

NO. OF COPIES RECEIVED	
DISTRIBUTION	
SANTA FE	1
FILE	1 ✓
U.S.G.S.	2
LAND OFFICE	
OPERATOR	1

NEW MEXICO OIL CONSERVATION COMMISSION

RECEIVED

JUN 9 1980

O. C. D.  
ARTESIA OFFICE

30-005-60727  
Form C-101  
Revised 1-1-65

5A. In State Type of Lease	
STATE <input type="checkbox"/>	TEE <input checked="" type="checkbox"/>
6. Title of Lease (See Note 1)	

APPLICATION FOR PERMIT TO DRILL, DEEPEN, OR PLUG BACK

1a. Type of Work	
DRILL <input checked="" type="checkbox"/>	DEEPEN <input type="checkbox"/>
b. Type of Well	
OIL WELL <input checked="" type="checkbox"/>	GAS WELL <input type="checkbox"/>
OTHER <input type="checkbox"/>	
c. Name of Operator	
Coronado Exploration Corp ✓	
d. Address of Operator	
1005 Marquette NW Albuquerque, NM 87102	
e. Location of Well	
UNIT LETTER I	LOCATED 1980
FEET FROM THE South LINE	
AND 660	FEET FROM THE East LINE OF SEC. 28
TWP. 11S RGE. 28E NMM	
1b. Proposed Depth	
2800'	
1c. Formation	
San Andres	
1d. Name of C.T.	
Cable Tool	
1e. Elevations (Show whether DL, RL, etc.)	
3640.9 Gr	
1f. Kind & Status Play. Bond	
Statewide	
21f. Drilling Contractor	
Comanche Drilling	
22. Approx. Date Work will start	
July 4, 1980	

7. Unit Agreement Name
8. Name of Leaseholder
Louise
9. Well No.
#1
10. Field and Pool, or Pl. Unit
Wildcat
11. County
Chaves
12. Proposed Depth
2800'
13. Formation
San Andres
14. Name of C.T.
Cable Tool
15. Elevations (Show whether DL, RL, etc.)
3640.9 Gr
16. Kind & Status Play. Bond
Statewide
17. Drilling Contractor
Comanche Drilling
18. Approx. Date Work will start
July 4, 1980

PROPOSED CASING AND CEMENT PROGRAM

SIZE OF HOLE	SIZE OF CASING	WEIGHT PER FOOT	SETTING DEPTH	SACKS OF CEMENT	EST. TOP
10"	8 5/8"	20	400	85	Circ.
8"	4 1/2"	9.5	2800	145	2000'

We propose to:

Drill a 10" hole and set 8 5/8" casing to 400'; circulate cement to surface; WOC 12 hrs. Test hole for fluid entry. If bailed dry commence drilling an 8" hole to 2800'. Run DDL with Microlaterolog; GR-CNL-D. Set 4 1/2" casing to either TD or above P1 zone depending on the outcome of the logs. In latter case open hole completion will be attempted, in former case casing will be perforated.

APPROVAL VALID  
FOR 90 DAYS UNLESS  
DRILLING COMMENCED,

EXPIRES 9-18-80

IN ABOVE SPACE DESCRIBE PROPOSED PROGRAM: IF PROPOSAL IS TO DEEPEN OR PLUG BACK, GIVE DATA ON PRESENT PRODUCTIVE ZONE AND PROPOSED NEW PRODUCTIVE ZONE. GIVE BLOWOUT PREVENTER PROGRAM, IF ANY.

I hereby certify that the information above is true and complete to the best of my knowledge and belief.  
CORONADO EXPLORATION CORP.  
Signed Florida Deane Title Production Secretary Date 06-02-80

(This space for State Use)  
APPROVED BY W.A. Gressett TITLE SUPERVISOR, DISTRICT II DATE JUN 18 1980

CONDITIONS OF APPROVAL, IF ANY:  
Subject to Case 6934  
6-25-80  
Casing to be circulated to surface behind 8 5/8" casing

N. MEXICO OIL CONSERVATION COMMISS  
WELL LOCATION AND ACREAGE DEDICATION PLAT

Form C-102  
Supersedes C-128  
Effective 1-4-65

All distances must be from the outer boundaries of the Section.

Operator <b>Coronado Exploration Co.</b>			Lease <b>Louise</b>		Well No. <b>1</b>
Unit Letter <b>1</b>	Section <b>28</b>	Township <b>11 South</b>	Range <b>28 East</b>	County <b>Chaves</b>	
Actual Footage Location of Well: <b>1980</b> feet from the <b>South</b> line and <b>660</b> feet from the <b>East</b> line					
Ground Level Elev. <b>3640.9</b>	Producing Formation <b>San Andres</b>		Pool <b>Wildcat</b>	Dedicated Acreage: <b>40</b> Acres	

1. Outline the acreage dedicated to the subject well by colored pencil or hatchure marks on the plat below.
2. If more than one lease is dedicated to the well, outline each and identify the ownership thereof (both as to working interest and royalty).
3. If more than one lease of different ownership is dedicated to the well, have the interests of all owners been consolidated by communitization, unitization, force-pooling, etc?

☒ Yes ☐ No If answer is "yes," type of consolidation see reverse side

If answer is "no," list the owners and tract descriptions which have actually been consolidated. (Use reverse side of this form if necessary.)

No allowable will be assigned to the well until all interests have been consolidated (by communitization, unitization, forced-pooling, or otherwise) or until a non-standard unit, eliminating such interests, has been approved by the Commission.

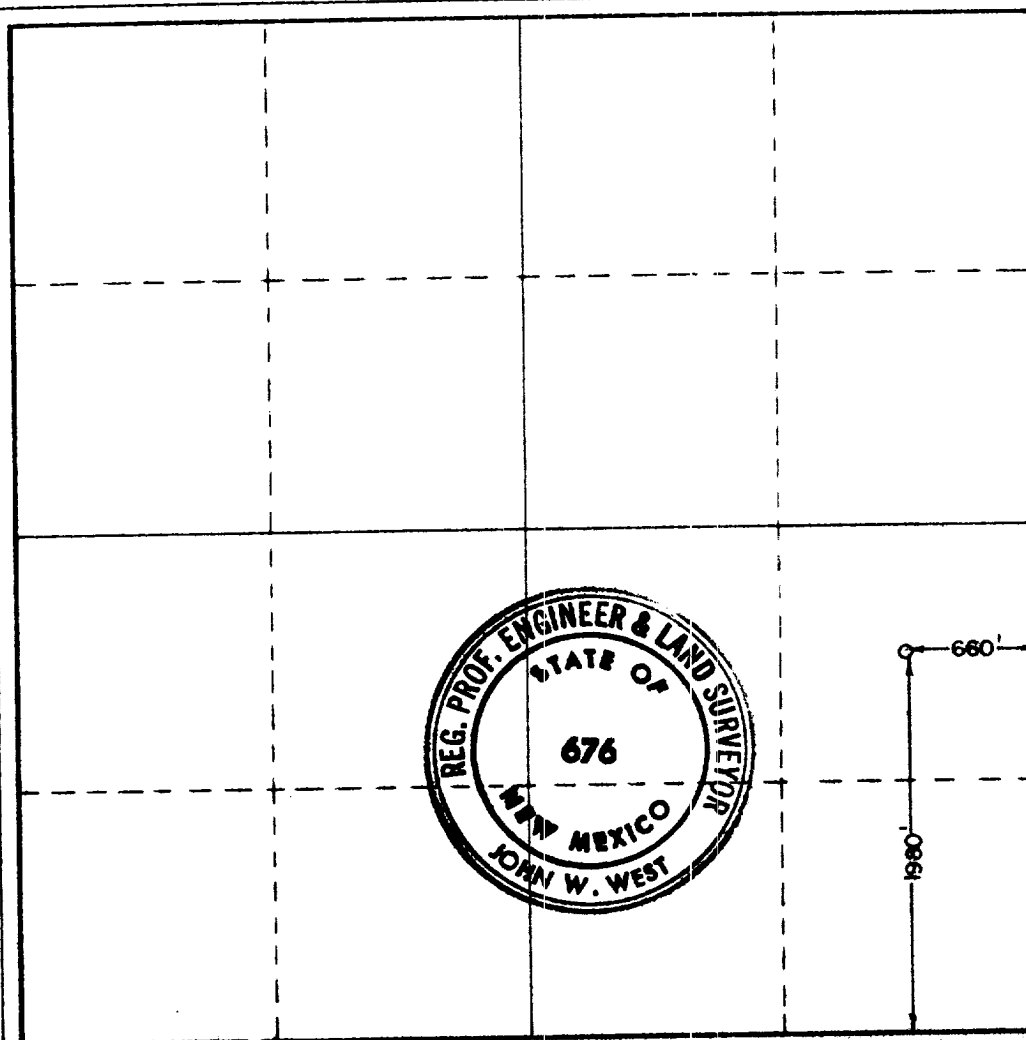

CERTIFICATION

I hereby certify that the information contained herein is true and complete to the best of my knowledge and belief.

Pamela Bacon

Name

Production Sec.

Position

Coronado Exploration Corp.

Company

06-06-80

Date

*Pamela Bacon*

I hereby certify that the well location shown on this plat was plotted from field notes of actual surveys made by me or under my supervision, and that the same is true and correct to the best of my knowledge and belief.

Date Surveyed

April 26, 1980

Registered Professional Engineer and/or Land Surveyor

*John W. West*

Certificate No. **JOHN W. WEST 676**  
**PATRICK A. ROMERO 6083**  
**Ronald J. Egan 3239**

0 220 440 660 880 1100 1320 1540 1760 1980 2200 2420 2640 2860 3080 3300 3520 3740 3960 4180 4400 4620 4840 5060 5280 5500 5720 5940 6160 6380 6600

3. Communitisation is by force pooling. Leases not held by operator are:  
Tenneco 12.5%, White Ranch Minerals 4.296875%, Francisca Winston Trust  
.78125%, Frederick Winston Trust .390625%, and Selma Andrews Trust  
.28125%.