

NO. OF COPIES RECEIVED		
DISTRIBUTION		
SANTA FE	✓	
FILE	1	✓
U.S.G.S.	2	
LAND OFFICE		
OPERATOR	1	

NEW MEXICO OIL CONSERVATION COMMISSION

RECEIVED

JUN 27 1980

O. C. D.

ARTESIA OFFICE

30-005-60741

Form C-101
Revised 1-1-65

5A. Indicate Type of Lease	
STATE <input type="checkbox"/>	FEE <input type="checkbox"/>
5. State Oil & Gas Lease No.	

APPLICATION FOR PERMIT TO DRILL, DEEPEN, OR PLUG BACK

1a. Type of Work DRILL <input checked="" type="checkbox"/> DEEPEN <input type="checkbox"/> PLUG BACK <input type="checkbox"/>		7. Unit Agreement Name
b. Type of Well OIL WELL <input type="checkbox"/> GAS WELL <input checked="" type="checkbox"/> OTHER <input type="checkbox"/> SINGLE ZONE <input type="checkbox"/> MULTIPLE ZONE <input type="checkbox"/>		8. Farm or Lease Name Johnson-Fee
2. Name of Operator Fred Pool Drilling, Inc.		9. Well No. 1
3. Address of Operator 437 White Bldg. Roswell, N.M. 88201		10. Field and Pool, or Wildcat Wildcat
4. Location of Well UNIT LETTER L LOCATED 600 FEET FROM THE West LINE AND 1980 FEET FROM THE South LINE OF SEC. 30 TWP. 68 RGE. 26E NMPM		12. County Chaves
19. Proposed Depth 4400 ft.		19A. Formation ABO
20. Rotary or C.T. Rotary		
21. Elevations (Show whether DF, RT, etc.) 3719.7 OL	21A. Kind & Status Plug. Bond Blanket	21B. Drilling Contractor Fred Pool Drlg. Inc.
22. Approx. Date Work will start Aug. 10, 1980		

23. PROPOSED CASING AND CEMENT PROGRAM

SIZE OF HOLE	SIZE OF CASING	WEIGHT PER FOOT	SETTING DEPTH	SACKS OF CEMENT	EST. TOP
17 1/2"	13 3/8"	4.4	400" approx.	350 sz C1 C	Circulated
12 1/2 or 11"	8 5/8"	2.4	1500"	300 sz C1 C	"
7 7/8"	4 1/2"	10.54	4400"	400 sz C1 H	"

Double Shafer Manual Series 900 blow-out preventer will be used on well

Gas is dedicated to Transwestern Pipeline Co.

APPROVAL VALID
FOR 90 DAYS UNLESS
DRILLING COMMENCED,

EXPIRES 10-1-80

IN ABOVE SPACE DESCRIBE PROPOSED PROGRAM: IF PROPOSAL IS TO DEEPEN OR PLUG BACK, GIVE DATA ON PRESENT PRODUCTIVE ZONE AND PROPOSED NEW PRODUCTIVE ZONE. GIVE BLOWOUT PREVENTER PROGRAM, IF ANY.

I hereby certify that the information above is true and complete to the best of my knowledge and belief.

Signed Leta Pool Title Secretary Date 6-26-80

(This space for State Use)

APPROVED BY Mike Williams TITLE OIL AND GAS INSPECTOR DATE JUL 1 1980

CONDITIONS OF APPROVAL, IF ANY:

Cement must be circulated to
surface behind 13 3/8" 18 5/8" casing

WELL LOCATION AND ACREAGE DEDICATION PLAT

RECEIVED

Superseded 1-1-63
Effective 1-1-63

JUL 1 1980

All distances must be from the outer boundaries of the Section.

Operator Fred Pool Drilling, Inc.		Lease Johnson-Fee		O. C. D.	Well No. 1
Unit Letter L	Section 30	Township 6 South	Range 26 East	County Chaves	
Actual Postage Location of Well: 660 feet from the West line and 1980 feet from the South line			Dedicated Acreage: 160		
Ground Level Elev. 3719.7	Producing Formation Abo		Pool Wildcat	Acres	

1. Outline the acreage dedicated to the subject well by colored pencil or hachure marks on the plat below.
2. If more than one lease is dedicated to the well, outline each and identify the ownership thereof (both as to working interest and royalty).
3. If more than one lease of different ownership is dedicated to the well, have the interests of all owners been consolidated by communitization, unitization, force-pooling, etc?

☐ Yes ☐ No If answer is "yes," type of consolidation _____

If answer is "no," list the owners and tract descriptions which have actually been consolidated. (Use reverse side of this form if necessary.) _____

No allowable will be assigned to the well until all interests have been consolidated (by communitization, unitization, forced-pooling, or otherwise) or until a non-standard unit, eliminating such interests, has been approved by the Commission.

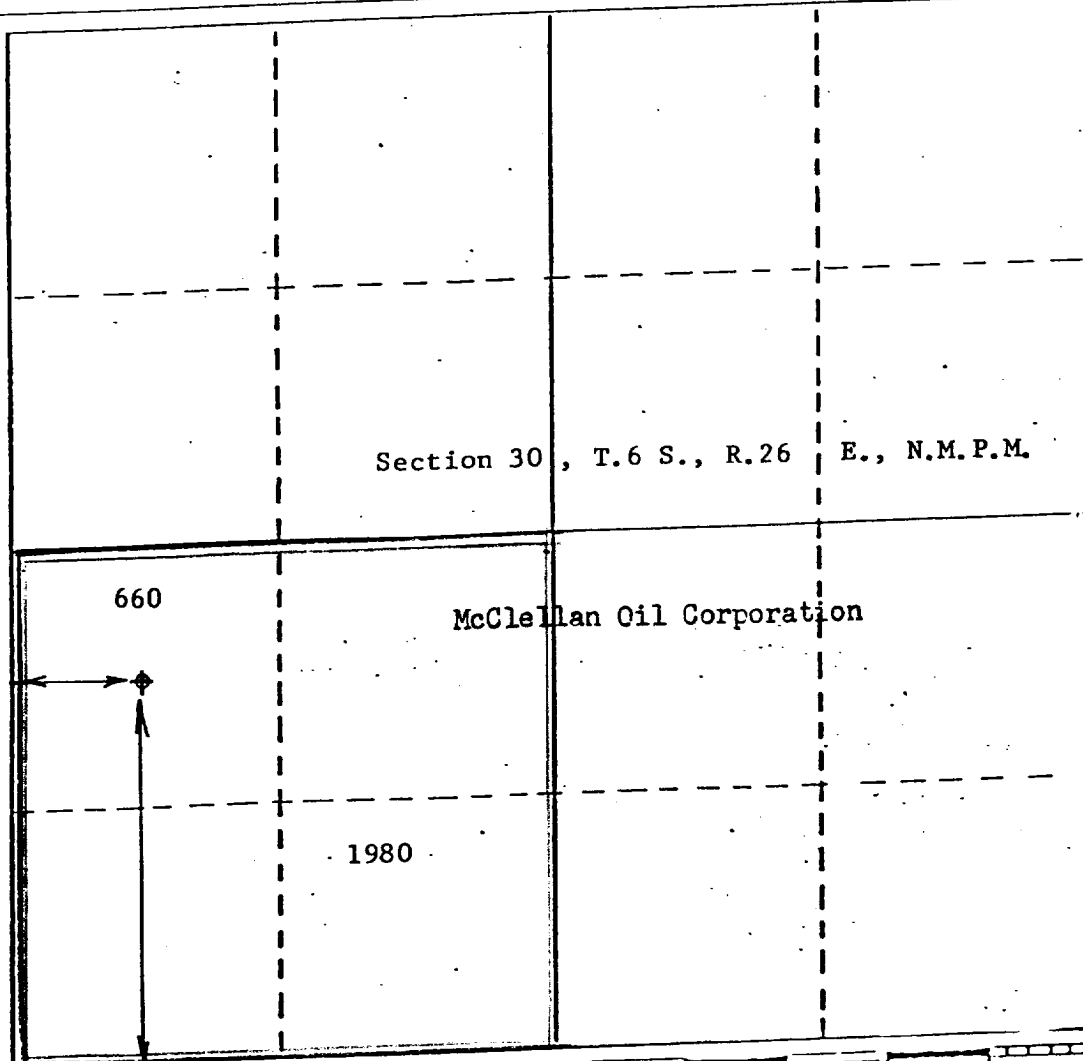

CERTIFICATION

I hereby certify that the information contained herein is true and complete to the best of my knowledge and belief.

Fred Pool, Jr.

Name

President

Position

Fred Pool Drilling, Inc.

Company

June 26, 1980

Date

I hereby certify that the well location shown on this plat was plotted from field notes of actual surveys made by me or under my supervision, and that the same is true and correct to the best of my knowledge and belief.

John D. Jaquess
Date Surveyed
John D. Jaquess
Registered Professional Engineer
and/or Licensed Surveyor
Certificate No. **6290**