

NO. OF COPIES RECEIVED	
DISTRIBUTION	
SANTA FE	1
FILE	1 ✓
U.S.G.S.	2
LAND OFFICE	
OPERATOR	1

NEW MEXICO OIL CONSERVATION COMMISSION
RECEIVED

JUL 7 1980

O. C. D.

30-005-60744
Form C-101
Revised 1-1-65

5A. Indicate Type of Lease	
STATE <input type="checkbox"/>	FEE <input checked="" type="checkbox"/>
5. State Oil & Gas Lease No.	

APPLICATION FOR PERMIT TO DRILL, DEEPEN, OR PLUG BACK

1a. Type of Work		7. Unit Agreement Name	
b. Type of Well DRILL <input checked="" type="checkbox"/> DEEPEN <input type="checkbox"/> PLUG BACK <input type="checkbox"/> OIL WELL <input checked="" type="checkbox"/> GAS WELL <input type="checkbox"/> OTHER <input type="checkbox"/> SINGLE ZONE <input type="checkbox"/> MULTIPLE ZONE <input type="checkbox"/>		8. Farm or Lease Name Elizabeth	
2. Name of Operator Ralph Nix ✓		9. Well No. 3	
3. Address of Operator P.O. Box 617, Artesia, New Mexico 88210		10. Field and Pool, or Wildcat Undesignated SA	
4. Location of Well UNIT LETTER <u>C</u> LOCATED <u>330</u> FEET FROM THE <u>North</u> LINE AND <u>1650</u> FEET FROM THE <u>West</u> LINE OF SEC. <u>7</u> TWP. <u>8S</u> RGE. <u>29E</u> NMPM		12. County Chaves	
19. Proposed Depth 2800'		19A. Formation San Andres	20. Rotary or C.T. Rotary
21. Elevations (Show whether DI, RT, etc.) 4056' GL	21A. Kind & Status Plug. Bond Blanket	21B. Drilling Contractor Artesia Fishing Tool	22. Approx. Date Work will start As soon as approved

PROPOSED CASING AND CEMENT PROGRAM

SIZE OF HOLE	SIZE OF CASING	WEIGHT PER FOOT	SETTING DEPTH	SACKS OF CEMENT	EST. TOP
12-1/4"	8-5/8"	24#	250'	200	Circ. to top
7-7/8"	4-1/2"	10.5#	2800'	200	1900'

Adequate blowout prevention equipment will be utilized.

APPROVAL VALID
FOR 90 DAYS UNLESS
DRILLING COMMENCED,

EXPIRES 10-8-80

IN ABOVE SPACE DESCRIBE PROPOSED PROGRAM; IF PROPOSAL IS TO DEEPEN OR PLUG BACK, GIVE DATA ON PRESENT PRODUCTIVE ZONE AND PROPOSED NEW PRODUCTIVE ZONE. GIVE BLOWOUT PREVENTER PROGRAM, IF ANY.

I hereby certify that the information above is true and complete to the best of my knowledge and belief.

Signed [Signature] Title Operations Manager Date 7/3/80

(This space for State Use)

APPROVED BY [Signature] TITLE OIL AND GAS INSPECTOR DATE JUL 8 1980

CONDITIONS OF APPROVAL, IF ANY:

NEW MEXICO OIL CONSERVATION COMMISSION
WELL LOCATION AND ACREAGE DEDICATION PLAT

Form C-102
 Supersedes C-128
 Effective 1-1-65

All distances must be from the outer boundaries of the Section.

Operator Ralph Nix			Lease ELIZABETH		Well No. #3
Unit Letter C	Section 7	Township 8S.	Range 29E.	County Chaves	
Actual Footage Location of Well:					
1650		feet from the WEST line and		330	feet from the NORTH line
Ground Level Elev. 4056	Producing Formation San Andres		Pool Undesignated		Dedicated Acreage: 40 Acres

1. Outline the acreage dedicated to the subject well by colored pencil or hatchure marks on the plat below.
2. If more than one lease is dedicated to the well, outline each and identify the ownership thereof (both as to working interest and royalty).
3. If more than one lease of different ownership is dedicated to the well, have the interests of all owners been consolidated by communitization, unitization, force-pooling, etc?

☐ Yes ☐ No If answer is "yes," type of consolidation _____

If answer is "no," list the owners and tract descriptions which have actually been consolidated. (Use reverse side of this form if necessary.) _____

No allowable will be assigned to the well until all interests have been consolidated (by communitization, unitization, forced-pooling, or otherwise) or until a non-standard unit, eliminating such interests, has been approved by the Commission.

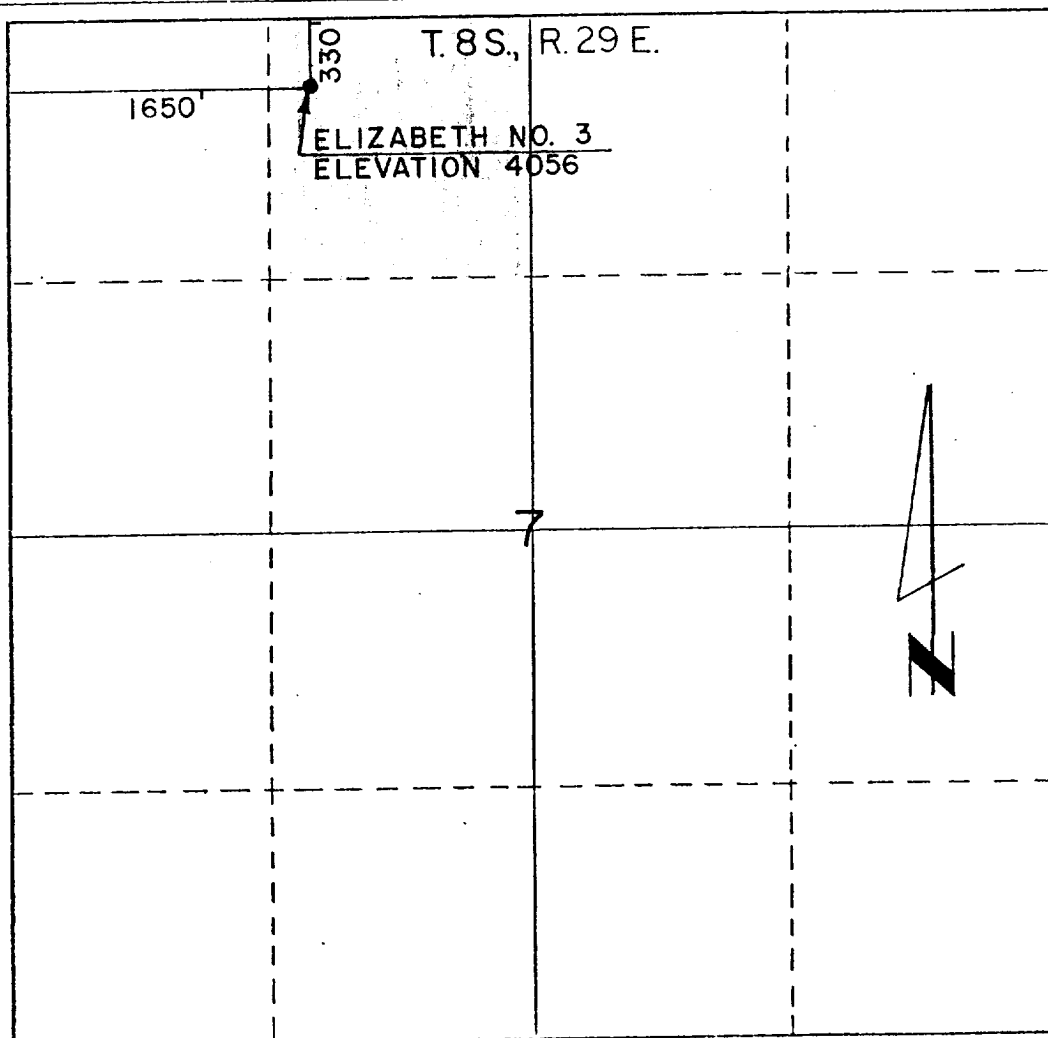

CERTIFICATION

I hereby certify that the information contained herein is true and complete to the best of my knowledge and belief.

Name *Paul Nix*
 Position **Operations Manager**
 Company **Ralph Nix Oil**
 Date **7/3/80**

I hereby certify that the well location shown on this plat was plotted from field notes of actual surveys made by me or under my supervision, and that the same is true and correct to the best of my knowledge and belief.

May 22, 1980

Date Surveyed *Thomas T. Mann*
Thomas T. Mann
 Registered Professional Engineer
 and/or Land Surveyor

N.M. License #277

Certificate No. _____

