

NO. OF COPIES RECEIVED	
DISTRIBUTION	
SANTA FE	1
FILE	1 ✓
U.S.G.S.	2
LAND OFFICE	
OPERATOR	1

NEW MEXICO OIL CONSERVATION COMMISSION

RECEIVED

JUL 10 1980

O. C. D.
ARTESIA, OFFICE

30-005-60745
Form C-101
Revised 1-1-65

5A. Indicate Type of Lease
STATE ☐ FEE ☒

5. State Oil & Gas Lease No.

APPLICATION FOR PERMIT TO DRILL, DEEPEN, OR PLUG BACK

1a. Type of Work DRILL <input checked="" type="checkbox"/> DEEPEN <input type="checkbox"/> PLUG BACK <input type="checkbox"/>		7. Unit Agreement Name
b. Type of Well OIL WELL <input type="checkbox"/> GAS WELL <input checked="" type="checkbox"/> OTHER <input type="checkbox"/> SINGLE ZONE <input type="checkbox"/> MULTIPLE ZONE <input type="checkbox"/>		8. Farm or Lease Name J.C. Nail
2. Name of Operator Fred Pool Drilling, Co.		9. Well No. 1
3. Address of Operator 437 White Bldg. Roswell, N.M. 88201		10. Field and Pool, or Wildcat Und. Wildcat
4. Location of Well UNIT LETTER 0 LOCATED 660 FEET FROM THE South LINE AND 1980 FEET FROM THE East LINE OF SEC. 33 TWP. 5S RGE. 24E NMPM		12. County Chaves
13. Proposed Depth 4200 ft.		15A. Formation Abo
16. Rotary or C.T. Rotary		
21. Elevations (show whether DF, RT, etc.) 4062.5	21A. Kind & Status Plug. Bond Blanket	21B. Drilling Contractor Fred Pool Drlg. Co.
22. Approx. Date Work will start August 1		

23.

PROPOSED CASING AND CEMENT PROGRAM

SIZE OF HOLE	SIZE OF CASING	WEIGHT PER FOOT	SETTING DEPTH	SACKS OF CEMENT	EST. TOP
17"	13 3/8	54.50 #	350 ft.	350 sx.	circulate
12"	8 5/8	24#	1400 ft.	300 sx. C1 C	"
7 7/8	4 1/2	10.5#	4200 ft.	400 sx. C1 H	"

Double Shafer manual blow- out preventer will be used on well, Series 900.

G Gas is not dedicated to a purchaser.

APPROVAL VALID
FOR 90 DAYS UNLESS
DRILLING COMMENCED,

EXPIRES 10-14-80

IN ABOVE SPACE DESCRIBE PROPOSED PROGRAM: IF PROPOSAL IS TO DEEPEN OR PLUG BACK, GIVE DATA ON PRESENT PRODUCTIVE ZONE AND PROPOSED NEW PRODUCTIVE ZONE. GIVE BLOWOUT PREVENTER PROGRAM, IF ANY.

I hereby certify that the information above is true and complete to the best of my knowledge and belief.

Signed Renta Pool Title Secretary Date 7-8-80
(This space for State Use)

APPROVED BY W.A. Gressett TITLE SUPERVISOR, DISTRICT II DATE JUL 14 1980
CONDITIONS OF APPROVAL, IF ANY:

WELL LOCATION AND ACREAGE DEDICATION PLAT

Superseded by Form 1-1-65

All distances must be from the outer boundaries of the section.

Operator Fred Pool Drilling, ^{Co} Inc.			Lease J.C. Nail		Well No. 1
Unit Letter 0	Section 33	Township 5 South	Range 24 East	County Chaves	
Actual Footage Location of Well: <div style="display: flex; justify-content: space-between;"> 660 feet from the South line and 1980 feet from the East line </div>					
Ground Level Elev. 4062.5	Producing Formation Abo	Pool Und. Wildcat		Dedicated Acreage: 160 Acres	

1. Outline the acreage dedicated to the subject well by colored pencil or hatchure marks on the plat below.
2. If more than one lease is dedicated to the well, outline each and identify the ownership thereof (both as to working interest and royalty).
3. If more than one lease of different ownership is dedicated to the well, have the interests of all owners been consolidated by communitization, unitization, force-pooling, etc?

☐ Yes ☒ No If answer is "yes," type of consolidation _____

If answer is "no," list the owners and tract descriptions which have actually been consolidated. (Use reverse side of this form if necessary.) _____

No allowable will be assigned to the well until all interests have been consolidated (by communitization, unitization, forced-pooling, or otherwise) or until a non-standard unit, eliminating such interests, has been approved by the Commission.

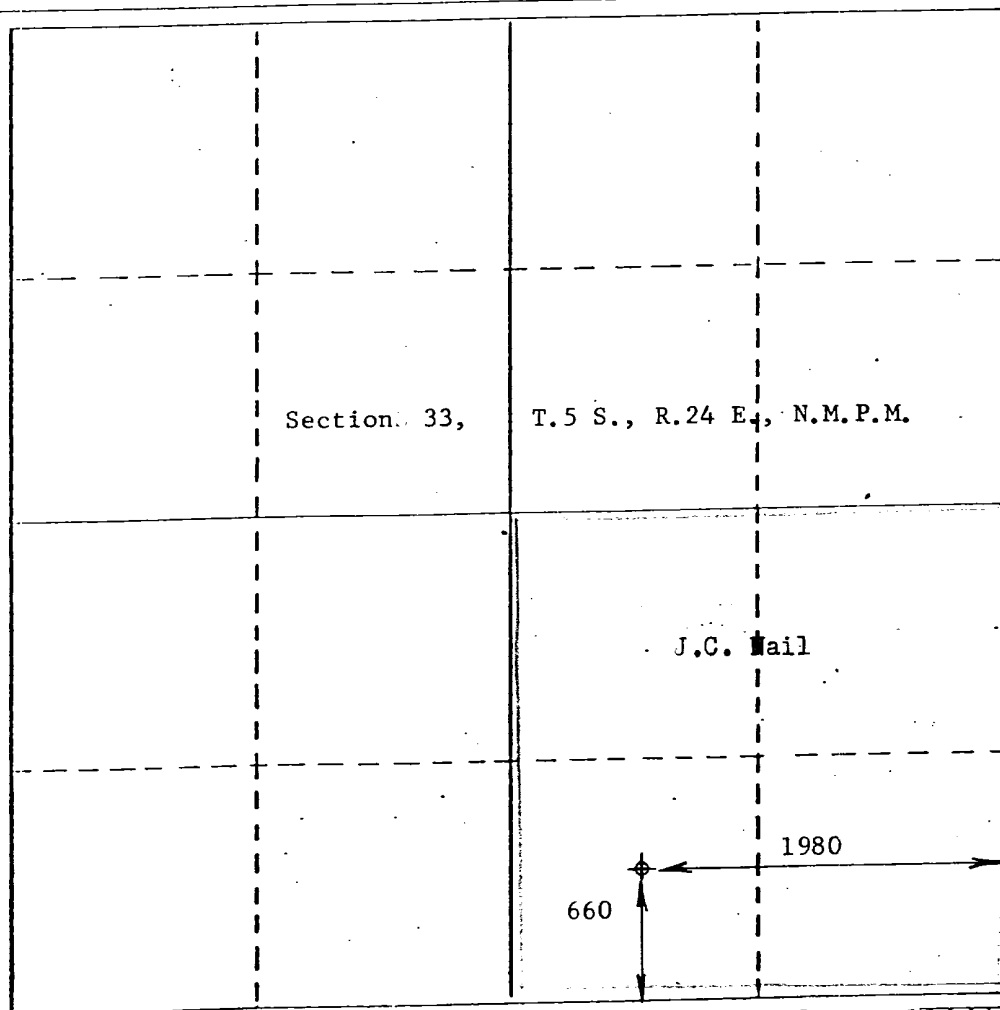

CERTIFICATION

I hereby certify that the information contained herein is true and complete to the best of my knowledge and belief.

Fred Pool, Jr.

Name
Fred Pool Drig, ^{Co} Inc.

Position
President

Company
July 7, 1980

Date
Fred Pool Jr

I hereby certify that the well location shown on this plat was plotted from field notes of actual surveys made by me or under my supervision, and that the same is true and correct to the best of my knowledge and belief.

JOHN D. JAQUESS
 STATE OF
 John D. Jaquess, P.E., N.S.
 Registered Professional Engineer
 and Geologist
 License No. 6290
 NEW MEXICO
 PROFESSIONAL ENGINEER
 Certificate No. 6290

