

NO. OF COPIES RECEIVED	
DISTRIBUTION	
SANTA FE	1
FILE	1 ✓
U.S.G.S.	2
LAND OFFICE	
OPERATOR	1

NEW MEXICO OIL CONSERVATION COMMISSION

30-005-60750

Form C-101
Revised 11-65

5A. Indicate Type of Lease	
STATE <input type="checkbox"/>	FEE <input checked="" type="checkbox"/>

5. State Oil & Gas Lease No.

APPLICATION FOR PERMIT TO DRILL, DEEPEN, OR PLUG BACK

1a. Type of Work DRILL <input checked="" type="checkbox"/> DEEPEN <input type="checkbox"/> PLUG BACK <input type="checkbox"/>				7. Unit Agreement Name	
b. Type of Well OIL WELL <input checked="" type="checkbox"/> GAS WELL <input type="checkbox"/> OTHER <input type="checkbox"/> SINGLE ZONE <input checked="" type="checkbox"/> MULTIPLE ZONE <input type="checkbox"/>				8. Name of Lessee Name J.P. White D	
2. Name of Operator Coronado Exploration Corp. ✓				9. Well No. 84	
3. Address of Operator 1005 Marquett NW Albuquerque, NM 87102				10. Field Name Und. Race Track SA	
4. Location of Well UNIT LETTER N LOCATED 1980 FEET FROM THE West LINE AND 660 FEET FROM THE South LINE OF SEC. 20 TWP. 10S RGE. 28E NMPM				11. County Chaves	
19. Proposed Depth 2230'				19A. Formation San Andres	
21. Elevations (Show whether DF, RT, etc.) 3751.4 Gr				21A. Kind & Status Plug Bond Statewide	
21B. Drilling Contractor Comanche Drilling				22. Approx. Date Work will start 7-18-80	

PROPOSED CASING AND CEMENT PROGRAM

SIZE OF HOLE	SIZE OF CASING	WEIGHT PER FOOT	SETTING DEPTH	SACKS OF CEMENT	EST. TOP
10"	8 5/8"	20#	330	200	Circulate
8"	4 1/2"	9.5#	2200	135	1700'

We propose to:

Drill a 10" hole to 330' and set 8 5/8" 20# surface casing. We will circulate the cement and WOC 18 hours. We will test the casing for leaks. If there are no leaks we will continue to drill making an 8" hole to approximately 2230'. We will set 4 1/2" casing at 2200' and cement with a pack-off shoe leaving approximately 30' of open hole. We will run SNP, Dual Induction and Density logs to TD.

IN ABOVE SPACE DESCRIBE PROPOSED PROGRAM: IF PROPOSAL IS TO DEEPEN OR PLUG BACK, GIVE DATA ON PRESENT PRODUCTIVE ZONE AND PROPOSED NEW PRODUCTIVE ZONE. GIVE BLOWOUT PREVENTER PROGRAM, IF ANY.

I hereby certify that the information above is true and complete to the best of my knowledge and belief.

Signed BY: CORONADO EXPLORATION CORP. Title Engineer Date July 14, 1980

(This space for State Use)

APPROVED BY: W. A. Grissett TITLE SUPERVISOR, DISTRICT II DATE JUL 18 1980

CONDITIONS OF APPROVAL, IF ANY:

NEW MEXICO OIL CONSERVATION COMMISSION
WELL LOCATION AND ACREAGE DEDICATION PLAT

Form C-102
Supersedes C-128
Effective 1-1-65

All distances must be from the outer boundaries of the Section.

Operator Coronado Exploration Corp.			Lease J.P. White "D"		Well No. 4
Unit Letter N	Section 20	Township 10 South	Range 28 East	County Chaves	
Actual Footage Location of Well: 660 feet from the South line and 1980 feet from the West line					
Ground Level Elev. 3751.4	Producing Formation San Andres		Pool Rose Track and L.E. Ranch San Andres	Dedicated Acreage: 40 Acres	

- Outline the acreage dedicated to the subject well by colored pencil or hachure marks on the plat below.
- If more than one lease is dedicated to the well, outline each and identify the ownership thereof (both as to working interest and royalty).
- If more than one lease of different ownership is dedicated to the well, have the interests of all owners been consolidated by communitization, unitization, force-pooling, etc?

☐ Yes ☒ No If answer is "yes," type of consolidation _____

If answer is "no," list the owners and tract descriptions which have actually been consolidated. (Use reverse side of this form if necessary.) All leases are held by operator and participating parties

No allowable will be assigned to the well until all interests have been consolidated (by communitization, unitization, forced-pooling, or otherwise) or until a non-standard unit, eliminating such interests, has been approved by the Commission.

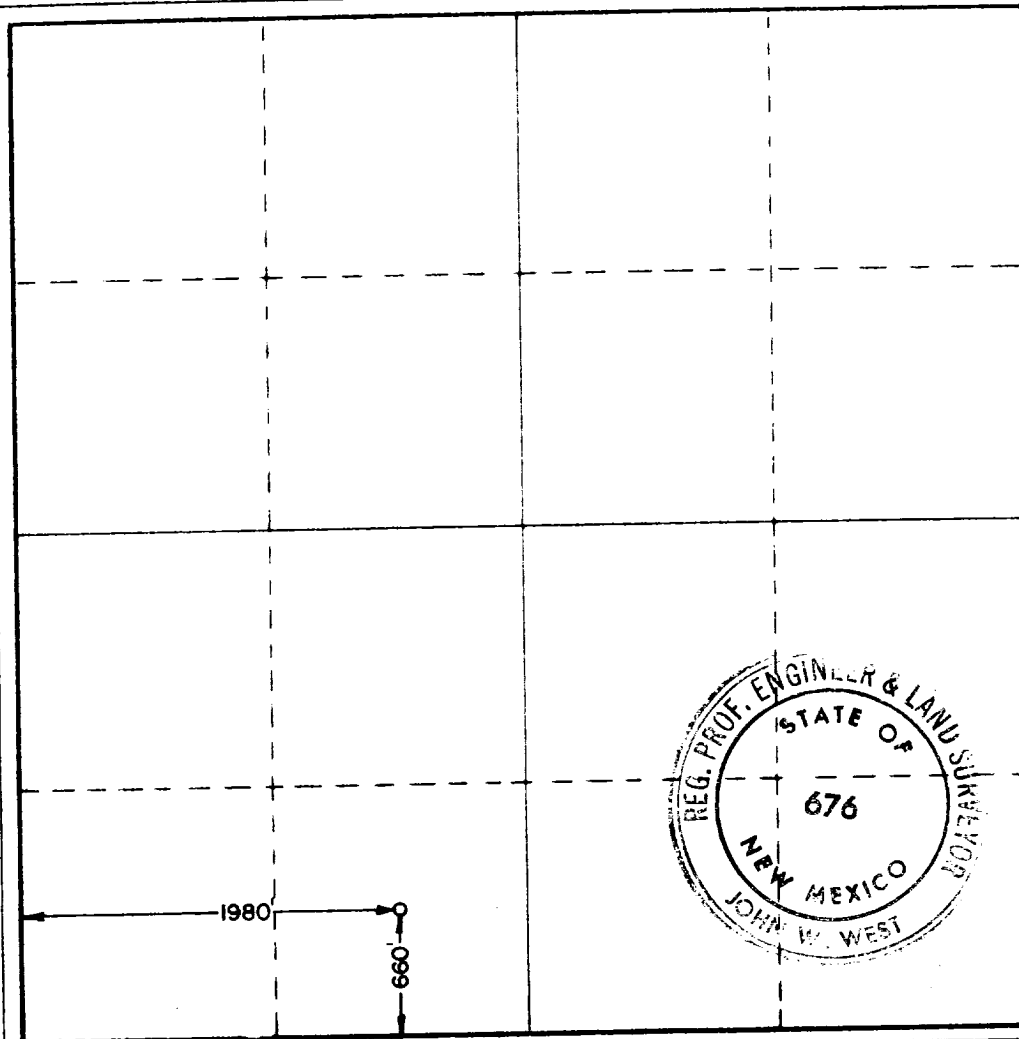

CERTIFICATION

I hereby certify that the information contained herein is true and complete to the best of my knowledge and belief

Pamela Bacon

Name

Pamela Bacon

Position

Production Secretary

Company

Coronado Exploration Corp.

Date

07 15-80

I hereby certify that the well location shown on this plat was plotted from field notes of actual surveys made by me or under my supervision, and that the same is true and correct to the best of my knowledge and belief.

Date Surveyed

July 10, 1980

Registered Professional Engineer and/or Land Surveyor

John W. West

Certificate No. **JOHN W. WEST 676**
PATRICK A. ROMERO 6663
Ronald J. Eidson 3239