

NO. OF COPIES RECEIVED	
DISTRIBUTION	
ANTAF	1
FILE	1
U.S.G.S.	2
LAND OFFICE	1
OPERATOR	1

NEW MEXICO OIL CONSERVATION COMMISSION

RECEIVED  
JUL 18 1980  
O. C. D.  
ARTESIA, OFFICE

30-005-60753

Form C-101  
Revised 1-1-65

5A. Indicate Type of Lease STATE <input checked="" type="checkbox"/> FEE <input type="checkbox"/>
5. State Oil & Gas Lease No. L-4705

APPLICATION FOR PERMIT TO DRILL, DEEPEN, OR PLUG BACK

1a. Type of Work DRILL <input checked="" type="checkbox"/> DEEPEN <input type="checkbox"/> PLUG BACK <input type="checkbox"/>		7. Unit Agreement Name
b. Type of Well OIL WELL <input checked="" type="checkbox"/> GAS WELL <input type="checkbox"/> OTHER <input type="checkbox"/> SINGLE ZONE <input type="checkbox"/> MULTIPLE ZONE <input type="checkbox"/>		8. Farm or Lease Name DEB STATE
2. Name of Operator H. W. PACE		9. Well No. 1
3. Address of Operator BOX 7435, MIDLAND, TEXAS 79703		10. Field and Pool or Wildcat <del>Wildcat</del> UNDESIGNATED SAN A.
4. Location of Well UNIT LETTER <u>I</u> LOCATED <u>1990'</u> FEET FROM THE <u>SOUTH</u> LINE AND <u>660'</u> FEET FROM THE <u>EAST</u> LINE OF SEC. <u>16</u> TWP. <u>8S</u> RGE. <u>26E</u> NMPM		12. County CHAVES
19. Proposed Depth 1600'		19A. Formation SAN AND
20. Rotary or C.T. C.T.		
21. Elevations (Show whether DF, RT, etc.) G.L. 3°40.6	21A. Kind & Status Plug. Bond one well \$5000.00	21B. Drilling Contractor PRICE DRILLING CO
22. Approx. Date Work will start JULY, 19, 1980		

PROPOSED CASING AND CEMENT PROGRAM

SIZE OF HOLE	SIZE OF CASING	WEIGHT PER FOOT	SETTING DEPTH	SACKS OF CEMENT	EST. TOP
14"	8-5/8	24#	250"	120 sx class C	CIR
6"	4-1/2	14#	1600'	190 cu ft Pos-Circ	Mix

APPROVAL VAND  
FOR 90 DAYS UNLESS  
DRILLING COMMENCED,  
EXPIRES 10-21-80

IN ABOVE SPACE DESCRIBE PROPOSED PROGRAM: IF PROPOSAL IS TO DEEPEN OR PLUG BACK, GIVE DATA ON PRESENT PRODUCTIVE ZONE AND PROPOSED NEW PRODUCTIVE ZONE. GIVE BLOWOUT PREVENTER PROGRAM, IF ANY.

I hereby certify that the information above is true and complete to the best of my knowledge and belief.

Signed H. W. Pace Title OPERATOR Date 7-13, 1980

(This space for State Use)

APPROVED BY W. A. Gressett TITLE SUPERVISOR, DISTRICT II DATE JUL 21 1980

CONDITIONS OF APPROVAL, IF ANY:

NEW MEXICO OIL CONSERVATION COMMISSION  
WELL LOCATION AND ACREAGE DEDICATION PLAT

Form C-102  
Supersedes C-128  
Effective 1-1-65

All distances must be from the outer boundaries of the Section

Operator <b>H. W. PACE</b>		Lease <b>DEB State</b>		Well No. <b>1</b>
Unit Letter <b>I</b>	Section <b>16</b>	Township <b>8 South</b>	Range <b>26 East</b>	County <b>Chaves</b>
Actual Footage Location of Well: <b>1980</b> feet from the <b>South</b> line and <b>660</b> feet from the <b>East</b> line				
Ground Level Elev. <b>3840.6</b>	Producing Formation <b>Sg. And</b>	Pool <b>W. West</b>	Dedicated Acreage: <b>40</b> Acres	

1. Outline the acreage dedicated to the subject well by colored pencil or hachure marks on the plat below.
2. If more than one lease is dedicated to the well, outline each and identify the ownership thereof (both as to working interest and royalty).
3. If more than one lease of different ownership is dedicated to the well, have the interests of all owners been consolidated by communitization, unitization, force-pooling, etc?

☐ Yes ☐ No If answer is "yes," type of consolidation \_\_\_\_\_

If answer is "no," list the owners and tract descriptions which have actually been consolidated. (Use reverse side of this form if necessary.) \_\_\_\_\_

No allowable will be assigned to the well until all interests have been consolidated (by communitization, unitization, forced-pooling, or otherwise) or until a non-standard unit, eliminating such interests, has been approved by the Commission.

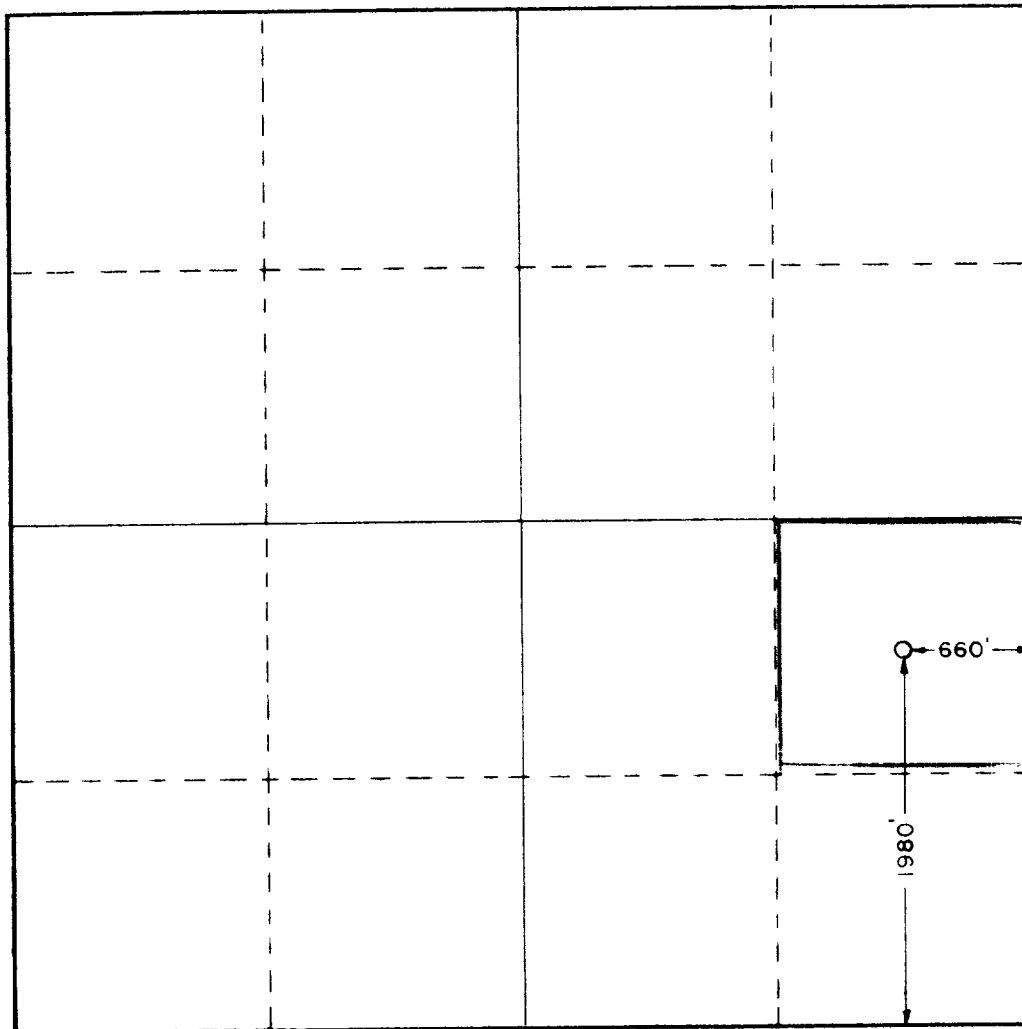

CERTIFICATION

I hereby certify that the information contained herein is true and complete to the best of my knowledge and belief.

*H. W. Pace*

Name

**OPERATOR**

Position

**H. W. PACE**

Company

**7-18-80**

Date

I hereby certify that the information shown on this plat was plotted from field notes of actual surveys made on or under my supervision, and that the same is true and correct to the best of my knowledge and belief.

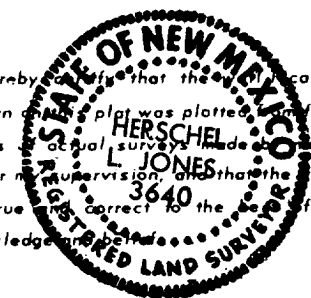

Date Surveyed

**July 17, 1980**

Registered Professional Engineer  
and/or Land Surveyor

Certificate No.

**3640**