

NEW MEXICO OIL CONSERVATION COMMISSION  
WE LOCATION AND ACREAGE DEDICATION PLAT

RECEIVED Form O-101  
Superseeds C-12F  
Effective 1-1-81

All distances must be from the outer boundaries of the Section

JUL 29 1981

General American Oil Company of Texas				GAO State		O. C. D. 1	
Section	36	Township	7 - South	Range	28 - East	County Chaves	
Actual Location of Well:							
2206		feet from the North		line and 660		feet from the East	
Ground Level Elev.	4090.7'		Producing Formation	Montoya		Pool	Undesignated
						Dedicated Acreage	320

1. Outline the acreage dedicated to the subject well by colored pencil or hachure marks on the plat below.
2. If more than one lease is dedicated to the well, outline each and identify the ownership thereof (both as to working interest and royalty).
3. If more than one lease of different ownership is dedicated to the well, have the interests of all owners been consolidated by communitization, unitization, force-pooling, etc?

☐ Yes ☐ No If answer is "yes," type of consolidation \_\_\_\_\_

If answer is "no," list the owners and tract descriptions which have actually been consolidated. (Use reverse side of this form if necessary.) \_\_\_\_\_

No allowable will be assigned to the well until all interests have been consolidated (by communitization, unitization, forced-pooling, or otherwise) or until a non-standard unit, eliminating such interests, has been approved by the Commission.

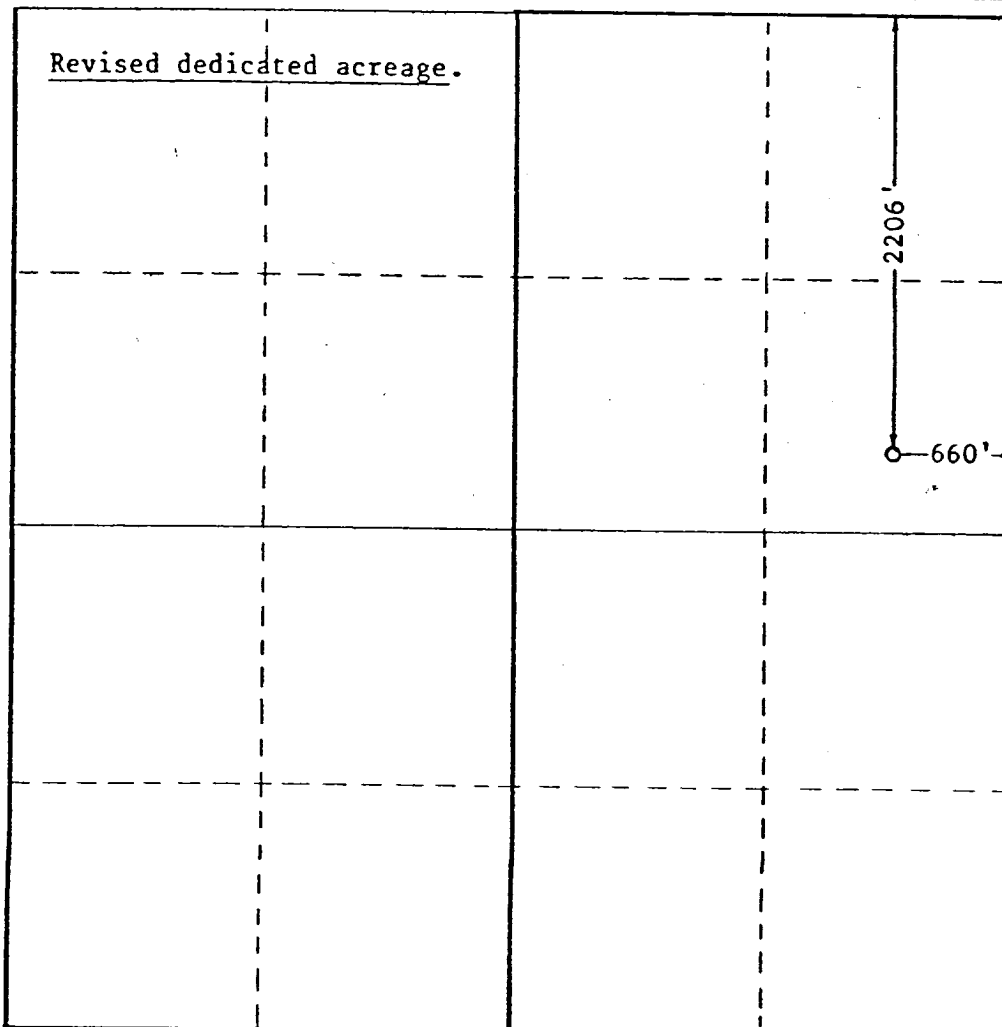

CERTIFICATION

I hereby certify that the information contained herein is true and complete to the best of my knowledge and belief.

*Lendell N. Hawkins*

Lendell N. Hawkins

Position

Field Superintendent

Company

General American Oil Co. of T

Date

July 28, 1981

I hereby certify that the well location shown on this plat was plotted from field notes of actual surveys made by me or under my supervision, and that the same is true and correct to the best of my knowledge and belief.

Date Surveyed

July 15, 1980

Registered Professional Engineer and/or Land Surveyor

See original plat sent July 28, 1980.

Certificate No.

0 320 640 960 1280 1600 1920 2240 2560 2880 3200 3520 3840 4160 4480 4800 5120 5440 5760 6080 6400