

N.M.O.C.D. COPY UNITED STATES  
DEPARTMENT OF THE INTERIOR  
GEOLOGICAL SURVEYSUBMIT IN TRIPPLICATE\*  
(Other instructions on re-  
verse side)Form approved.  
Budget Bureau No. 42-R1424.

## SUNDRY NOTICES AND REPORTS ON WELLS

(Do not use this form for proposals to drill or to deepen or plug back to a different formation.  
Use "APPLICATION FOR PERMIT—" for such proposals.)

RECEIVED

1. OIL WELL <input type="checkbox"/> GAS WELL <input checked="" type="checkbox"/> OTHER	NOV 10 1980
2. NAME OF OPERATOR	O. C. D.
3. ADDRESS OF OPERATOR	ARTESIA, OFFICE
P. O. Box 1518, Roswell, New Mexico 88201	
4. LOCATION OF WELL (Report location clearly and in accordance with any State requirements.* See also space 17 below.) At surface	
1980' FNL & 2030' FWL	
14. PERMIT NO.	15. ELEVATIONS (Show whether OF, RT, GR, etc.)
	3943.7' GR

5. LEASE DESIGNATION AND SERIAL NO.
NM 18821
6. IF INDIAN, ALLOTTEE OR TRIBE NAME
---
7. UNIT AGREEMENT NAME
---
8. FARM OR LEASE NAME
North Haystack Federal
9. WELL NO.
1
10. FIELD AND POOL, OR WILDCAT
Wildcat No. 1
11. SEC., T., R., M., OR BLK. AND SURVEY OR AREA
Section 26-5S-26E
12. COUNTY OR PARISH
Chaves
13. STATE
N.M.

16. Check Appropriate Box To Indicate Nature of Notice, Report, or Other Data

NOTICE OF INTENTION TO:		SUBSEQUENT REPORT OF:	
TEST WATER SHUT-OFF	<input type="checkbox"/>	WATER SHUT-OFF	<input type="checkbox"/>
FRACTURE TREAT	<input type="checkbox"/>	FRACTURE TREATMENT	<input type="checkbox"/>
SHOOT OR ACIDIZE	<input type="checkbox"/>	SHOOTING OR ACIDIZING	<input type="checkbox"/>
REPAIR WELL	<input type="checkbox"/>	(Other)	<input type="checkbox"/>
PULL OR ALTER CASING	<input type="checkbox"/>	(NOTE: Report results of multiple completion on Well Completion or Recompletion Report and Log form.)	
MULTIPLE COMPLETE	<input type="checkbox"/>		
ABANDON*	<input type="checkbox"/>		
CHANGE PLANS	<input type="checkbox"/>		
(Other) Change in drilling contractor	<input checked="" type="checkbox"/>		

17. DESCRIBE PROPOSED OR COMPLETED OPERATIONS (Clearly state all pertinent details, and give pertinent dates, including estimated date of starting any proposed work. If well is directionally drilled, give subsurface locations and measured and true vertical depths for all markers and zones pertinent to this work.)\*

Well is currently being drilled by a cable tool drilling rig. The original application to drill was filed showing WEK Drilling Company as the drilling contractor. WEK will not drill this well, the correct drilling contractor will be Warton Drilling Company, Rig #8. Attached is the Pad drawing for Rig #8.

BOP Program: Rig will be equipped with a 10" 900 Cameron SS Double blowout preventer with a 4 stage double Payne Closing Unit.

The rotary rig will move in approximately November 20, 1980.

RECEIVED  
NOV 4 1980  
U.S. GEOLOGICAL SURVEY  
ARTESIA, NEW MEXICO

18. I hereby certify that the foregoing is true and correct

SIGNED <u>Pharis Barnette</u>	TITLE <u>Authorized Agent</u>	DATE <u>10-31-80</u>
(This space for Federal or State office use)		
(Orig. Sgd.) <u>PETER W. CHESTER</u>	TITLE <u>ACTING DISTRICT ENGINEER</u>	DATE <u>NOV 5 1980</u>
APPROVED BY		
CONDITIONS OF APPROVAL, IF ANY:		

\*See Instructions on Reverse Side

Pad Drawing - Read & Stevens, Inc.  
#1 North Haystack Feder  
1980' FNL & 2030' FWL, Sec. 26-5S-26E  
Chaves County, NM

WARTON DRILLING COMPANY

Rig #3

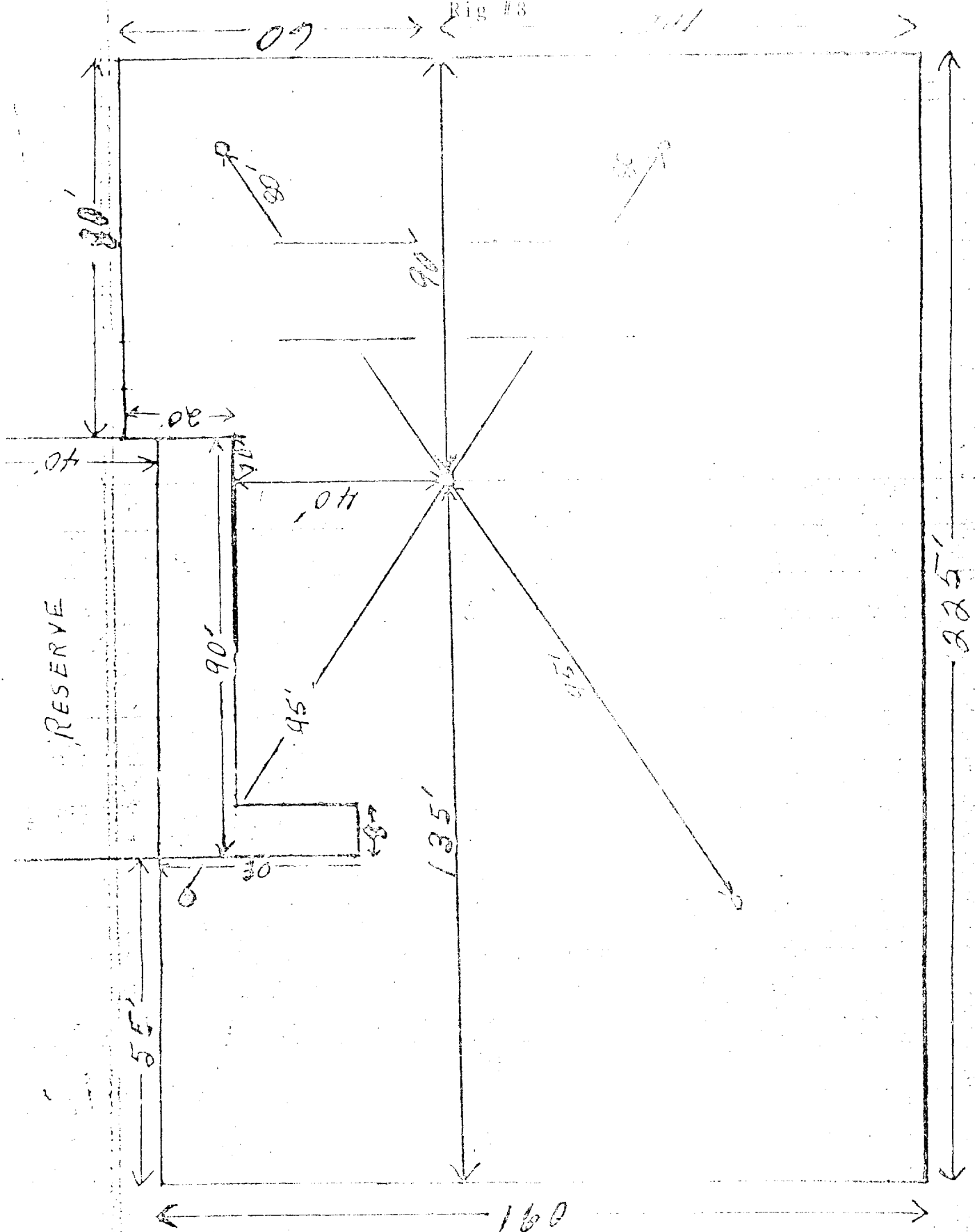

UNITED STATES  
DEPARTMENT OF THE INTERIOR

SEP 16 1980

30-005-60783

## GEOLOGICAL SURVEY

O. C. D.

## APPLICATION FOR PERMIT TO DRILL, DEEPEN, OR PLUG BACK

## 1a. TYPE OF WORK

DRILL ☒DEEPEN ☐PLUG BACK ☐

## b. TYPE OF WELL

OIL  
WELL ☐GAS  
WELL ☒

OTHER

SINGLE  
ZONE ☐MULTIPLE  
ZONE ☐

## 2. NAME OF OPERATOR

Read &amp; Stevens, Inc. ✓

## 3. ADDRESS OF OPERATOR

P. O. Box 1518 Roswell, New Mexico 88201

## 4. LOCATION OF WELL (Report location clearly and in accordance with any State requirements.)\*

At surface

1980' FNL and 2030' FWL

At proposed prod. zone

Same

## 14. DISTANCE IN MILES AND DIRECTION FROM NEAREST TOWN OR POST OFFICE\*

Approximately 46 miles northeast of Roswell, New Mexico

## 15. DISTANCE FROM PROPOSED\*

LOCATION TO NEAREST  
PROPERTY OR LEASE LINE, FT.  
(Also to nearest drlg. unit line, if any)

1980'

## 16. NO. OF ACRES IN LEASE

1440

17. NO. OF ACRES ASSIGNED  
TO THIS WELL

320

## 18. DISTANCE FROM PROPOSED LOCATION\*

TO NEAREST WELL, DRILLING, COMPLETED,  
OR APPLIED FOR, ON THIS LEASE, FT.

None

## 19. PROPOSED DEPTH

6700'

## 20. ROTARY OR CABLE TOOLS

Rotary

## 21. ELEVATIONS (Show whether DF, RT, GR, etc.)

3943.7 GR

## 22. APPROX. DATE WORK WILL START\*

September 15, 1980

## 23.

## PROPOSED CASING AND CEMENTING PROGRAM

SIZE OF HOLE	SIZE OF CASING	WEIGHT PER FOOT	SETTING DEPTH	QUANTITY OF CEMENT
17 1/2"	12 3/4"	34#	30'	50 Sx "C" Circulate to Surface
11"	8 5/8"	24#	1450'	700 Sx "H" " " "
7 7/8"	4 1/2"	10.5-11.6#	6700'	350 Sx Class "C"

## Mud Program:

- 0' - 30' Spud mud with Magcobar gel.  
30' - 1,450' Fresh water and native mud. Mud wt. 8.4, Visc. 30-32, no WL control.  
If seepage is noted add lost circulation material. If circulation is lost, drill dry to 1450' and set intermediate casing.  
1,450' - 4,500' Fresh water and native mud.  
4,500' - 5,700' Salt water gel, 4 % KCL, XPEL-G, Vis. 31-33, wt. 8.4-9.0# no WL control.  
5,700' - T.D. Salt water gel, 4 % KCL, XPEL-G, Vis. 31-45, Wt. 8.4-9.0# plus flosal.

BOP Program: Blowout preventor stack and casing head will be independently pressure tested before drilling into the Wolfcamp formation. A daily check of the blowout preventor system will be made from 5700' to Total Depth.

Gas Sales are not dedicated.

IN ABOVE SPACE DESCRIBE PROPOSED PROGRAM: If proposal is to deepen or plug back, give data on present productive zone and proposed new productive zone. If proposal is to drill or deepen directionally, give pertinent data on subsurface locations and measured and true vertical depths. Give blowout preventer program, if any.

## 24.

Agent for:

SIGNED

TITLE

Read &amp; Stevens, Inc.

DATE

Sept. 5, 1980

(This space for Federal or State office use)

PERMIT NO.

APPROVAL DATE

APPROVED BY

TITLE

ACTING DISTRICT ENGINEER

DATE

12 1980

\*See Instructions On Reverse Side

