

UNITED STATES
DEPARTMENT OF THE INTERIOR
GEOLOGICAL SURVEYSUBMIT IN TRIPPLICATE*
(Other instructions on re-
verse side)Form approved,
Budget Bureau No. 42-R1424.

5. LEASE DESIGNATION AND SERIAL NO.

NM 16094

6. IF INDIAN, ALLOTTEE OR TRIBE NAME

SUNDRY NOTICES AND REPORTS ON WELLS

(Do not use this form for proposals to drill or to deepen or plug back to a different reservoir.
Use "APPLICATION FOR PERMIT—" for such proposals.)

RECEIVED

1. OIL WELL ☒ GAS WELL ☐ OTHER

2. NAME OF OPERATOR

Southland Royalty Company /

3. ADDRESS OF OPERATOR

1100 Wall Towers West: Midland, Texas 79701

4. LOCATION OF WELL (Report location clearly and in accordance with any State requirements.*
See also space 17 below.)
At surface

1980' FSL & 1780' FEL Sec. 29, T-14-S, R-27-S

14. PERMIT NO.

15. ELEVATIONS (Show whether DF, RT, GR, etc.)

3434.6 GR

7. UNIT AGREEMENT NAME

8. FARM OR LEASE NAME

Hagerman Federal ~~29~~ Comm

9. WELL NO.

1

10. FIELD AND POOL, OR WILDCAT

Undesignated (San Andres)

11. SEC., T., R., M., OR BLK. AND
SURVEY OR AREA

Sec. 29, T-14-S, R-27-E

12. COUNTY OR PARISH

Chaves

13. STATE

New Mexico

16. Check Appropriate Box To Indicate Nature of Notice, Report, or Other Data

NOTICE OF INTENTION TO:

TEST WATER SHUT-OFF

FRACTURE TREAT

SHOOT OR ACIDIZE

REPAIR WELL

(Other)

PULL OR ALTER CASING

MULTIPLE COMPLETE

ABANDON*

CHANGE PLANS

SUBSEQUENT REPORT OF:

WATER SHUT-OFF

FRACTURE TREATMENT

SHOOTING OR ACIDIZING

(Other)

REPAIRING WELL

ALTERING CASING

ABANDONMENT*

Set 5 1/2" Production csg & PB
(NOTE: Report results of multiple completion on Well Completion or Recompletion Report and Log form.) to San

17. DESCRIBE PROPOSED OR COMPLETED OPERATIONS (Clearly state all pertinent details, and give pertinent dates, including estimated date of starting any proposed work. If well is directionally drilled, give subsurface locations and measured and true vertical depths for all markers and zones pertinent to this work.)* Andre:

Per verbal approval 12-2-80 from Peter Chester w/USGS, captioned well was PB as follows:
Spot 125 sxs Cl "C" cmt plug from 7150'-6800'. Spot 35 sxs Cl "C" cmt plug from 5637'-5537'. Spot 35 sxs Cl "C" cmt plug from 4630'-4530'. Spot 35 sxs Cl "C" cmt plug from 3885'-3785'.

Ran 63 jts 5 1/2", 14#, K-55, ST&C csg. Set @ 2600'. Cmt w/400 sxs 50-50 Poz Mix Cl "C" w/2% CaCl. PD @ 9:20 AM 12-4-80. Top cmt @ 1070' by Temp Survey.

18. I hereby certify that the foregoing is true and correct

SIGNED

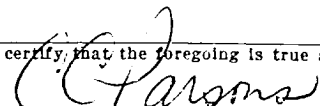

TITLE

District Operations Engineer

DATE

12-8-80

(This space for Federal or State office use)

APPROVED BY

CONDITIONS OF APPROVAL, IF ANY:

TITLE

DATE

**NEW MEXICO OIL CONSERVATION COMMISSION
WELL LOCATION AND ACREAGE DEDICATION PLAT**

Form C-102
Supersedes C-128
Effective 1-1-65

All distances must be from the outer boundaries of the Section

Operator Southland Royalty CO.			Lease Hagerman Fed. 29 Com.		Well No. 1
Unit Letter J	Section 29	Township 14 south	Range 27 east	County Chaves	
Actual Footage Location of Well: 1980 feet from the south line and 1780 feet from the east line					
Ground Level Elev. 3434.6	Producing Formation San Andres	Pool Undesignated		Dedicated Acreage: 40 Acres	

1. Outline the acreage dedicated to the subject well by colored pencil or hachure marks on the plat below.
2. If more than one lease is dedicated to the well, outline each and identify the ownership thereof (both as to working interest and royalty).
3. If more than one lease of different ownership is dedicated to the well, have the interests of all owners been consolidated by communitization, unitization, force-pooling, etc?

☐ Yes ☐ No If answer is "yes," type of consolidation _____

If answer is "no," list the owners and tract descriptions which have actually been consolidated. (Use reverse side of this form if necessary.) _____

No allowable will be assigned to the well until all interests have been consolidated (by communitization, unitization, forced-pooling, or otherwise) or until a non-standard unit, eliminating such interests, has been approved by the Commission.

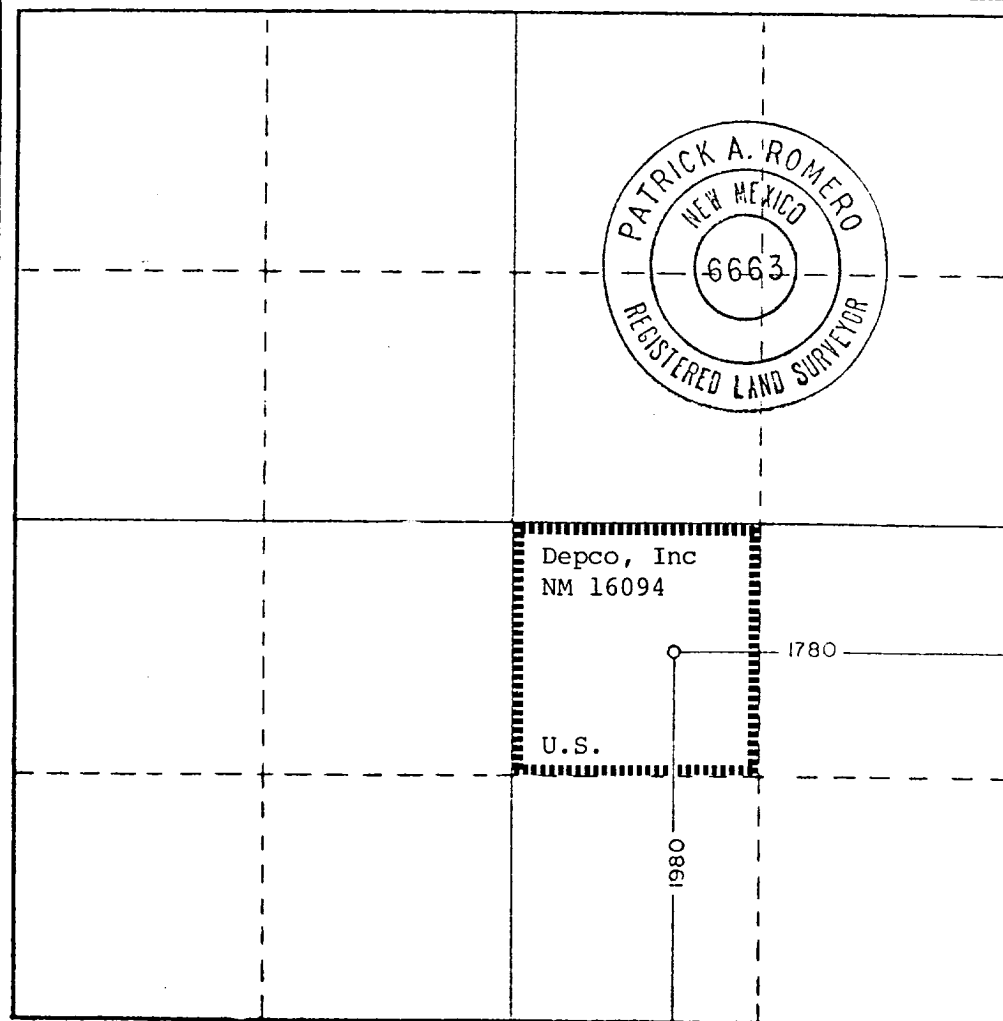

CERTIFICATION

I hereby certify that the information contained herein is true and complete to the best of my knowledge and belief.

Name *P. Parsons*
Position
District Operations Engineer
Company
Southland Royalty Company
Date
December 8, 1980

I hereby certify that the well location shown on this plat was plotted from field notes of actual surveys made by me or under my supervision, and that the same is true and correct to the best of my knowledge and belief.

Date Surveyed
9-15-80

Registered Professional Engineer and/or Land Surveyor

Patrick A. Romero

Certificate No. **JOHN W. WEST 678**
PATRICK A. ROMERO 6663