

NO. OF COPIES RECEIVED	
DISTRIBUTION	
SANTA FE	1
FILE	1
U.S.G.S.	2
LAND OFFICE	
OPERATOR	1

NEW MEXICO OIL CONSERVATION COMMISSION

RECEIVED

OCT 8 1980

O. C. D.

30-005-60789

Form C-101  
Revised 1-1-65

5A. Indicate Type of Lease	
STATE <input type="checkbox"/>	FEE <input checked="" type="checkbox"/>
5. State Oil & Gas Lease No.	

APPLICATION FOR PERMIT TO DRILL, ~~DEEPEN~~ OR PLUG BACK

1a. Type of Work		7. Unit Agreement Name	
b. Type of Well DRILL <input checked="" type="checkbox"/> DEEPEN <input type="checkbox"/> PLUG BACK <input type="checkbox"/> OIL WELL <input checked="" type="checkbox"/> GAS WELL <input type="checkbox"/> OTHER <input type="checkbox"/> SINGLE ZONE <input checked="" type="checkbox"/> MULTIPLE ZONE <input type="checkbox"/>		8. Farm or Lease Name Jack L	
2. Name of Operator McClellan Oil Corporation		9. Well No. 2	
3. Address of Operator P. O. Drawer 730, Roswell, New Mexico 88201		10. Field and Pool, or Wildcat Wildcat	
4. Location of Well UNIT LETTER M LOCATED 860 FEET FROM THE South LINE AND 560 FEET FROM THE West LINE OF SEC. 14 TWP. 6-S RGE. 27-E NMPM		12. County Chaves	
19. Proposed Depth 5100'		19A. Formation Abo	
20. Rotary or C.T. Rotary		21. Elevations (Show whether DE, RT, etc.) 4106 G.L.	
21A. Kind & Status Plug. Bond Statewide		21B. Drilling Contractor BAM Drilling Corp.	
22. Approx. Date Work will start 12/1/80			

PROPOSED CASING AND CEMENT PROGRAM

SIZE OF HOLE	SIZE OF CASING	WEIGHT PER FOOT	SETTING DEPTH	SACKS OF CEMENT	EST. TOP
17"	13-3/8"	54	30'	6 yds.	Surface
12-1/4"	8-5/8"	20	1450'	300 sx	Circulate
7-7/8"	7"	23	4700'	250 sx	4000'
6-1/4"	4 1/2" liner	10 1/2	4500-5100'	100 sx	4500'

Will drill to 4700' and run 7" casing. Will either drill with air or light mud from 4700' to 5100'. Will run 600' of 4 1/2" liner and attempt completion in the Abo formation. A diagrammatic sketch and description of the blow-out preventer is attached.

APPROVAL VALID  
FOR 90 DAYS UNLESS  
DRILLING COMMENCED,

EXPIRES 1-10-81

IN ABOVE SPACE DESCRIBE PROPOSED PROGRAM; IF PROPOSAL IS TO DEEPEN OR PLUG BACK, GIVE DATA ON PRESENT PRODUCTIVE ZONE AND PROPOSED NEW PRODUCTIVE ZONE. IF BLOWOUT PREVENTER PROGRAM, IF ANY.

I hereby certify that the information above is true and complete to the best of my knowledge and belief.

Signed James J. McClellan Title Operator Date 10/7/80

(This space for State Use)

APPROVED BY W.A. Gressett TITLE SUPERVISOR, DISTRICT II DATE OCT 10 1980

CONDITIONS OF APPROVAL, IF ANY:

Class C Cement must be circulated to surface behind 8 7/8" casing

# NEW MEXICO OIL & GAS LOCATION AND ACREAGE DEDICATION PLAT

Supersedes G-128  
Effective 1-1-65

All distances must be from the outer boundaries of the Section.

Operator <b>McClellan Oil Corp.</b>			Lease <b>Jack L</b>		Well No. <b>2</b>
Unit Letter <b>M</b>	Section <b>14</b>	Township <b>6 South</b>	Range <b>27 East</b>	County <b>Chaves</b>	
Actual Footage Location of Wells: <div> <div>860</div> <div>feet from the</div> <div>South</div> <div>line and</div> <div>560</div> <div>feet from the</div> <div>West</div> <div>line</div> </div>					
Ground Level Elev. <b>4106.2</b>	Producing Formation <b>Abo</b>	Pool <b>Wildcat</b>		Dedicated Acreage: <b>160</b> Acres	

1. Outline the acreage dedicated to the subject well by colored pencil or hachure marks on the plat below.
2. If more than one lease is dedicated to the well, outline each and identify the ownership thereof (both as to working interest and royalty).
3. If more than one lease of different ownership is dedicated to the well, have the interests of all owners been consolidated by communitization, unitization, force-pooling, etc?

☐ Yes ☐ No If answer is "yes," type of consolidation \_\_\_\_\_

If answer is "no," list the owners and tract descriptions which have actually been consolidated. (Use reverse side of this form if necessary.) \_\_\_\_\_

No allowable will be assigned to the well until all interests have been consolidated (by communitization, unitization, forced-pooling, or otherwise) or until a non-standard unit, eliminating such interests, has been approved by the Commission.

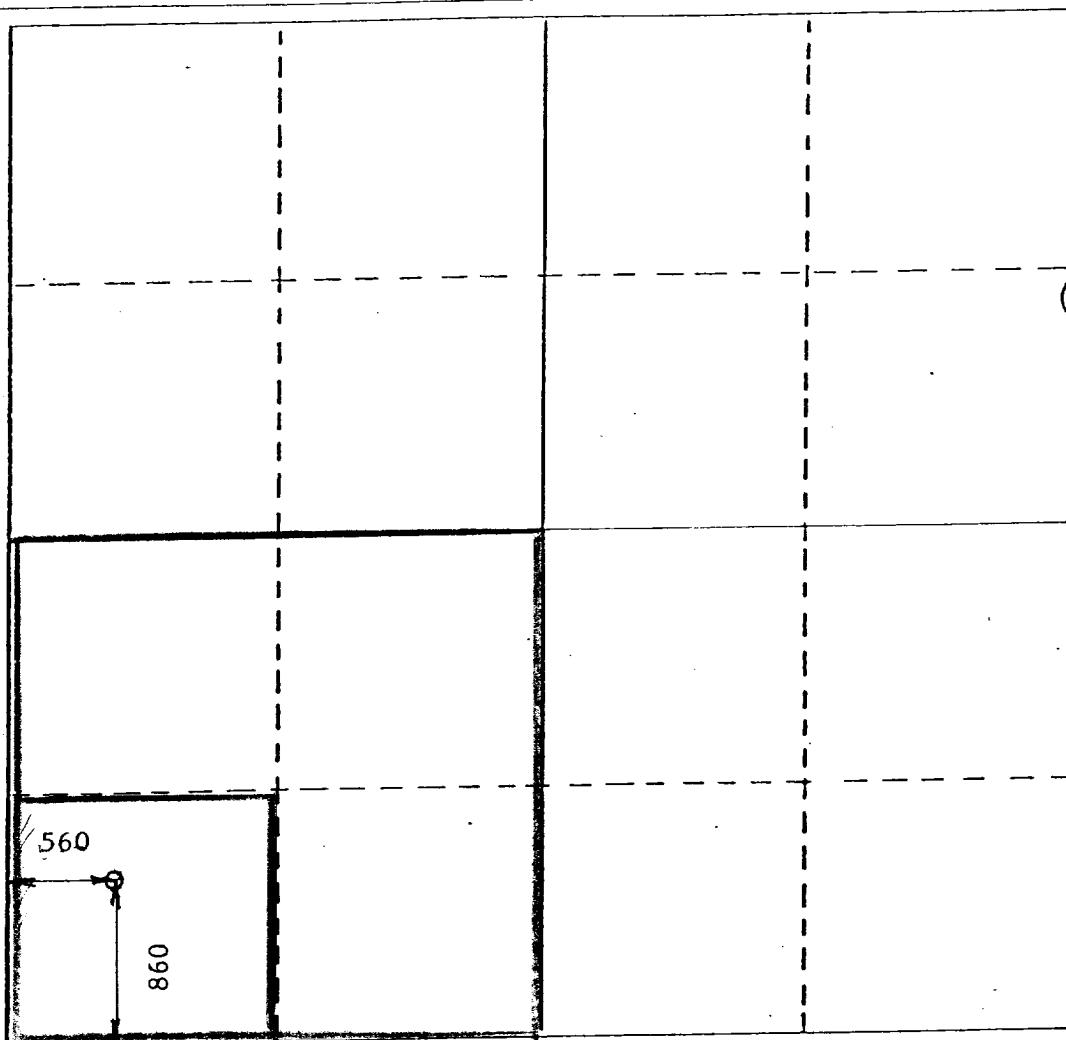

## CERTIFICATION

I hereby certify that the information contained herein is true and complete to the best of my knowledge and belief.

Name  
**Jack . McClellan**  
Position  
**President**  
Company  
**McClellan Oil Corporation**  
Date  
**Sept. 20, 1980**

I hereby certify that the well location shown on this plat was plotted from field notes of actual surveys made by me or under my supervision, and that the same is true and correct to the best of my knowledge and belief.

Date Surveyed  
**Sept. 20, 1980**  
Registered Professional Engineer and/or Land Surveyor  
**John D. Jaquess, P.E.**  
Certificate No.  
**6290**

0 330 660 990 1320 1650 1980 2310 2640 2970 3300 3630 3960 4290 4620 4950 5280 5610 5940 6270 6600

BAM Drilling Corporation  
Blowout Preventer Specifications

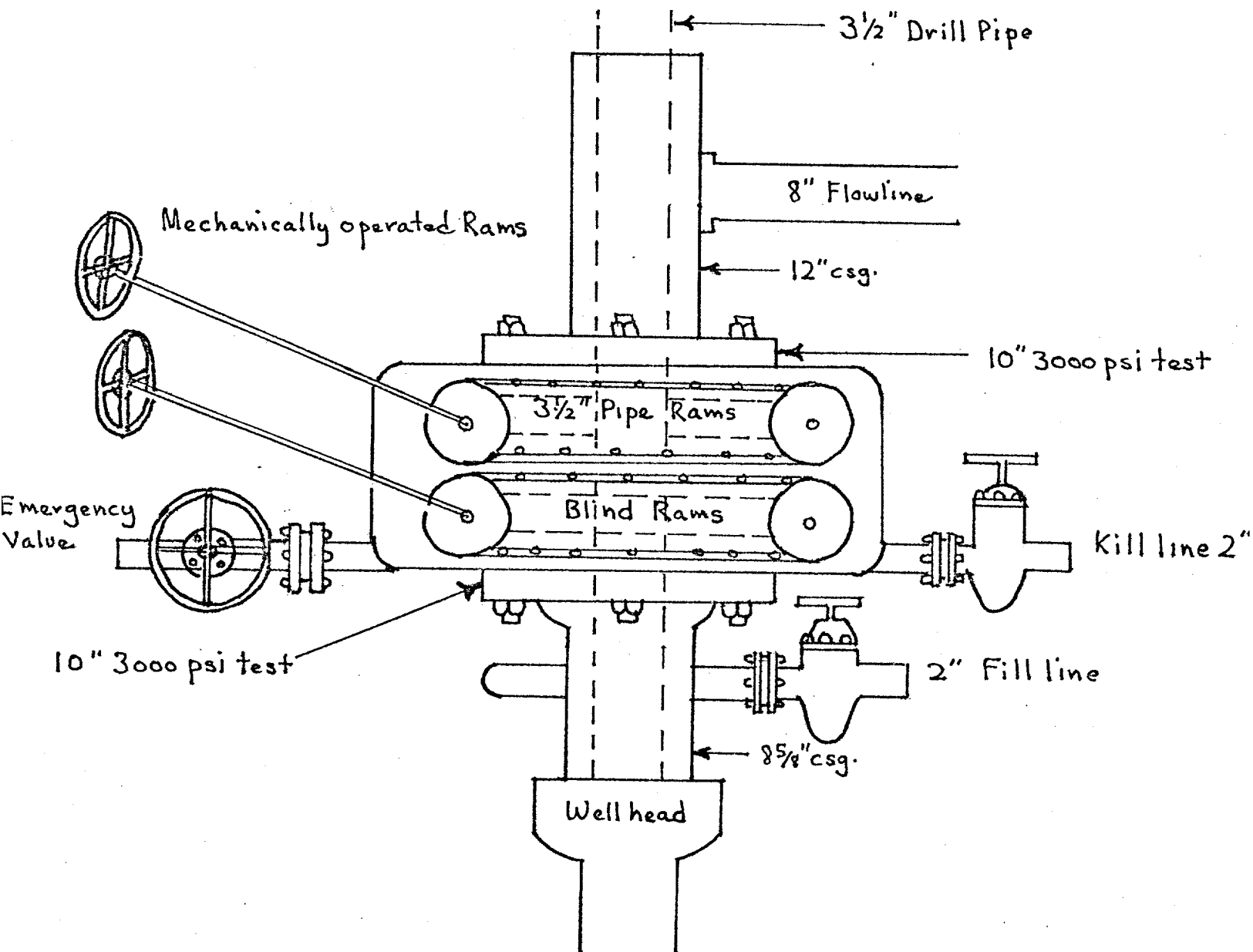

BOP's are Shaffer Double Rams Series 900, 10 inch. mechanically operated. Rated to 3000 psi. Rams consist of one 3 1/2 inch pipe rams and one blind rams. All connections and valves are 3000 psi working pressure.