

NO. OF COPIES RECEIVED	
DISTRIBUTION	
SANTA FE	1
FILE	1
U.S.G.S.	1
LAND OFFICE	1
OPERATOR	1

NEW MEXICO OIL CONSERVATION COMMISSION

RECEIVED

30-005-60808

Form C-101  
Revised 1-1-85

NOV 07 1980

NOV 11 1980

C & K PETROLEUM, INC.  
Midland, Texas

5A. Indicate Type of Lease
STATE <input checked="" type="checkbox"/> FEE <input type="checkbox"/>
5. State Oil & Gas Lease No.
L-5018

APPLICATION FOR PERMIT TO DRILL, DEEPEN, OR PLUG BACK

1a. Type of Work		7. Unit Agreement Name	
DRILL <input checked="" type="checkbox"/> DEEPEN <input type="checkbox"/> PLUG BACK <input type="checkbox"/>		White Draw Unit	
b. Type of Well		8. Farm or Lease Name	
OIL WELL <input type="checkbox"/> GAS WELL <input checked="" type="checkbox"/> OTHER <input type="checkbox"/> SINGLE ZONE <input type="checkbox"/> MULTIPLE ZONE <input type="checkbox"/>		White Draw Unit	
2. Name of Operator		9. Well No.	
C & K Petroleum, Inc.		#1	
3. Address of Operator		10. Field and Pool, or Wildcat	
P. O. Drawer 3546 Midland, Texas 79702		Wildcat	
4. Location of Well		12. County	
UNIT LETTER G LOCATED 1980 FEET FROM THE North LINE		Chaves	
AND 1980 FEET FROM THE East LINE OF SEC. 14 TWP. 3-S RGE. 27-E NMPM			
19. Proposed Depth		19A. Formation	
5500		Abo	
20. Rotary or C.T.*		Rotary & C.T.*	
21. Elevations (show whether DE, RI, etc.)		22. Approx. Date Work will start	
4008.0		your approval	
21A. Kind & Status Plug. Bond			
Blanket-Active			
21B. Drilling Contractor			
Pending			

PROPOSED CASING AND CEMENT PROGRAM

SIZE OF HOLE	SIZE OF CASING	WEIGHT PER FOOT	SETTING DEPTH	SACKS OF CEMENT	EST. TOP
12-1/4"	8-5/8	24#	1500	1000	Circ.
7-7/8"	4-1/2	10.5#	5500	250	4500

NOTE: 13-3/8" Conductor pipe to be set @ 40'.

Blowout Preventer Program: Will use 10" 3000# WP with Double Rams and 3000# choke manifold. Choke manifold and BOP to be tested to 1500#.

\*NOTE: Will spud with C.T.

NOTE: Cities Service has first call on gas purchase.

APPROVAL VALID  
FOR 90 DAYS UNLESS  
DRILLING COMMENCED,

EXPIRES 2-14-81

IN ABOVE SPACE DESCRIBE PROPOSED PROGRAM: IF PROPOSAL IS TO DEEPEN OR PLUG BACK, GIVE DATA ON PRESENT PRODUCTIVE ZONE AND PROPOSED NEW PRODUCTIVE ZONE. GIVE BLOWOUT PREVENTER PROGRAM, IF ANY.

I hereby certify that the information above is true and complete to the best of my knowledge and belief.

Signed W. A. Gressett Title Adm. Supervisor Date 10/28/80

(This space for State Use)

APPROVED BY W. A. Gressett TITLE SUPERVISOR, DISTRICT II DATE NOV 14 1980

CONDITIONS OF APPROVAL, IF ANY:

Cement must be circulated to  
surface behind 13 3/8" & 8 5/8" casing

NEW MEXICO OIL CONSERVATION COMMISSION  
WELL LOCATION AND ACREAGE DEDICATION PLAT

Form C-102  
Supersedes C-128  
Effective 1-1-65

All distances must be from the outer boundaries of the Section

Operator <b>C&amp;K Petroleum Inc.</b>			Lease <b>White Draw Unit</b>		Well No. <b>1</b>
Section <b>G</b>	Section <b>14</b>	Township <b>3 South</b>	Range <b>27 East</b>	County <b>Chaves</b>	
Approximate Location of Well: <b>1980</b> feet from the <b>north</b> line and <b>1980</b> feet from the <b>east</b> line					
Well Depth (feet) <b>4008.0</b>	Producing Formation <b>Abo</b>	Pool <b>Wildcat</b>	Dedicated Acreage: <b>160</b> Acres		

- Outline the acreage dedicated to the subject well by colored pencil or hatchure marks on the plat below.
- If more than one lease is dedicated to the well, outline each and identify the ownership thereof (both as to working interest and royalty).
- If more than one lease of different ownership is dedicated to the well, have the interests of all owners been consolidated by communitization, unitization, force-pooling, etc?

☒ Yes ☐ No If answer is "yes," type of consolidation Unitization

If answer is "no," list the owners and tract descriptions which have actually been consolidated. (Use reverse side of this form if necessary.)

No allowable will be assigned to the well until all interests have been consolidated (by communitization, unitization, forced-pooling, or otherwise) or until a non-standard unit, eliminating such interests, has been approved by the Commission.

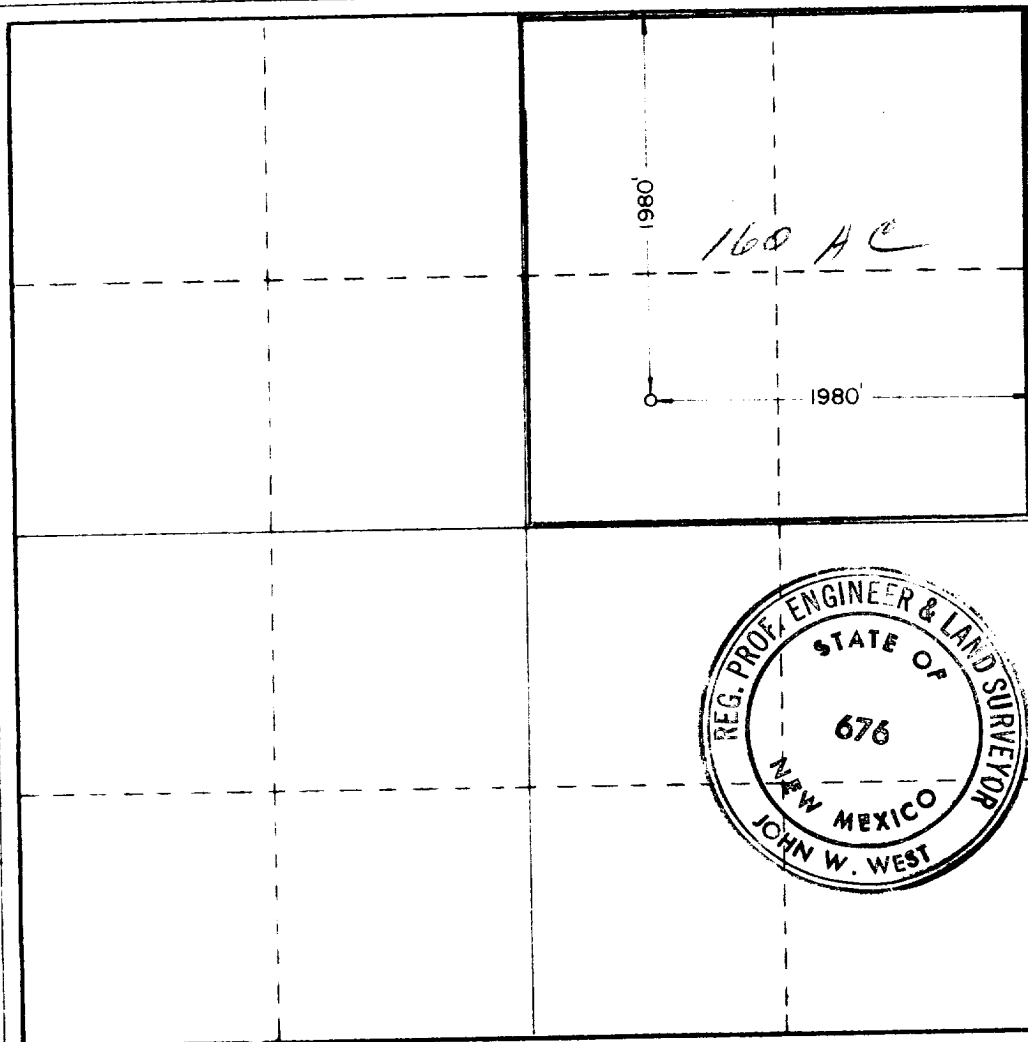

CERTIFICATION

I hereby certify that the information contained herein is true and complete to the best of my knowledge and belief.

Name [Signature]  
Position  
Adm. Supervisor  
Company  
C & K Petroleum, Inc.  
Date  
Nov. 3, 1980

I hereby certify that the well location shown on this plat was plotted from field notes of actual surveys made by me or under my supervision, and that the same is true and correct to the best of my knowledge and belief.

Date Surveyed  
Oct. 21, 1980  
Registered Professional Engineer and/or Land Surveyor  
[Signature]  
Certificate No. JOHN W. WEST 676  
PATRICK A. ROMERO 6863  
Ronald J. Eidson 3239

0 330 660 990 1320 1650 1980 2310 2640 2000 1800 1000 800 0