

Form 9-331C  
(May 1963)

SUBMIT IN THE CATEGORY\*  
(Other instructions on reverse side)

Form approved.  
Budget Bureau No. 42-R1425.

30-005-60813

UNITED STATES  
DEPARTMENT OF THE INTERIOR  
GEOLOGICAL SURVEY

APPLICATION FOR PERMIT TO DRILL, DEEPEN, OR PLUG BACK

1a. TYPE OF WORK

DRILL ☒

DEEPEN ☐

PLUG BACK ☐

b. TYPE OF WELL

OIL WELL ☒

GAS WELL ☐

OTHER ☐

SINGLE ZONE ☒

MULTIPLE ZONE ☐

2. NAME OF OPERATOR

Inexco Oil Company

3. ADDRESS OF OPERATOR

Suite 1900, Milam Bldg., Houston, Texas 77002

4. LOCATION OF WELL (Report location clearly and in accordance with any State requirements.)\*

At surface

660' FNL & 1980' FWL

At proposed prod. zone

1780'

14. DISTANCE IN MILES AND DIRECTION FROM NEAREST TOWN OR POST OFFICE\*

12 miles East of Hagerman, New Mexico

15. DISTANCE FROM PROPOSED\* LOCATION TO NEAREST PROPERTY OR LEASE LINE, FT.

(Also to nearest drlg. unit line, if any) 660'

16. NO. OF ACRES IN LEASE

320

17. NO. OF ACRES ASSIGNED TO THIS WELL

220 40

18. DISTANCE FROM PROPOSED LOCATION\* TO NEAREST WELL, DRILLING, COMPLETED, OR APPLIED FOR, ON THIS LEASE, FT.

NA

19. PROPOSED DEPTH

9200

20. ROTARY OR CABLE TOOLS

Rotary

21. ELEVATIONS (Show whether DF, RT, GR, etc.)

3634.3 G.L.

22. APPROX. DATE WORK WILL START\*

10/25/80

23.

PROPOSED CASING AND CEMENTING PROGRAM

SIZE OF HOLE	SIZE OF CASING	WEIGHT PER FOOT	SETTING DEPTH	QUANTITY OF CEMENT
17-1/2"	13-3/8"	61 lbs.	400	425 sx. circ.
12-1/4"	9-5/8"	43 1/2 lbs.	2300	700 sx. circ.
7-7/8"	5-1/2"	15 1/2 lbs.	9200	700 sx.

Will drill to approximately 9200' to test the Mississippian. If production is indicated, will set casing and attempt completion.

RECEIVED

Estimated Geologic tops are as follows:

San Andres 2000  
Glorieta 3300  
Abo 5400  
Atoka 8600  
Morrow 8700  
Miss. (Chester) 8900

NOV 14 1980

RECEIVED

OCT 14 1980

O. C. O.  
ARTESIA, OFFICE

U.S. GEOLOGICAL SURVEY  
ARTESIA, NEW MEXICO

WAS NOT DEDICATED.

Mud Program: Drill with native mud to 2300'. Mud-up @ top of Abo w/38-40 vis., 9 lb. salt base mud; 5100' - maintain 38-40 vis. with salt gel mud, 6% oil & 9-10 lb. & water loss 10-15 cc.

IN ABOVE SPACE DESCRIBE PROPOSED PROGRAM: If proposal is to deepen or plug back, give data on present productive zone and proposed new productive zone. If proposal is to drill or deepen directionally, give pertinent data on subsurface locations and measured and true vertical depths. Give blowout prevention program, if any.

24.

SIGNED

George H. Stewart

TITLE

Agent

DATE

10/3/80

(This space for Federal or State office use)

PERMIT NO.

APPROVAL DATE

(Orig. Sgd.) GEORGE H. STEWART

APPROVED BY

ACTING DISTRICT ENGINEER

DATE

OCT 30 1980

CONDITIONS OF APPROVAL, IF ANY:

N.M.C.G.D. COPY  
N.M.C.G.D. COPY  
UNITED STATES  
DEPARTMENT OF THE INTERIOR  
GEOLOGICAL SURVEY

SUBMIT IN TRIPLICATE\*  
(Other instructions on reverse side)

Form approved.  
Budget Bureau No. 42-R1424.

**SUNDRY NOTICES AND REPORTS ON WELLS**

(Do not use this form for proposals to drill or to deepen or plug back to a different location. Use "APPLICATION FOR PERMIT—" for such proposals.)

1. <input type="checkbox"/> OIL WELL <input checked="" type="checkbox"/> GAS WELL <input type="checkbox"/> OTHER		NOV 14 1980 O. C. D. ARTESIA, OFFICE	
2. NAME OF OPERATOR Inexco Oil Company		8. FARM OR LEASE NAME McClellan Federal	
3. ADDRESS OF OPERATOR Suite 1900, Milam Bldg., Houston, Texas 77002		9. WELL NO. 1	
4. LOCATION OF WELL (Report location clearly and in accordance with any State requirements.* See also space 17 below.) At surface 660 FNL & 1780 FWL		10. FIELD AND POOL, OR WILDCAT Wildcat	
14. PERMIT NO.		11. SEC., T., E., M., OR BLK. AND SURVEY OR AREA Sec. 31-T13S-R29E	
15. ELEVATIONS (Show whether DF, RT, GR, etc.) 3634 G.L.		12. COUNTY OR PARISH Chaves	
		13. STATE NM	

16. Check Appropriate Box To Indicate Nature of Notice, Report, or Other Data

NOTICE OF INTENTION TO:		SUBSEQUENT REPORT OF:	
TEST WATER SHUT-OFF <input type="checkbox"/>	PULL OR ALTER CASING <input type="checkbox"/>	WATER SHUT-OFF <input type="checkbox"/>	REPAIRING WELL <input type="checkbox"/>
FRACTURE TREAT <input type="checkbox"/>	MULTIPLE COMPLETE <input type="checkbox"/>	FRACTURE TREATMENT <input type="checkbox"/>	ALTERING CASING <input type="checkbox"/>
SHOOT OR ACIDIZE <input type="checkbox"/>	ABANDON* <input type="checkbox"/>	SHOOTING OR ACIDIZING <input type="checkbox"/>	ABANDONMENT* <input type="checkbox"/>
REPAIR WELL <input type="checkbox"/>	CHANGE PLANS <input checked="" type="checkbox"/>	(Other) <input type="checkbox"/>	
(Other) Move location		(NOTE: Report results of multiple completion on Well Completion or Recompletion Report and Log form.)	

17. DESCRIBE PROPOSED OR COMPLETED OPERATIONS (Clearly state all pertinent details, and give pertinent dates, including estimated date of starting any proposed work. If well is directionally drilled, give subsurface locations and measured and true vertical depths for all markers and zones pertinent to this work.)\*

Request approval of change of location as previously approved from 660 FNL & 1980 FWL to 660 FNL & 1780 FWL. This change of location is necessitated by the presence of an oil pipeline in close proximity to the present location.

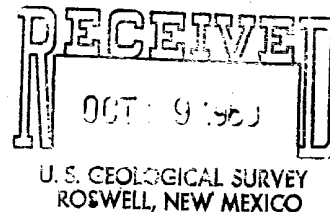

18. I hereby certify that the foregoing is true and correct

SIGNED <u>George H. Stewart</u> (This space for Federal or State office use) (Orig. Sgd.) GEORGE H. STEWART	TITLE <u>Agent</u>	DATE <u>10/28/80</u>
APPROVED BY <u>ACTING DISTRICT ENGINEER</u> CONDITIONS OF APPROVAL, IF ANY:	TITLE <u>ACTING DISTRICT ENGINEER</u>	DATE <u>OCT 30 1980</u>

# WELL LOCATION AND ACREAGE DEDICATION PLAT

Supersedes C-128  
Effective 1-1-65

All distances must be from the outer boundaries of the section.

Operator <b>Inexco Oil Company</b>		Lease <b>McClellan Federal</b>		Well No. <b>1</b>
Unit Letter	Section <b>31</b>	Township <b>13 South</b>	Range <b>29 East</b>	County <b>Chaves</b>
Actual Footage Location of Well:				
660 feet from the North		line and 1780		feet from the West line
Ground Level Elev. <b>3634</b>	Producing Formation <b>Morrow (Penn)</b>		Pool <b>Wildcat</b>	Dedicated Acreage: <b>320 40</b> Acres

1. Outline the acreage dedicated to the subject well by colored pencil or hatchure marks on the plat below.
2. If more than one lease is dedicated to the well, outline each and identify the ownership thereof (both as to working interest and royalty).
3. If more than one lease of different ownership is dedicated to the well, have the interests of all owners been consolidated by communitization, unitization, force-pooling, etc?

☐ Yes ☐ No If answer is "yes," type of consolidation \_\_\_\_\_

If answer is "no," list the owners and tract descriptions which have actually been consolidated. (Use reverse side of this form if necessary.) \_\_\_\_\_

No allowable will be assigned to the well until all interests have been consolidated (by communitization, unitization, forced-pooling, or otherwise) or until a non-standard unit, eliminating such interests, has been approved by the Commission.

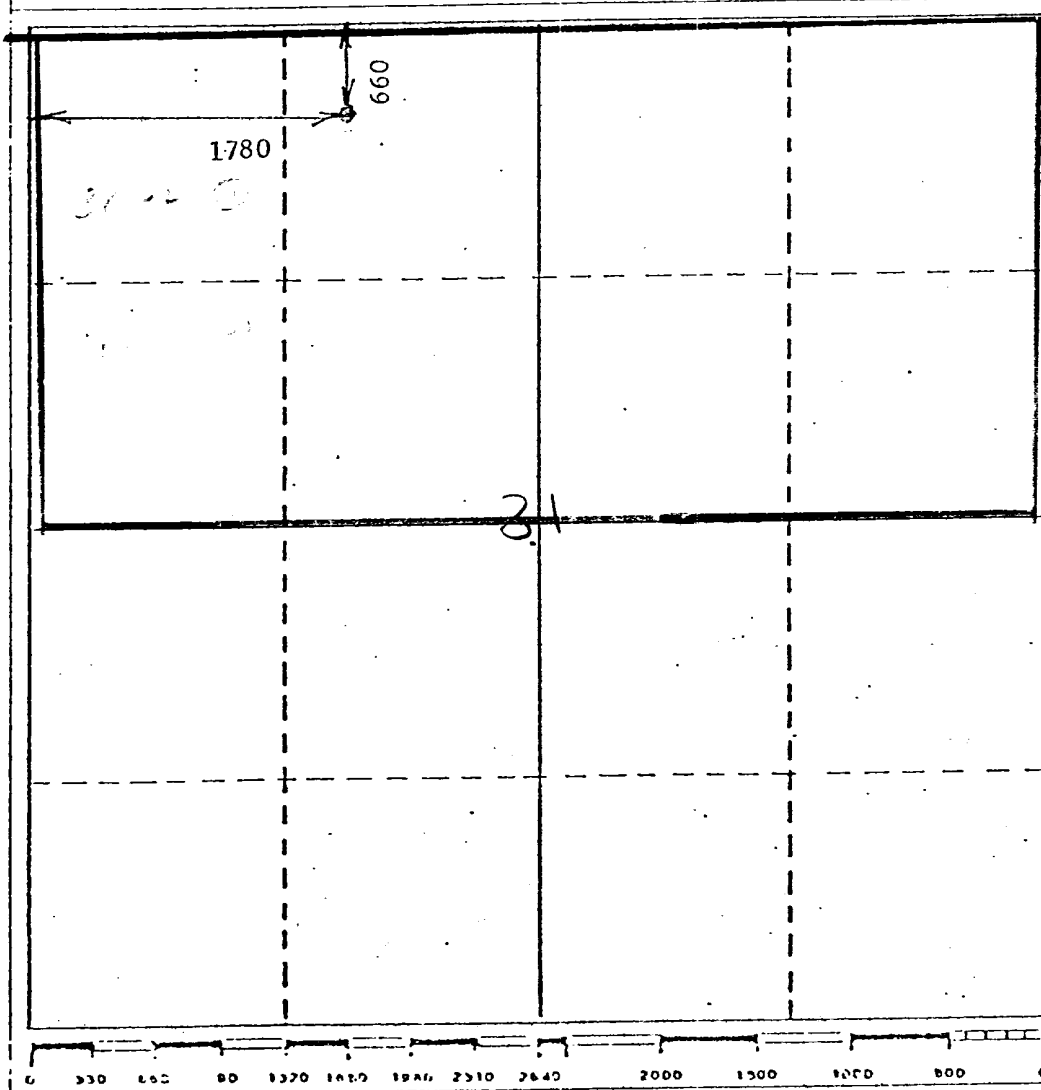

## CERTIFICATION

I hereby certify that the information contained herein is true and complete to the best of my knowledge and belief.

Name  
**Jack L. McClellan**  
Position  
**Agent**

Company  
**Inexco Oil Co.**

Date  
**10/28/80**

I hereby certify that the well location shown on this plat was plotted from field notes of actual surveys made by me or under my supervision, and that the same is true and correct to the best of my knowledge and belief.

Date Surveyed  
**October 28, 1980**

Registered Professional Engineer and/or Land Surveyor

**John B. Jaquess, P.E. & L.S.**

Certificate No.  
**6290**

## SURFACE USE PLAN

Inexco Oil Company #1 McClellan Federal  
1780'FWL & 660' FNL Section 31, T14S-R29E  
Chaves County, New Mexico  
Federal Lease NM 12561

1. Existing Roads

Exhibit "A" is a portion of the Chaves County road map of the New Mexico State Highway Department, showing the proposed well site in relation to nearby highways and ranch-oil field roads. U. S. Highway 31 will be used for 12.6 miles from Hagerman to the oil-ranch road. This highway is maintained by the State of New Mexico. The oil field-ranch road will be used for approximately 6.5 miles. This road is constructed of caliche, is approximately 12' to 35' in width and is maintained by the county, area ranchers, and oil operators who utilize this road. All roads and highways to be used are marked in yellow and the proposed well site and nearby towns are marked in red.

2. Planned Access Road

Exhibit "B" shows the ranch and oil field roads. The new road to be constructed is marked in red and is approximately 400' in length. Approximately 6.5 miles of existing ranch road will be utilized (shown in yellow on Exhibit "B"). This road is approximately 12' to 15' wide. Existing fences will be left intact.

3. Location of Existing Wells

Exhibit "C" shows all of the producing wells within 2 miles of the proposed test with ownership of various tracts.

4. Location of Tank Battery, Production Facilities & Production Gathering & Service Lines

If gas production is achieved the location of the line will be determined by the purchaser laying in the gathering system to his existing gas lines.

5. Location and Type of Water Supply

There is no useable water in this area. All water needed for drilling, testing, and completion will be trucked in by a commercial transport on existing roads as shown on Exhibit "A".

6. Source of Construction Materials

It will be necessary to use caliche on new road and location. This material will be obtained from the pits when they are constructed.

7. Handling of Waste Disposal

All waste material remaining after the drilling of this well will be placed in mud pit as shown on Exhibit "D". Any combustible or biochemically degradable material will be placed in the "burn and trash pit".

8. Ancillary Facilities

No ancillary facilities are planned.

9. Well Site Layout  
This information is shown on Exhibit "D".
10. Plan for Restoration of Surface  
All pits will be filled in and leveled. Deadmen will be removed. The access road and location will be restored as near as possible to its natural state following instructions from appropriate governmental agency, if well is abandoned; otherwise the location will be cleared and maintained in an orderly manner.
11. Other Information  
No unusual topography exists on the well site or access roads and the surface is comprised of Exhibit "B".
12. Operator Representatives
- |                              |                |        |
|------------------------------|----------------|--------|
| A. W. Cook                   | (713) 651-3432 | Office |
| 1100 Milam Bldg., Suite 1900 | (713) 370-2164 | Home   |
| Houston, Texas 77002         |                |        |
13. Certification  
I certify that I, or persons under my direct supervision, have inspected the proposed drill site and access route; that I am familiar with the conditions which presently exist; that the statements made in this plan are, to the best of my knowledge, true and correct; and that the work associated with the operations proposed herein will be performed by McClellan Oil Corporation and its contractors and subcontractors in conformity with this plan and the terms and conditions under which it is approved.

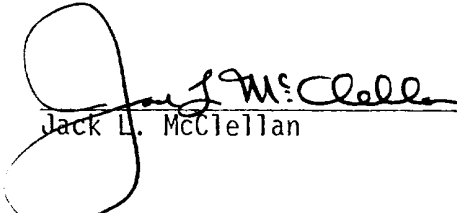
  
\_\_\_\_\_  
Jack L. McClellan

REQUIREMENTS  
(NTL-6)

1. Location: 660' FNL & 1780' FWL Section 31, T14S, R29E, Chaves Co., New Mexico
2. Elevation: 3634.3 G.L.
3. Geologic name of surface formation: Unknown
4. Type of drilling rig and associated equipment: Rotary - Warton Drilling Co.  
Rig #4
5. Proposed drilling depth and objective formation: 9200' Mississippian
6. Estimated tops of geologic markers:

Yates _____	San Andres <u>2000'</u>	Abo <u>5400'</u>
7-Rivers _____	Glorieta <u>3300'</u>	Atoka <u>8600'</u>
Queen _____	Tubb _____	Morrow <u>8700'</u>
		Miss.(Chester) <u>8900'</u>
7. Estimated depths of any oil, water, or gas: Gas 8700'
- 8-9. Proposed casing program:

<u>13-3/8"</u>	@ <u>400'</u>	Grade <u>J-55</u>	Wt. <u>61 lbs</u>	Type Cement <u>425 sx Class "C"</u>	Circ. _____
<u>9-5/8"</u>	@ <u>2300'</u>	Grade <u>J-55</u>	Wt. <u>43½ lbs</u>	Type Cement <u>700 sx Class "C"</u>	Circ. _____
<u>5-1/2"</u>	@ <u>9200'</u>	Grade <u>J-55</u>	Wt. <u>15½ lbs</u>	Type Cement <u>700 sx Class "C"</u>	Circ. _____
10. Specifications for pressure control equipment and testing procedures: See  
attached diagram. Yellow jacket test will be made at approximately 3000'.
11. Type and characteristics of drilling fluids: Native mud to 2300'. Mud-up at top of  
Abo w/38-40 vis. 9 lb. salt base - At 5100', use salt base gel, 6% oil. Wtr. loss 10-15cc.
12. Testing, logging, and coring programs: Will DST any shows encountered in test that  
are justified in the operators judgement. No coring is anticipated.
13. Anticipated abnormal pressures or temperature: None
14. Anticipated commencement and completion date: October 25, 1980 - December 15, 1980
15. Other pertinent information: \_\_\_\_\_

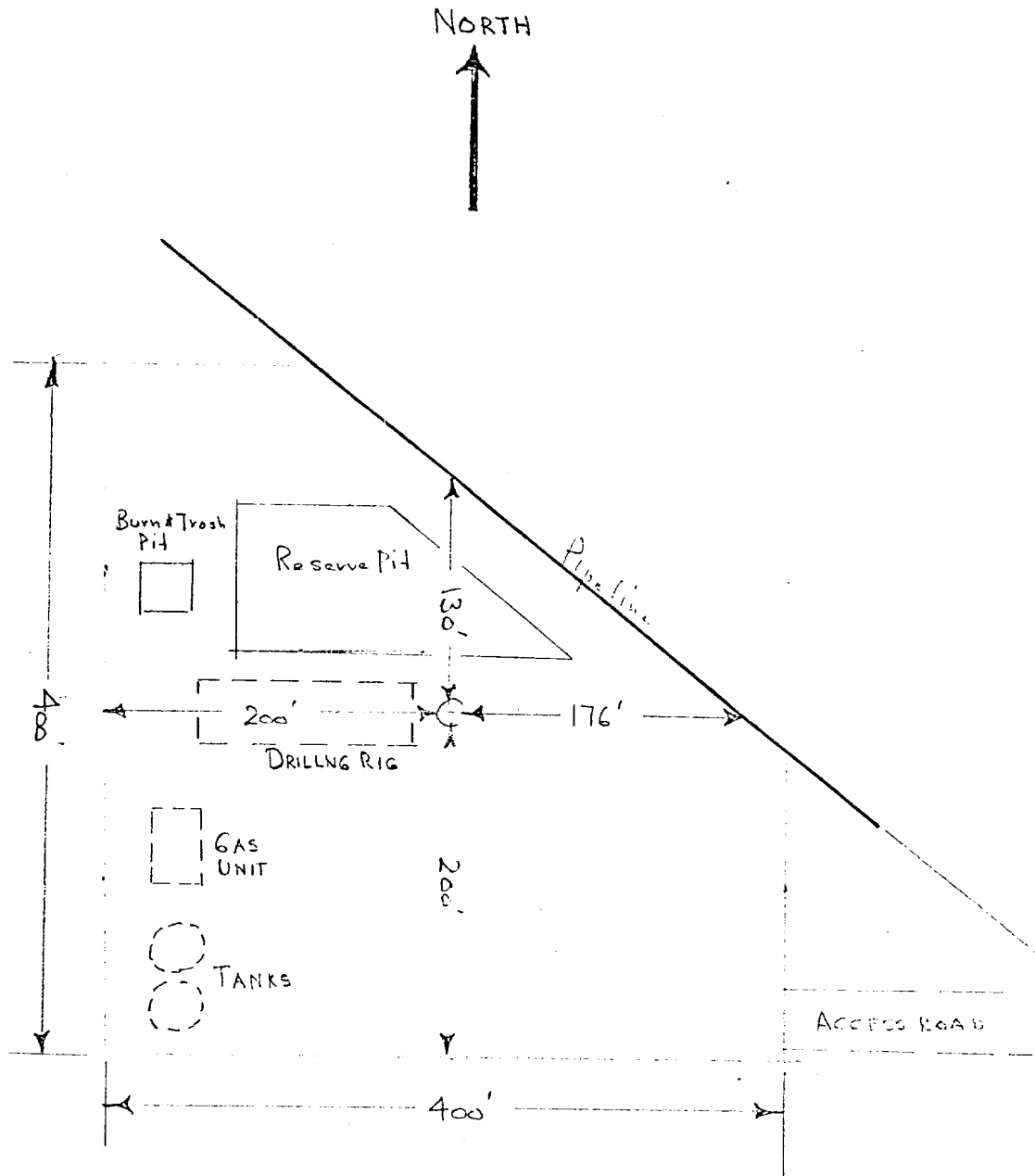

# NEW MEXICO OIL CONSERVATION COMMISSION WELL LOCATION AND ACREAGE DEDICATION PLAT

Supersedes C-128  
Effective 1-1-65

All distances must be from the outer boundaries of the Section.

Operator <b>Inexco Oil Company</b>		Lease <b>McClellan Federal #4</b>		Well No. <b>1</b>
Unit Letter	Section <b>31</b>	Township <b>13 South</b>	Range <b>29 East</b>	County <b>Chaves</b>
Actual Footage Location of Well:				
660 feet from the North line and		1980 feet from the West line		
Ground Level Elev. <b>3634.3</b>	Producing Formation <b>Morrow (Penn)</b>		Pool <b>Wildcat</b>	Dedicated Acreage: <b>320</b> Acres

1. Outline the acreage dedicated to the subject well by colored pencil or hatchure marks on the plat below.
2. If more than one lease is dedicated to the well, outline each and identify the ownership thereof (both as to working interest and royalty).
3. If more than one lease of different ownership is dedicated to the well, have the interests of all owners been consolidated by communitization, unitization, force-pooling, etc?

☐ Yes ☐ No If answer is "yes," type of consolidation \_\_\_\_\_

If answer is "no," list the owners and tract descriptions which have actually been consolidated. (Use reverse side of this form if necessary.) \_\_\_\_\_

No allowable will be assigned to the well until all interests have been consolidated (by communitization, unitization, forced-pooling, or otherwise) or until a non-standard unit, eliminating such interests, has been approved by the Commission.

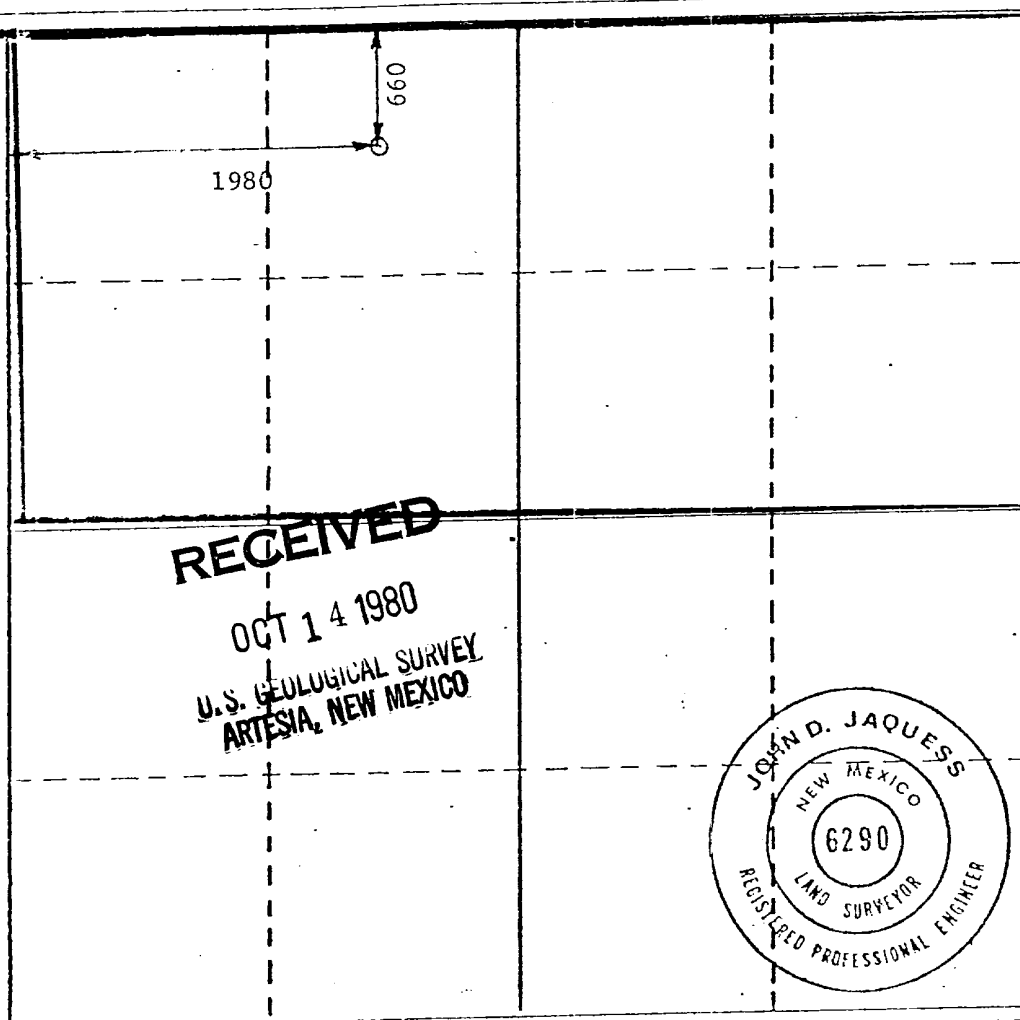

## CERTIFICATION

I hereby certify that the information contained herein is true and complete to the best of my knowledge and belief.

*Jack L. McClellan*  
Name

Jack L. McClellan  
Position

Agent

Company

Inexco Oil Company

Date

October 4, 1980

I hereby certify that the well location shown on this plat was plotted from field notes of actual surveys made by me or under my supervision, and that the same is true and correct to the best of my knowledge and belief.

Date Surveyed

October 3, 1980

Registered Professional Engineer and/or Land Surveyor

*John D. Jaquess*  
John D. Jaquess, P.E. & L.S.

Certificate No.

6290

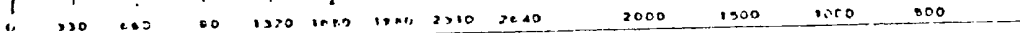





# United States Department of the Interior

GEOLOGICAL SURVEY

## SPECIAL APPROVAL STIPULATIONS

THE FOLLOWING DATA IS REQUIRED ON THE WELL SIGN:

Inesco Oil Co. McClellan Fed No. 1	
OPERATOR	WELL DESIGNATION
31-138-29E	CHAVEZ
S--R	COUNTY
N.M. - 12561	
LEASE NO.	

THE SPECIAL STIPULATIONS CHECK MARKED BELOW ARE APPLICABLE TO THE ABOVE-DESCRIBED WELL AND APPROVAL OF THIS APPLICATION TO DRILL IS CONDITIONED UPON COMPLIANCE WITH SUCH STIPULATIONS. EACH PERMITTEE HAS THE RIGHT OF ADMINISTRATIVE APPEAL TO THESE SPECIAL STIPULATIONS PURSUANT TO TITLE 30 CFR 290.

- ☒ A. 13 3/8" surface casing should be set in the Rustler Anhydrite formation and cement circulated to the surface. If surface casing is set at a lesser depth, the \_\_\_\_\_ casing must be cemented from the casing shoe to the surface or cemented to the surface through a stage tool set at least 50 feet below the top of the Rustler after cementing around the shoe with sufficient cement to fill to the base of the salt section.
- ☒ B. Before drilling below the 9 5/8" casing, the blowout preventer assembly will consist of a minimum of one annular type and two ram type preventers.
- ☐ C. Casing protectors will be run on drill pipe while drilling through the \_\_\_\_\_ casing. Protectors will be of sufficient number and of sufficient outside diameter to protect the casing.
- ☐ D. Minimum required fill of cement behind the \_\_\_\_\_ casing is to \_\_\_\_\_.
- ☒ E. After setting the 9 5/8" casing string and before drilling into the WOLF CANYON formation, the blowout preventers and related control equipment shall be pressure tested to rated working pressures by an independent service company. Any equipment failing to test satisfactorily shall be repaired or replaced. This office should be notified in sufficient time for a representative to witness the tests and shall be furnished a copy of the pressure test report.
- ☒ F. Mud system monitoring equipment, with derrick floor indicators and visual and audio alarms, shall be installed and operating before drilling into the WOLF CANYON formation and used until production casing is run and cemented. Monitoring equipment shall consist of the following:
- (1) A recording pit level indicator to determine pit volume gains and losses.
  - (2) A mud volume measuring device for accurately determining mud volume necessary to fill the hole on trips.
  - (3) A flow sensor on the flow-line to warn of any abnormal mud returns from the well.
- ☒ G. All pits containing toxic liquids will be fenced and covered with a fine mesh netting, if necessary for the protection of livestock or wildlife.
- ☒ H. Above ground permanent structures and equipment shall be painted in accordance with the Painting Guidelines. The paint color is to simulate:
- ☒ Sandstone Brown, Fed. Std. 595-20318 or 30318
- ☒ Sagebrush Gray, Fed. Std. 595-26357 or 36357
- ☐



I. A kelly cock will be installed and maintained in operable condition.



J. The ARTESIA District Office is to be notified in sufficient time for a representative to witness:

(a) Spudding 4-1/2

(b) Cementing casing

\_\_\_\_\_ inch

\_\_\_\_\_ inch

\_\_\_\_\_ inch

(c) ~~BOP tests~~



K. A Communitization Agreement covering the acreage dedicated to the well must be filed for approval with the U. S. Geological Survey, P. O. Box 26124, Albuquerque, New Mexico 87125. The effective date of the agreement must be prior to any sales.



L. A Gamma Ray-Compensated Neutron log is required from the base of the salt section to the surface with cable speed not to exceed 30 feet per minute.



M. At least one working day prior to constructing the well pad, access roads and/or related facilities, the operator or dirt contractor shall notify the authorized officer (Bureau of Land Management, ROSWELL area). He shall also notify the Authorized Officer within two working days after completion of earth-moving activities.



N. All access roads constructed in conjunction with the drilling permit (APD) will be limited to a 12 foot wide driving surface, excluding turn-arounds. Surface disturbance associated with construction and/or use of the road will be limited to 50 feet in width. If well is a producer, all roads will be adequately drained to control runoff and soil erosion. Drainage facilities may include ditches, water bars, culverts and/or any other measures deemed necessary by the authorized officer of the BLM. The following is a general guide for the spacing of water bars:

% Slope

less than 2%	200 ft.
2% to 4%	100 ft.
4% to 5%	75 ft.
more than 5%	50 ft.



O. Other special stipulations

Any permanent pit containing waste oil must be fenced and covered with mesh wire.

13<sup>3</sup>/<sub>8</sub> Casing

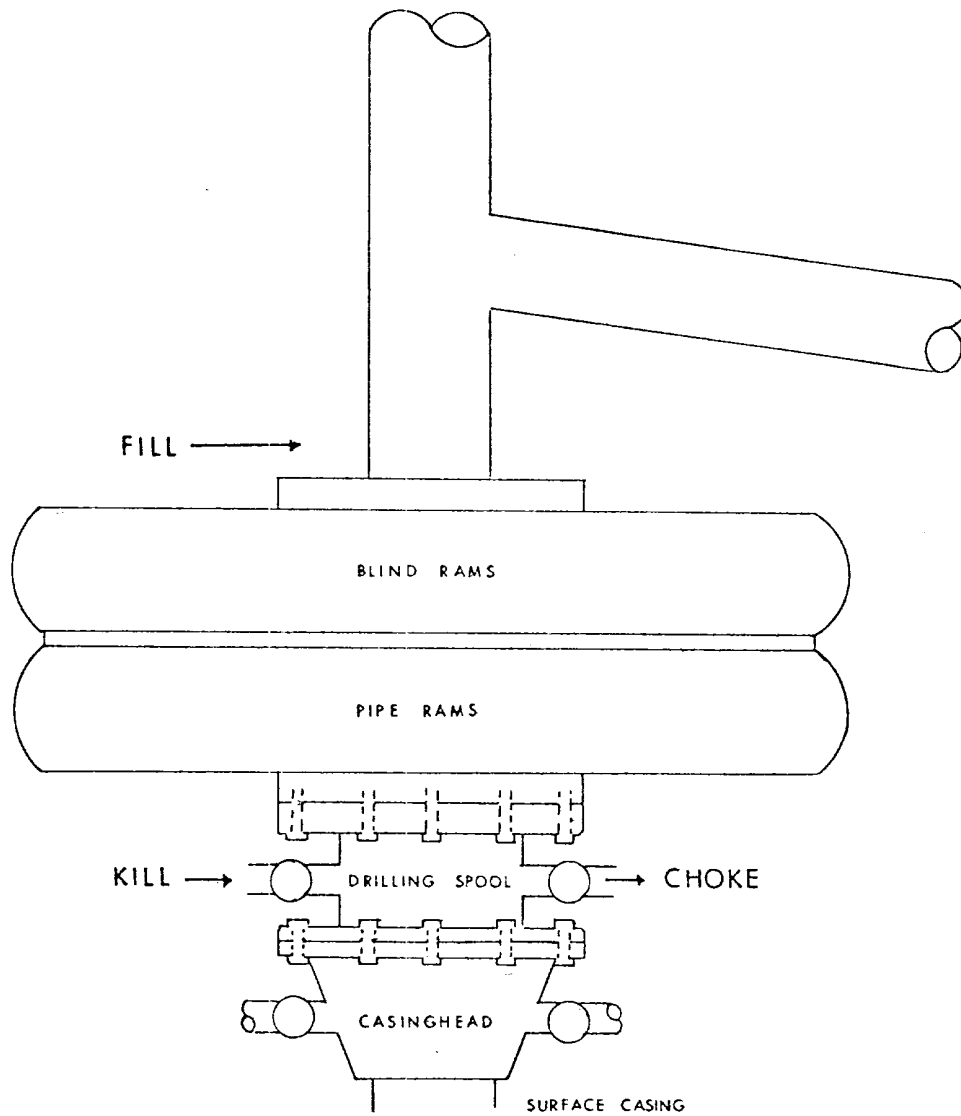

# BLOWOUT PREVENTOR SCHEMATICS

9 5/8 Casing

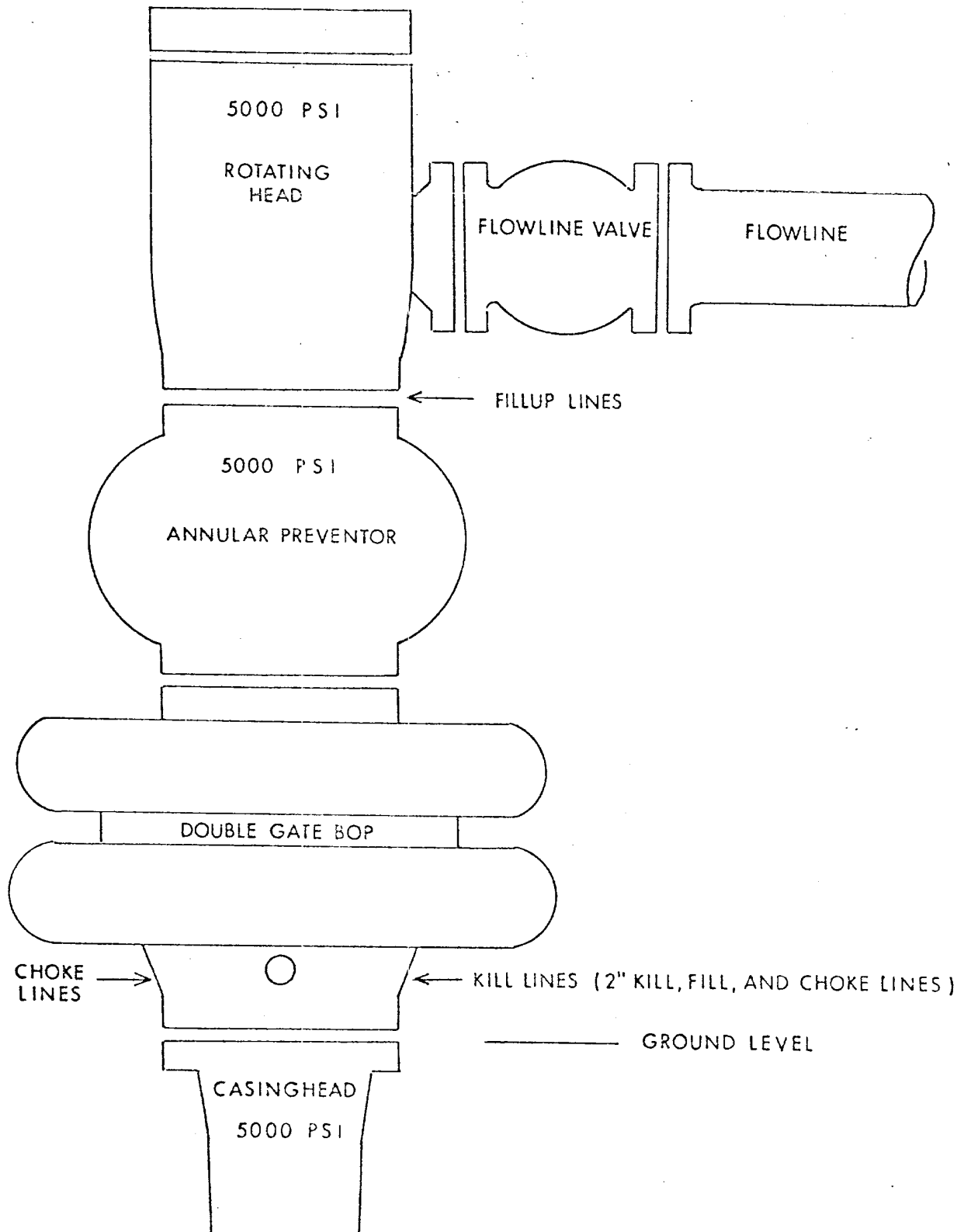

## SURFACE USE PLAN

SURFACE USE PLAN

Inexco Oil Company #1 McClellan Federal  
1980' FWL & 660' FNL Section 31, T14S-R29E  
Chaves County, New Mexico  
Federal Lease NM 12561

**RECEIVED**

OCT 14 1980

U.S. GEOLOGICAL SURVEY  
ARTESIA, NEW MEXICO

1. Existing Roads

Exhibit "A" is a portion of the Chaves County road map of the New Mexico State Highway Department, showing the proposed well site in relation to nearby highways and ranch-oil field roads. U. S. Highway 31 will be used for 12.6 miles from Hagerman to the oil-ranch road. This highway is maintained by the State of New Mexico. The oil field-ranch road will be used for approximately 6.5 miles. This road is constructed of caliche, is approximately 12' to 35' in width and is maintained by the county, area ranchers, and oil operators who utilize this road. All roads and highways to be used are marked in yellow and the proposed well site and nearby towns are marked in red.

2. Planned Access Road

Exhibit "B" shows the ranch and oil field roads. The new road to be constructed is marked in red and is approximately 200' in length. Approximately 6.5 miles of existing ranch road will be utilized (shown in yellow on Exhibit "B"). This road is approximately 12' to 15' wide. Existing fences will be left intact.

3. Location of Existing Wells

Exhibit "C" shows all of the producing wells within 2 miles of the proposed test with ownership of various tracts.

4. Location of Tank Battery, Production Facilities & Production Gathering & Service Lines

If gas production is achieved the location of the line will be determined by the purchaser laying in the gathering system to his existing gas lines.

5. Location and Type of Water Supply

There is no useable water in this area. All water needed for drilling, testing, and completion will be trucked in by a commercial transport on existing roads as shown on Exhibit "A".

6. Source of Construction Materials

It will be necessary to use caliche on new road and location. This material will be obtained from the pits when they are constructed.

7. Handling of Waste Disposal

All waste material remaining after the drilling of this well will be placed in mud pit as shown on Exhibit "D". Any combustible or biochemically degradable material will be placed in the "burn and trash pit".

8. Ancillary Facilities

No ancillary facilities are planned.

9. Well Site Layout  
This information is shown on Exhibit "D".
10. Plan for Restoration of Surface  
All pits will be filled in and leveled. Deadmen will be removed. The access road and location will be restored as near as possible to its natural state following instructions from appropriate governmental agency, if well is abandoned; otherwise the location will be cleared and maintained in an orderly manner.
11. Other Information  
No unusual topography exists on the well site or access roads and the surface is comprised of Exhibit "B".
12. Operator Representatives
- |                              |                |        |
|------------------------------|----------------|--------|
| A. W. Cook                   | (713) 651-3432 | Office |
| 1100 Milam Bldg., Suite 1900 | (713) 370-2164 | Home   |
| Houston, Texas 77002         |                |        |
13. Certification  
I certify that I, or persons under my direct supervision, have inspected the proposed drill site and access route; that I am familiar with the conditions which presently exist; that the statements made in this plan are, to the best of my knowledge, true and correct; and that the work associated with the operations proposed herein will be performed by McClellan Oil Corporation and its contractors and subcontractors in conformity with this plan and the terms and conditions under which it is approved.

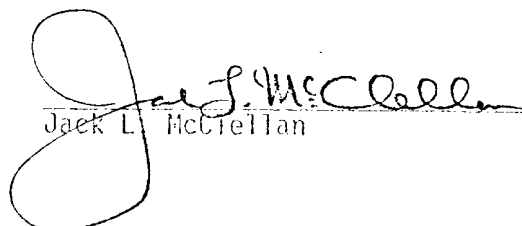
  
Jack L. McClellan

REQUIREMENTS  
(NTL-6)

1. Location: 660' FNL & 1980' FWL Section 31, T14S, R29E, Chaves Co., New Mexico
2. Elevation: 3634.3 G.L.
3. Geologic name of surface formation: Unknown
4. Type of drilling rig and associated equipment: Rotary - Warton Drilling Co.  
Rig #4
5. Proposed drilling depth and objective formation: 9200' Mississippian
6. Estimated tops of geologic markers:

Yates _____	San Andres <u>2000'</u>	Abo <u>5400'</u>
7-Rivers _____	Glorieta <u>3300'</u>	Atoka <u>8600'</u>
Queen _____	Tubb _____	Morrow <u>8700'</u>
		Miss.(Chester) <u>8900'</u>
7. Estimated depths of any oil, water, or gas: Gas 8700'
- 8-9. Proposed casing program:

<u>13-3/8 " @ 400 ' Grade J-55</u>	<u>Wt. 61 lbs</u>	<u>Type Cement 425 sx Class "C" Circ.</u>
<u>9-5/8 " @ 2300 ' Grade J-55</u>	<u>Wt. 43½ lbs</u>	<u>Type Cement 700 sx Class "C" Circ.</u>
<u>5-1/2 " @ 9200 ' Grade J-55</u>	<u>Wt. 15½ lbs</u>	<u>Type Cement 700 sx Class "C"</u>
10. Specifications for pressure control equipment and testing procedures: See  
attached diagram. Yellow jacket test will be made at approximately 3000'.
11. Type and characteristics of drilling fluids: Native mud to 2300'. Mud-up at top of  
Abo w/38-40 vis. 9 lb. salt base - At 5100', use salt base gel, 6% oil. Wtr. loss 10-15cc.
12. Testing, logging, and coring programs: Will DST any shows encountered in test that  
are justified in the operators judgement. No coring is anticipated.
13. Anticipated abnormal pressures or temperature: None
14. Anticipated commencement and completion date: October 25, 1980 - December 15, 1980
15. Other pertinent information: \_\_\_\_\_



SURFACE USE PLAN Exhibit "A"  
Inexco Co. No.1 McClellan Federal  
Section 31 T13S R29E  
Chaves County, New Mexico

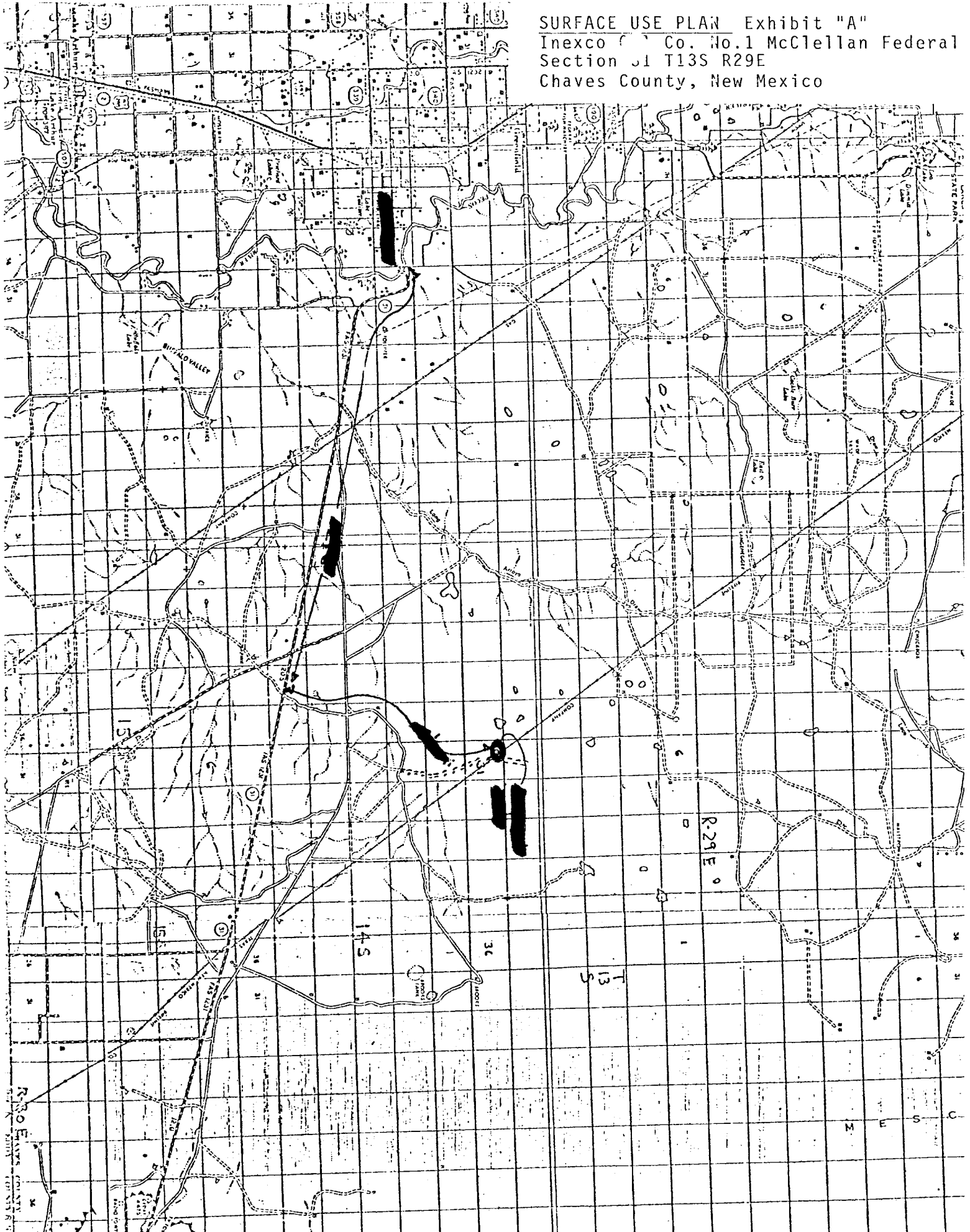

SURFACE USE PLAN EXHIBIT B  
Inexco Oil Company No.1 McClellan Fed.  
Section T13S R29E  
Chaves County, New Mexico

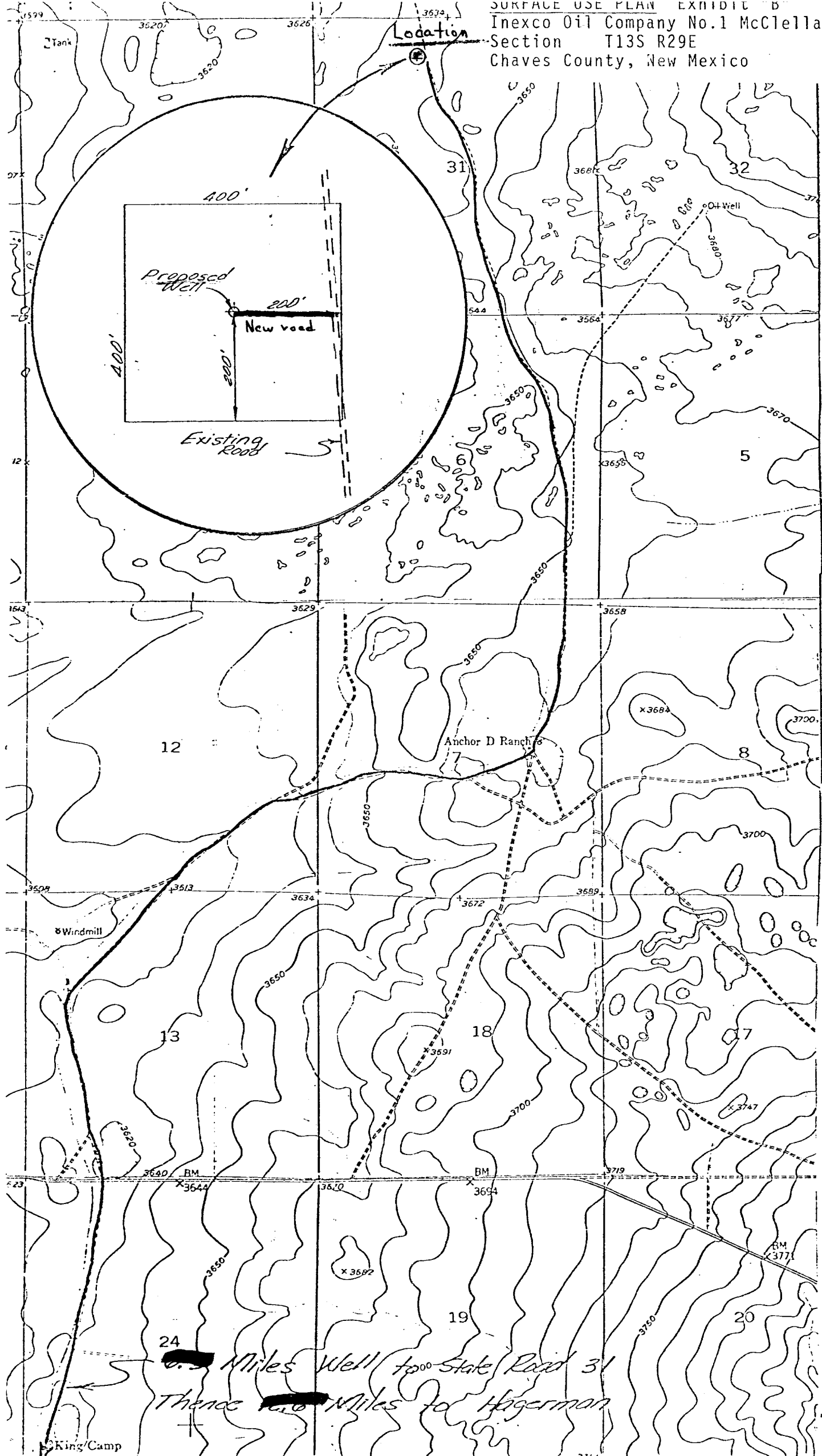

24 Miles Well to State Road 31  
Thence 1.6 Miles to Hogerman

Inexco Oil Co. No.1 McClellan Fed.  
Section 31 T13S R29E  
Chaves County, New Mexico

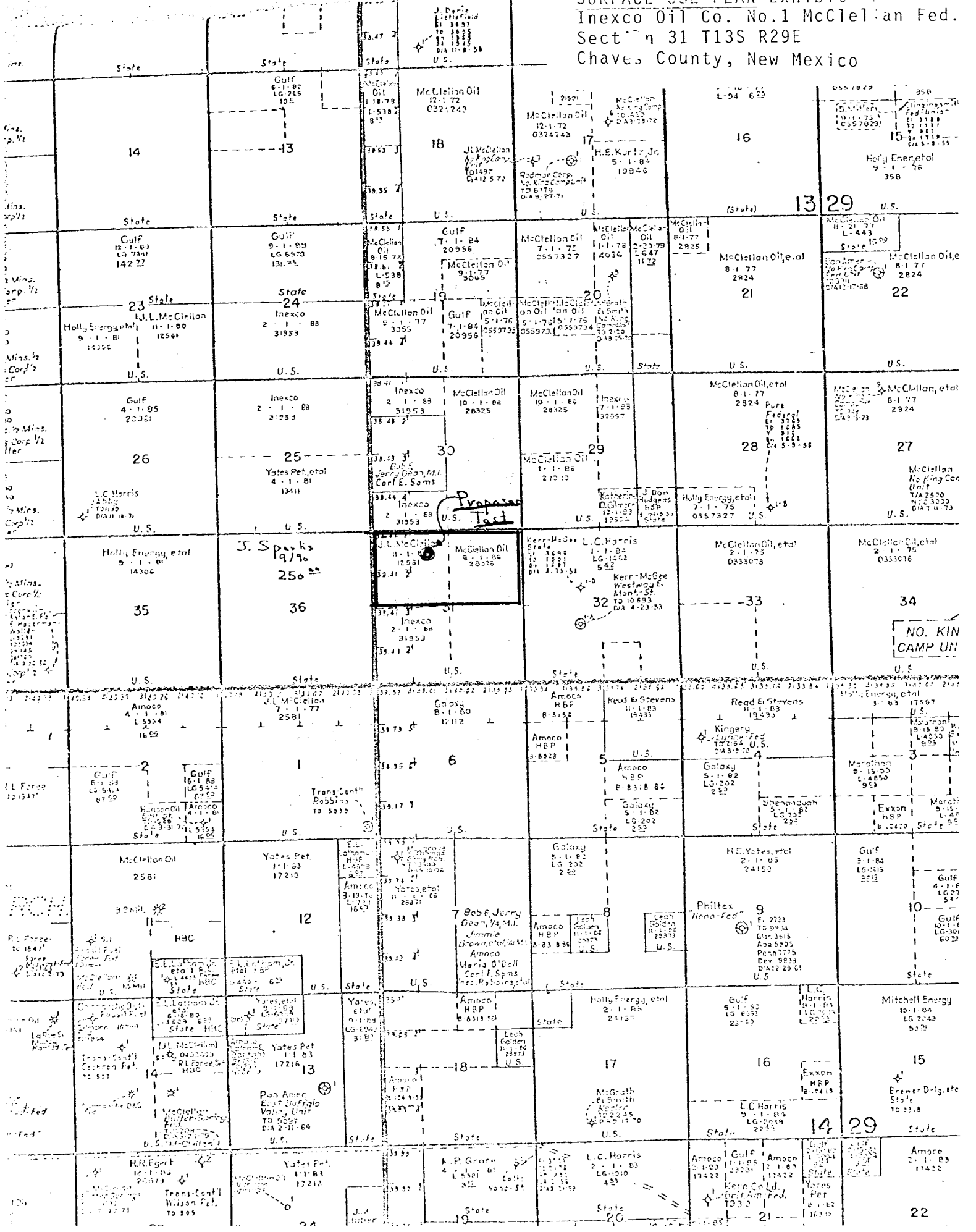

SURFACE USE PLAN Exhibit "D"  
Inex Oil Co. No.1 McClellan Fed.  
Section 31 T13S R29E  
Chaves County, New Mexico

