

STATE OF NEW MEXICO
ENERGY AND MINERALS DEPARTMENT

LAND CONSERVATION DIVISION

Form C-101
Revised 10-1-78

NO. OF COPIES RECEIVED	
DISTRIBUTION	
SANTA FE	/
FILE	/
U.S.G.S.	/
LAND OFFICE	/
OPERATOR	/

RECEIVED BY
SEP 25 1986
O. C. D.
SAN ANTONIO, NEW MEXICO 87501

5A. Indicate Type of Lease
STATE ☐ FEE ☒
5. State Oil & Gas Lease No.

APPLICATION FOR PERMIT TO DRILL, DEEPEN, OR PLUG BACK

1a. Type of Work DRILL <input checked="" type="checkbox"/> Re-enter DEEPEN <input type="checkbox"/> PLUG BACK <input type="checkbox"/>		7. Unit Agreement Name	
b. Type of Well OIL WELL <input type="checkbox"/> GAS WELL <input type="checkbox"/> OTHER <input type="checkbox"/> SINGLE ZONE <input type="checkbox"/> MULTIPLE ZONE <input type="checkbox"/>		8. Farm or Lease Name Skip	
2. Name of Operator N. Dale Nichols		9. Well No. 1	
3. Address of Operator P.O. Box 1972 Midland, Texas 79702		10. Field and Foot, or Mineral Unders. San Andres	
4. Location of Well UNIT LETTER <u>P</u> LOCATED <u>660</u> FEET FROM THE <u>East</u> LINE AND <u>660</u> FEET FROM THE <u>South</u> LINE OF SEC. <u>26</u> TWP. <u>7S</u> RGE. <u>28E</u> NMPM		17. County Chaves	
19. Proposed Depth 2710'		19A. Formation San Andres	
20. Rotary or C.T. Rotary (Reverse)		21. Elevation (Show whether D.F., K.T., etc.) 4076 G.L. 4079	
21A. Kind & Status Plug. Bond Blanket		21B. Drilling Contractor N. Dale Nichols	
22. Approx. Date Work will start 9-29-86			

PROPOSED CASING AND CEMENT PROGRAM

SIZE OF HOLE	SIZE OF CASING	WEIGHT PER FOOT	SETTING DEPTH	SACKS OF CEMENT	EST. TOP
17 1/2"	13 3/8"	48#	407'	425	2102'
13 1/2"	8 5/8"	24#	2820'	1320	2102'

We propose to re-enter and clean out the P & A Ralph Nix #1 Skip. Our proposal calls for cleaning out inside the 8 5/8 casing to a depth of 2710', perforate the casing with 2 holes per foot from 2578 to 2588 and 2600 to 2620, acidize and test the P2 zone of the San andres.

We propose to use the casing currently existing in the well as follows:

13 3/8" 48# set at 407' and cemented with 425 sacks, cement circulated.

8 5/8" 24# set at 2820' and cemented with 1320 sacks, cement circulated.

Ralph Nix - 7-24-86
Will 1986 9-15-86 010-7225
IN ABOVE SPACE DESCRIBE PROPOSED PROGRAM: IF PROPOSAL IS TO DEEPEN OR PLUG BACK, GIVE DATA ON PRESENT PRODUCTIVE ZONE AND PROPOSED NEW PRODUCTIVE ZONE. GIVE BLOWOUT PREVENTER PROGRAM, IF ANY.

I hereby certify that the information above is true and complete to the best of my knowledge and belief.

Signed N. Dale Nichols Title Operator Date 9-22-86

(This space for State Use) Original Signed By

Les A. Clements

APPROVED BY Supervisor District II DATE SEP 26 1986

CONDITIONS OF APPROVAL, IF ANY:

**NEW MEXICO OIL CONSERVATION COMMISSION
WELL LOCATION AND ACREAGE DEDICATION PLAT**

Form C-102
Supersedes C-128
Effective 1-1-65

All distances must be from the outer boundaries of the Section.

Operator: N. Dale Nichols			Lease: Skip		Well No.: 1
Unit Letter: P	Section: 26	Township: 7-S	Range: 28-E	County: Chaves	
Actual Footage Location of Well:					
660 feet from the east line and		660 feet from the south line			
Ground Level Elev.: 4079	Producing Formation: San Andres	Pool: Undesignated	Dedicated Acreage: 40 Acres		

1. Outline the acreage dedicated to the subject well by colored pencil or hatchure marks on the plat below.
2. If more than one lease is dedicated to the well, identify the ownership thereof (both as to working interest and royalty).
3. If more than one lease of different ownership is dedicated to the well, have the interests of all owners been consolidated by communitization, unitization, force-pooling, etc? D.

RECEIVED BY
SEP 25 1986
ARTESIA, OFFICE

☐ Yes ☐ No If answer is "yes," type of consolidation _____

If answer is "no," list the owners and tract descriptions which have actually been consolidated. (Use reverse side of this form if necessary.) _____

No allowable will be assigned to the well until all interests have been consolidated (by communitization, unitization, forced-pooling, or otherwise) or until a non-standard unit, eliminating such interests, has been approved by the Commission.

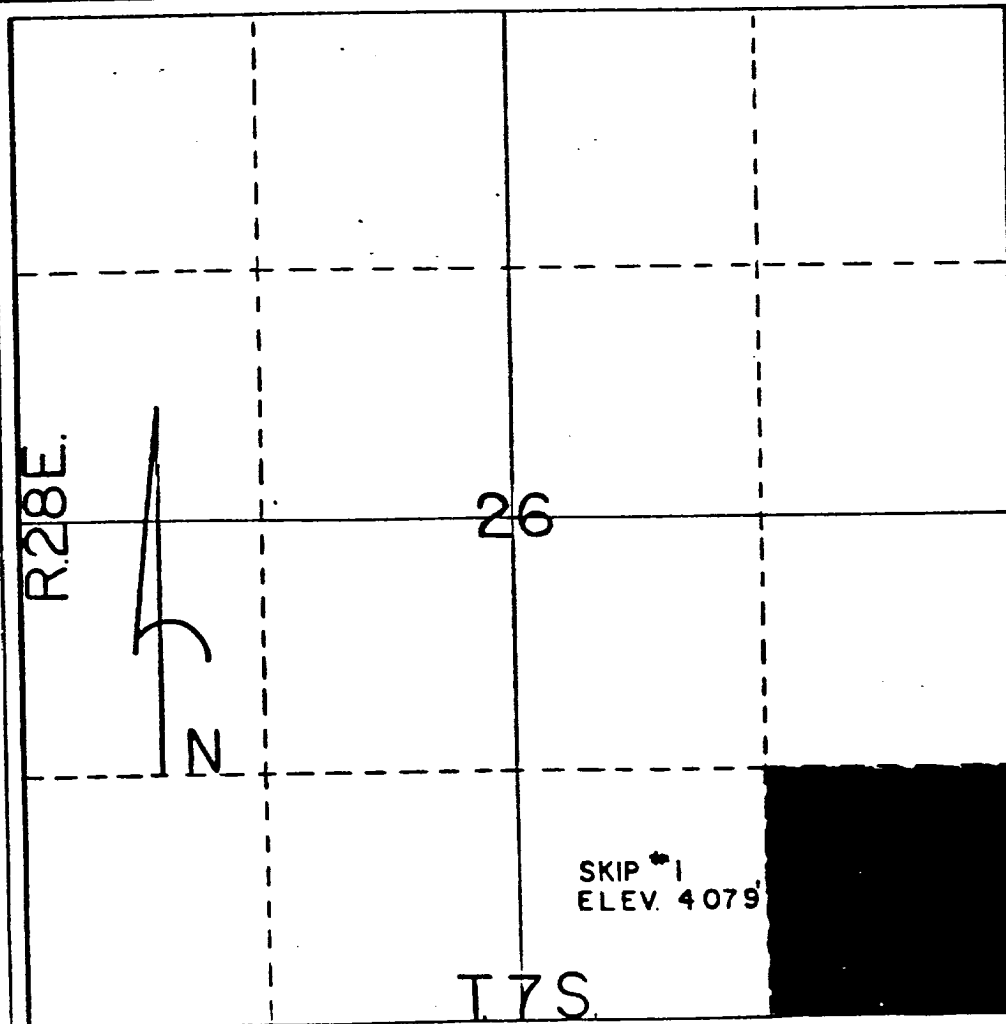

**SKIP #1
ELEV. 4079**

CERTIFICATION

I hereby certify that the information contained herein is true and complete to the best of my knowledge and belief.

N. Dale Nichols

Name
N. Dale Nichols

Position
Operator

Company
N. Dale Nichols

Date
9-24-86

I hereby certify that the well location shown on this plat was plotted from field notes of actual surveys made by me or under my supervision, and that the same is true and correct to the best of my knowledge and belief.

Thomas T. Mann

Date Surveyed
10-14-80

Registered Professional Engineer
and/or Land Surveyor

Thomas T. Mann

Registration
N.M. License No. 277