

## OIL CONSERVATION DIVISION

P. O. BOX 2038

SANTA FE, NEW MEXICO 87501

Form C-103  
Revised 10-1-

NO. OF COPIES RECEIVED		
DISTRIBUTION		
SANTA FE	1	
FILE	1	✓
U.S.O.S.		
LAND OFFICE		
OPERATION	1	

5a. Indicate Type of Lease  
 State ☐ For ☒  
 b. State Oil & Gas Lease No.

## SUNDRY NOTICES AND REPORTS ON WELLS

(DO NOT USE THIS FORM FOR PROPOSALS TO DRILL OR TO DEEPEN OR PLUG SALT TO A DIFFERENT DEPTH. USE MATRICATION FOR PERMIT TO DRILL OR TO DEEPEN OR PLUG SALT TO A DIFFERENT DEPTH.)

RECEIVED

OIL WELL ☐ GAS WELL ☒ OTHER ☐

Name of Operator: Yates Petroleum Corporation

Address of Operator: 207 South 4th St., Artesia, NM 88210

Location of Well: UNIT LETTER G 1980 FEET FROM THE North LINE AND 1980 FEET FROM THE East LINE, SECTION 21 TOWNSHIP 10S RANGE 26E

MAR 24 1981

O. C. D.  
ARTESIA, OFFICE

7. Unit Agreement Name  
 8. Farm or Lease Name: Newman PP  
 9. Well No.: 1  
 10. Field and Pool, or Wildcat: Wildcat  
 11. County: Chaves

15. Elevation (Show whether DF, RT, GR, etc.)

3699.2' GR

Check Appropriate Box To Indicate Nature of Notice, Report or Other Data

NOTICE OF INTENTION TO:

SUBSEQUENT REPORT OF:

PERFORM REMEDIAL WORK ☐  
 TEMPORARILY ABANDON ☐  
 WELL OR ALTER CASING ☐

PLUG AND ABANDON ☐  
 CHANGE PLANS ☐

REMEDIAL WORK ☐  
 COMMENCE DRILLING OPERATIONS ☒  
 CASING TEST AND CEMENT JOBS ☒

ALTERING CASING ☐  
 PLUG AND ABANDONMENT ☐

OTHER Plugback ☒OTHER ☐

Describe Proposed or Completed Operations (Clearly state all pertinent details, and give pertinent dates, including estimated date of starting any proposed work) SEE RULE 1103.

Spudded a 12-1/4" hole at 6:00 PM 3-5-81.

TD 988'. Ran 25 joints of 8-5/8" 24# K-55 casing set at 988'. 1-regular pattern guide shoe at 988'. Flapper float insert at 948'. Cemented w/400 sacks 65-35 Poz, 4% Bentonite, 8# Kolite, 1/4# celloflakes and 3% CaCl. Tailed in with 150 sacks Class C 2% CaCl. PD 1:30 PM 3-7-81. Bumped plug to 900 psi, released pressure and float held okay. Cement circulated 40 sacks. WOC 18 hours. Reduced hole to 7-7/8"

TD 5097'. This well was drilled to a total depth of 5097' & logged with no shows in the Abo formation. Propose to plugback to 1800', run 4-1/2" casing with sufficient cement to tie back into 8-5/8" casing (to approximately 900'), & test San Andres. The well will be plugged back as follows:

35 sacks Class C on bottom across Wolfcamp top at 5020'

4300-4400' (35 sacks minimum) across Abo top at 4346'

2100-2200' (35 sacks minimum) across Glorieta top at 2164'

1800-2000' across water porosity zone in lower San Andres

Verbal approval for the proposed plugback was obtained from Mr. Gressett, NMOCD, Artesia on 3-22-81

I hereby certify that the information above is true and complete to the best of my knowledge and belief.

SIGNED Lynda Z. Gressett

TITLE Engineering Secretary

DATE 3-23-81

APPROVED BY W. A. Gressett

TITLE SUPERVISOR, DISTRICT IV

DATE MAR 30 1981

CONDITIONS OF APPROVAL, IF ANY:

MEXICO OIL CONSERVATION COMMISSION  
WELL LOCATION AND ACREAGE DEDICATION PLAT

Form C-102  
Supersedes C-128  
Effective 1-1-65

All distances must be from the outer boundaries of the Section.

Owner <b>Yates Petroleum Corporation</b>			Lease <b>Newman "PP"</b>		Well No. <b>1</b>
Section Letter <b>G</b>	Section <b>21</b>	Township <b>10S</b>	Range <b>26E</b>	County <b>Chaves</b>	
Well Footage Location of Well: <div style="display: flex; justify-content: space-between;"> <span>1980 feet from the North line and</span> <span>1980 feet from the East line</span> </div>					
Ground Level Elev. <b>3699.2 GR</b>	Producing Formation <b>San Andres</b>		Pool <b>Und. San Andres</b>		Dedicated Acreage: <b>40</b> Acres

1. Outline the acreage dedicated to the subject well by colored pencil or hachure marks on the plat below.
2. If more than one lease is dedicated to the well, outline each and identify the ownership thereof (both as to working interest and royalty).
3. If more than one lease of different ownership is dedicated to the well, have the interests of all owners been consolidated by communitization, unitization, force-pooling, etc?

☐ Yes    ☐ No    If answer is "yes," type of consolidation \_\_\_\_\_

If answer is "no," list the owners and tract descriptions which have actually been consolidated. (Use reverse side of this form if necessary.) \_\_\_\_\_

No allowable will be assigned to the well until all interests have been consolidated (by communitization, unitization, forced-pooling, or otherwise) or until a non-standard unit, eliminating such interests, has been approved by the Commission.

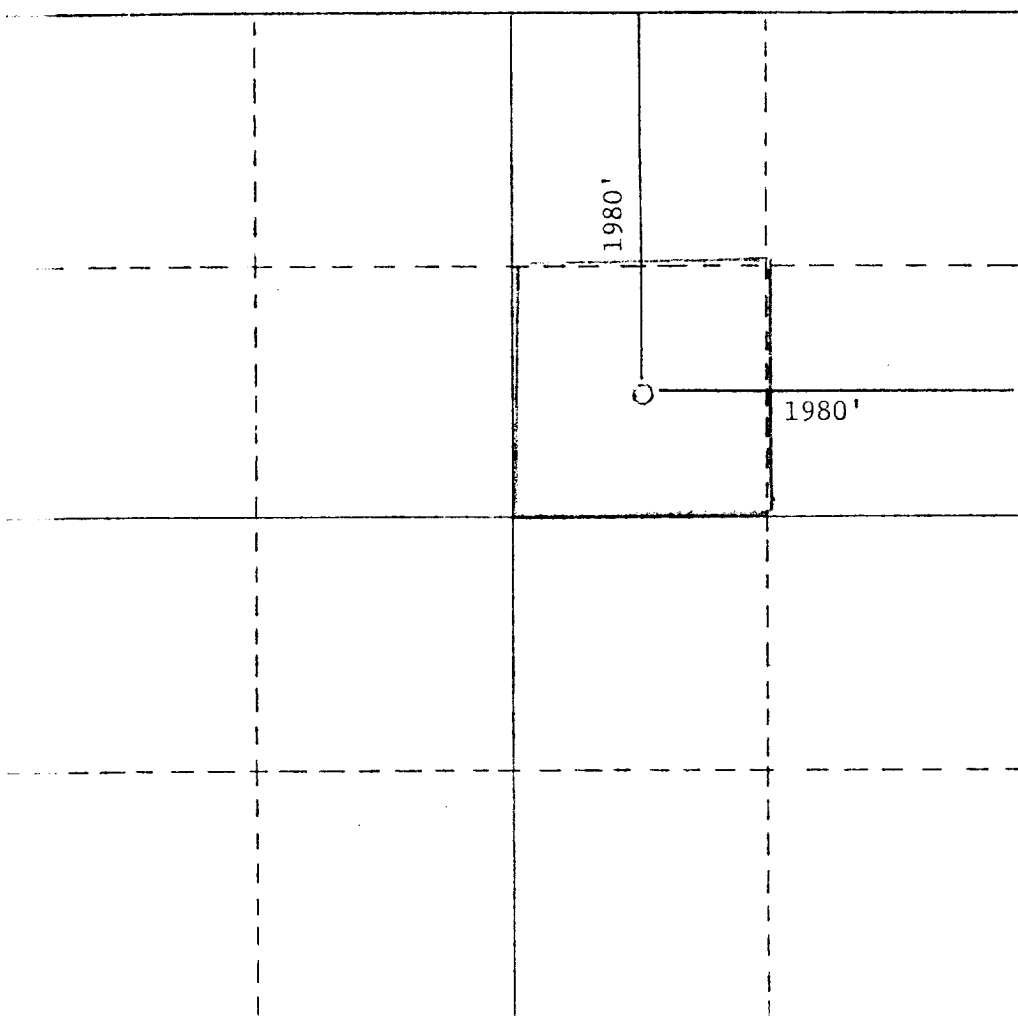

**CERTIFICATION**

*I hereby certify that the information contained herein is true and complete to the best of my knowledge and belief.*

*Albert R. Stall*  
Name

**Albert R. Stall**

Position

**Engineer**

Company

**Yates Petroleum Corporation**

Date

**3-23-81**

*I hereby certify that the well location shown on this plat was plotted from field notes of actual surveys made by me or under my supervision, and that the same is true and correct to the best of my knowledge and belief.*

**Refer to original plat**

Date Surveyed **dated 2/5/81**

Registered Professional Engineer  
and/or Land Surveyor

Certificate No.

