

30-005-60873

Form C-101  
Revised 1-1-65

NEW MEXICO OIL CONSERVATION COMMISSION

FEB 20 1981

O. C. D.  
ARTESIA OFFICE

NO. OF COPIES RECEIVED	
DISTRIBUTION	
SANTA FE	1
FILE	1 ✓
U.S.G.S.	2
LAND OFFICE	1
OPERATOR	1

APPLICATION FOR PERMIT TO DRILL, DEEPEN, OR PLUG BACK

1a. Type of Work DRILL <input checked="" type="checkbox"/> DEEPEN <input type="checkbox"/> PLUG BACK <input type="checkbox"/>		5A. Indicate Type of Lease STATE <input checked="" type="checkbox"/> FEE <input type="checkbox"/>
b. Type of Well OIL WELL <input type="checkbox"/> GAS WELL <input checked="" type="checkbox"/> OTHER <input type="checkbox"/> SINGLE ZONE <input checked="" type="checkbox"/> MULTIPLE ZONE <input type="checkbox"/>		5. State Oil & Gas Lease No. L5250
2. Name of Operator Energy Resources Oil & Gas Corp.		7. Unit Agreement Name
3. Address of Operator 2735 Villa Creek Drive Dallas, Texas 75234		8. Farm or Lease Name State 4A
4. Location of Well UNIT LETTER L LOCATED 660 FEET FROM THE West LINE AND 1980 FEET FROM THE South LINE OF SEC. 4 TWP. 5S RGE. 26E NMPM		9. Well No. 1
		10. Field and Pool, or Wildcat Wildcat
		12. County Chaves
19. Proposed Depth 5000		19A. Formation ABO
20. Rotary or C.T. Rotary		
21. Elevations (Show whether DF, RT, etc.) 3809.8 G.L.	21A. Kind & Status Plug. Bond Blanket-effective	21B. Drilling Contractor Pace Drilling Co.
		22. Approx. Date Work will start 2-21-81

PROPOSED CASING AND CEMENT PROGRAM

SIZE OF HOLE	SIZE OF CASING	WEIGHT PER FOOT	SETTING DEPTH	SACKS OF CEMENT	EST. TOP
17-1/2"	13-3/8"	54.5	400' ±	420 ±	Surface
12-1/4"	8-5/8"	24	1500' ±	750 ±	Surface
7-7/8"	*4-1/2"	10.5	5000' ±	650 ±	

Will be run  
if deemed  
productive.

The well will spud with a 17½" hole and drill to + 400'. Surface casing will be run and cement circulated to surface. Casing will be tested to 1000 psi before drilling out from under surface. BOP's will be installed and pressure tested to 3000 psi. (BOP's will be pressure tested a minimum of once every 10 days). A 12¼" hole will be drilled + 1500' and 8-5/8" O.D. casing set and cemented to surface. Casing will be tested to 1000 psi before drilling out. A 7-7/8" hole will be drilled to a total depth of + 5000'. If the well is deemed productive, 4½" O.D. casing will be run and cemented with 650 sacks. A minimum of 18 hrs. woc time will adhere to any casing string run.

gas is not dedicated

APPROVAL VALID FOR 180 DAYS  
PERMIT EXPIRES 8-24-81  
UNLESS DRILLING UNDERWAY

IN ABOVE SPACE DESCRIBE PROPOSED PROGRAM: IF PROPOSAL IS TO DEEPEN OR PLUG BACK, GIVE DATA ON PRESENT PRODUCTIVE ZONE AND PROPOSED NEW PRODUCTIVE ZONE. GIVE BLOWOUT PREVENTER PROGRAM, IF ANY.

I hereby certify that the information above is true and complete to the best of my knowledge and belief.

Signed [Signature] Title AG, C. R. T. Date 2-20-81

(This space for State Use)

APPROVED BY [Signature] TITLE SUPERVISOR, DISTRICT II DATE FEB 24 1981

CONDITIONS OF APPROVAL, IF ANY:

NEW MEXICO OIL CONSERVATION COMMISSION  
WELL LOCATION AND ACREAGE DEDICATION PLAT

Form C-102  
Supersedes C-128  
Effective 1-1-65

All distances must be from the outer boundaries of the Section

Operator ENERGY RESOURCES <sup>Corp</sup> SOIL & GAS		Lease State 4A		Well No. 1
Section Letter "1."	Section 4	Township 5 South	Range 26 East	County Chaves
Actual Portage Location of Well: 198 feet from the South line and 660 feet from the West line				
Ground Level Elev. 3809.8	Producing Formation ABO	Pool Wildcat	Dedicated Acreage 160 Acres	

1. Outline the acreage dedicated to the subject well by colored pencil or hachure marks on the plat below.
2. If more than one lease is dedicated to the well, outline each and identify the ownership thereof (both as to working interest and royalty).
3. If more than one lease of different ownership is dedicated to the well, have the interests of all owners been consolidated by communitization, unitization, force-pooling, etc?

☐ Yes ☒ No If answer is "yes," type of consolidation \_\_\_\_\_

If answer is "no," list the owners and tract descriptions which have actually been consolidated (Use reverse side of this form if necessary.) \_\_\_\_\_

No allowable will be assigned to the well until all interests have been consolidated (by communitization, unitization, forced-pooling, or otherwise) or until a non-standard unit, eliminating such interests, has been approved by the Commission.

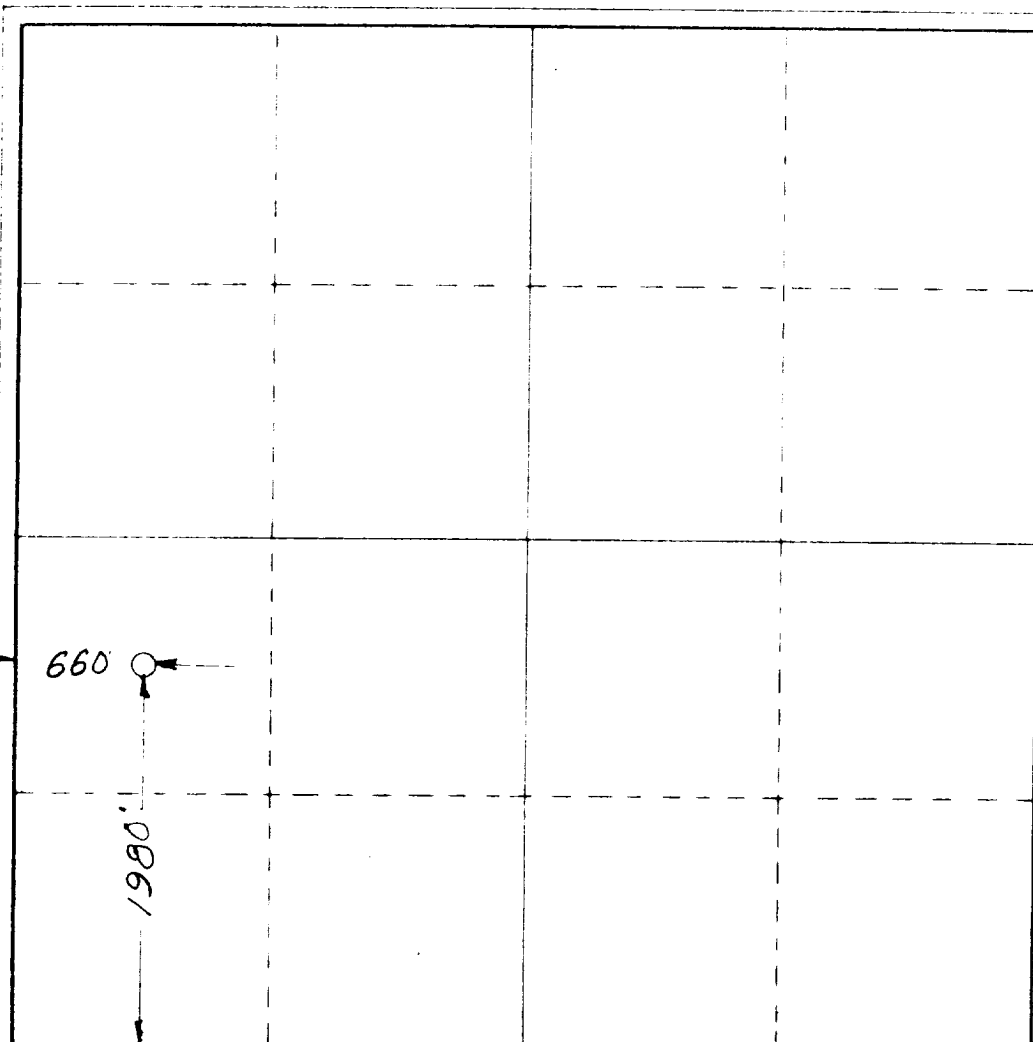

CERTIFICATION

I hereby certify that the information contained herein is true and complete to the best of my knowledge and belief.

*Gerald Brockman*  
Name

Gerald Brockman

Position

Agent

Company

Energy Resources Oil & Gas

Date

February 19, 1981

I hereby certify that the well location shown on this plat was plotted from field notes of actual surveys made by me or under my supervision, and that the same is true and correct to the best of my knowledge and belief.

Date Surveyed

February 17, 1981

Registered Professional Engineer  
and/or Land Surveyor

*Flora H. Lopez*  
Certificate No.

3640



ENERGY RESOURCES OIL & GAS

State 4A #1  
Section 4 T5S R26E  
Chaves County, New Mexico

BLOWOUT PREVENTER PROGRAM SCHEMATIC

