

NO. COPIES RECEIVED	
DISTRIBUTION	
STATE	1
U.S.	1
OFFICE	1
OTHER	1

NEW MEXICO OIL CONSERVATION COMMISSION

Amended application

APR 02 1981

O. C. D.
ALBUQUERQUE OFFICE

30-005-60873

Form O-101
Revised 1-1-80

1A. Indicate Type of Lease	
STATE <input checked="" type="checkbox"/>	FEE <input type="checkbox"/>
5. State Oil & Gas Lease No.	
L5250	

APPLICATION FOR PERMIT TO DRILL, DEEPEN, OR PLUG BACK

1. Well No.	2. Well Name	3. Well Location
4. Kind of Well	5. Depth	6. Plug Back
DEEPEN <input checked="" type="checkbox"/>		
7. Unit Agreement Name	8. Farm or Lease Name	9. Well No.
	State 4A	1

10. Field and Pool, or Wildcat	11. County
Wildcat	Chaves
12. Location of Well	13. Proposed Depth
2735 Villa Creek Drive Dallas, Texas 75234	6100'
14. Direction of Well	15. Formation
UNIT LETTER L LOCATION 660 WEST LINE	Montoya
16. Feet from the South	17. Rotary
4	Rotary

18. Proposed Depth	19A. Formation	20. Rotary
6100'	Montoya	Rotary
21. Well No. (Show whether DF, RT, etc.)	21A. Kind & Status Plug Back	21B. Drilling Contractor
3809.8 G.L.	Blanket-Effective	Pace Drilling Co.
22. Approx. Date Work will start	3-29-81	

PROPOSED CASING AND CEMENT PROGRAM

SIZE OF HOLE	SIZE OF CASING	WEIGHT PER FOOT	SETTING DEPTH	SACKS OF CEMENT	EST. TOP
*17-1/2	13-3/8	48.0	400	400	Surface
*12-1/4	8-5/8	24.0	1516	700	Surface
7-7/8	4-1/2	10.50	+ 6100	+520	+4000

If deemed productive this casing will be set.

*Casing sizes previously set.

IN ABOVE SPACE DESCRIBE PROPOSED PROGRAM, IF PROPOSAL IS TO PLUG BACK, GIVE DATA ON PRESENT WELL, AND IF PROPOSAL IS TO DRILL NEW PRODUCTIVE WELL, GIVE BLINDOUT PREVENTER PROGRAM, IF ANY.

I hereby certify that the information above is true and complete to the best of my knowledge and belief.

Agent
This space for State Use

DATED BY W. A. Gressett TITLE SUPERVISOR, DISTRICT II

APR 06 1981

REMARKS OF APPROVAL, IF ANY:

WELL LOCATION AND ACREAGE DEDICATION PLAT

Supersedes L-128
Effective 1-1-85

Distances must be from the outer boundaries of the section.

Operator ENERGY RESOURCE OIL & GAS Co.		Lease State 4A		Well No. 1
Unit Letter "L"	Section 4	Township 5 South	Range 26 East	County Chaves
Actual Footage Location of Well: 198 feet from the South line and 660 feet from the West line				
Ground Level Elev. 3809.8	Producing Formation Montoya	Pool Wildcat Montoya	Dedicated Acreage: 320 Acres	

1. Outline the acreage dedicated to the subject well by colored pencil or hatchure marks on the plat below.
2. If more than one lease is dedicated to the well, outline each and identify the ownership thereof (both as to working interest and royalty).
3. If more than one lease of different ownership is dedicated to the well, have the interests of all owners been consolidated by communitization, unitization, force-pooling, etc?

☐ Yes ☒ No If answer is "yes," type of consolidation _____

If answer is "no," list the owners and tract descriptions which have actually been consolidated. (Use reverse side of this form if necessary.) _____

No allowable will be assigned to the well until all interests have been consolidated (by communitization, unitization, forced-pooling, or otherwise) or until a non-standard unit, eliminating such interests, has been approved by the Commission.

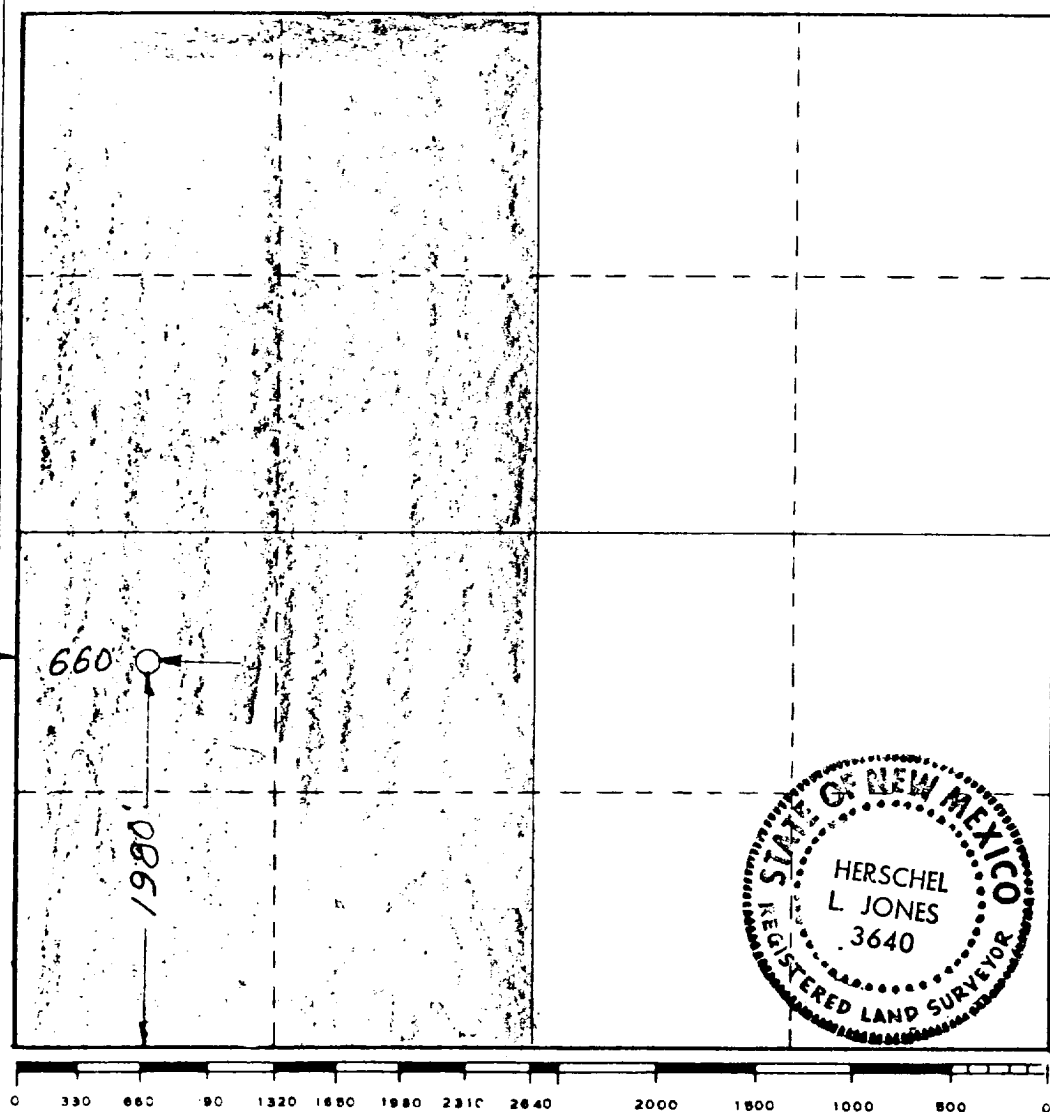

CERTIFICATION

I hereby certify that the information contained herein is true and complete to the best of my knowledge and belief.

Greg Muhlinghouse
Name

Greg Muhlinghouse
Position

Agent
Company

Energy Resources Oil & Gas

Date

March 25, 1981

I hereby certify that the well location shown on this plat was plotted from field notes of actual surveys made by me or under my supervision, and that the same is true and correct to the best of my knowledge and belief.

Date Surveyed

February 17, 1981

Registered Professional Engineer
and/or Land Surveyor

Herschel L. Jones
Certificate No. **3640**