

NO. OF COPIES RECEIVED	5
DISTRIBUTION	
SANTA FE	1
FILE	1
U.S.G.S.	2
LAND OFFICE	
OPERATOR	1

# NEW MEXICO OIL CONSERVATION COMMISSION

RECEIVED 30-005-60875  
 FEB 23 1981

Form C-101  
 Revised 1-1-75

5A. Indicate Type of Lease  
 STATE ☐ FEE ☒  
 5. State Oil & Gas Lease No.

O. C. D.  
 LAND OFFICE

## APPLICATION FOR PERMIT TO DRILL, DEEPEN, OR PLUG BACK

1a. Type of Work DRILL <input checked="" type="checkbox"/> DEEPEN <input type="checkbox"/> PLUG BACK <input type="checkbox"/>		7. Unit Agreement Name
b. Type of Well OIL WELL <input checked="" type="checkbox"/> GAS WELL <input type="checkbox"/> OTHER <input type="checkbox"/>		8. Farm or Lease Name 29 Plains "29"
c. Name of Operator Coronado Exploration Corp. ✓		9. Well No. 1
3. Address of Operator 1005 Marquette NW Albuquerque, NM 87102		10. Field and Foot, or Wildcat X LE Ranch SA Ent.
4. Location of Well UNIT LETTER D LOCATED 660 FEET FROM THE West LINE AND 660 FEET FROM THE North LINE OF SEC. 29 TWP. 10S RGE. 28E NMPM		11. County Chaves
12. Proposed Depth 2300'		13A. Formation San Andres
13B. Drilling Contractor 3 J's Drilling Co.		13C. Date Work will start February 10, 1981
21. Elevations (Show whether DT, RT, etc.) 3732.2 3737.4 Gr.		21A. Kind & Status Plug. Bond Statewide

## PROPOSED CASING AND CEMENT PROGRAM

SIZE OF HOLE	SIZE OF CASING	WEIGHT PER FOOT	SETTING DEPTH	SACKS OF CEMENT	EST. TOP
10"	8 5/8"	20#	320'	150'	circulate
8"	4 1/2"	9.5#	2300'	140'	

We plan to:

Set 320' of 8 5/8" 20# casing in a 10" hole. Cement with 150 sx Class "C" cement with 2% CaCl and WOC 18 hrs. Bail hole dry and wait for one hour. If hole remains dry, we will drill an 8" hole to TD. We will run SNP, Dual Induction and Density logs. Depending on the outcome of the logs, we will either set 4 1/2" casing or plug the hole according to NMOCC regulations.

APPROVAL V. 180  
 PERMIT EXPIRES 8-24-81  
 UNLESS DRILLING UNDERWAY

IN ABOVE SPACE DESCRIBE PROPOSED PROGRAM: IF PROPOSAL IS TO DEEPEN OR PLUG BACK, GIVE DATA ON PRESENT PRODUCTIVE ZONE AND PROPOSED NEW PRODUCTIVE ZONE. GIVE BLOWOUT PREVENTER PROGRAM, IF ANY.

I hereby certify that the information above is true and complete to the best of my knowledge and belief.

CORONADO EXPLORATION CORP.

Signed [Signature] Title Production Secretary Date February 3, 1981

(This space for State Use)

APPROVED BY [Signature] TITLE SUPERVISOR, DISTRICT II DATE FEB 24 1981

CONDITIONS OF APPROVAL, IF ANY:

NEW MEXICO OIL CONSERVATION COMMISSION  
WELL LOCATION AND ACREAGE DEDICATION PLAT

Form C-102  
Supersedes C-128  
Effective 1-1-65

All distances must be from the outer boundaries of the Section.

Operator <b>Coronado Exploration Corp.</b>		Lease <b>Plains 29</b>		Well No. <b>1</b>
Unit Letter <b>D</b>	Section <b>29</b>	Township <b>10 South</b>	Range <b>28 East</b>	County <b>Chaves</b>
Actual Footage Location of Well: <b>660</b> feet from the <b>North</b> line and <b>660</b> feet from the <b>West</b> line				
Ground Level Elev. <b>3732.2</b>	Producing Formation <b>San Andres</b>	Pool <b>LE Ranch San Andres</b>	Dedicated Acreage: <b>40</b> Acres	

1. Outline the acreage dedicated to the subject well by colored pencil or hatchure marks on the plat below.
2. If more than one lease is dedicated to the well, outline each and identify the ownership thereof (both as to working interest and royalty).
3. If more than one lease of different ownership is dedicated to the well, have the interests of all owners been consolidated by communitization, unitization, force-pooling, etc?

☐ Yes ☒ No If answer is "yes," type of consolidation \_\_\_\_\_

If answer is "no," list the owners and tract descriptions which have actually been consolidated. (Use reverse side of this form if necessary.) All leases held by operator and participating parties

No allowable will be assigned to the well until all interests have been consolidated (by communitization, unitization, forced-pooling, or otherwise) or until a non-standard unit, eliminating such interests, has been approved by the Commission.

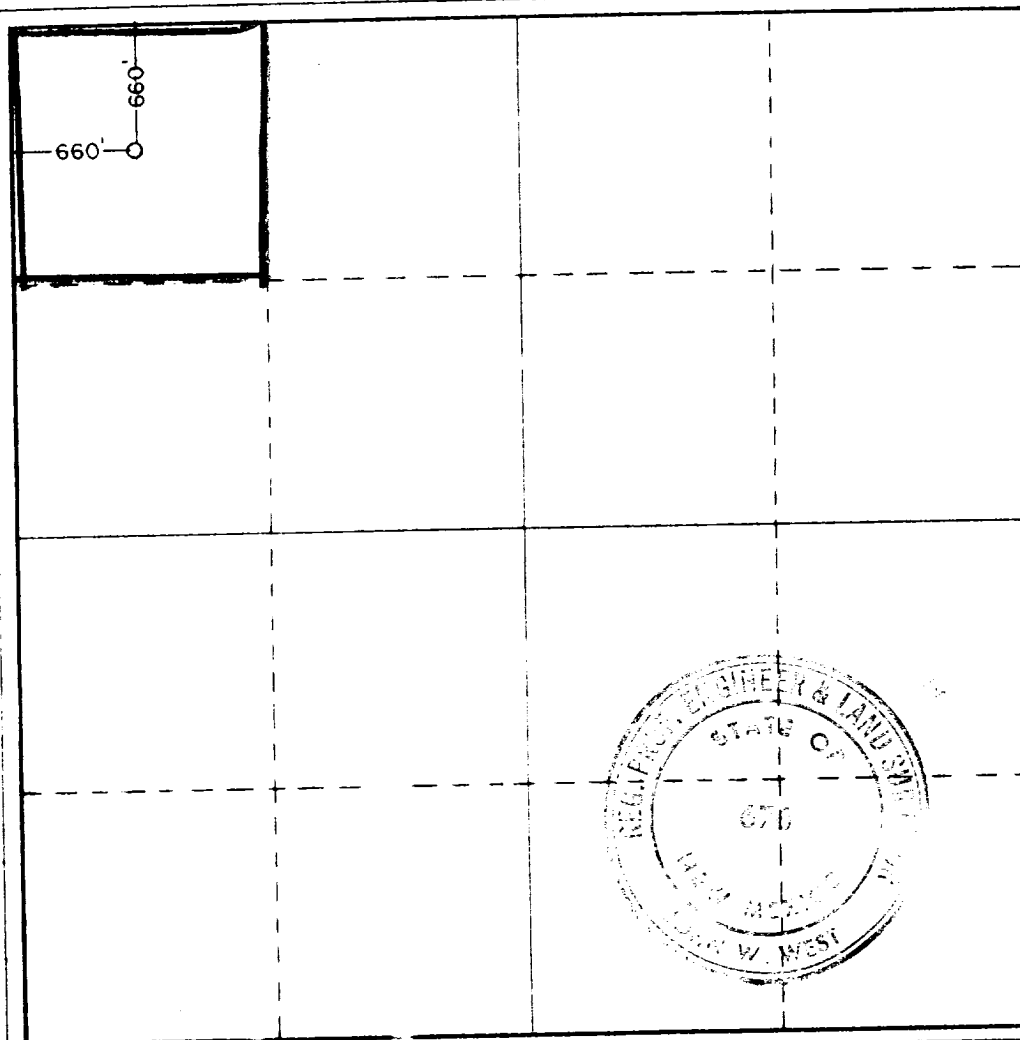

CERTIFICATION

I hereby certify that the information contained herein is true and complete to the best of my knowledge and belief.

*Gail Gunnels*

Name  
**Gail Gunnels**

Position  
**Production Secretary**

Company  
**Coronado Exploration Corp.**

Date  
**February 19, 1981**

I hereby certify that the well location shown on this plat was plotted from field notes of actual surveys made by me or under my supervision, and that the same is true and correct to the best of my knowledge and belief.

Date Surveyed  
**2-16-81**

Registered Professional Engineer and/or Land Surveyor

*John W. West*

Certificate No. **JOHN W. WEST 676**  
**PATRICK A. ROMERO 6863**  
**Ronald J. Eidson 3239**

0 330 660 990 1320 1650 1980 2310 2640 2970 3300 3630 3960 4290 4620 4950 5280 5610 5940 6270 6600