

NO. OF COPIES RECEIVED	6
DISTRIBUTION	
SANTA FE	1
FILE	1
U.S.G.S.	2
LAND OFFICE	1
OPERATOR	1

NEW MEXICO OIL CONSERVATION COMMISSION

RECEIVED

30-005-60878

Form C-101  
Revised 1-1-65

FEB 20 1981

O. C. D.  
ARTESIA, OFFICE

5A. Indicate Type of Lease	
STATE <input checked="" type="checkbox"/>	FEE <input type="checkbox"/>
5. State Oil & Gas Lease No. L-5247	

APPLICATION FOR PERMIT TO DRILL, DEEPEN, OR PLUG BACK

1a. Type of Work		7. Unit Agreement Name	
b. Type of Well OIL WELL <input type="checkbox"/> GAS WELL <input checked="" type="checkbox"/> OTHER <input type="checkbox"/>		Hernandez Draw	
DRILL <input checked="" type="checkbox"/> DEEPEN <input type="checkbox"/> PLUG BACK <input type="checkbox"/>		8. Farm or Lease Name Hernandez Draw	
c. Name of Operator Read & Stevens, Inc.		9. Well No. 1	
d. Address of Operator P.O. Box 1518, Roswell, NM 88201		10. Field and Pool, or Wildcat Wildcat	
4. Location of Well UNIT LETTER I LOCATED 1980 FEET FROM THE South LINE AND 660 FEET FROM THE East LINE OF SEC. 36 TWP. 4S RGE. 26E NMPM		12. County Chaves	
19. Proposed Depth 6800'		19A. Formation Montoya	
20. Rotary or C.T. C.T./Rotary		21. Elevations (Show whether OF, RI, etc.) 3897.6' GR	
21A. Kind & Status Plug. Bond Statewide		21B. Drilling Contractor Linton / WEK	
22. Approx. Date Work will start 2-28-81			

PROPOSED CASING AND CEMENT PROGRAM

SIZE OF HOLE	SIZE OF CASING	WEIGHT PER FOOT	SETTING DEPTH	SACKS OF CEMENT	EST. TOP
17 1/2"	12 3/4"	34#	30'	50 sx "C"	Circ.
11"	8 5/8"	24#	1500'	700 sx "C"	Circ.
7 7/8"	4 1/2"	10.5#	6800'	600 sx "C"	4000'

We propose to drill and test the Montoya formation. If commercial, 4 1/2" production casing will be run and cemented.

Linton will drill the surface hole with a cable tool rig.

WEK will move on location, approximately March 25, 1981, to finish the well.

Mud Program: 0-4200' Fresh water & Native mud.  
4200-5000' SW gel, X-PEL-G, Vis 31-33  
5000-6800' SW gel, X-PEL-G, flosal, Vis 31-45

BOP Program: 10" Shaffer Type 48E Double Hydraulic Series 900 Blowout Preventer w/Double Rams and rated to 3000 psi working pressure w/Payne dual control 3000 psi closing unit and Payne dual control 300 psi accumulator.

APPROVAL VALID FOR 180 DAYS  
PERMIT EXPIRES 8-26-81  
UNLESS DRILLING UNDERWAY

4. ABOVE SPACE DESCRIBE PROPOSED PROGRAM: IF PROPOSAL IS TO DEEPEN OR PLUG BACK, GIVE DATA ON PRESENT PRODUCTIVE ZONE AND PROPOSED NEW PRODUCTIVE ZONE. GIVE BLOWOUT PREVENTER PROGRAM, IF ANY.

I hereby certify that the information above is true and complete to the best of my knowledge and belief.

Signed Bruce Stobbs Title Petroleum Engineer Date 2-19-81  
(This space for State Use)

APPROVED BY W. A. Gressett TITLE SUPERVISOR, DISTRICT II DATE 2-26-81

CONDITIONS OF APPROVAL, IF ANY:

Subject to Case 7181  
3-11-81

**N MEXICO OIL CONSERVATION COMMISSION  
WELL LOCATION AND ACREAGE DEDICATION PLAT**

Form C-102  
Supersedes C-128  
Effective 1-1-65

All distances must be from the outer boundaries of the Section.

Operator <b>Read &amp; Stevens, Inc.</b>			Lease <b>Hernandez Draw Unit</b>		Well No. <b>1</b>
Unit Letter <b>I</b>	Section <b>36</b>	Township <b>4 South</b>	Range <b>26 East</b>	County <b>Chaves</b>	
Actual Footage Location of Well: <div style="display: flex; justify-content: space-between;"> <span><b>1980</b> feet from the <b>south</b> line and</span> <span><b>660</b> feet from the <b>east</b> line</span> </div>					
Ground Level Elev. <b>3897.6</b>	Producing Formation <b>Montoya</b>	Pool <b>Wildcat</b>		Dedicated Acreage: <b>320</b> Acres	

1. Outline the acreage dedicated to the subject well by colored pencil or hachure marks on the plat below.
2. If more than one lease is dedicated to the well, outline each and identify the ownership thereof (both as to working interest and royalty).
3. If more than one lease of different ownership is dedicated to the well, have the interests of all owners been consolidated by communitization, unitization, force-pooling, etc?

☐ Yes    ☒ No    If answer is "yes," type of consolidation \_\_\_\_\_

If answer is "no," list the owners and tract descriptions which have actually been consolidated. (Use reverse side of this form if necessary.) \_\_\_\_\_

No allowable will be assigned to the well until all interests have been consolidated (by communitization, unitization, forced-pooling, or otherwise) or until a non-standard unit, eliminating such interests, has been approved by the Commission.

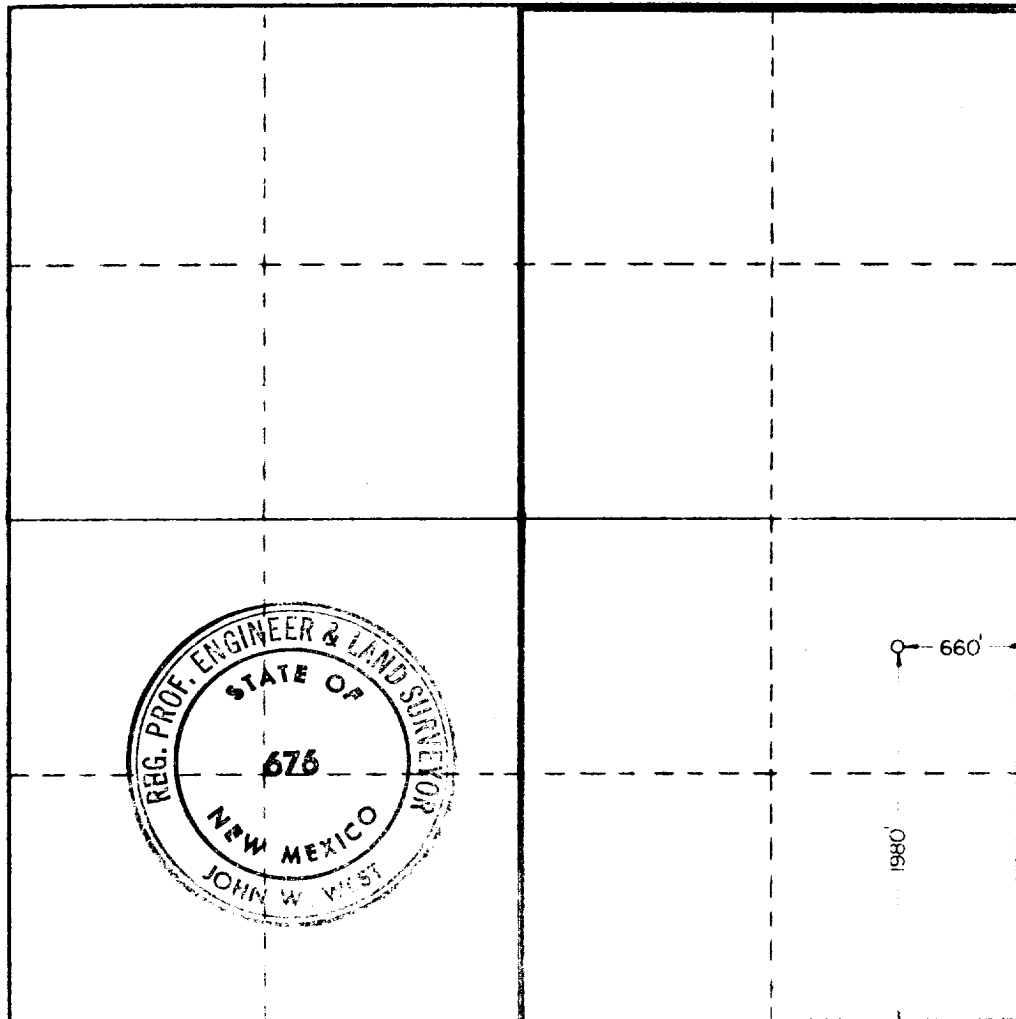

**CERTIFICATION**

I hereby certify that the information contained herein is true and complete to the best of my knowledge and belief.

*Paula Sturiale*

Name

**Paula Sturiale**

Position

**Authorized Agent**

Company

**Read & Stevens, Inc.**

Date

**2-19-81**

I hereby certify that the well location shown on this plat was plotted from field notes of actual surveys made by me or under my supervision, and that the same is true and correct to the best of my knowledge and belief.

Date Surveyed

**2-18-81**

Registered Professional Engineer and/or Land Surveyor

*John W. West*