

10.00.0000

SUBMIT IN TRIPLICATE\*  
(Other instructions on  
reverse side)Form approved,  
Budget Bureau No. 42-R1

30-005-60880

DEPARTMENT  
OF THE INTERIORBUREAU OF LAND  
MANAGEMENT  
GEOLOGICAL SURVEY

## APPLICATION FOR PERMIT

## TO DRILL, DEEPEN, OR PLUG BACK

## 1a. TYPE OF WORK

DRILL ☒DEEPEN ☐PLUG BACK ☐

## b. TYPE OF WELL

OIL  
WELL ☐GAS  
WELL ☒

OTI

## 2. NAME OF OPERATOR

Yates Petroleum Corpo

## 3. ADDRESS OF OPERATOR

207 South 4th Street,

## 4. LOCATION OF WELL (Report location clear of surface)

660 FNL &amp; -

At proposed prod. zone

## 14. DISTANCE IN MILES AND DIRECTION FROM

Approx. 22 Miles N NE of Ros

## 15. DISTANCE FROM PROPOSED\*

LOCATION TO NEAREST  
PROPERTY OR LEASE LINE, FT.  
(Also to nearest drilg. unit line, if any)18. DISTANCE FROM PROPOSED LOCATION\*  
TO NEAREST WELL, DRILLING, COMPLETE  
OR APPLIED FOR, ON THIS LEASE, FT.

## 21. ELEVATIONS (Show whether DF, RT, GR,

3633.8 GR

## 23.

SIZE OF HOLE	SIZE OF CASING
15"	10 3/4"
9 5/8"	7"
6 1/4"	4 1/2 "

We propose to drill and test  
400' of surface casing with  
below the water zone. If

MUD PROGRAM: FW gel and  
dris

BOP PROGRAM: BOP's will

SINGLE ZONE ☐ MULTIPLE ZONE ☐

ion

Rosalia, New Mexico 88210

d in accordance with any State requirements.)\*

FEL

## NEAREST TOWN OR POST OFFICE\*

Rosalia, New Mexico

560'

## 16. NO. OF ACRES IN LEASE

## 19. PROPOSED DEPTH

.8 mile

Approx. 4300'

17. NO. OF ACRES ASSIGNED  
TO THIS WELL

160

## 20. ROTARY OR CABLE TOOLS

Rotary

## 22. APPROX. DATE WORK WILL START

As soon as approved

## PROPOSED CASING AND CEMENTING PROGRAM

WEIGHT PER FOOT	SETTING DEPTH	QUANTITY OF CEMENT
32.7# J-55	Approx. 400'	Circulate
23# J-55	Approx. 1450'	Circulate
9.5# J-55	TD	

the Abo and intermediate formations. Approximately  
be set and cement circulated. Casing will be set 100'  
numerical, 4 1/2" production casing will be run.

to 400', native to 1450'  
KCL to TD. MW 8.7 - 9.0, Vis 34-39, WL 14-7

installed on 7" casing and tested daily.

IN ABOVE SPACE DESCRIBE PROPOSED PROGRAM  
zone. If proposal is to drill or deepen dis-  
preventer program, if any.

## 24.

SIGNED

(This space for Federal or State office)

PERMIT NO.

GEORGE H. S.

APPROVED BY

CONDITIONS OF APPROVAL, IF ANY:

TITLE

Geographer

DATE 1-14-81

APPROVAL DATE

TITLE

DATE

FEB 19 1981

N  
WEL

MEXICO OIL CONSERVATION COMMISS  
LOCATION AND ACREAGE DEDICATION PLAT

Form C-102  
Supersedes C-12  
Effective 1-1-65

A:

ences must be from the outer boundaries of the Section.

Operator Yates Petroleum Corporation		
Unit Letter A	Section 35	Tow
Actual Footage Location of Well: 660' feet from the North		
Ground Level Elev. 3616.1	Producing Formation ABO	

Lease Federal HY		Well No. 3
outh	Range 25 East	County Chaves
line and 760 feet from the East line		Dedicated Acreage: 160 Acres
Pool WILDCAT		

1. Outline the acreage dedicated

2. If more than one lease is dedi  
interest and royalty).

3. If more than one lease of differ  
dated by communitization, unitiz

☐ Yes ☐ No If answer

If answer is "no," list the owne  
this form if necessary.)

No allowable will be assigned to  
forced-pooling, or otherwise) or ur  
sion.

e subject well by colored pencil or hachure marks on the plat below.

d to the well, outline each and identify the ownership thereof (both as to working

wnership is dedicated to the well, have the interests of all owners been consoli  
t, force-pooling, etc?

'yes,' type of consolidation

id tract descriptions which have actually been consolidated. (Use reverse side of

well until all interests have been consolidated (by communitization, unitization,  
non-standard unit, eliminating such interests, has been approved by the Commis-

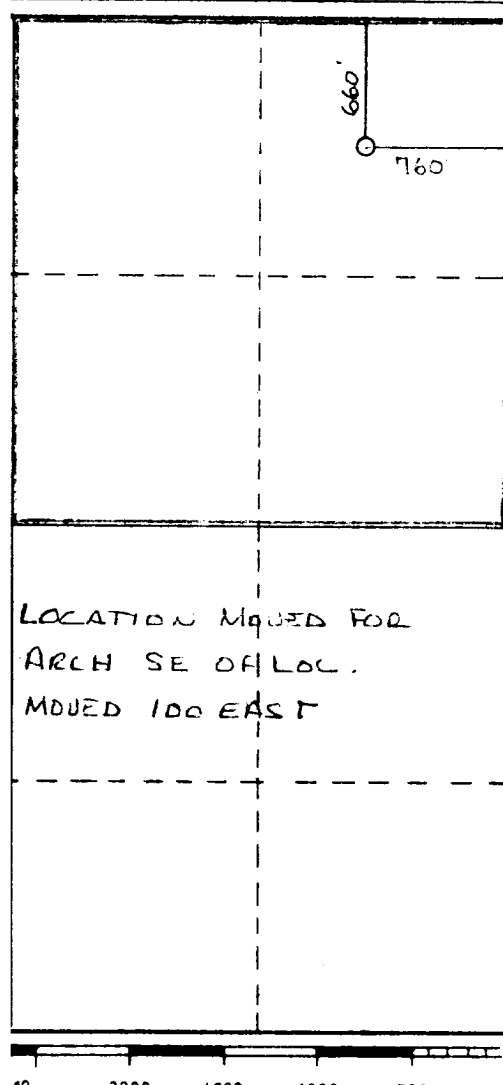
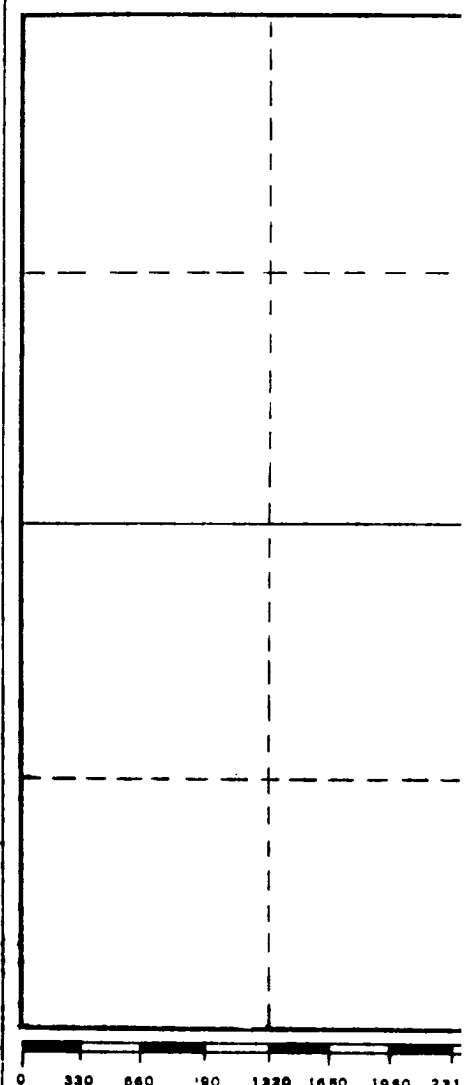

CERTIFICATION

I hereby certify that the information con-  
tained herein is true and complete to the  
best of my knowledge and belief.

*Gliserio Rodriguez*  
Name

GLISERIO RODRIGUEZ  
Position

GEOGRAPHER

Company

YATES PETROLEUM CORP.

Date

I hereby certify that the well location  
shown on this plat was plotted from field  
notes of actual location made by me or  
under my supervision and that the same  
is true and correct to the best of my  
knowledge.

Date Surveyed

February 10, 1981

Registered Professional Engineer  
and/or Land Surveyor

*Gliserio Rodriguez*

Certificate No.

3640

N  
WEL

MEXICO OIL CONSERVATION COMMISS  
LOCATION AND ACREAGE DEDICATION PLAT

Form C-10  
Supersedes  
Effective 1-

ances must be from the outer boundaries of the Section.

Operator <b>YATES PETROLEUM CORPO</b>		
Unit Letter <b>"A"</b>	Section <b>35</b>	Tow
Actual Footage Location of Well: <b>660</b> feet from the <b>Nort</b>		
Ground Lvel Elev. <b>3633.8</b>	Producing Formation <b>ABO</b>	

Lease	Well No. <b>3</b>
Federal H Y	
Range <b>25 East</b>	County <b>Chaves</b>
line and <b>660</b> feet from the <b>East</b> line	
Pool <b>UNDES. ABO</b>	Dedicated Acreage: <b>160</b>

1. Outline the acreage dedicated

2. If more than one lease is dedi  
interest and royalty).

3. If more than one lease of differ  
dated by communitization, unitiz

☐ Yes ☐ No If answer

If answer is "no," list the owne  
this form if necessary.)

No allowable will be assigned to  
forced-pooling, or otherwise) or u  
sion.

e subject well by colored pencil or hachure marks on the plat below.

d to the well, outline each and identify the ownership thereof (both as to work

wnership is dedicated to the well, have the interests of all owners been consol  
i, force-pooling, etc?

'yes,' type of consolidation

nd tract descriptions which have actually been consolidated. (Use reverse side

well until all interests have been consolidated (by communitization, unitizati  
(non-standard unit, eliminating such interests, has been approved by the Comm

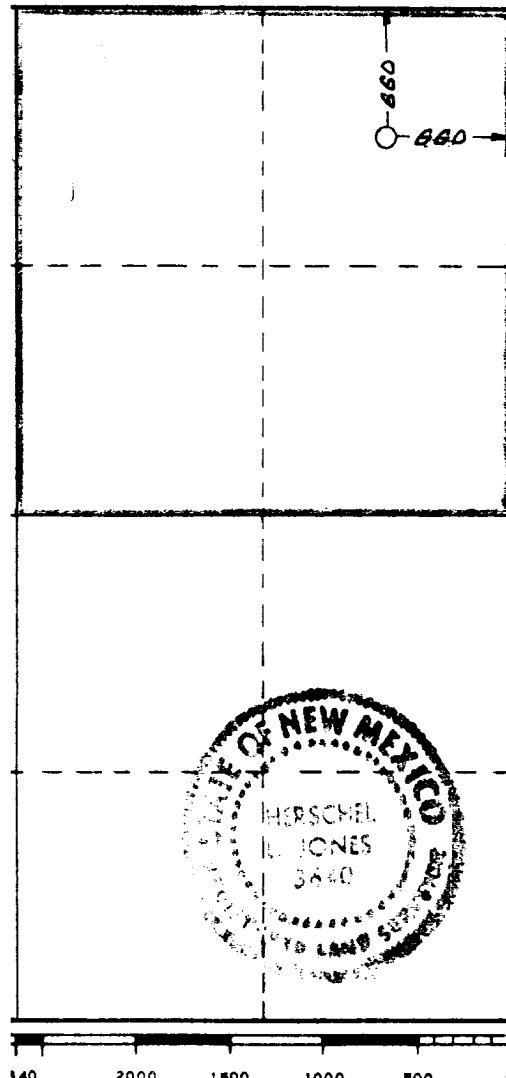
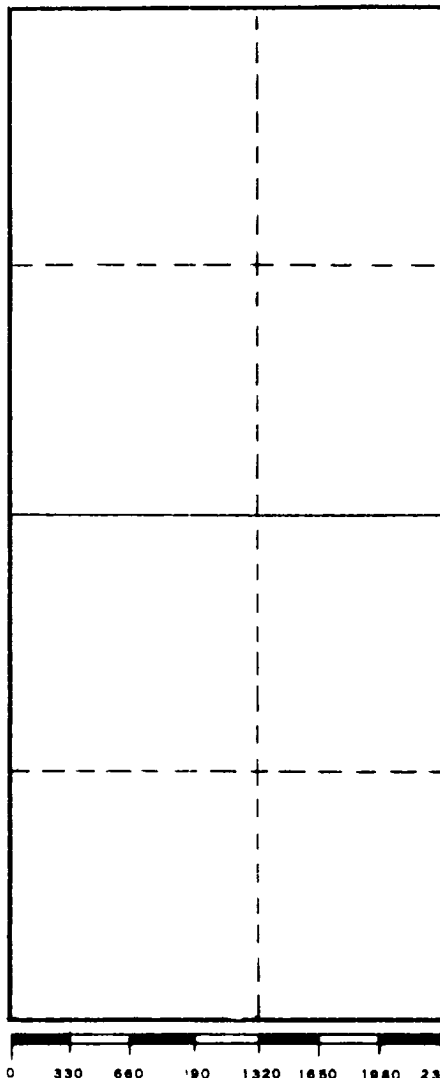

CERTIFICATION

I hereby certify that the information con  
tained herein is true and complete to  
best of my knowledge and belief.

*Gliserio A. Rodriguez*  
Name  
**GLISERIO A. RODRIGUEZ**  
Position  
**GEOGRAPHER**  
Company  
**YATES PETROLEUM CORP**  
Date  
**1-14-81**

I hereby certify that the well loca  
shown on this plat was plotted from  
notes of actual surveys made by m  
under my supervision, and that the  
is true and correct to the best of  
knowledge and belief.

Date Surveyed  
**January 10, 19**  
Registered Professional Engineer  
and/or Land Surveyor  
*Herschel L. Jones*  
Certificate No.  
**3640**

Yates Petroleum Corporation  
Federal HY #3  
660' FNL and 660' FEL  
Section 35 - T7S - R25E  
Chaves County, New Mexico

In conjunction with Form  
Petroleum Corporation sub  
accordance with USGS requ

51C, Application for Permit to Drill subject well, Yates  
; the following ten items of pertinent information in  
ments:

1. The geologic surface      ation is quaternary alluvium.
2. The estimate tops of      logic markers are as follows:  
  
    San Andres - 420  
    Glorieta - 1305  
    Abo - 3645  
    Wolfcamp - 4395  
    T.D. - 4450
3. The estimated depths      which anticipated water, oil, or gas formations are expect  
    to be encountered:  
  
    Water: Approximately 5'  
  
    Oil or Gas: Abo
4. Proposed Casing Progr      See Form 9-331C.
5. Pressure Control Equi      nt: See Form 9-331C and Exhibit B.
6. Mud Program: See For      -331C.
7. Auxiliary Equipment:      lly Cock; pit level indicators and flow sensor equipment;  
    b with full-opening valve on floor, drill pipe connection.
8. Testing, Logging and      ing Program:  
  
    Samples: Surface cas      to T.D.  
    DST's: As Warrant  
    Logging: Intermedia      asing to T.D.  
            CNL-FDC T.1      o casing with GR-CNL on to surface and  
            DLL from T      to casing with selected min. RxO.
9. No abnormal pressure.      temperatures are anticipated.
10. Anticipated starting      e: As soon as possible after approval

MULT JOINT SURFACE USE AND OPERATIONS PLAN

Yates Petroleum Corporation  
Federal HY #3  
Section 35 - T7S - R25E  
660' FNL and 660' FEL  
(Exploratory Well)

This plan is submitted with the above described well. The proposed well, the proposed surface disturbance in the surface after completion be made of the environment

Form 9-331C, Application for Permit to Drill, covering the purpose of this plan is to describe the location of the construction activities and operations plan, the magnitude of the operations, so that a complete appraisal can be made of the effect associated with the operation.

1. EXISTING ROADS.

Exhibit A is a portion of the proposed location miles NNE of Roswell, in red and green on Exhibit A.

of a county map showing the well and roads in the vicinity. The proposed well site is located approximately 22 miles west of Mexico and the access route to the location is indicated on Exhibit A.

DIRECTIONS:

1. Proceed east from
2. Turn east from approximately 2 1/2 miles and continue NE for 6 miles. Turn east onto the pipeline leading to an earthen windmill.

swell on Highway 285 for a distance of approximately 13 miles. Then turn east onto the pipeline leading to an earthen windmill. The new road will start here going past an old

2. PLANNED ACCESS ROAD.

- A. Then proposed new origin to the south-to-south direction
- B. The new road will be 12 feet in width (Driving surface) and will ramp over the pipeline at least
- C. The new road will be bladed and crowned, with drainage on one side. Two turnouts will be built
- D. The route of the road has been flagged.

cess will be approximately 2600' in length from point of edge of the drilling pad. The road will lie in a north-south direction. The new road will be 12 feet in width (Driving surface) and will ramp over the pipeline at least 12 feet in width (Driving surface) and will ramp over the pipeline at least

3. LOCATION OF EXISTING

L.

- A. There is drilling activity within a one-mile radius of the wellsite.

tivity within a one-mile radius of the wellsite.

4. LOCATION OF EXISTING

/OR PROPOSED FACILITIES.

- A. There are no production facilities on this section of the lease at the present time.
- B. In the event that the well is productive, the necessary production facilities will be installed at the drilling pad. If the well is productive oil, a gas engine or diesel self-contained unit will be used to provide the necessary power. No power will be required if the well is productive of gas.

ion facilities on this section of the lease at the present time.

e well is productive, the necessary production facilities will be installed at the drilling pad. If the well is productive oil, a gas engine or diesel self-contained unit will be used to provide the necessary power. No power will be required if the well is productive of gas.

5. LOCATION AND TYPE OF WATER SUPPLY.

- A. It is planned to fill the proposed well with a fresh water system. The water will be obtained from commercial sources and will be hauled to the location by truck over the existing and proposed roads shown in Exhibit A.

6. SOURCE OF CONSTRUCTION MATERIALS.

- A. There is no existing pit of construction material so none will be used.

7. METHODS OF HANDLING WASTE DISPOSAL.

- A. Drill cuttings will be disposed of in the reserve pits.
- B. Drilling fluids will be allowed to evaporate in the reserve pits until the pits are dry.
- C. Water produced during operations will be collected in tanks until hauled to an approved disposal site, or separate disposal application will be submitted to the USGS for appropriate approval.
- D. Oil produced during operation will be stored in tanks until sold.
- E. Current laws and regulations pertaining to the disposal of human waste will be complied with.
- F. Trash, waste paper, garbage and junk will be buried in a separate trash pit and covered with a minimum of 24 inches dirt. All waste material will be contained to prevent scattering by the wind.
- G. All trash and debris will be buried or removed from the wellsite within 30 days after finishing drilling and/or completion operations.

8. ANCILLARY FACILITIES.

- A. None required.

9. WELLSITE LAYOUT.

- A. Exhibit C shows the relative location and dimensions of the well pad, the reserve pits, etc.
- B. The location surface is sloping. Minor cut and fill will be required on localities.
- C. The reserve pits will be plastic lined.
- D. A 400' X 400' area has been staked and flagged.

10. PLANS FOR RESTORATION OF THE SURFACE.

- A. After finishing drilling and/or completion operations, all equipment and other material not needed for further operations will be removed. The location will be cleaned of all trash and junk to leave the wellsite in as aesthetically pleasing a condition as possible.

- B. Unguarded pits, if any, containing fluids will be fenced until they have dried and leveled.
- C. If the proposed well is non-productive, all rehabilitation and/or vegetation requirements of the BLM and the USGS will be complied with and will be accomplished as expeditiously as possible. All pits will be filled leveled within 90 days after abandonment.

11. OTHER INFORMATION.

- A. Topography: The surface in the vicinity of the wellsite consists of sloping dunes. The immediate area of the wellsite is discussed above in paragraph 9B.
- B. Flora and Fauna: The vegetation cover on wellsite consists of mesquite and miscellaneous desert growth. No wildlife was observed, but the wildlife in the area is those typical of semi-arid desert land. The area is usually used for cattle grazing.
- C. The Pecos River is approximately 1½ miles SE.
- D. There are no inhabited dwellings in the vicinity of the proposed well.
- E. Surface Ownership The wellsite is on federal surface.
- F. There is no evidence of any archeological, historical or cultural sites in the area.

12. OPERATOR'S REPRESENTATIVE.

- A. The field representative responsible for assuring compliance with the approved surface use plan

Gliserio "Rod" Rodriguez  
Yates Petroleum Corporation  
207 South 4th Street  
Artesia, New Mexico 88210  
(505) 746-3558

13. CERTIFICATION.

I hereby certify that I, persons under my direct supervision, have inspected the proposed drillsite and access route, that I am familiar with the conditions which presently exist; that the statements made in this plan are to the best of my knowledge true and correct; and, that the work associated with the operations proposed herein will be performed by Yates Petroleum Company and its contractors and subcontractors in conformity with this plan and the terms and conditions under which it is approved.

1-25-81  
Date

  
Gliserio Rodriguez, Geologist

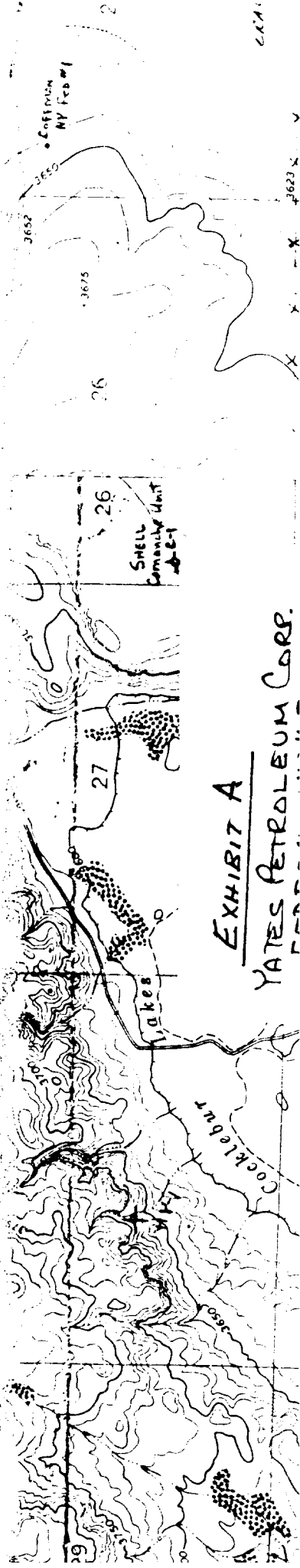

**EXHIBIT A**  
**YATES PETROLEUM CORP.**

SEC. 33 - T13S - R15E  
 660' FNL - 660' FEL  
 CHAVES, C. TY. NM

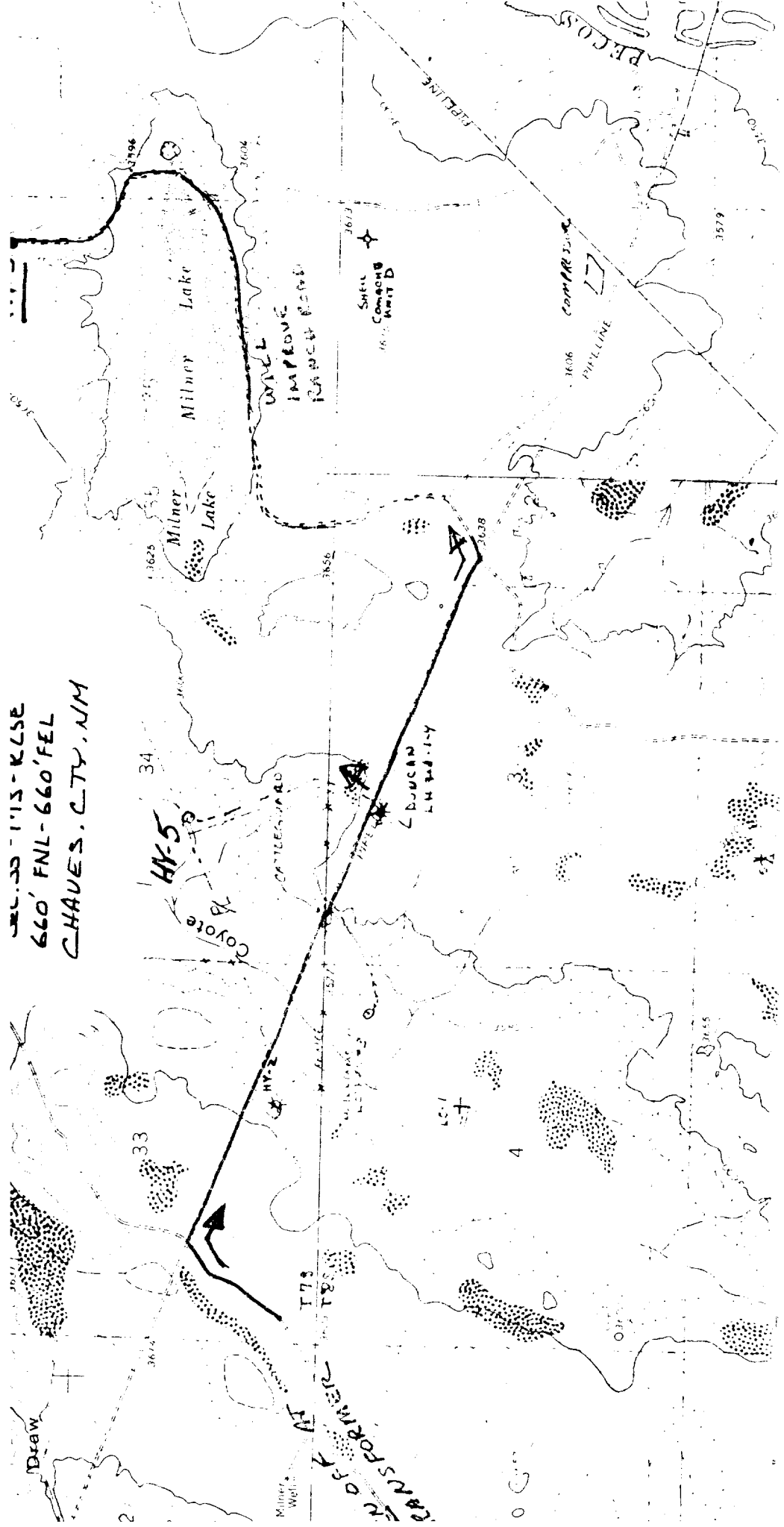



# EXHIBIT B

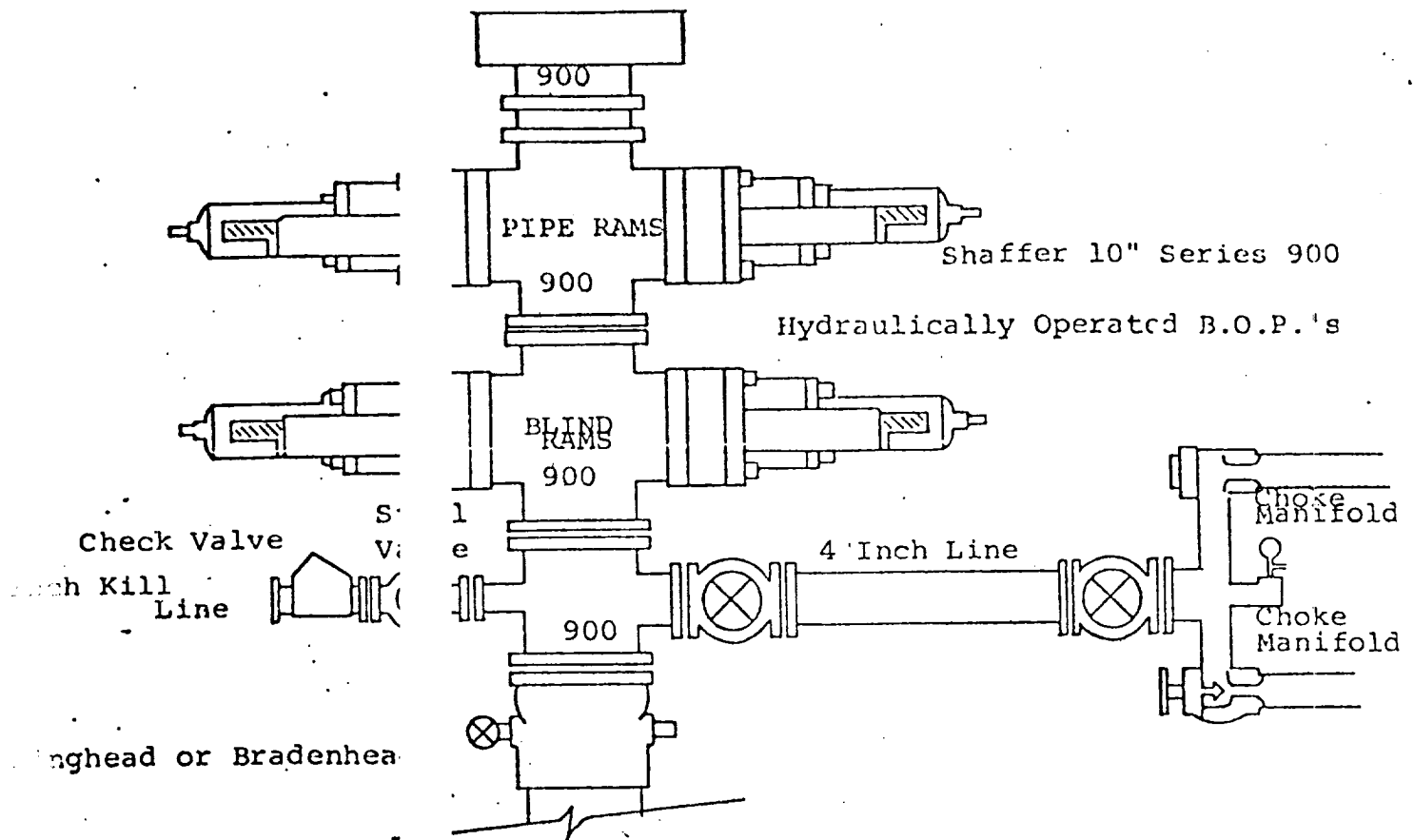

## FOLLOWING CONSTITUT

All preventers to be installed prior to Choke outlet to be Kill line to be of All connections from hole or tube a minimum The available closing required with sufficient All connections to to that of the B.O. Inside blowout preventer Operating controls Hole must be kept full not responsible for D. P. float must be

## MINIMUM BLOWOUT PREVENTER REQUIREMENTS

hydraulically operated with secondary manual controls  
 Allowing out from under casing.  
 Minimum of 4" diameter.  
 Steel construction of 2" minimum diameter.  
 Operating manifolds to preventers to be all steel.  
 A of one inch in diameter.  
 Pressure shall be at least 15% in excess of that  
 Sufficient volume to operate the B.O.P.'s.  
 1 from preventer to have a pressure rating equivalent  
 's.  
 er to be available on rig floor.  
 Located a safe distance from the rig floor.  
 Used on trips below intermediate casing. Operator  
 Blowouts resulting from not keeping hole full.  
 Installed and used below zone of first gas intrusion.

# EXHIBIT C

## YATES PETROLEUM CORPORATION

