

NO. OF COPIES RECEIVED	
DISTRIBUTION	
DATE	
FILE	1
U.S.G.S.	1
LAND OFFICE	
OPERATOR	

NEW MEXICO OIL CONSERVATION COMMISSION

FEB 25 1981

30-005-60886

Form C-101
Revised 1-1-85

5A. Indicate Type of Lease

STATE ☐ FEDERAL ☐

5. State Oil & Gas Lease No.

APPLICATION FOR PERMIT TO DRILL, DEEPEN, OR PLUG BACK

1a. Type of Work

b. Type of Well

DRILL ☒

DEEPEN ☐

PLUG BACK ☐

OIL WELL ☒

GAS WELL ☐

OTHER

SINGLE ZONE ☐

MULTIPLE ZONE ☐

2. Name of Operator

Stevens Oil Company ✓

3. Address of Operator

P. O. Box 2203, Roswell, New Mexico 88201

4. Location of Well

UNIT LETTER H

LOCATED 1650

FEET FROM THE

North

LINE

AND 990

FEET FROM THE East

LINE OF SEC. 6

TWP. 9-S

RGE. 29-E

NMPM

7. Unit Agreement Name

8. Farm or Lease Name

O'Brien "L"

9. Well No.

5

10. Field and Pool, or Wildcat

Twin Lakes-San Andres Assoc.

12. County

Chaves

19. Proposed Depth

3000'

19A. Formation

San Andres

20. Rotary or C.T.

Rotary

21. Elevations (Show whether DF, RT, etc.)

3963.3 Gr; 3973.3 KB

21A. Kind & Status Plug. Bond

Statewide

21B. Drilling Contractor

Artesia Fishing Tool

22. Approx. Date Work will start

April 1, 1981

23.

PROPOSED CASING AND CEMENT PROGRAM

SIZE OF HOLE	SIZE OF CASING	WEIGHT PER FOOT	SETTING DEPTH	SACKS OF CEMENT	EST. TOP
11"	8 5/8"	20#	120'	Circulate	Surf.
7 7/8 "	4 1/2"	9.5#	3000'	175	2050'

Will drill with water and mud to T.D., log, and if indicated productive, case to T.D. and perforate in producing intervals.

Adequate blowout preventers will be used.

APPROVAL NO. 180
PERMIT NO. 9-3-81
UNLESS FILING UNDERWAY

IN ABOVE SPACE DESCRIBE PROPOSED PROGRAM; IF PROPOSAL IS TO DEEPEN OR PLUG BACK, GIVE DATA ON PRESENT PRODUCTIVE ZONE AND PROPOSED NEW PRODUCTIVE ZONE. GIVE BLOWOUT PREVENTER PROGRAM, IF ANY.

I hereby certify that the information above is true and complete to the best of my knowledge and belief.

Signed W. A. Gressitt Title Owner Date 2-24-81

(This space for State Use)

APPROVED BY W. A. Gressitt TITLE SUPERVISOR, DISTRICT II DATE MAR 03 1981

CONDITIONS OF APPROVAL, IF ANY:

N MEXICO OIL CONSERVATION COMMISS
WELL LOCATION AND ACREAGE DEDICATION PLAT

Form C-102
 Supersedes C-128
 Effective 1-1-65

All distances must be from the outer boundaries of the Section

Operator Stevens Oil Co.			Lease O'Brien "L"		Well No. 5
Tract Letter H	Section 6	Township 9 South	Range 29 East	County Chaves	
A. First Four (4) Location of Well: 1650 feet from the north line and 990 feet from the east line.					
Ground Level Elev. 3963.3	Producing Formation San Andres		Pool <i>and</i> Twin Lakes-San Andres Assoc.		Dedicated Acreage: 40 Acres

1. Outline the acreage dedicated to the subject well by colored pencil or hachure marks on the plat below.
2. If more than one lease is dedicated to the well, outline each and identify the ownership thereof (both as to working interest and royalty).
3. If more than one lease of different ownership is dedicated to the well, have the interests of all owners been consolidated by communitization, unitization, force-pooling, etc?
☐ Yes ☐ No If answer is "yes," type of consolidation _____

If answer is "no," list the owners and tract descriptions which have actually been consolidated. (Use reverse side of this form if necessary.) _____

No allowable will be assigned to the well until all interests have been consolidated (by communitization, unitization, forced-pooling, or otherwise) or until a non-standard unit, eliminating such interests, has been approved by the Commission.

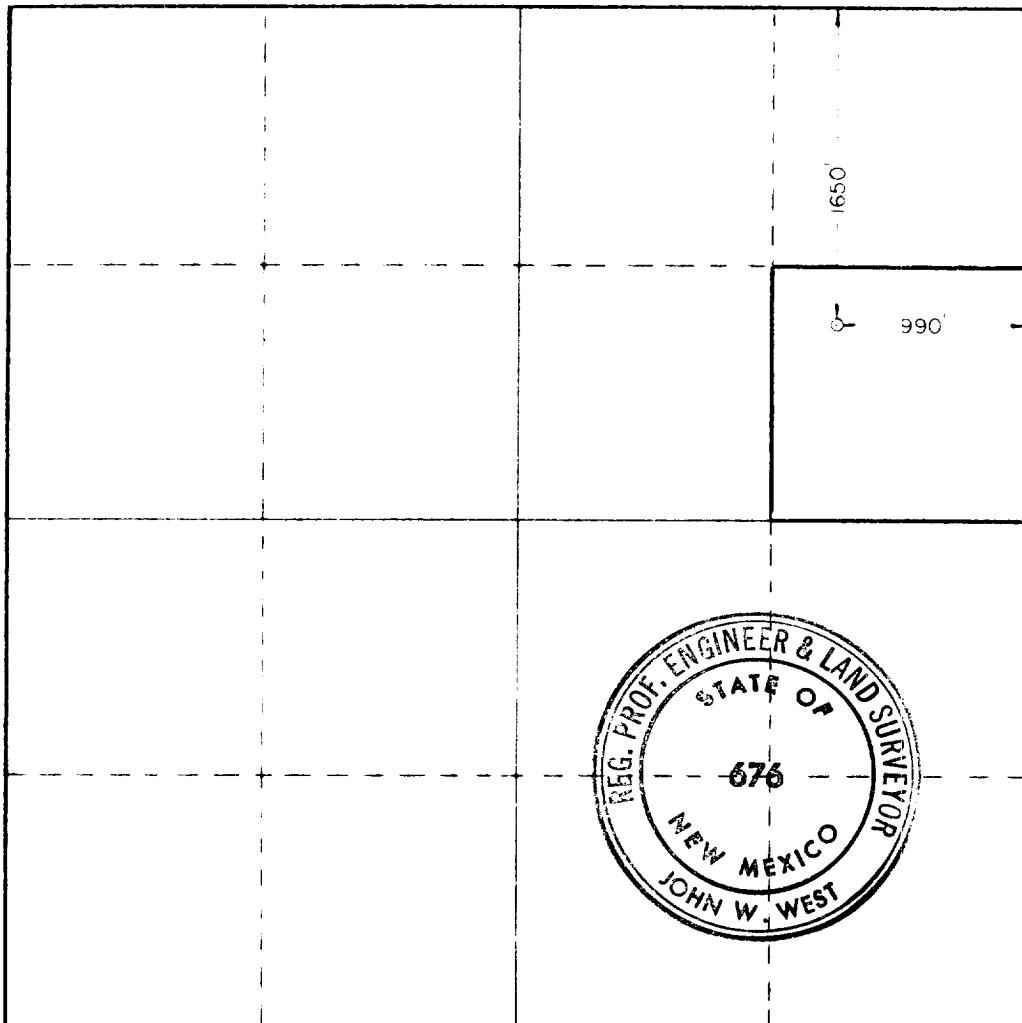

CERTIFICATION

I hereby certify that the information contained herein is true and complete to the best of my knowledge and belief.

Name: *Donald J. Eidson*
 Position: **Owner**

Company: **Stevens Oil Co.**

Date: **2-24-81**

I hereby certify that the well location shown on this plat was plotted from field notes of actual surveys made by me or under my supervision, and that the same is true and correct to the best of my knowledge and belief.

Date Surveyed: **1-28-81**

Registered Professional Engineer and Land Surveyor

Donald J. Eidson
 Certificate No. **JOHN W. WEST 676**
PATRICK A. ROMERO 6663
Ronald J. Eidson 3239

