

NO. OF COPIES RECEIVED	
DISTRIBUTION	
SANTA FE	1
FILE	1
U.S.G.S.	2
LAND OFFICE	
OPERATOR	1

NEW MEXICO OIL CONSERVATION COMMISSION

FEB 25 1981

O. C. D.  
ARTESIA, OFFICE

30-005-60890

Form C-101  
Revised 1-1-65

5A. Indicate Type of Lease  
STATE ☐ FEE ☒

5. State Oil & Gas Lease No.

APPLICATION FOR PERMIT TO DRILL, DEEPEN, OR PLUG BACK

1. Type of Work

DRILL ☒

DEEPEN ☐

PLUG BACK ☐

2. Type of Well

OIL WELL ☐

GAS WELL ☒

OWNER

SINGLE ZONE ☒

MULTIPLE ZONE ☐

3. Name of Operator

Mesa Petroleum Co.

4. Address of Operator

1000 Vaughn Building / Midland, Texas 79701

5. Location of Well

UNIT LETTER J LOCATED 1980 FEET FROM THE SOUTH LINE

ND 1980 FEET FROM THE EAST LINE OF SEC. 17 TWP. 5S RGE. 24E NMPM

7. Unit Agreement Name

8. Farm or Lease Name

BEIL ESTATE

9. Well No.

1

10. Field and Pool, or Wildcat

WILDCAT ABO

12. County

CHAVES

19. Proposed Depth

4300'

19A. Formation

ABO

20. Rotary or C.T.

ROTARY

6. Elevations (Show whether DF, RT, etc.)

4096.0' GR

21A. Kind & Status Plug. Bond

BLANKET

21B. Drilling Contractor

DESERT

22. Approx. Date Work will start

MAY 23, 1981

PROPOSED CASING AND CEMENT PROGRAM

SIZE OF HOLE	SIZE OF CASING	WEIGHT PER FOOT	SETTING DEPTH	SACKS OF CEMENT	EST. TOP
17 1/2"	13 3/8"	48#	800'	500	SURFACE
11"	8 5/8"	24#	1500'	600	SUFFICIENT TO
7 7/8"	4 1/2"	10.5#	4300'	500	COVER ALL PAY

Propose to drill 17 1/2" hole to 800' using air. Will set 13 3/8" surface casing and cement to surface. Will reduce hole to 11" and drill to 1500' to set 8 5/8" intermediate casing. Will nipple up ram type BOP's and reduce hole to 7 7/8" and drill to total depth with air, foam, or mud as required. After log evaluation, 4 1/2" casing may be run and cemented back to surface casing or with sufficient kinds and amounts to isolate and seal off any fresh water, oil, or gas zones encountered.

Gas Sales Are Not Dedicted

APPROVAL VALID FOR 180 DAYS  
PERMIT EXPIRES 9-6-81  
UNLESS DRILLING UNDERWAY

XC: NMOCD (6), TLS, CEN RCDS, ACCTG, HOBBS, MEC, LAND, PARTNERS, FILE

ABOVE SPACE DESCRIBE PROPOSED PROGRAM: IF PROPOSAL IS TO DEEPEN OR PLUG BACK, GIVE DATA ON PRESENT PRODUCTIVE ZONE AND PROPOSED NEW PRODUCTION ZONE. GIVE BLOWOUT PREVENTER PROGRAM, IF ANY.

reby certify that the information above is true and complete to the best of my knowledge and belief.

sed R. E. Mark Title Regulatory Coordinator Date FEBRUARY 24, 1981

(This space for State Use)

PROVED BY W. A. Gressitt TITLE SUPERVISOR DISTRICT 1 DATE MAR 06 1981

EDITIONS OF APPROVAL, IF ANY:

N MEXICO OIL CONSERVATION COMMISS  
WELL LOCATION AND ACREAGE DEDICATION PLAT

Form C-102  
Supersedes C-128  
Effective 1-1-65

All distances must be from the outer boundaries of the Section

Operator <b>Mesa Petroleum Co.</b>		Lease <b>Bell Estate</b>		Well No. <b>1</b>	
Tract Letter <b>J</b>	Section <b>17</b>	Township <b>5 S</b>	Range <b>24 E</b>	County <b>Chaves County</b>	
Actual Footage Location of Well: <b>1980</b> feet from the <b>South</b> line and <b>1980</b> feet from the <b>East</b> line					
Ground Level Elev. <b>4096.0</b>	Producing Formation <b>ABO</b>	Pool <b>WILDCAT</b>		Dedicated Acreage: <b>SE/4 160</b> Acres	

1. Outline the acreage dedicated to the subject well by colored pencil or hatchure marks on the plat below.
2. If more than one lease is dedicated to the well, outline each and identify the ownership thereof (both as to working interest and royalty).
3. If more than one lease of different ownership is dedicated to the well, have the interests of all owners been consolidated by communitization, unitization, force-pooling, etc?

☐ Yes ☐ No If answer is "yes," type of consolidation \_\_\_\_\_

If answer is "no," list the owners and tract descriptions which have actually been consolidated. (Use reverse side of this form if necessary.) \_\_\_\_\_

No allowable will be assigned to the well until all interests have been consolidated (by communitization, unitization, forced-pooling, or otherwise) or until a non-standard unit, eliminating such interests, has been approved by the Commission.

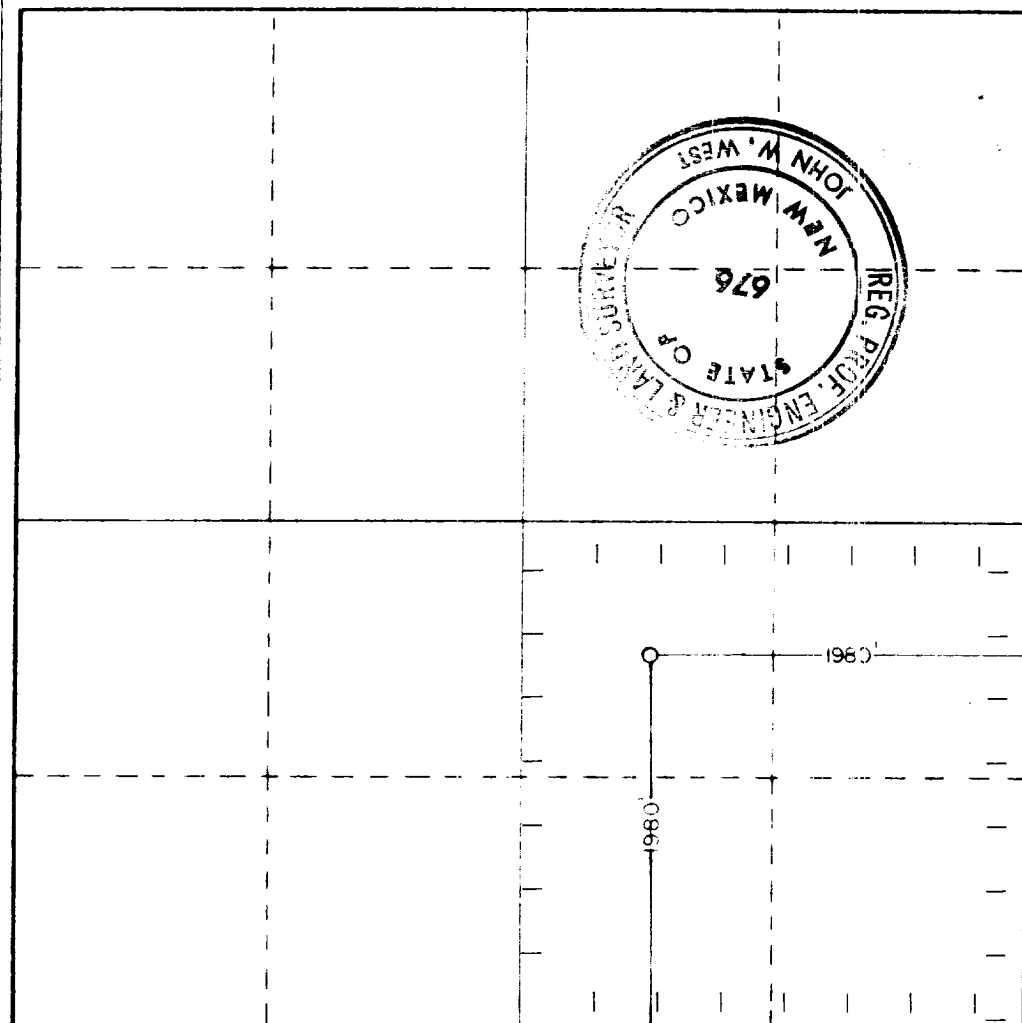

CERTIFICATION

I hereby certify that the information contained herein is true and complete to the best of my knowledge and belief

*R. E. Mathis*

Name  
**R. E. MATHIS**

Position  
**REGULATORY COORDINATOR**

Company  
**MESA PETROLEUM CO.**

Date  
**FEBRUARY 24, 1981**

I hereby certify that the well location shown on this plat was plotted from field notes of actual surveys made by me or under my supervision, and that the same is true and correct to the best of my knowledge and belief.

Date Surveyed

**2-9-81**

Registered Professional Engineer  
and/or Land Surveyor

*John W. West*

Certificate No. **JOHN W. WEST 676**  
**PATRICK A. ROMERO 6868**  
**Ronald J. Eidson 3239**

0 330 660 990 1320 1650 1980 2310 2640 2000 1500 1000 500 0