

NO. OF COPIES RECEIVED	
DISTRIBUTION	
SANTA FE	
FILE	
U.S.G.S.	
LAND OFFICE	
OPERATOR	

# NEW MEXICO OIL CONSERVATION COMMISSION

30-005-60917  
Form C-101  
Revised 1-1-65

5A. Indicate Type of Lease	
STATE <input type="checkbox"/>	FEE <input checked="" type="checkbox"/>
5. State Oil & Gas Lease No.	

## APPLICATION FOR PERMIT TO DRILL, DEEPEN, OR PLUG BACK

1a. Type of Work		7. Unit Agreement Name	
b. Type of Well OIL WELL <input type="checkbox"/> GAS WELL <input checked="" type="checkbox"/> OTHER <input type="checkbox"/>		8. Farm or Lease Name Red Bluff	
2. Name of Operator Fred Pool Drllg. Co. Inc.		9. Well No. 1	
3. Address of Operator 1300 Clovis Star Rt. Roswell, N.M. 88201		10. Field and Pool, or Wildcat Wildcat	
4. Location of Well UNIT LETTER N LOCATED 660 FEET FROM THE S LINE AS 1980 FEET FROM THE W LINE OF SEC. 23 TWP. 7S RGE. 25E NMPM		12. County Chaves	
19. Proposed Depth 4400		19A. Formation Abo	
20. Rotary or C.T. Rotary		21. Approx. Date Work will start 3-30-81	
21A. Kind & Status Plug. Bond Blanket		21B. Drilling Contractor Bantam	
22. Elevation (Show whether DF, RT, etc.) 3676 G1		23. Elevation (Show whether DF, RT, etc.) Blanket	

## PROPOSED CASING AND CEMENT PROGRAM

SIZE OF HOLE	SIZE OF CASING	WEIGHT PER FOOT	SETTING DEPTH	SACKS OF CEMENT	EST. TOP
17 1/2	13 3/8	48 #	450	600 sx	circulate
12 1/4	8 5/8	24#	1500	1000 sx	"
7 7/8	4 1/2	10.5	4400	600 sx	2500 ft.

Gas is not dedicated at this time.

Double Shafer Manual, Series 900, blow out preventer will be used on well.

APPROVAL VALID FOR 180 DAYS  
PERMIT EXPIRES 9-24-81  
UNLESS DRILLING UNDERWAY

IN ABOVE SPACE DESCRIBE PROPOSED PROGRAM; IF PROPOSAL IS TO DEEPEN OR PLUG BACK, GIVE DATA ON PRESENT PRODUCTIVE ZONE AND PROPOSED NEW PRODUCTIVE ZONE. GIVE BLOWOUT PREVENTER PROGRAM, IF ANY.

hereby certify that the information above is true and complete to the best of my knowledge and belief.

Signed [Signature] Title Secretary Date 3-20-81

(This space for State Use)

APPROVED BY [Signature] TITLE SUPERVISOR DISTRICT II DATE MAR 24 1981

CONDITIONS OF APPROVAL, IF ANY:

Lease must be comm. Prior to producing the well

Cement must be circulated to surface behind 13 3/8" 28 # casing

Notify N.M.O.C.C. in sufficient time to witness cementing

8 5/8"

## OIL CONSERVATION DIVISION

STATE OF NEW MEXICO  
ENERGY AND MINERALS DEPARTMENTP. O. BOX 2088  
SANTA FE, NEW MEXICO 87501Form C-103  
Revised 10-1-78

All distances must be from the outer boundaries of the Section.

Operator <b>Fred Pool Jr.</b>		Lease <b>Red Bluff</b>		Well No. <b>1</b>	
Unit Letter <b>N</b>	Section <b>23</b>	Township <b>7 South</b>	Range <b>25 East</b>	County <b>Chaves</b>	
Actual Footage Location of Well: <b>660</b> feet from the <b>South</b> line and <b>1980</b> feet from the <b>West</b> line					
Ground Level Elev. <b>3676</b>	Producing Formation <b>Abo</b>		Pool <b>Wildcat</b>	Dedicated Acreage: <b>160</b> Acres	

1. Outline the acreage dedicated to the subject well by colored pencil or hatchure marks on the plat below.
2. If more than one lease is dedicated to the well, outline each and identify the ownership thereof (both as to working interest and royalty).
3. If more than one lease of different ownership is dedicated to the well, have the interests of all owners been consolidated by communitization, unitization, force-pooling, etc?

☐ Yes ☒ No If answer is "yes," type of consolidation \_\_\_\_\_

If answer is "no," list the owners and tract descriptions which have actually been consolidated. (Use reverse side of this form if necessary.) \_\_\_\_\_

No allowable will be assigned to the well until all interests have been consolidated (by communitization, unitization, forced-pooling, or otherwise) or until a non-standard unit, eliminating such interests, has been approved by the Division.

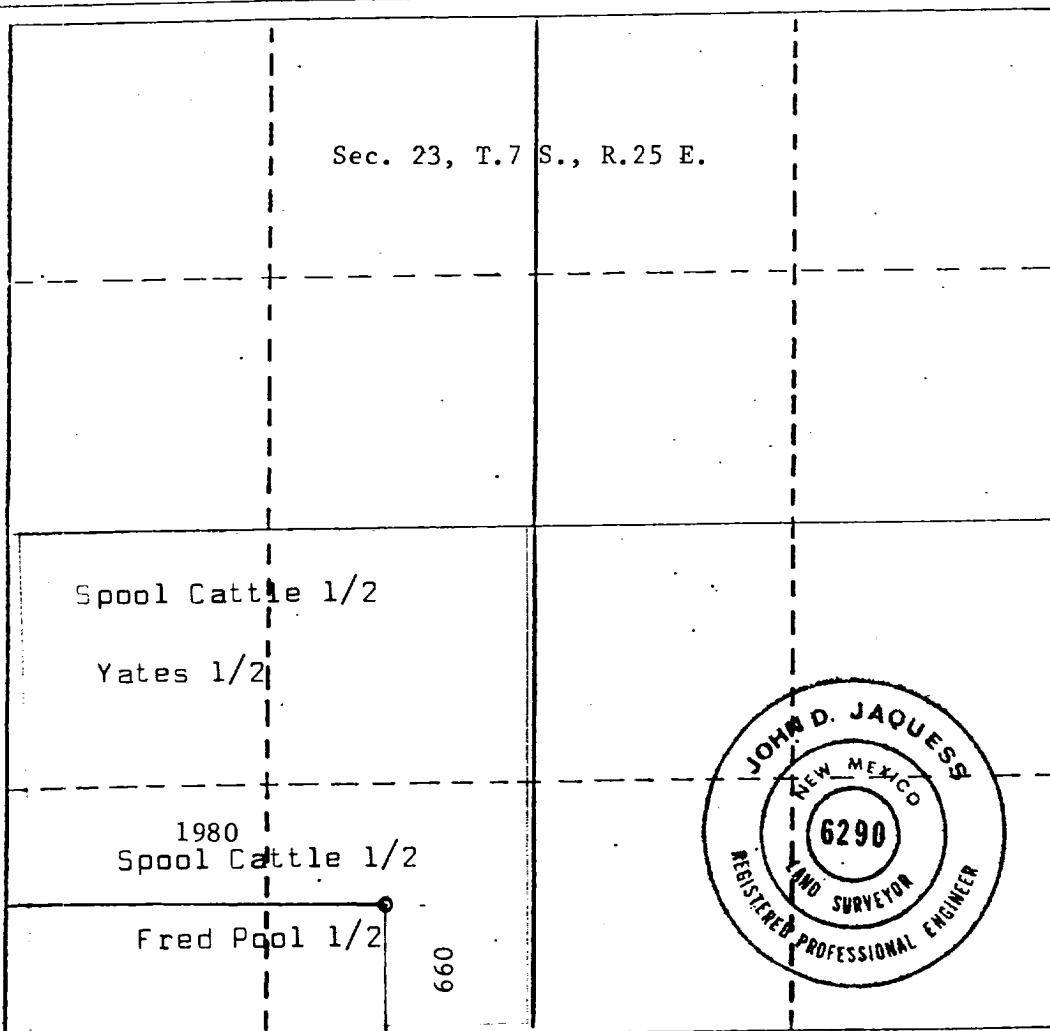

## CERTIFICATION

I hereby certify that the information contained herein is true and complete to the best of my knowledge and belief.

*[Signature]*  
Name  
**Fred Pool, Jr.**

Position  
**President**

Company  
**Fred Pool Dring. Co**

Date  
**3-20-81**

I hereby certify that the well location shown on this plat was plotted from field notes of actual surveys made by me or under my supervision, and that the same is true and correct to the best of my knowledge and belief.

Date Surveyed  
**February 24, 1981**

Registered Professional Engineer  
and/or Land Surveyor

*[Signature]*  
**John D. Jaquess, P.E. & L.S.**

Certificate No.  
**6290**

