

| | |
|------------------------|--|
| NO. OF COPIES RECEIVED | |
| DISTRIBUTION | |
| AMOUNT PAID | |
| FILE | |
| U.S.G.S. | |
| LAND OFFICE | |
| OPERATOR | |

NEW MEXICO OIL CONSERVATION COMMISSION

MAR 25 1981

O. C. C.
ARIZONA LEASE

30-005-60920

Form C-101
Revised 1-1-65

5A. Indicate Type of Lease

STATE ☐

FEE ☒

5. State Oil & Gas Lease No.

APPLICATION FOR PERMIT TO DRILL, DEEPEN, OR PLUG BACK

| | | | |
|--|--|---|--|
| 1a. Type of Work | | 7. Unit Agreement Name | |
| b. Type of Well DRILL <input checked="" type="checkbox"/> DEEPEN <input type="checkbox"/> PLUG BACK <input type="checkbox"/> OIL WELL <input checked="" type="checkbox"/> GAS WELL <input type="checkbox"/> OTHER <input type="checkbox"/> SINGLE ZONE <input type="checkbox"/> MULTIPLE ZONE <input type="checkbox"/> | | 8. Farm or Lease Name O'Brien "L" | |
| 2. Name of Operator Stevens Oil Company ✓ | | 9. Well No. 3 | |
| 3. Address of Operator P.O. Box 2203, Roswell, N.M. 88201 | | 10. Field and Pool, or Willcutt Twin Lakes-San Andr | |
| 4. Location of Well UNIT LETTER A LOCATED 330' FEET FROM THE North LINE AND 990' FEET FROM THE East LINE OF SEC. 6 TWP. 9S RGE. 29E NMPM | | 12. County Chaves | |
| 18. Proposed Depth 2900' | | 19A. Formation San Andres | |
| 20. Rotary or C.T. Rotary | | 21. Elevations (Show whether DF, RT, etc.) 3984.2 Gr., 3994.2 KB | |
| 21A. Kind & Status Plug. Bond Statewide | | 21B. Drilling Contractor Bantam Drilling Co. | |
| 22. Approx. Date Work will start 3-22-81 | | | |

PROPOSED CASING AND CEMENT PROGRAM

| SIZE OF HOLE | SIZE OF CASING | WEIGHT PER FOOT | SETTING DEPTH | SACKS OF CEMENT | EST. TOP |
|--------------|----------------|-----------------|---------------|-----------------|----------|
| 12-1/2" | 8-5/8" | 20# | 120' | 75 sacks | |
| 7-7/8" | 4-1/2" | 9.5# | 2900' | 175 sacks | |

Will drill with water and mud to T.D., log, and if indicated productive, case to T.D. and perforate in producing intervals.

Adequate blowout preventers will be used.

APPROVED AND FOR 180
PERMIT EXHIBITS 9-25-81
UNLESS DRILLING UNDER

IN ABOVE SPACE DESCRIBE PROPOSED PROGRAM: IF PROPOSAL IS TO DEEPEN OR PLUG BACK, GIVE DATA ON PRESENT PRODUCTIVE ZONE AND PROPOSED NEW PRODUCTIVE ZONE. GIVE BLOWOUT PREVENTER PROGRAM, IF ANY.

I hereby certify that the information above is true and complete to the best of my knowledge and belief.

Signed Donald E. Hume Title Owner Date 3-24-81

(This space for State Use)

APPROVED BY W. A. Gressett TITLE Superintendent DATE 3-25-81

CONDITIONS OF APPROVAL, IF ANY:

**MEXICO OIL CONSERVATION COMMISSION
WELL LOCATION AND ACREAGE DEDICATION PLAT**

Form C-102
Supersedes C-126
Effective 1-1-65

All distances must be from the outer boundaries of the Section.

| | | | | | |
|--|--|--|---------------------------|--|----------------------|
| Operator Stevens Oil Co. | | | Lease O'Brien L | | Well No. 3 |
| Unit Letter A | Section 6 | Township 9 South | Range 29 East | County Chaves | |
| Actual Footage Location of Well: 330 feet from the North line and 990 feet from the East line | | | | | |
| Ground Level Elev. 3984.2 | Producing Formation San Andres | Pool Twin Lakes (Associated) | | Dedicated Acreage: 40.28 Acres | |

1. Outline the acreage dedicated to the subject well by colored pencil or hatchure marks on the plat below.
2. If more than one lease is dedicated to the well, outline each and identify the ownership thereof (both as to working interest and royalty).
3. If more than one lease of different ownership is dedicated to the well, have the interests of all owners been consolidated by communitization, unitization, force-pooling, etc?

☐ Yes ☐ No If answer is "yes," type of consolidation _____

If answer is "no," list the owners and tract descriptions which have actually been consolidated. (Use reverse side of this form if necessary.) _____

No allowable will be assigned to the well until all interests have been consolidated (by communitization, unitization, forced-pooling, or otherwise) or until a non-standard unit, eliminating such interests, has been approved by the Commission.

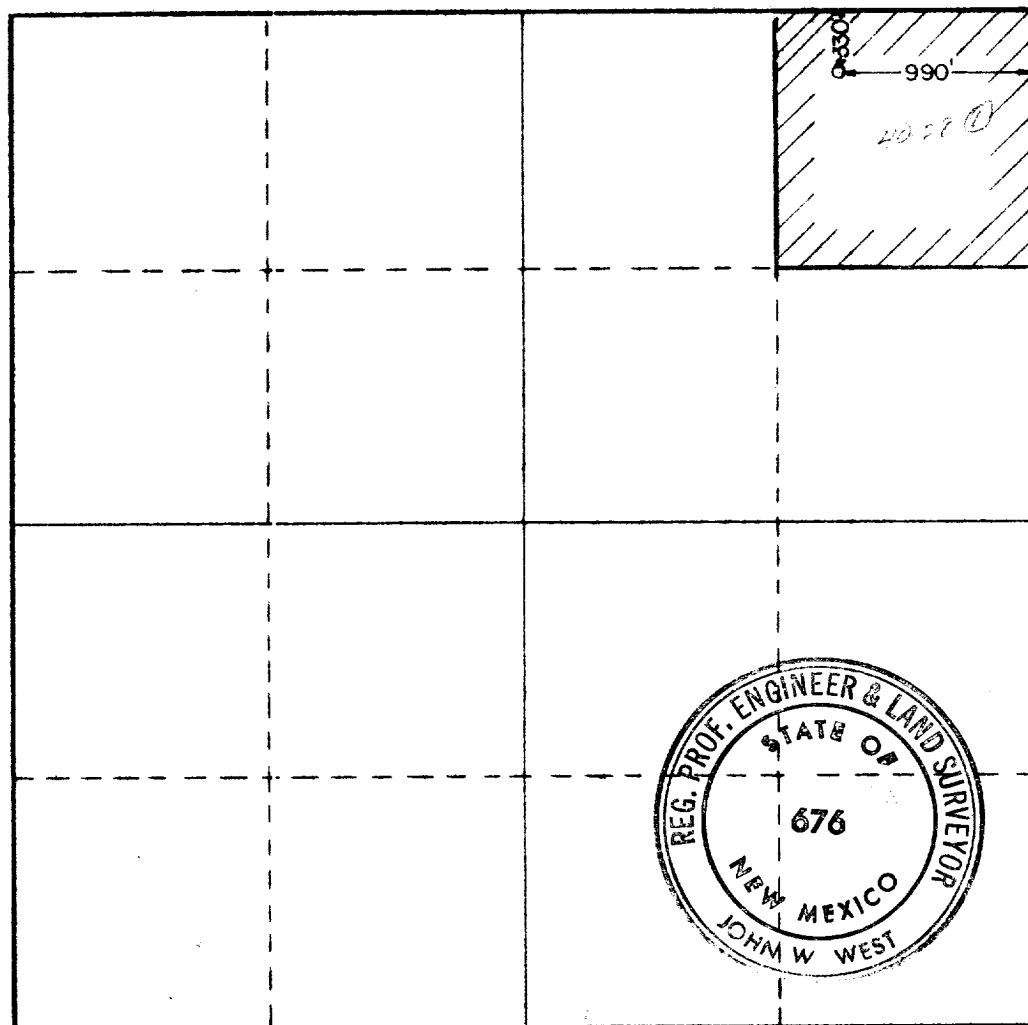

CERTIFICATION

I hereby certify that the information contained herein is true and complete to the best of my knowledge and belief.

Name *Ronald J. Eidson*
Position
Owner

Company
Stevens Oil Company

Date
3-24-81

I hereby certify that the well location shown on this plat was plotted from field notes of actual surveys made by me or under my supervision, and that the same is true and correct to the best of my knowledge and belief.

Date Surveyed
10-17-80

Registered Professional Engineer and/or Land Surveyor

John W. West

Certificate No. **JOHN W. WEST 676**
PATRICK A. ROMERO 6068
Ronald J. Eidson 3239

