

AMENDED

NEW MEXICO OIL CONSERVATION COMMISSION RECEIVED

Form C-101
Revised 1-1-65

NO. OF COPIES RECEIVED	
DISTRIBUTION	
SANTA FE	1
FILE	1
U.S.G.S.	2
LAND OFFICE	
OPERATOR	1

MAY 8 1981

O. C. D.
ARTESIA, OFFICE

5A. Indicate Type of Lease STATE <input type="checkbox"/> FEE <input checked="" type="checkbox"/>
5. State Oil & Gas Lease No. -
7. Unit Agreement Name -
8. Farm or Lease Name Cooper
9. Well No. 2
10. Field and Pool, or Wildcat X Urd. Linda San Andres
12. County Chaves
19. Proposed Depth 1100'
19A. Formation San Andres
20. Rotary or C.T. Rotary
21. Elevations (Show whether DF, RT, etc.) 3662 GR
21A. Kind & Status Plug. Bond Statewide-Active
21B. Drilling Contractor Stewart Bros.
22. Approx. Date Work will start May 20, 1981

APPLICATION FOR PERMIT TO DRILL, DEEPEN, OR PLUG BACK

1a. Type of Work DRILL <input checked="" type="checkbox"/> DEEPEN <input type="checkbox"/> PLUG BACK <input type="checkbox"/>
b. Type of Well OIL WELL <input checked="" type="checkbox"/> GAS WELL <input type="checkbox"/> OTHER <input type="checkbox"/> SINGLE ZONE <input checked="" type="checkbox"/> MULTIPLE ZONE <input type="checkbox"/>
2. Name of Operator Penroc Oil Corporation
3. Address of Operator P. O. Drawer 831, Midland, Texas 79702
4. Location of Well UNIT LETTER F LOCATED 2145 FEET FROM THE North LINE AND 1650 FEET FROM THE West LINE OF SEC. 29 TWP. 6S RGE. 26E NMPM
23.

PROPOSED CASING AND CEMENT PROGRAM

SIZE OF HOLE	SIZE OF CASING	WEIGHT PER FOOT	SETTING DEPTH	SACKS OF CEMENT	EST. TOP
11"	8-5/8"	24.0#	450'	175	Circulate
7-7/8"	4-1/2"	10.50#	1100'	300	Circulate

Blowout Preventer: Shaffer 8" Series 900 Double Manual

APPROVAL VALID FOR 180 DAYS
PERMIT EXPIRES 11-12-81
UNLESS DRILLING UNDERWAY

IN ABOVE SPACE DESCRIBE PROPOSED PROGRAM: IF PROPOSAL IS TO DEEPEN OR PLUG BACK, GIVE DATA ON PRESENT PRODUCTIVE ZONE AND PROPOSED NEW PRODUCTIVE ZONE. GIVE BLOWOUT PREVENTER PROGRAM, IF ANY.

I hereby certify that the information above is true and complete to the best of my knowledge and belief.

Signed B. J. Dickey Title President Date 5-7-81
(This space for State Use)APPROVED BY W. A. Gussett TITLE SUPERVISOR, DISTRICT II DATE MAY 12 1981
CONDITIONS OF APPROVAL, IF ANY:Cement must be circulated to
surface behind 8 7/8" - 4 1/2" casingNotify N.M.O.C.C. in sufficient
time to witness cementing
the 8 7/8" casing

**MEXICO OIL CONSERVATION COMMISSION
WELL LOCATION AND ACREAGE DEDICATION PLAT**

Form C-112
Supersedes C-128
Effective 1-1-65

All distances must be from the outer boundaries of the Section

AMENDED

Operator PENROC OIL CORPORATION			Lease Cooper		Well No. 2
Tract Letter "F"	Section 29	Township 6 South	Range 26 East	County Chaves	
Actual Well Location of Well: 2145 feet from the North line and 1650 feet from the West line					
Ground Level Elev. 3662	Producing Formation San Andres	Pool Unid. Linda San Andres	Dedicated Acreage 40 Acres		

RECEIVED

MAY 8 1981

O. C. D. OFFICE

1. Outline the acreage dedicated to the subject well by colored pencil or hatchure marks on the plat below.
2. If more than one lease is dedicated to the well, outline each and identify the ownership thereof (both as to working interest and royalty).
3. If more than one lease of different ownership is dedicated to the well, have the interests of all owners been consolidated by communitization, unitization, force-pooling, etc?

☐ Yes ☐ No If answer is "yes," type of consolidation _____

If answer is "no," list the owners and tract descriptions which have actually been consolidated. (Use reverse side of this form if necessary.) _____

No allowable will be assigned to the well until all interests have been consolidated (by communitization, unitization, forced-pooling, or otherwise) or until a non-standard unit, eliminating such interests, has been approved by the Commission.

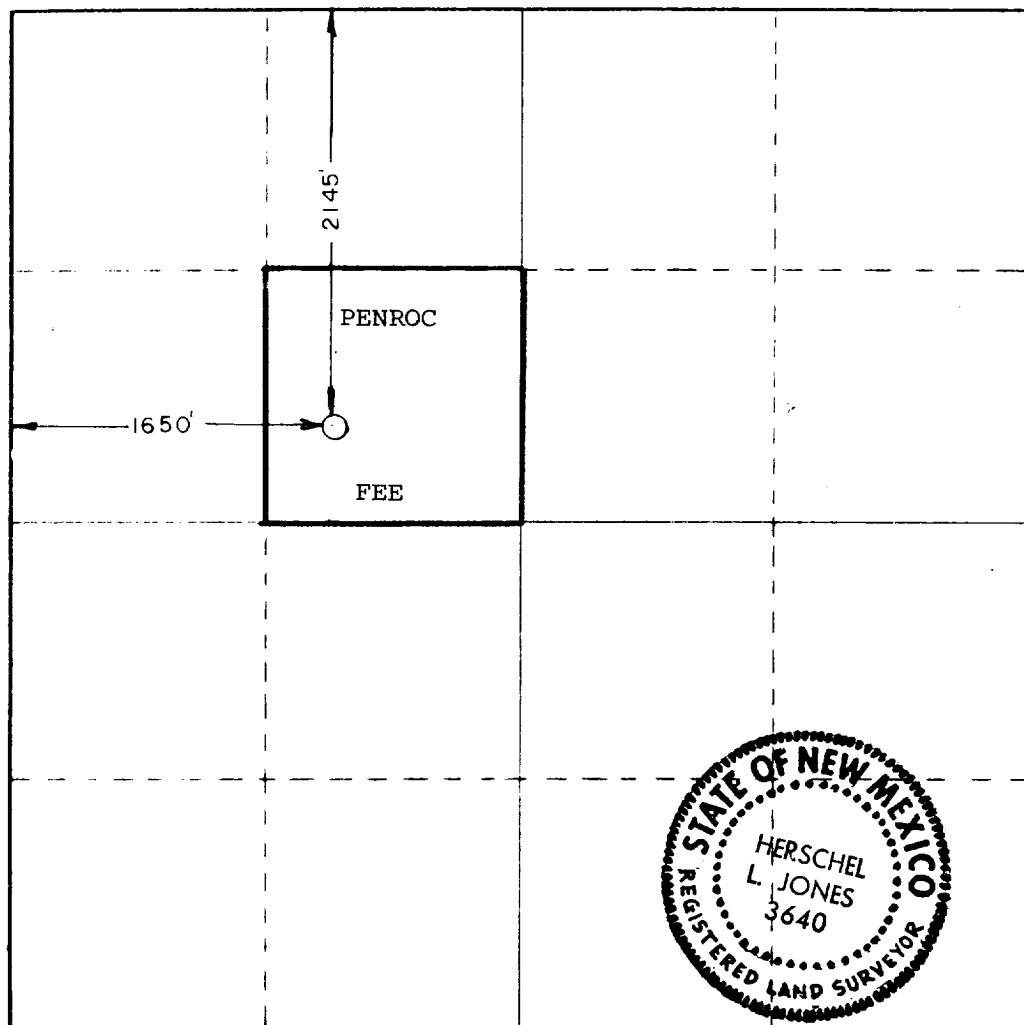

CERTIFICATION

I hereby certify that the information contained herein is true and complete to the best of my knowledge and belief

Name *B. J. Dally*
Position President

Company
Penroc Oil Corporation

Date
5-7-81

I hereby certify that the well location shown on this plat was plotted from field notes of actual surveys made by me or under my supervision, and that the same is true and correct to the best of my knowledge and belief.

Date Surveyed
March 13, 1981

Registered Professional Engineer and/or Land Surveyor

Herschel L. Jones
Certificate No. **3640**

0 330 660 990 1320 1650 1980 2310 2640 2970 3300 3630 3960 4290 4620 4950 5280 5610 5940 6270 6600