

NO. OF COPIES RECEIVED	
DISTRIBUTION	
SANTA FE	/
FILE	/
U.S.G.S.	/
LAND OFFICE	/
OPERATOR	/

NEW MEXICO OIL CONSERVATION COMMISSION RECEIVED

30-005-60938
Form C-101
Revised 1-1-65

APR 07 1981

O. C. D.

ARTESIA, OFFICE

APPLICATION FOR PERMIT TO DRILL, DEEPEN, OR PLUG BACK

1a. Type of Work

b. Type of Well

DRILL ☒

DEEPEN ☐

PLUG BACK ☐

OIL WELL ☒

GAS WELL ☐

OTHER

SINGLE ZONE ☐

MULTIPLE ZONE ☐

c. Name of Operator

Yates Petroleum Corporation

d. Address of Operator

207 South 4th Street, Artesia, NM 88210

e. Location of Well

UNIT LETTER M LOCATED 330 FEET FROM THE South LINE

AND 330 FEET FROM THE West LINE OF SEC. 16 TWP. 10S RGE. 25E NMPM

7. Unit Agreement Name

8. Farm or Lease Name

Bitter Lake PX State

9. Well No.

1

10. Field and Pool, or Wildcat

Bitter Lake SA

12. County

Chaves

19. Proposed Depth

approx. 950

19A. Formation

SA Slaughter

20. Rotary or C.T.

Rotary

1. Elevations (Show whether DF, RT, etc.)

3517.4 GL

21A. Risk & Status Plug. Benz

Blanket

21B. Drilling Contractor

Stewart Brothers

22. Approx. Date Work will start

ASAP

PROPOSED CASING AND CEMENT PROGRAM

SIZE OF HOLE	SIZE OF CASING	WEIGHT PER FOOT	SETTING DEPTH	SACKS OF CEMENT	EST. TOP
	16"	Conductor	40'	Redi Mix	
10 3/4"	7"	20#	720'	150 sx	circulate
6 1/4"	4 1/2"	9.5#	TD	72 sx	circulate

Propose to drill a San Andres test hole. Casing will be set per program. 4 1/2" production string will be set at TD, perforated and stimulated as needed for production.

MUD PROGRAM: Fresh water gel to 720', fresh water to TD

BOP PROGRAM: BOP will be installed on 7" casing and tested.

APPROVAL VALID FOR 180 DAYS
PERMIT EXPIRES 10-8-81
UNLESS DRILLING UNDERWAY

ABOVE SPACE DESCRIBE PROPOSED PROGRAM: IF PROPOSAL IS TO DEEPEN OR PLUG BACK, GIVE DATA ON PRESENT PRODUCTIVE ZONE AND PROPOSED NEW PRODUCTIVE ZONE. GIVE BLOWOUT PREVENTER PROGRAM, IF ANY.

I hereby certify that the information above is true and complete to the best of my knowledge and belief.

Signed W. A. Gessett Title Geographer Date April 7, 1981
(This space for State Use)

APPROVED BY W. A. Gessett TITLE SUPERVISOR, DISTRICT II DATE APR 08 1981

CONDITIONS OF APPROVAL, IF ANY:

Cement must be circulated to surface behind all casing

Notify N.M.O.C.C. in 2 days time to witness cementing

7 11

**W MEXICO OIL CONSERVATION COMMI. ON
WELL LOCATION AND ACREAGE DEDICATION PLAT**

Form C-102
Supersedes C-128
Effective 1-1-65

All distances must be from the outer boundaries of the Section.

Operator Yates Petroleum Corporation			Lease Bitter Lake "PX" State		Well No. 1
Unit Letter M	Section 16	Township 10 South	Range 25 East	County Chaves	
Actual Footage Location of Well: 330 feet from the South line and 330 feet from the West line					
Ground Level Elev. 3517.4	Producing Formation SAN ANDRES		Pool BITTER LAKE S.A.		Dedicated Acreage: 40 Acres

1. Outline the acreage dedicated to the subject well by colored pencil or hachure marks on the plat below.
2. If more than one lease is dedicated to the well, outline each and identify the ownership thereof (both as to working interest and royalty).
3. If more than one lease of different ownership is dedicated to the well, have the interests of all owners been consolidated by communitization, unitization, force-pooling, etc?

☐ Yes ☐ No If answer is "yes," type of consolidation _____

If answer is "no," list the owners and tract descriptions which have actually been consolidated. (Use reverse side of this form if necessary.) _____

No allowable will be assigned to the well until all interests have been consolidated (by communitization, unitization, forced-pooling, or otherwise) or until a non-standard unit, eliminating such interests, has been approved by the Commission.

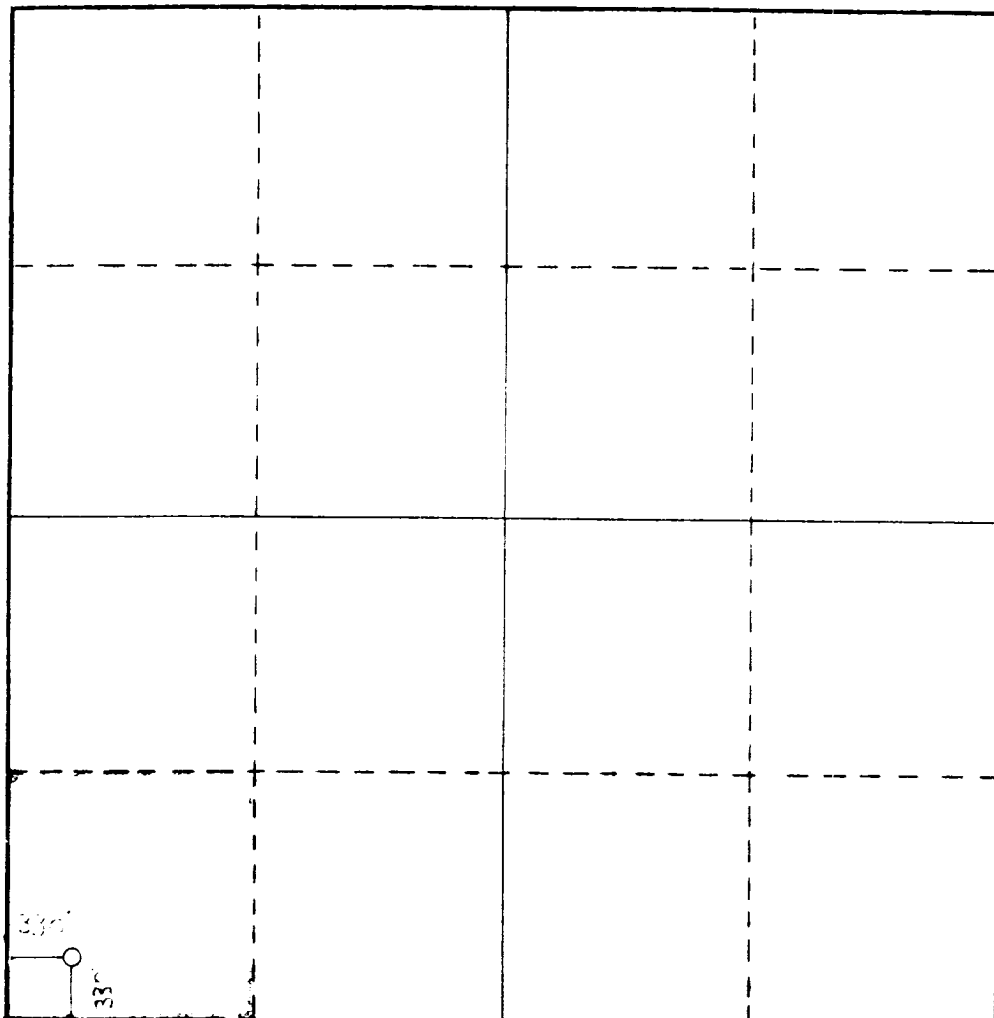

CERTIFICATION

I hereby certify that the information contained herein is true and complete to the best of my knowledge and belief.

Gliserio Rodriguez
Name
GLISERIO RODRIGUEZ
Position
GEOGRAPHER
Company
YATES PETROLEUM CORP
Date
2-16-81

I hereby certify that the well location shown on this plat was plotted from field notes of actual surveys made by me or under my supervision, and that the same is true and correct to the best of my knowledge and belief.

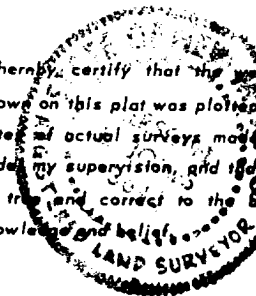

Date Surveyed
February 13, 1981
Registered Professional Engineer
and/or Land Surveyor

Herschell Jones
Certificate No. **36440**

0 330 660 990 1320 1650 1980 2310 2640

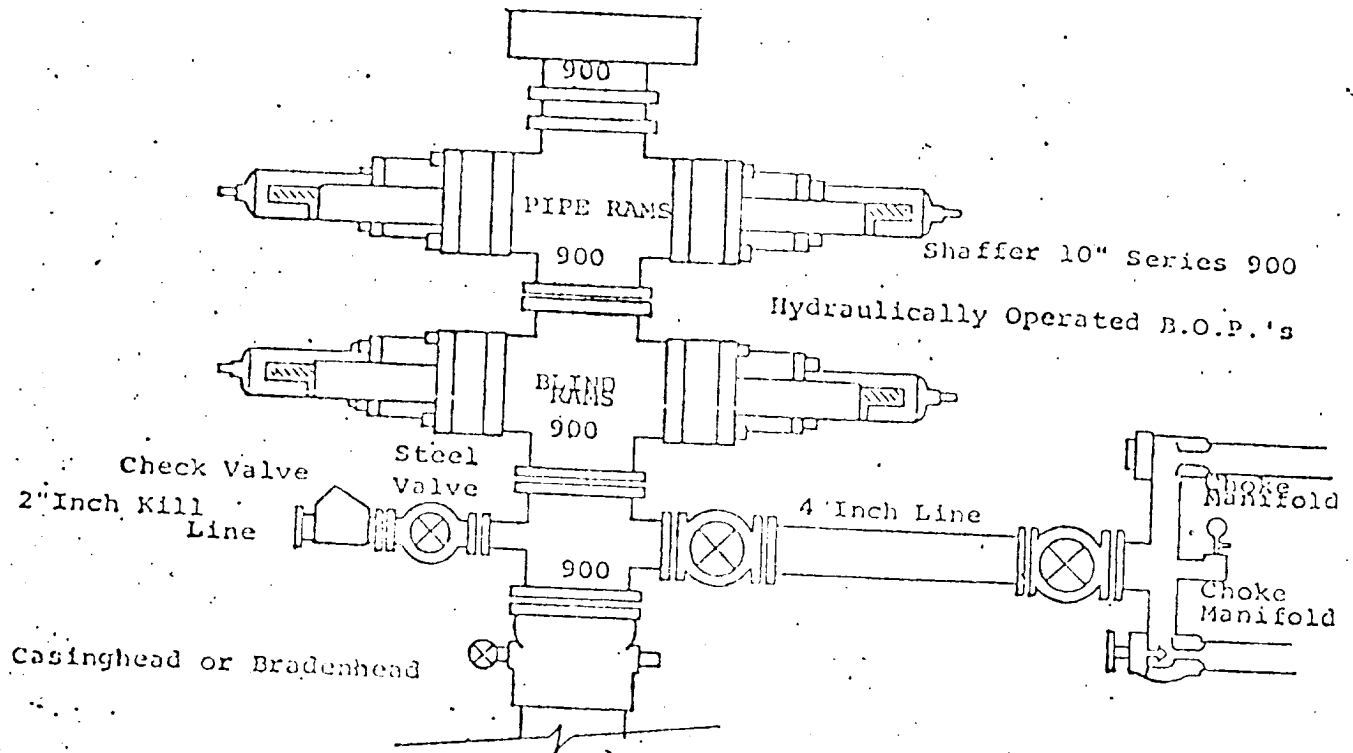

THE FOLLOWING CONSTITUTE MINIMUM BLOWOUT PREVENTER REQUIREMENTS

1. All preventers to be hydraulically operated with secondary manual controls installed prior to drilling out from under casing.
2. Choke outlet to be a minimum of 4" diameter.
3. Kill line to be of all steel construction of 2" minimum diameter.
4. All connections from operating manifolds to preventers to be all steel. hole or tube a minimum of one inch in diameter.
5. The available closing pressure shall be at least 15% in excess of that required with sufficient volume to operate the B.O.P.'s.
6. All connections to and from preventer to have a pressure rating equivalent to that of the B.O.P.'s.
7. Inside blowout preventer to be available on rig floor.
8. Operating controls located a safe distance from the rig floor.
9. Hole must be kept filled on trips below intermediate casing. Operator not responsible for blowouts resulting from not keeping hole full.
10. D. P. float must be installed and used below zone of first gas intrusion.