

30-005-60950

NO. OF COPIES RECEIVED	
DISTRIBUTION	
SANTA FE	1
FILE	1 ✓
U.S.G.S.	2
LAND OFFICE	1
OPERATOR	1

NEW MEXICO OIL CONSERVATION COMM ~~RECEIVED~~

Form C-101
Revised 1-1-65

APR 27 1981

O. C. D.
ARTESIA, OFFICE

5A. Indicate Type of Lease STATE <input checked="" type="checkbox"/> FEE <input type="checkbox"/>
5. State Oil & Gas Lease No. LG 9571
7. Unit Agreement Name
8. Farm or Lease Name BOSWELL STATE
9. Well No. 1
10. Field and Pool, or Wildcat WILDCAT
12. County CHAVES
19. Proposed Depth 3700'
19A. Formation BASEMENT
20. Rotary or C.T. ROTARY
21. Elevations (Show whether DF, RT, etc.) 4242.0' GR
21A. Kind & Status Plug. Bond BLANKET
21B. Drilling Contractor TOM BROWN DRILLING
22. Approx. Date Work will start MAY 12, 1981

APPLICATION FOR PERMIT TO DRILL, DEEPEN, OR PLUG BACK

1a. Type of Work b. Type of Well OIL WELL <input type="checkbox"/> GAS WELL <input checked="" type="checkbox"/> OTHER <input type="checkbox"/> 2. Name of Operator MESA PETROLEUM CO. 3. Address of Operator 1000 VAUGHN BUILDING/MIDLAND, TEXAS 79701 4. Location of Well UNIT LETTER A LOCATED 660 FEET FROM THE NORTH LINE AND 660 FEET FROM THE EAST LINE OF SEC. 30 TWP. 5S RGE. 21E NMPM	DEEPEN <input type="checkbox"/> PLUG BACK <input type="checkbox"/> SINGLE ZONE <input type="checkbox"/> MULTIPLE ZONE <input type="checkbox"/>
---	---

PROPOSED CASING AND CEMENT PROGRAM					
SIZE OF HOLE	SIZE OF CASING	WEIGHT PER FOOT	SETTING DEPTH	SACKS OF CEMENT	EST. TOP
17 1/2"	13 3/8"	48#	800'	500	SURFACE
11"	8 5/8"	24#	1600'	500	SUFFICIENT TO ISOLATE WTR, O&G
7 7/8"	4 1/2"	10.5#	3700'	500	SUFFICIENT TO COVER ALL PAY

Propose to drill 17 1/2" hole using air to 800' or deeper. Will set 13 3/8" surface casing and cement to surface. Will reduce hole to 11" and drill to 1600' to set 8 5/8" casing. Will nipple up ram type BOP's and reduce hole to 7 7/8" and drill to total depth using air, foam, or mud as required. After log evaluation, 4 1/2" casing may be run and cemented with sufficient kinds and amounts of cement to isolate and seal off any fresh water, oil, or gas zones encountered.

APPROVAL VALID FOR 180 DAYS
PERMIT EXPIRES 10-29-81

Gas Sales Are Dedicated to Transwestern Pipeline Company UNLESS DRILLING UNDERWAY

XC: NMOC (6), TLR, CEN RCDS, ACCTG, ROSWELL, MEC, LAND PARTNERS, FILE

IN ABOVE SPACE DESCRIBE PROPOSED PROGRAM: IF PROPOSAL IS TO DEEPEN OR PLUG BACK, GIVE DATA ON PRESENT PRODUCTIVE ZONE AND PROPOSED NEW PRODUCTIVE ZONE. GIVE BLOWOUT PREVENTER PROGRAM, IF ANY.

I hereby certify that the information above is true and complete to the best of my knowledge and belief.

Signed R. E. Markin Title REGULATORY COORDINATOR Date APRIL 24, 1981

(This space for State Use)

APPROVED BY W. A. Gussert TITLE SUPERVISOR, DISTRICT II DATE APR 29 1981

CONDITIONS OF APPROVAL, IF ANY:

NEW MEXICO OIL CONSERVATION COMMISSION
WELL LOCATION AND ACREAGE DEDICATION PLAT

Form C-102
 Supersedes C-128
 Effective 1-1-65

All distances must be from the outer boundaries of the Section.

Operator Mesa Petroleum Co.			Lease Boswell State			Well No. 1		
Unit Letter A	Section 30	Township 5South	Range 21East	County Chaves				
Actual Footage Location of Well: 660 feet from the East line and 660 feet from the North line								
Ground Level Elev. 4242.0'	Producing Formation BASEMENT		Pool WILDCAT			Dedicated Acreage: NE/4 160 Acres		

1. Outline the acreage dedicated to the subject well by colored pencil or hachure marks on the plat below.
2. If more than one lease is dedicated to the well, outline each and identify the ownership thereof (both as to working interest and royalty).
3. If more than one lease of different ownership is dedicated to the well, have the interests of all owners been consolidated by communitization, unitization, force-pooling, etc?

☐ Yes ☐ No If answer is "yes," type of consolidation _____

If answer is "no," list the owners and tract descriptions which have actually been consolidated. (Use reverse side of this form if necessary.) _____

No allowable will be assigned to the well until all interests have been consolidated (by communitization, unitization, forced-pooling, or otherwise) or until a non-standard unit, eliminating such interests, has been approved by the Commission.

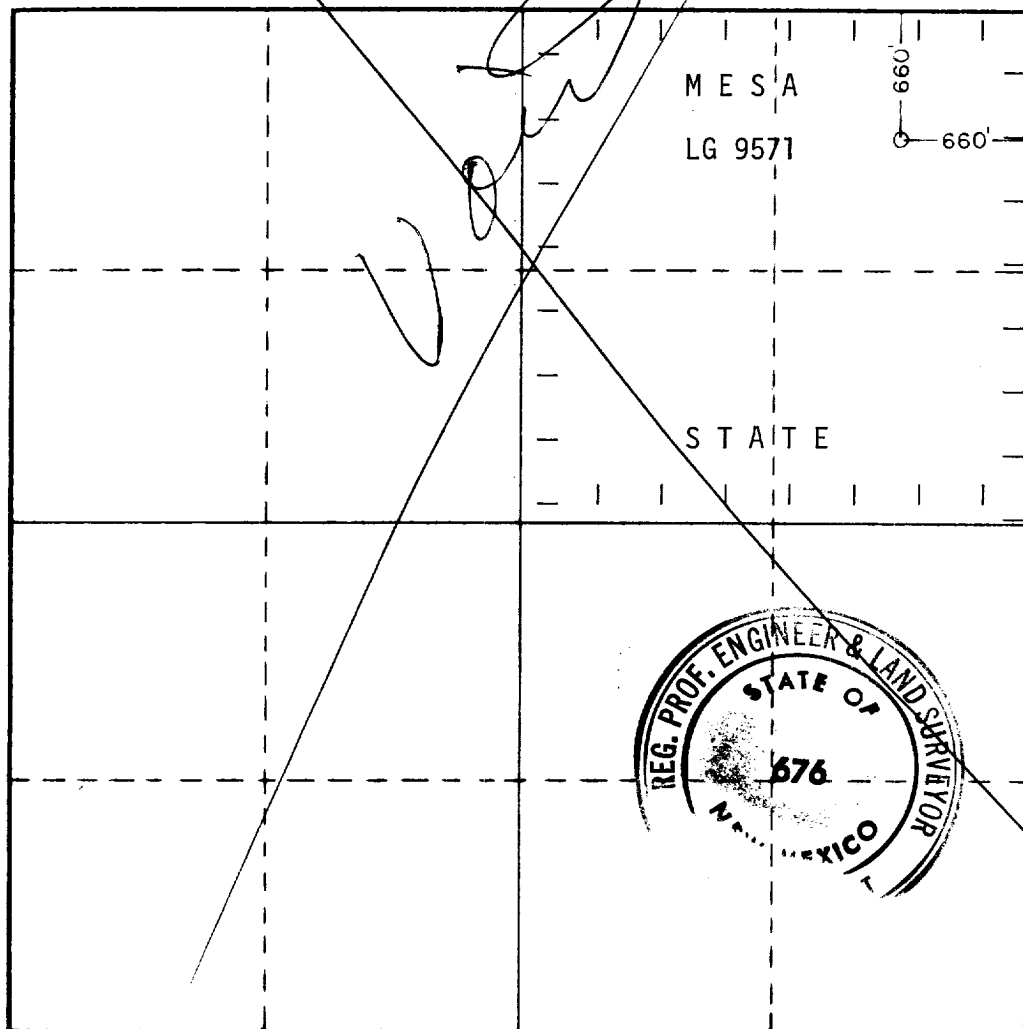

CERTIFICATION

I hereby certify that the information contained herein is true and complete to the best of my knowledge and belief.

R. E. Mathis

Name
R. E. MATHIS
 Position
REGULATORY COORDINATOR
 Company
MESA PETROLEUM CO.
 Date
APRIL 24, 1981

I hereby certify that the well location shown on this plat was plotted from field notes of actual surveys made by me or under my supervision, and that the same is true and correct to the best of my knowledge and belief.

Date Surveyed
April 15, 1981

Registered Professional Engineer and/or Land Surveyor

John W. West

Certificate No. **JOHN W. WEST 676**
PATRICK A. ROMERO 6883
Ronald J. Eidson 3239