

NO. OF COPIES RECEIVED	
DISTRIBUTION	
SANTA FE	1
FILE	1 ✓
U.S.G.S.	2
LAND OFFICE	1
OPERATOR	1

# NEW MEXICO OIL CONSERVATION COMMISSION

RECEIVED

MAY 8 1981

O. C. D.  
ARTESIA, OFFICE

Form C-101  
Revised 1-1-65

5A. Indicate Type of Lease  
STATE ☒ FEE ☐  
5. State Oil & Gas Lease No.  
LG 9571

## APPLICATION FOR PERMIT TO DRILL, DEEPEN, OR PLUG BACK

1a. Type of Work DRILL <input checked="" type="checkbox"/> DEEPEN <input type="checkbox"/> PLUG BACK <input type="checkbox"/>		7. Unit Agreement Name
b. Type of Well OIL WELL <input type="checkbox"/> GAS WELL <input checked="" type="checkbox"/> OTHER <input type="checkbox"/>		8. Farm or Lease Name BOSWELL STATE
2. Name of Operator MESA PETROLEUM CO.		9. Well No. 1
3. Address of Operator 1000 VAUGHN BUILDING/MIDLAND, TEXAS 79701		10. Field and Pool, or Wildcat WILDCAT <i>Person</i>
4. Location of Well UNIT LETTER <u>J</u> LOCATED <u>1650</u> FEET FROM THE <u>South</u> LINE AND <u>1650</u> FEET FROM THE <u>EAST</u> LINE OF SEC. <u>30</u> TWP. <u>5S</u> RGE. <u>21E</u> NMPM		12. County CHAVES
21. Elevations (Show whether DF, RT, etc.) 4258.3' GR		19. Proposed Depth 3700'
21A. Kind & Status Plug. Bond BLANKET		19A. Formation BASEMENT
21B. Drilling Contractor TOM BROWN DRILLING		20. Rotary or C.T. ROTARY
22. Approx. Date Work will start MAY 30, 1981		

### PROPOSED CASING AND CEMENT PROGRAM

SIZE OF HOLE	SIZE OF CASING	WEIGHT PER FOOT	SETTING DEPTH	SACKS OF CEMENT	EST. TOP
17 1/2"	13 3/8"	48#	800'	500	SURFACE
11"	8 5/8"	24#	1600'	500	SUFFICIENT TO ISOLATE WTR, O&G
7 7/8"	4 1/2"	10.5#	3700'	500	SUFFICIENT TO COVER ALL PAY

Propose to drill 17 1/2" hole using air to 800' or deeper. Will set 13 3/8" surface casing and cement to surface. Will reduce hole to 11" and drill to 1600' to set 8 5/8" casing. Will nipple up ram type BOP's and reduce hole to 7 7/8" and drill to total depth using air, foam, or mud as required. After log evaluation, 4 1/2" casing may be run and cemented with sufficient kinds and amounts of cement to isolate and seal off any fresh water, oil, or gas zones encountered.

APPROVAL VALID FOR 180 DAYS  
PERMIT EXPIRES 11-12-81  
UNLESS DRILLING UNDERWAY

Note: Original location was 660' FNL & 660' FEL, moved due to topography.

Gas Sales Are Dedicated to Transwestern Pipeline Company.

XC: NMOCD (6), TLS, CEN RCDS, ACCTG, ROSWELL, MEC, LAND, PARTNERS, FILE

IN ABOVE SPACE DESCRIBE PROPOSED PROGRAM; IF PROPOSAL IS TO DEEPEN OR PLUG BACK, GIVE DATA ON PRESENT PRODUCTIVE ZONE AND PROPOSED NEW PRODUCTIVE ZONE. GIVE BLOWOUT PREVENTER PROGRAM, IF ANY.

I hereby certify that the information above is true and complete to the best of my knowledge and belief.

Signed R. E. Walker Title REGULATORY COORDINATOR Date May 6, 1981

(This space for State Use)

APPROVED BY W. A. Gressett TITLE SUPERVISOR DISTRICT IV DATE MAY 13 1981

CONDITIONS OF APPROVAL, IF ANY:

**N MEXICO OIL CONSERVATION COMMISS**  
**WELL LOCATION AND ACREAGE DEDICATION PLAT**

Form C-102  
 Supersedes C-128  
 Effective 1-1-65

All distances must be from the outer boundaries of the Section.

Operator <b>Mesa Petroleum Co.</b>			Lease <b>Boswell State</b>		Well No. <b>1</b>
Unit Letter <b>J</b>	Section <b>30</b>	Township <b>5 South</b>	Range <b>21 East</b>	County <b>Chaves</b>	
Actual Footage Location of Well: <b>1650</b> feet from the <b>south</b> line and <b>1650</b> feet from the <b>east</b> line					
Ground Level Elev. <b>4258.3</b>	Producing Formation <b>PENN</b>	Pool <b>WILDCAT PENN</b>		Dedicated Acreage: <b>SE/4 160</b> Acres	

1. Outline the acreage dedicated to the subject well by colored pencil or hachure marks on the plat below.
2. If more than one lease is dedicated to the well, outline each and identify the ownership thereof (both as to working interest and royalty).
3. If more than one lease of different ownership is dedicated to the well, have the interests of all owners been consolidated by communitization, unitization, force-pooling, etc?

☐ Yes    ☐ No    If answer is "yes," type of consolidation \_\_\_\_\_

If answer is "no," list the owners and tract descriptions which have actually been consolidated. (Use reverse side of this form if necessary.) \_\_\_\_\_

No allowable will be assigned to the well until all interests have been consolidated (by communitization, unitization, forced-pooling, or otherwise) or until a non-standard unit, eliminating such interests, has been approved by the Commission.

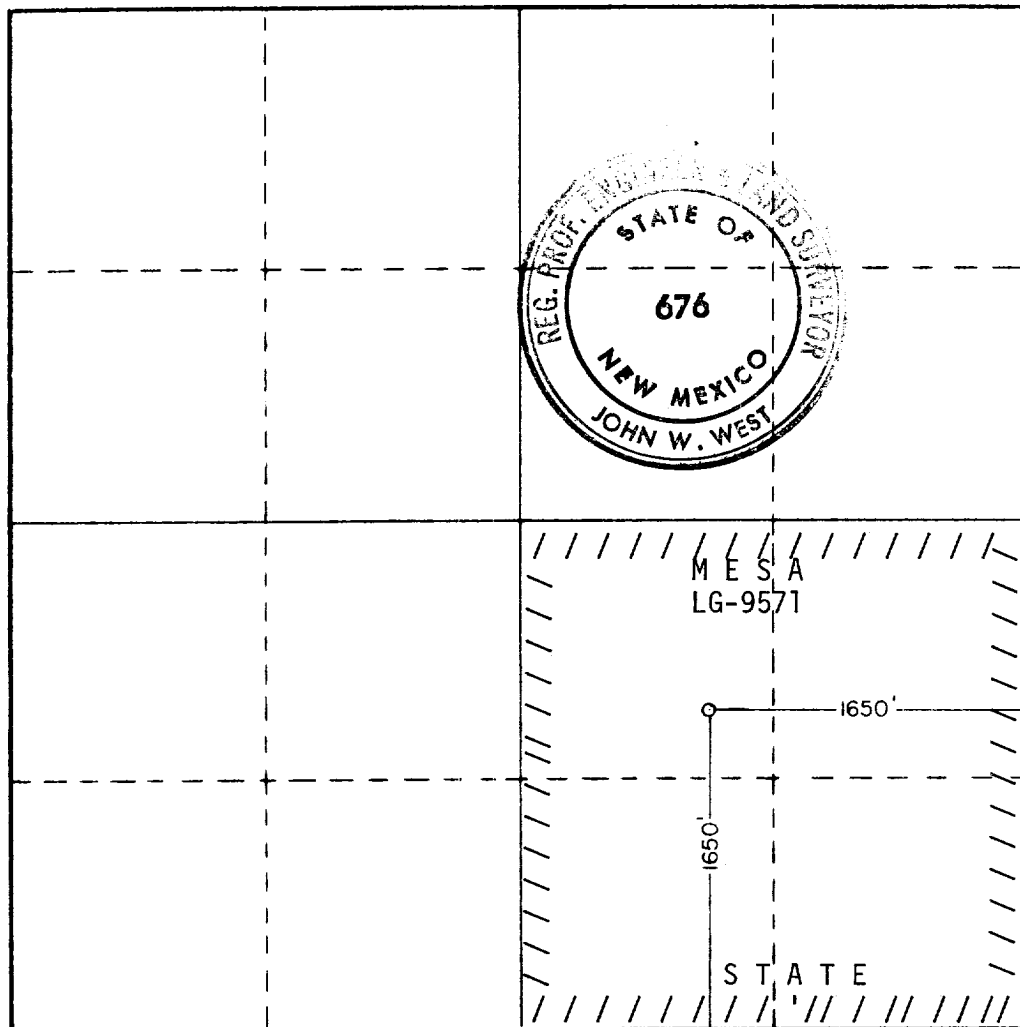

**CERTIFICATION**

I hereby certify that the information contained herein is true and complete to the best of my knowledge and belief.

*R. E. Mathis*

Name  
**R. E. MATHIS**  
 Position  
**REGULATORY COORDINATOR**  
 Company  
**MESA PETROLEUM CO**  
 Date  
**5-6-81**

I hereby certify that the well location shown on this plat was plotted from field notes of actual surveys made by me or under my supervision, and that the same is true and correct to the best of my knowledge and belief.

Date Surveyed  
**5-1-81**  
 Registered Professional Engineer and/or Land Surveyor

*John W. West*

Certificate No. **JOHN W. WEST 676**  
**PATRICK A. ROMERO 6863**  
**Ronald J. Eidson 3239**

