

All distances must be from the outer boundaries of the Section.

Operator McClellan Oil Corp.		Lease P-Z Federal		Well No. #1
Unit Letter 0	Section 7	Township 9 South	Range 26 East	County Chaves
Actual Footage Location of Well: 1650 feet from the East line and 1250 feet from the South line				
Ground Level Elev. 3720	Producing Formation Abo	Pool Wildcat	Dedicated Acreage: 160 Acres	

1. Outline the acreage dedicated to the subject well by colored pencil or hachure marks on the plat below.
2. If more than one lease is dedicated to the well, outline each and identify the ownership thereof (both as to working interest and royalty).
3. If more than one lease of different ownership is dedicated to the well, have the interests of all owners been consolidated by communitization, unitization, force-pooling, etc?

Yes No If answer is "yes," type of consolidation _____

If answer is "no," list the owners and tract descriptions which have actually been consolidated. (Use reverse side of this form if necessary.) _____

No allowable will be assigned to the well until all interests have been consolidated (by communitization, unitization, forced-pooling, or otherwise) or until a non-standard unit, eliminating such interests, has been approved by the Division.

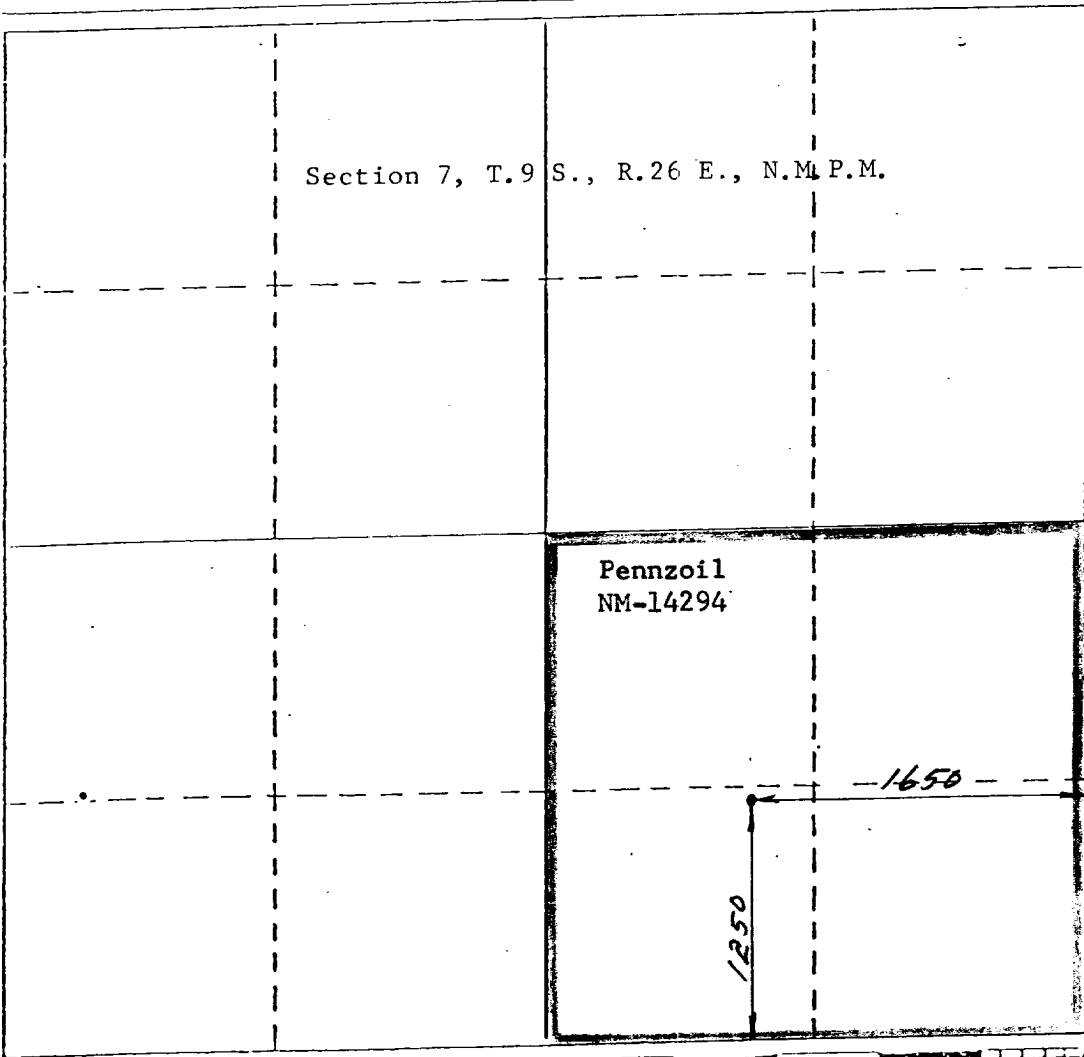

CERTIFICATION

I hereby certify that the information contained herein is true and complete to the best of my knowledge and belief.

George L. Smith, Jr.
Name
Jack L. McClellan
Position
President
Company
McClellan Oil Corporation
Date
July 7, 1981

I hereby certify that the well location shown on this plat was plotted from field notes of actual surveys made by me or under my supervision, and that the same is true and correct to the best of my knowledge and belief.

Date Surveyed
July 6, 1981
Registered Professional Engineer and/or Land Surveyor
John D. Jaques, P.E. & L.S.
Certificate No. **6290**

