

UNITED STATES
DEPARTMENT OF THE INTERIOR
GEOLOGICAL SURVEY

30-005-61627

APPLICATION FOR PERMIT TO DRILL, DEEPEN, OR PLUG BACK

1a. TYPE OF WORK
 DRILL DEEPEN PLUG BACK
 RECEIVED

b. TYPE OF WELL
 OIL WELL GAS WELL OTHER SINGLE ZONE MULTIPLE ZONE

2. NAME OF OPERATOR
 MESA PETROLEUM CO. ✓ JUN 1 1982

3. ADDRESS OF OPERATOR
 1000 VAUGHN BUILDING/MIDLAND, TEXAS 79701-4493
 O. C. D. ARTESIA, OFFICE

4. LOCATION OF WELL (Report location clearly and in accordance with any State requirements.)*
 At surface 1750 FSL & 1980' FEL NW/4 SE/4
 At proposed prod. zone SAME

14. DISTANCE IN MILES AND DIRECTION FROM NEAREST TOWN OR POST OFFICE*
 25 miles Northwest of Roswell, New Mexico

15. DISTANCE FROM PROPOSED* LOCATION TO NEAREST PROPERTY OR LEASE LINE, FT. (Also to nearest drig. unit line, if any) 1700'/660'

16. NO. OF ACRES IN LEASE 2459.68
 17. NO. OF ACRES ASSIGNED TO THIS WELL 160
 18. DISTANCE FROM PROPOSED LOCATION* TO NEAREST WELL, DRILLING, COMPLETED, OR APPLIED FOR, ON THIS LEASE, FT. 1330'
 19. PROPOSED DEPTH 3500'

20. ROTARY OR CABLE TOOLS ROTARY
 21. APPROX. DATE WORK WILL START* JUNE 18, 1982

23. PROPOSED CASING AND CEMENTING PROGRAM

SIZE OF HOLE	SIZE OF CASING	WEIGHT PER FOOT	SETTING DEPTH	QUANTITY OF CEMENT
12 1/4"	8 5/8"	24#	1400'	700/300 SURFACE
7 7/8"	4 1/2"	10.5#	3500'	COVER ABO

Propose to drill 12 1/4" hole to approximately 1400' to set 8 5/8" surface casing and cement to surface. Will nipple up ram type BOP's and reduce hole to 7 7/8" to drill to total depth. Drilling medium will be air, foam, or mud as required. After log evaluation, 4 1/2" casing may be run and cemented with sufficient kinds and amounts to isolate and seal off any fresh water, oil or gas zones encountered.

Operator's Gas Sales are dedicated.

RECEIVED
MAY 19 1982
OIL & GAS
U.S. GEOLOGICAL SURVEY
ROSWELL, NEW MEXICO

Part of ID-1
NL & API Book
6-4-82

XC: MMS (7), TLS, CEN RCDS, ACCTG, MEC, LAND, ROSWELL, REM, FILE, (PARTNERS

IN ABOVE SPACE DESCRIBE PROPOSED PROGRAM: If proposal is to deepen or plug back, give data on present productive zone and proposed new productive zone. If proposal is to drill or deepen directionally, give pertinent data on subsurface locations and measured and true vertical depths. Give blowout preventer program, if any.

24. SIGNED R.E. Mathis by Myrl Austin TITLE REGULATORY COORDINATOR DATE 5-18-82

(This space for Federal or State office use)
 PERMIT NO. Org. Sec.) GEORGE H. STEWART APPROVAL DATE

APPROVED BY MAY 27 1982 TITLE DATE
 CONDITIONS OF APPROVAL, IF ANY:
 FOR JAMES A. GILLHAM DISTRICT SUPERVISOR

OIL CONSERVATION DIVISION

STATE OF NEW MEXICO
ENERGY AND MINERALS DEPARTMENT

P. O. BOX 2088
SANTA FE, NEW MEXICO 87501

Form C-102
Revised 10-1-78

All distances must be from the outer boundaries of the Section.

Operator Mesa Petroleum Co.		Lease China Federal		Well No. #6
Unit Letter J	Section 17	Township 7 South	Range 23 East	County Chaves
Actual Postage Location of Well:				
1750	feet from the	South	line and	1980
				feet from the
				East
				line
Ground Level Elev. 3979	Producing Formation ABO		Pool UNDESIGNATED	Dedicated Acreage: SE/4 160 Acres

1. Outline the acreage dedicated to the subject well by colored pencil or hachure marks on the plat below.
2. If more than one lease is dedicated to the well, outline each and identify the ownership thereof (both as to working interest and royalty).
3. If more than one lease of different ownership is dedicated to the well, have the interests of all owners been consolidated by communitization, unitization, force-pooling, etc?

Yes No If answer is "yes," type of consolidation _____

If answer is "no," list the owners and tract descriptions which have actually been consolidated. (Use reverse side of this form if necessary.) _____

No allowable will be assigned to the well until all interests have been consolidated (by communitization, unitization, forced-pooling, or otherwise) or until a non-standard unit, eliminating such interests, has been approved by the Division.

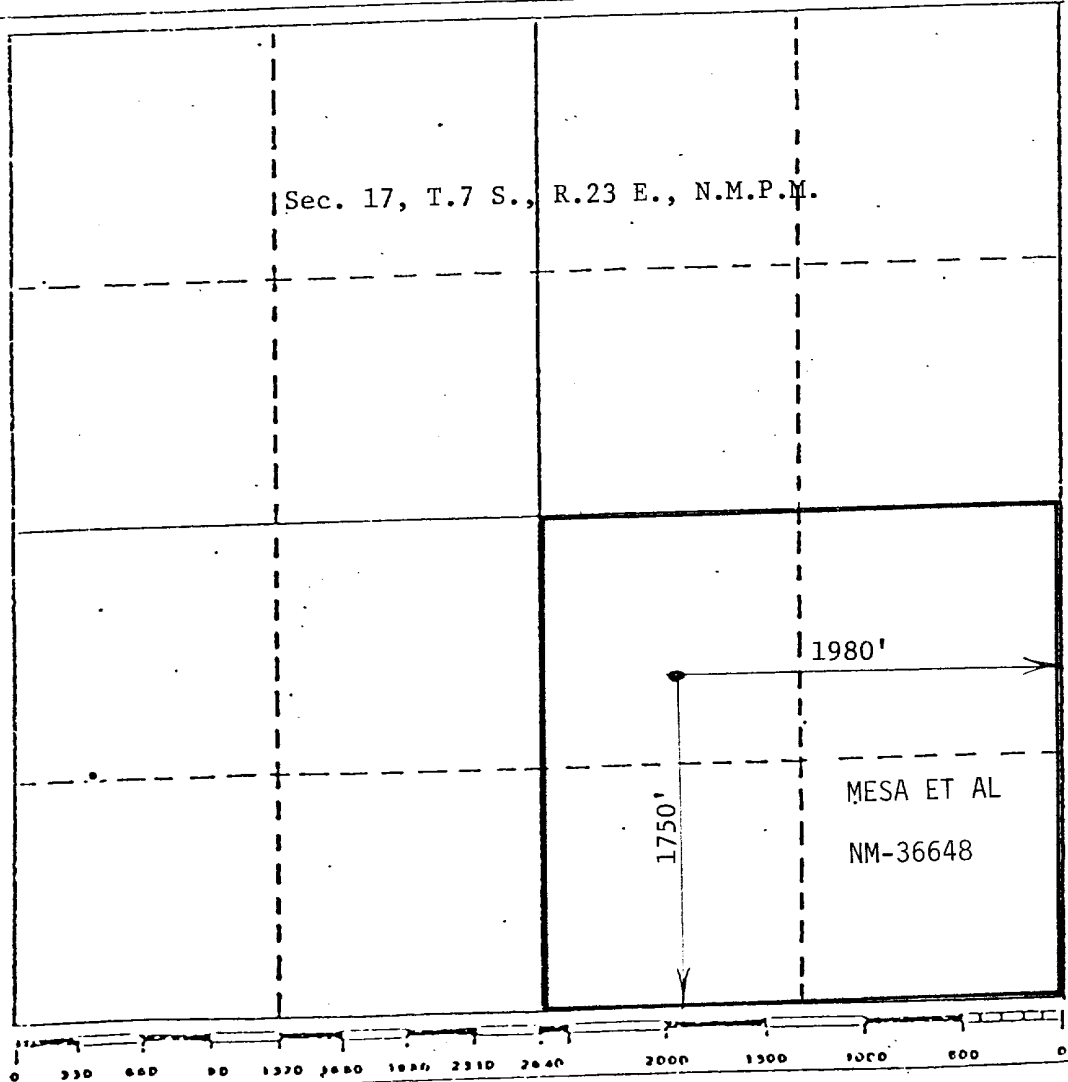

CERTIFICATION

I hereby certify that the information contained herein is true and complete to the best of my knowledge and belief.

Michael P. Houston

Name
MICHAEL P. HOUSTON

Position
OPERATIONS MANAGER

Company
MESA PETROLEUM CO.

Date
MAY 18, 1982

I hereby certify that the well location shown on this plat was plotted from field notes of actual surveys made by me or under my supervision, and that the same is true and correct to the best of my knowledge and belief.

Date Surveyed
May 17, 1982

Registered Professional Engineer and/or Land Surveyor
John D. Jaquess, P.E. & L.S.

Certificate No. 6290

APPLICATION FOR PERMIT TO DRILL

MESA PETROLEUM CO.
CHINA FEDERAL #6
1750 FSL & 1980' FEL, SEC 17, T7S, R23E
CHAVES COUNTY, NEW MEXICO

LEASE NO. NM-36648

In conjunction with Form 9331-C, Application For Permit to Drill subject well, the following additional information is provided:

1. Applicable portions of the GENERAL REQUIREMENTS FOR OIL AND GAS OPERATIONS ON FEDERAL LEASES, Roswell District, Geological Survey of September 1, 1980 will be adhered to.
2. Geological markers are estimated as follows:

SEVEN RIVERS	Surface
SAN ANDRES	Surface
GLORIETA	544'
TUBB	740'
ABO	2788'
3. Hydrocarbon bearing strata may occur in the Abo formation(s). No fresh water is expected to be encountered below 1400'.
4. The Casing and Blowout Preventer Program will be determined by hole conditions as encountered. See Exhibit VI. Anticipate drilling with air or foam using ram type preventer and rotating head for well control. The 8 5/8" casing will be set at approximately 1400' to protect any fresh water zones and cemented to the surface. The 4 1/2" production casing will be set at total depth or shallower depending upon the depth of the deepest commercial hydrocarbon bearing strata encountered. Sufficient amounts and kinds of cement would be used to ensure any water, gas, or oil zones encountered are isolated and shut off down to the casing point if run.
5. No drill stem test or coring program is planned. The logging program may consist of a GR-CNL from surface total depth and FDC from casing point to total depth.
6. Anticipated drilling time is ten days with completion operations to follow as soon as a completion unit is available.

Blow-out Preventers hydril and choke manifold are all 900 Series

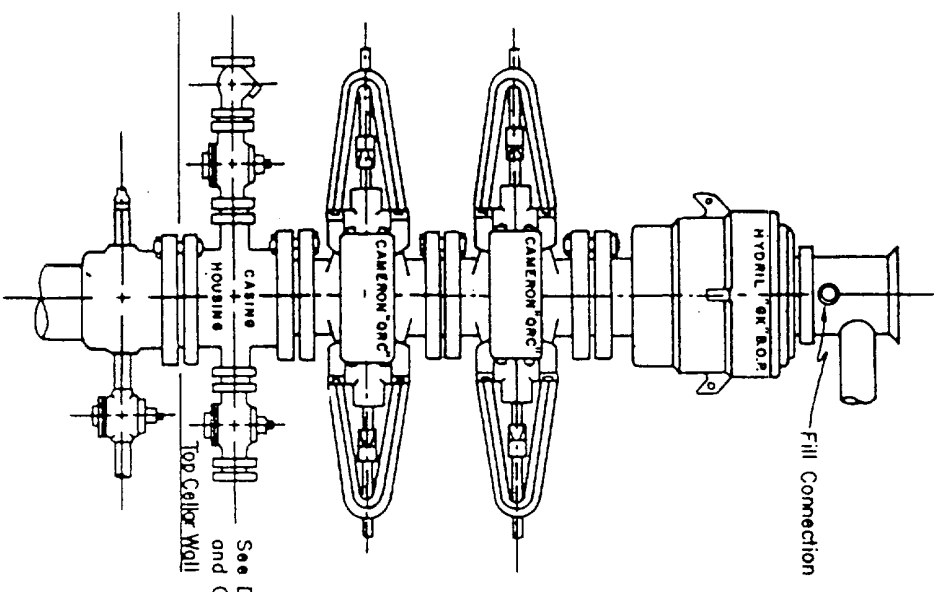

See Detail of 4" Flow Line and Choke Assembly

3,000 PSI WORKING PRESSURE
BLOW-OUT PREVENTER HOOK-UP

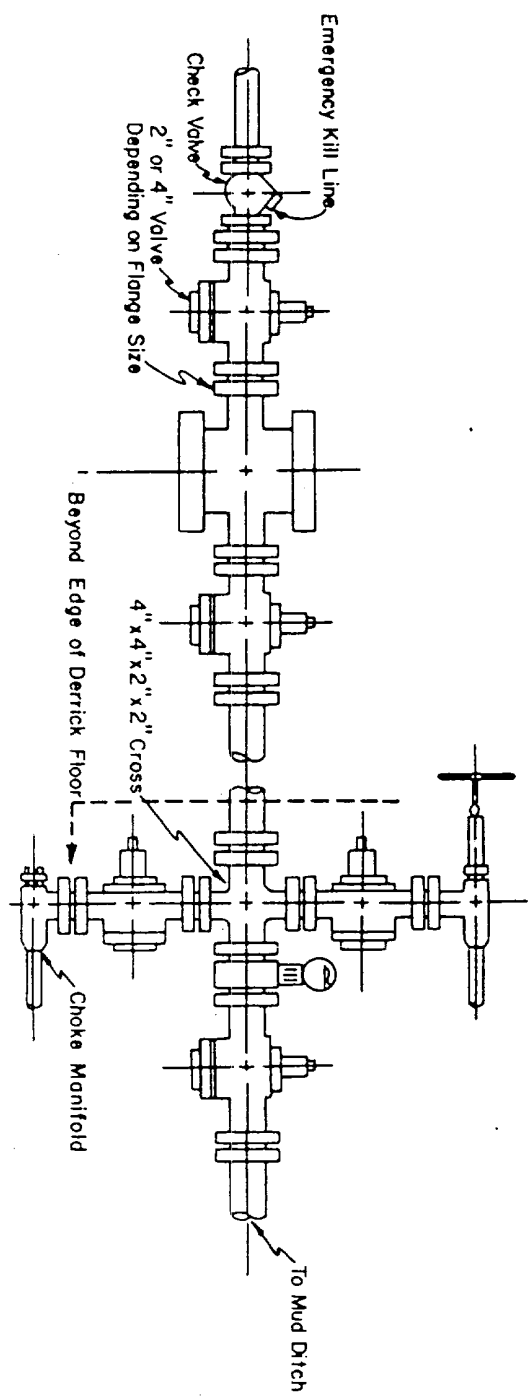

3,000 PSI WORKING PRESSURE
KILL, CHOKE, AND FILL CONNECTIONS

DETAIL OF 4" FLOW LINE CHOKE ASSEMBLY

Minimum assembly for 3,000 PSI working pressure will consist of three preventers.
The bottom and middle preventers may be Cameron.

NOTE: HYDRIL not installed on shallow-low pressure wells.
RAM type BOPs are API 10" X 3000 PSI



E X H I B I T

V I

REV.	DATE	BY