

UNITED STATES
DEPARTMENT OF THE INTERIOR
GEOLOGICAL SURVEY

APPLICATION FOR PERMIT TO DRILL, DEEPEN, OR PLUG BACK

1a. TYPE OF WORK
DRILL ☒ DEEPEN ☐ PLUG BACK ☐

b. TYPE OF WELL
OIL WELL ☐ GAS WELL ☒ OTHER ☐ SINGLE ZONE ☒ MULTIPLE ZONE ☐

2. NAME OF OPERATOR
MESA PETROLEUM CO.

3. ADDRESS OF OPERATOR
1000 VAUGHN BUILDING/MIDLAND, TEXAS 79701-4493

4. LOCATION OF WELL (Report location clearly and in accordance with any State requirements)
At surface 1880' FNL & 1980' FEL SW 1/4 NE 1/4 G
At proposed prod. zone SAME

5. LEASE DESIGNATION AND SERIAL NO.
NM-36710

6. IF INDIAN, ALLOTTEE OR TRIBE NAME

7. UNIT AGREEMENT NAME

8. FARM OR LEASE NAME
MAXINE FEDERAL

9. WELL NO.
1

10. FIELD AND POOL, OR WILDCAT
WILDCAT ABO

11. SEC., T., R., M., OR BLK. AND SURVEY OR AREA
SEC 20, T7S, R22E

12. COUNTY OR PARISH
CHAVES

13. STATE
NEW MEXICO

14. DISTANCE IN MILES AND DIRECTION FROM NEAREST TOWN OR POST OFFICE*
30 MILES NORTHWEST OF ROSWELL, NEW MEXICO

15. DISTANCE FROM PROPOSED* LOCATION TO NEAREST PROPERTY OR LEASE LINE, FT. (Also to nearest drlg. unit line, if any)
660'/660'

16. NO. OF ACRES IN LEASE
2560

17. NO. OF ACRES ASSIGNED TO THIS WELL
160

18. DISTANCE FROM PROPOSED LOCATION* TO NEAREST WELL, DRILLING, COMPLETED, OR APPLIED FOR, ON THIS LEASE, FT.
2 MILES

19. PROPOSED DEPTH
3400'

20. ROTARY OR CABLE TOOLS
ROTARY

21. ELEVATIONS (Show whether DF, RT, GR, etc.)
4404' GR

22. APPROX. DATE WORK WILL START*
SEPTEMBER 20, 1982

23. PROPOSED CASING AND CEMENTING PROGRAM

SIZE OF HOLE	SIZE OF CASING	WEIGHT PER FOOT	SETTING DEPTH	QUANTITY OF CEMENT
12 1/4"	8 5/8"	24#	1400'	700/300 SURFACE
7 7/8"	4 1/2"	10.5#	3400'	300 COVER ALL PAY

Propose to drill 12 1/4" hole to approximately 1400' to set 8 5/8" surface casing and cement to surface. Will nipple up ram type BOP's and reduce hole to 7 7/8" to drill to total depth. Drilling medium will be air, foam, or mud as required. After log evaluation, 4 1/2" casing may be run and cemented with sufficient kinds and amounts to isolate and seal off any fresh water, oil or gas zones encountered.

Operator's Gas Sales are dedicated.

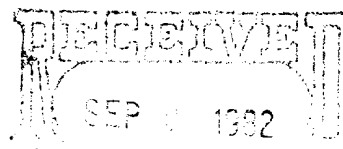

Posted ED-1
9-24-82
APF + BR

XC: MMS (7), TLS, CEN RCDS, ACCTG, MEC, LAND, ROSWELL, REM, FILE, (PARTNERS)

IN ABOVE SPACE DESCRIBE PROPOSED PROGRAM: If proposal is to deepen or plug back, give data on present productive zone and proposed new productive zone. If proposal is to drill or deepen directionally, give pertinent data on subsurface locations and measured and true vertical depths. Give blowout preventer program, if any.

24. SIGNED William R. Gillham Sr. Deug ENGR FOR TITLE REGULATORY COORDINATOR DATE 9-7-82

(This space for Federal or State office use)
GEORGE H. STEWART

PERMIT NO. SEP 10 1982 APPROVAL DATE

APPROVED BY JAMES A. GILLHAM TITLE DISTRICT SUPERVISOR DATE

OIL CONSERVATION DIVISION

STATE OF NEW MEXICO
ENERGY AND MINERALS DEPARTMENT

P. O. BOX 2008

SANTA FE, NEW MEXICO 8750

Form C-102
Revised 10-1-78

All distances must be from the outer boundaries of the Section.

Operator Mesa Petroleum Co.		Lease Maxine Federal		Well No. #1
Unit Letter G	Section 20	Township 7 South	Range 22 East	County Chaves
Actual Footage Location of Well: 1880' feet from the North line and 1980 feet from the East line				
Ground Level Elev. 4404	Producing Formation ABO	Pool WILDCAT - <i>Also</i>		Dedicated Acreage: NE/4 160 Acres

1. Outline the acreage dedicated to the subject well by colored pencil or hatchure marks on the plat below.
2. If more than one lease is dedicated to the well, outline each and identify the ownership thereof (both as to working interest and royalty).
3. If more than one lease of different ownership is dedicated to the well, have the interests of all owners been consolidated by communitization, unitization, force-pooling, etc?

☐ Yes ☐ No If answer is "yes," type of consolidation _____

If answer is "no," list the owners and tract descriptions which have actually been consolidated. (Use reverse side of this form if necessary.) _____

No allowable will be assigned to the well until all interests have been consolidated (by communitization, unitization, forced-pooling, or otherwise) or until a non-standard unit, eliminating such interests, has been approved by the Division.

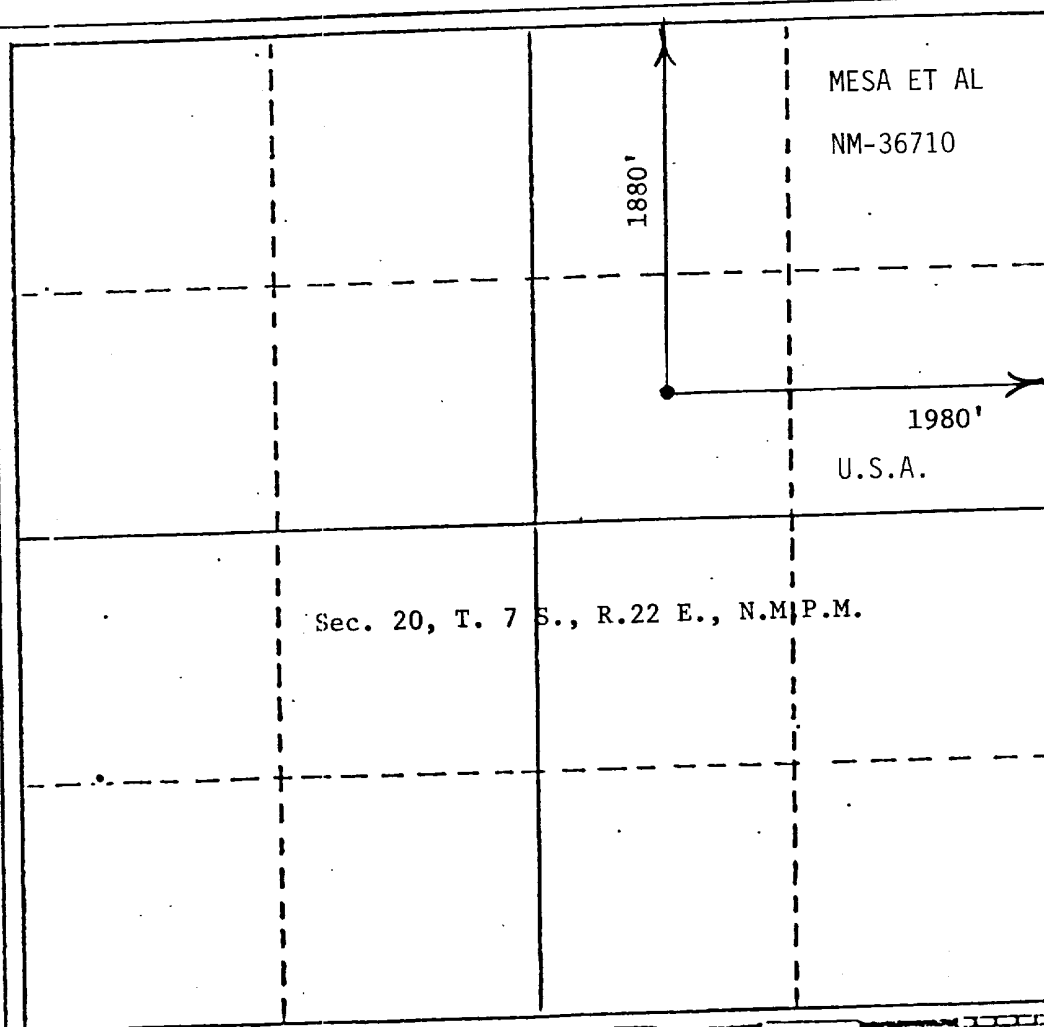

CERTIFICATION

I hereby certify that the information contained herein is true and complete to the best of my knowledge and belief.

William R. Mathis Sr. DEEG ENGR

Name **FOR**
R.E. Mathis
Position
Regulatory Coordinator
Company
Mesa Petroleum Co.
Date
September 7, 1982

I hereby certify that the well location shown on this plat was plotted from field notes of actual surveys made by me or under my supervision, and that the same is true and correct to the best of my knowledge and belief.

JOHN D. JAQUESS
Date Surveyed
August 30, 1982
Registered Professional Engineer
No. **6290**
John D. Jaquess, P.E. & L.S.
Certificate No.
6290

APPLICATION FOR PERMIT TO DRILL

MESA PETROLEUM CO.
MAXINE FEDERAL #1
1880' FNL & 1980' FEL, SEC 20, T7S, R22E
CHAVES COUNTY, NEW MEXICO

LEASE NO. NM-36710



In conjunction with Form 9331-C, Application For Permit to Drill subject well, the following additional information is provided:

1. Applicable portions of the GENERAL REQUIREMENTS FOR OIL AND GAS OPERATIONS ON FEDERAL LEASES, Roswell District, Geological Survey of September 1, 1980 will be adhered to.
2. Geological markers are estimated as follows:

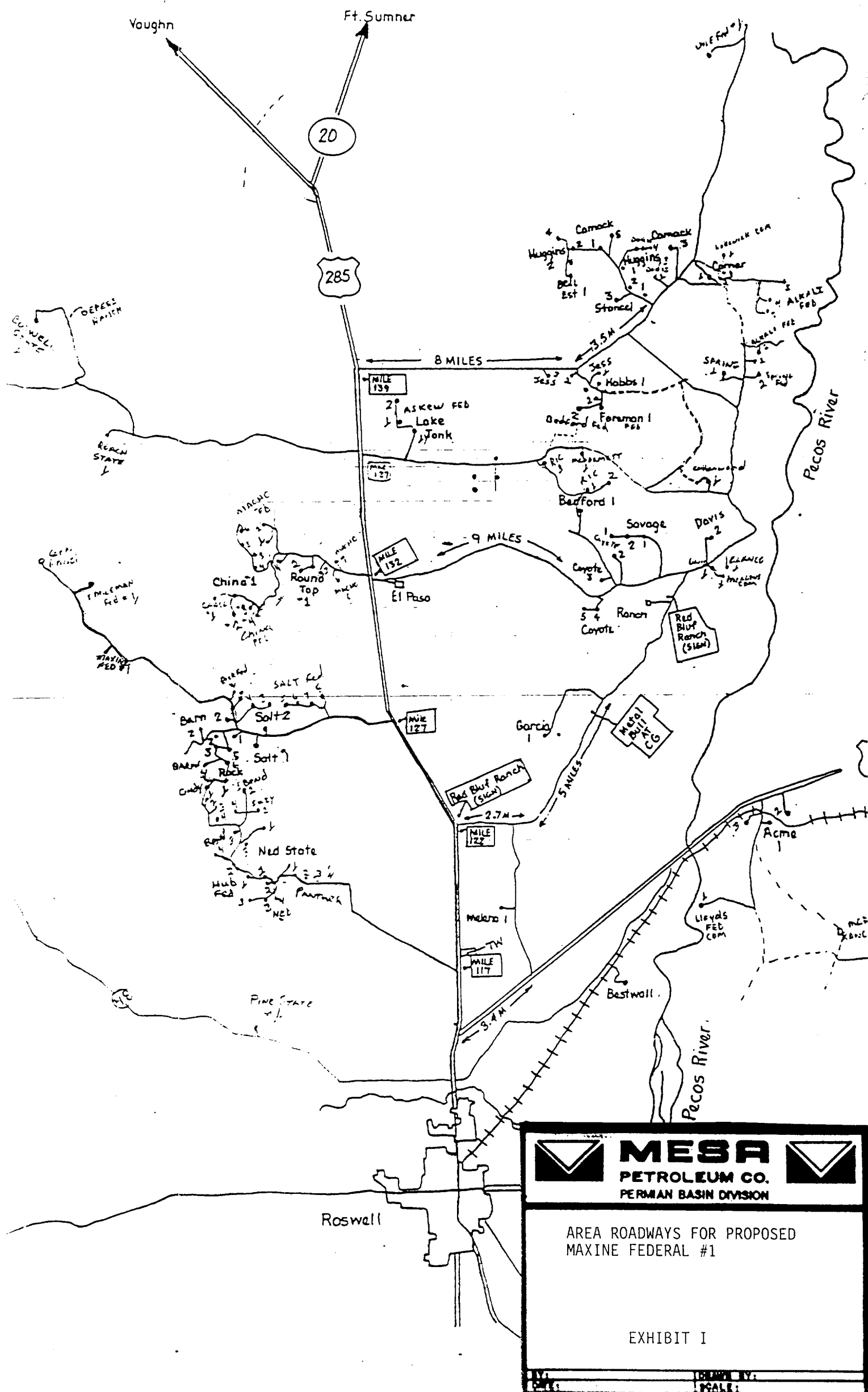
SAN ANDRES	Surface
GLORIETA	490
TUBB	2116
ABO	2758
3. Hydrocarbon bearing strata may occur in the Abo formation(s). No fresh water is expected to be encountered below 1400'.
4. The Casing and Blowout Preventer Program will be determined by hole conditions as encountered. See Exhibit VI. Anticipate drilling with air or foam using ram type preventer and rotating head for well control. The 8 5/8" casing will be set at approximately 1400' to protect any fresh water zones and cemented to the surface. The 4 1/2" production casing will be set at total depth or shallower depending upon the depth of the deepest commercial hydrocarbon bearing strata encountered. Sufficient amounts and kinds of cement would be used to ensure any water, gas, or oil zones encountered are isolated and shut off down to the casing point if run.
5. No drill stem test or coring program is planned. The logging program may consist of a GR-CNL from surface total depth and FDC from casing point to total depth.
6. Anticipated drilling time is ten days with completion operations to follow as soon as a completion unit is available.

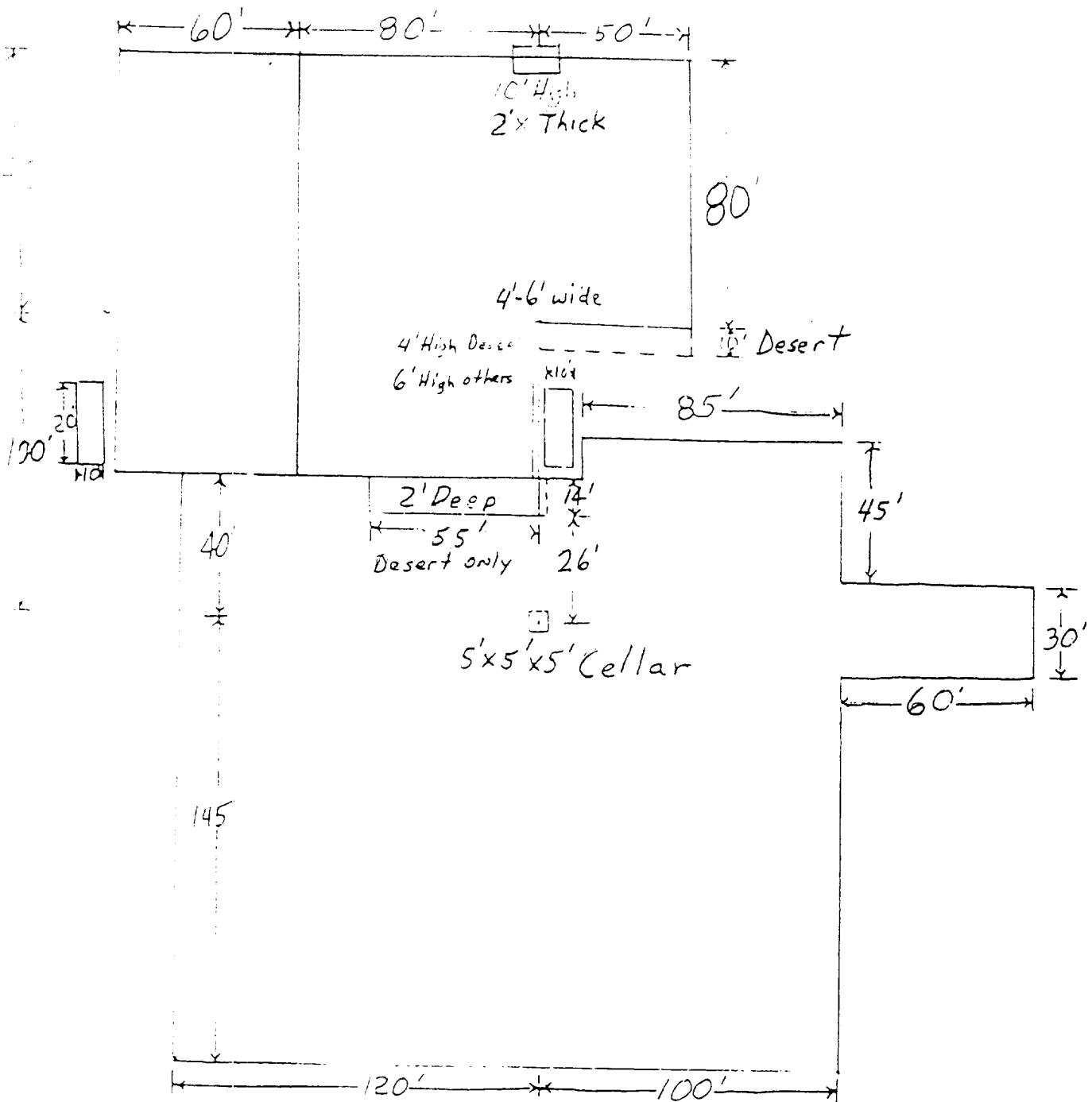



		MESA PETROLEUM CO. PERMIAN BASIN DIVISION		
EXHIBIT V				
FOR PROPOSED MAXINE FEDERAL #1				
BY:		DRAWN BY:		
DATE:		SCALE:		

Blow-out Preventers hydril and choke manifold are oil 900 Series

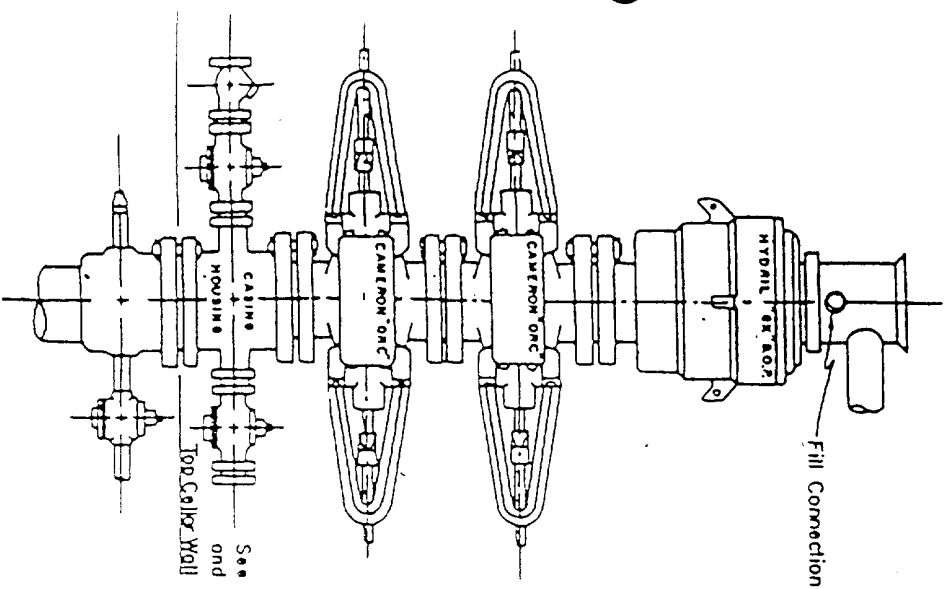

3,000 PSI WORKING PRESSURE
BLOW-OUT PREVENTER HOOK-UP

See Detail of 4" Flow Line
and Choke Assembly

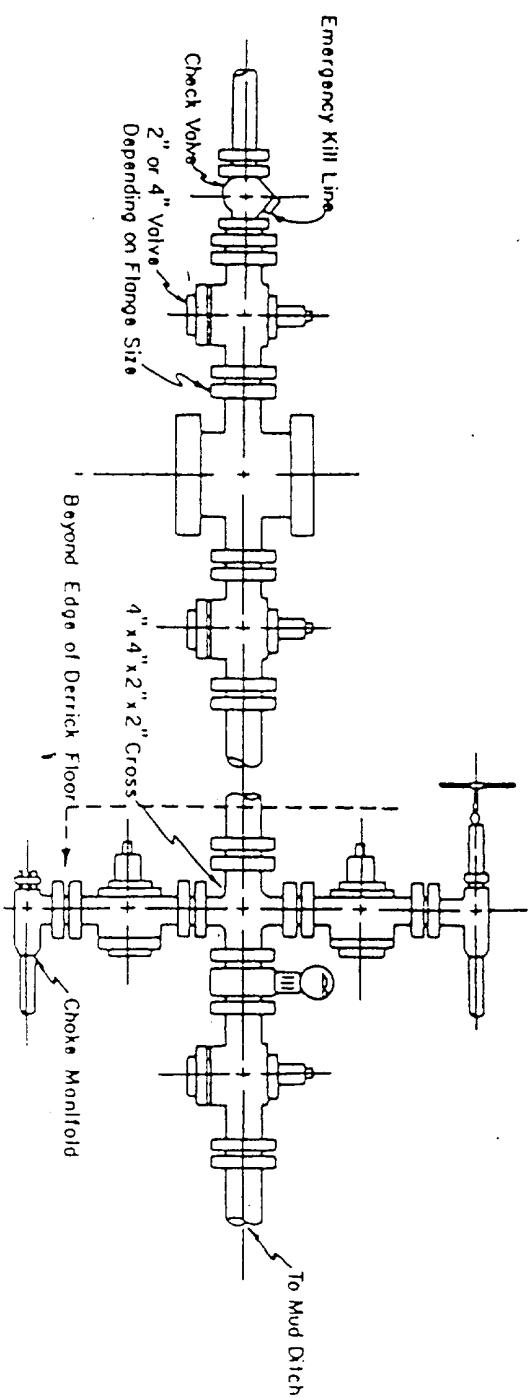

3,000 PSI WORKING PRESSURE
KILL, CHOKE, AND FILL CONNECTIONS

DETAIL OF 4" FLOW LINE CHOKE ASSEMBLY

Minimum assembly for 3,000 PSI working pressure will consist of three preventers.
The bottom and middle preventers may be Cameron

NOTE: HYDRIL, not installed on shallow-low pressure wells.
RAM type BOPs are API 10" X 3000 PSI

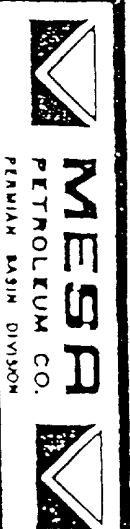

E X H I B I T

V I