

C/SF 30-005-01781

RECEIVED

AUG 27 1982

APPLICATION FOR PERMIT TO DRILL, DEEPEN, OR PLUG BACK

1a. TYPE OF WORK

DRILL ☒DEEPEN ☐OIL & GAS
PLUG BACK ☐

b. TYPE OF WELL

OIL
WELL ☐GAS
WELL ☒OTHER ☐MINERALS MGMT. SERVICE
ROSWELL, NEW MEXICO
ZONE ☐ ZONE ☐

2. NAME OF OPERATOR

McClellan Oil Corporation

3. ADDRESS OF OPERATOR

P.O. Drawer 730, Roswell, NM 88202

RECEIVED

4. LOCATION OF WELL (Report location clearly and in accordance with any State requirements.)*

At surface

660' FNL & 1980' FWL

SEP 9 1982

At proposed prod. zone

14. DISTANCE IN MILES AND DIRECTION FROM NEAREST TOWN OR POST OFFICE*

14 miles Northeast of Roswell, NM

O. C. D.
ARTESIA, OFFICE

15. DISTANCE FROM PROPOSED*

LOCATION TO NEAREST

PROPERTY OR LEASE LINE, FT.

(Also to nearest drlg. unit line, if any)

660'

16. NO. OF ACRES IN LEASE

320

17. NO. OF ACRES ASSIGNED TO THIS WELL

160

18. DISTANCE FROM PROPOSED LOCATION*

TO NEAREST WELL, DRILLING, COMPLETED,
OR APPLIED FOR, ON THIS LEASE, FT.

NA

19. PROPOSED DEPTH

4700'

20. ROTARY OR CABLE TOOLS

Rotary

21. ELEVATIONS (Show whether DF, RT, GR, etc.)

3786' G.L.

22. APPROX. DATE WORK WILL START*

Nov. 15, 1982

23.

PROPOSED CASING AND CEMENTING PROGRAM

SIZE OF HOLE	SIZE OF CASING	WEIGHT PER FOOT	SETTING DEPTH	QUANTITY OF CEMENT
12-1/4"	8-5/8"	23#	920'	650 sx Circulated
7-7/8"	4-1/2"	10.5#	4700'	375 sx

Will drill to approximately 4700' to test the Abo formation. If production is indicated, will run casing and attempt completion.

Estimated Geological Tops: San Andres: 800'
Glorieta: 1910'
Tubb: 3400'
Abo: 4170'

Mud Program: Will use native mud to top of Abo. Mud-up 100' above top of Abo with salt base gel having 15cc water loss, and 10 lb/gal mud wt.

Gas is not dedicated.

IN ABOVE SPACE DESCRIBE PROPOSED PROGRAM: If proposal is to deepen or plug back, give data on present productive zone and proposed new productive zone. If proposal is to drill or deepen directionally, give pertinent data on subsurface locations and measured and true vertical depths. Give blowout preventer program, if any.

24.

SIGNED

Mark McClellan

TITLE Geologist

DATE 8-2-82

(This space for Federal or State office use)

(Orig. Sgd.)

PERMIT NO.

GEORGE H. STEWART

APPROVAL DATE

APPROVED BY

SEP 9 1982

TITLE

DATE

CONDITIONS OF APPROVAL, IF ANY:

FRANK A. GILHAM
DISTRICT DIRECTORPosted TO-1
9-24-82
API & BK

All distances must be from the outer boundaries of the Section.

Operator McClellan Oil Corp.		Lease Tyrell Com Federal		Well No. #1
Unit Letter C	Section 13	Township 10 South	Range 25 East	County Chaves
Actual Postage Location of Well: 660 feet from the North line and 1980 feet from the West line				
Ground Level Elev. 3786	Producing Formation Abo	Pool Wildcat	Dedicated Acreage: 160 Acres	

1. Outline the acreage dedicated to the subject well by colored pencil or hatchure marks on the plat below.
2. If more than one lease is dedicated to the well, outline each and identify the ownership thereof (both as to working interest and royalty).
3. If more than one lease of different ownership is dedicated to the well, have the interests of all owners been consolidated by communitization, unitization, force-pooling, etc?

☐ Yes ☐ No If answer is "yes," type of consolidation _____

If answer is "no," list the owners and tract descriptions which have actually been consolidated. (Use reverse side of this form if necessary.) _____

No allowable will be assigned to the well until all interests have been consolidated (by communitization, unitization, forced-pooling, or otherwise) or until a non-standard unit, eliminating such interests, has been approved by the Division.

RECEIVED

AUG 21 1982

**OIL & GAS
MINERALS MGMT. SERVICE
ROSWEIL, NEW MEXICO**

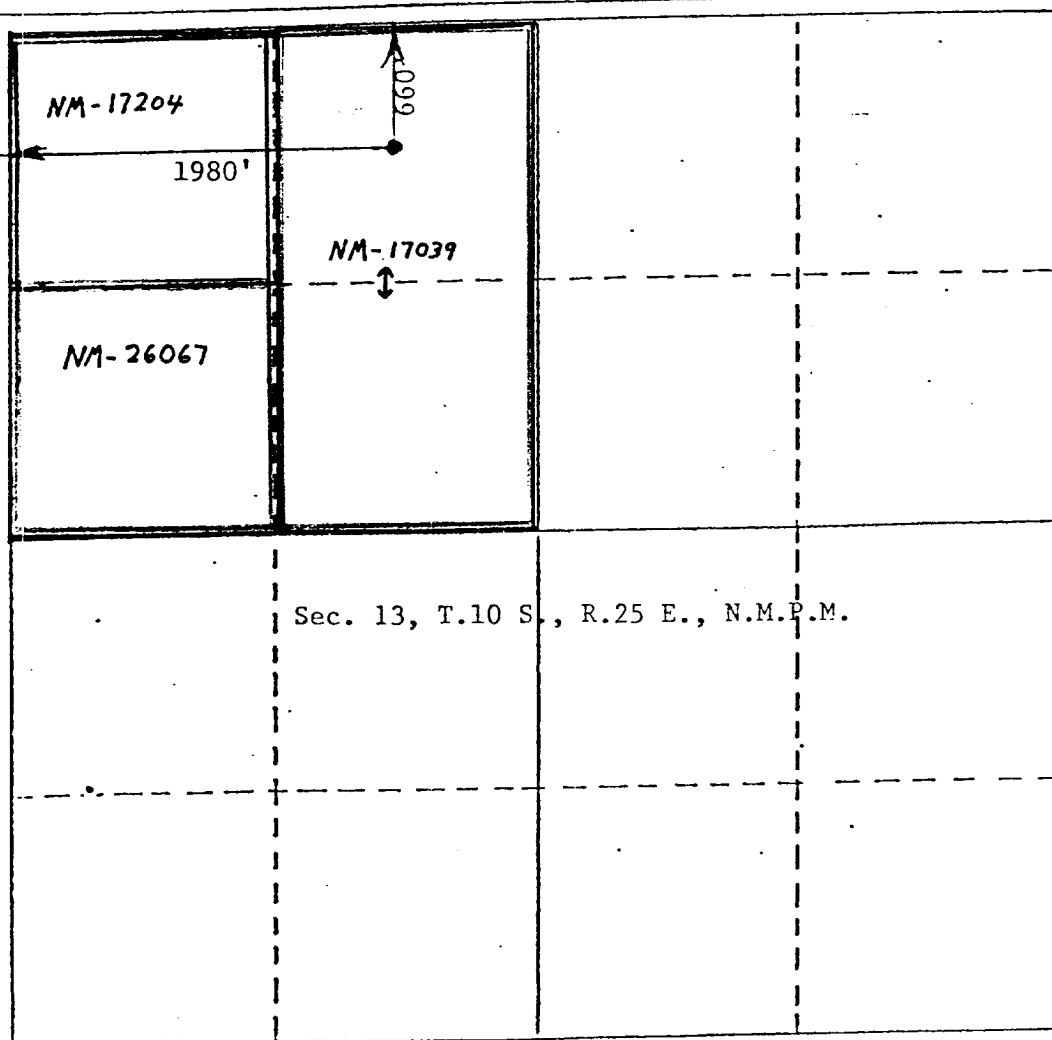

CERTIFICATION

I hereby certify that the information contained herein is true and complete to the best of my knowledge and belief.

Mark McClellan

Name

Mark McClellan

Position

Geologist

Company

McClellan Oil Corp.

Date

August 2, 1982

I hereby certify that the well location shown on this plat was plotted from field notes of actual surveys made by me or under my supervision, and that the same is true and correct to the best of my knowledge and belief.

Date Surveyed

July 22, 1982

Registered Professional Engineer and a Land Surveyor

JOHN D. JAQUES
6290
Professional Engineer
E. & L.S.

Tyrell Com Federal No. 1
REQUIREMENTS
(NTL-6)

1. Location: Section 13-T10S-R25E, 660' FNL & 1980' FWL
2. Elevation: 3786 G.L.
3. Geologic name of surface formation: See Archaeological Report
4. Type of drilling rig and associated equipment: Rotary
5. Proposed drilling depth and objective formation: 4700' - Abo
6. Estimated tops of geologic markers:

Yates _____	San Andres <u>800'</u>	Abo <u>4170'</u>
7-Rivers _____	Glorieta <u>1910'</u>	Wolfcamp _____
Queen _____	Tubb <u>3400'</u>	_____
7. Estimated depths of any oil, water, or gas: Gas: 4170'-4700'
- 8-9. Proposed casing program:

<u>8-5/8"</u> @ <u>920'</u> Grade <u>J-55</u> Wt. <u>23#</u> Type Cement <u>650 sx Class "C"</u>
<u>4-1/2"</u> @ <u>4700'</u> Grade <u>J-55</u> Wt. <u>10.5#</u> Type Cement <u>375 sx 50/50 Poz-C</u>
_____ " @ _____ ' Grade _____ Wt. _____ Type Cement _____
10. Specifications for pressure control equipment and testing procedures: Schaeffer type E 10" Series 900 Hydraulic BOP
11. Type and characteristics of drilling fluids: Native mud to top of Abo
Mud up with salt base gel; 40 visc, 15 cc water loss & 9.5 lb/gal mud.
12. Testing, logging, and coring programs: No testing or coring is anticipated.
Will run Compensated Neutron Formation Density & Dual Laterolog gamma ray logs.
13. Anticipated abnormal pressures or temperature: None anticipated
14. Anticipated commencement and completion date: Nov. 15, 1982, December 1, 1982
15. Other pertinent information: _____

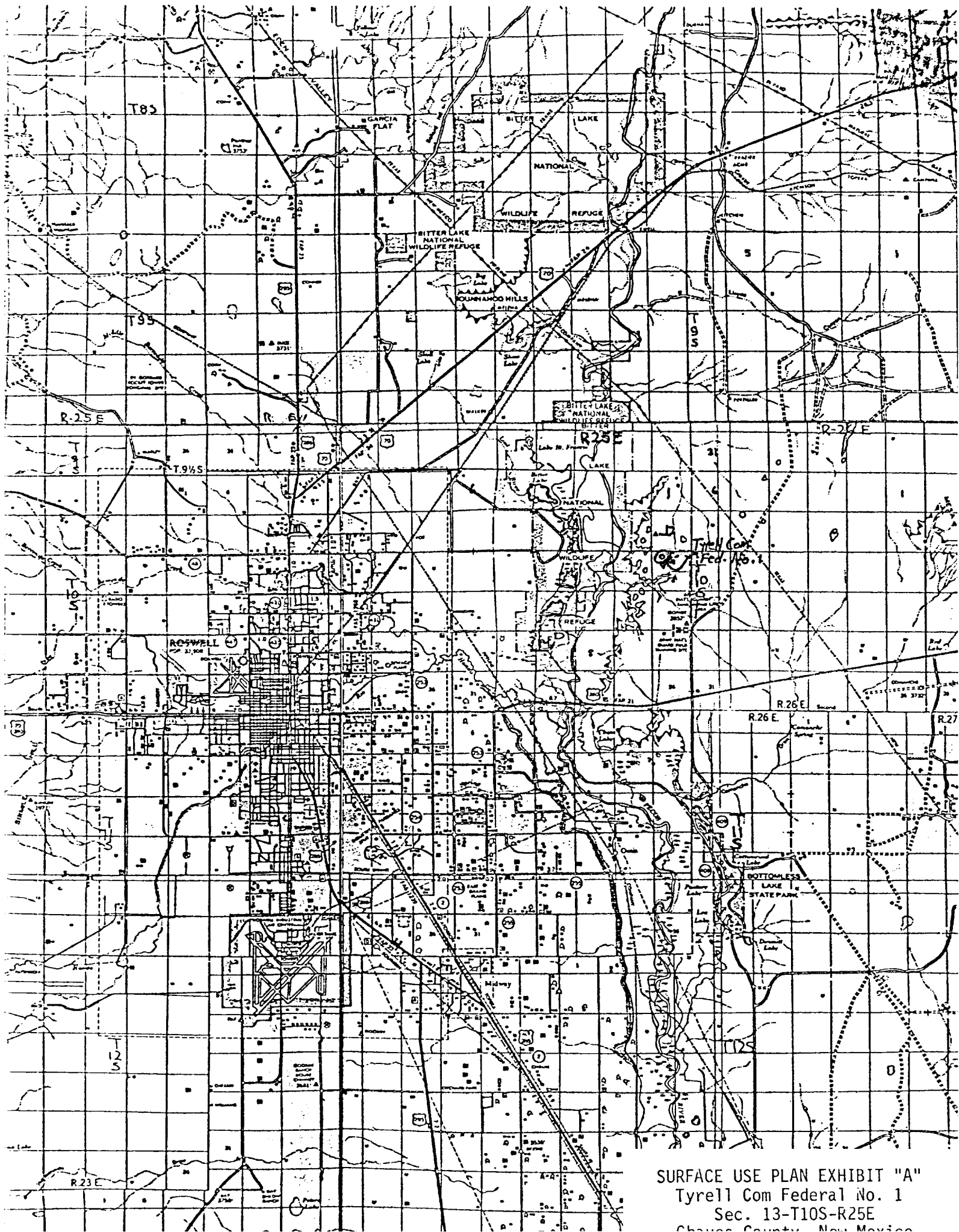

SURFACE USE PLAN EXHIBIT "A"
Tyrell Com Federal No. 1
Sec. 13-T10S-R25E
Chaves County, New Mexico

McCLELLAN OIL CORPORATION
SUGGESTED PAD DIMENSIONS

Reserve Pits 4 ft. deep, plastic lined

Working pits 5 ft. deep

No cellar

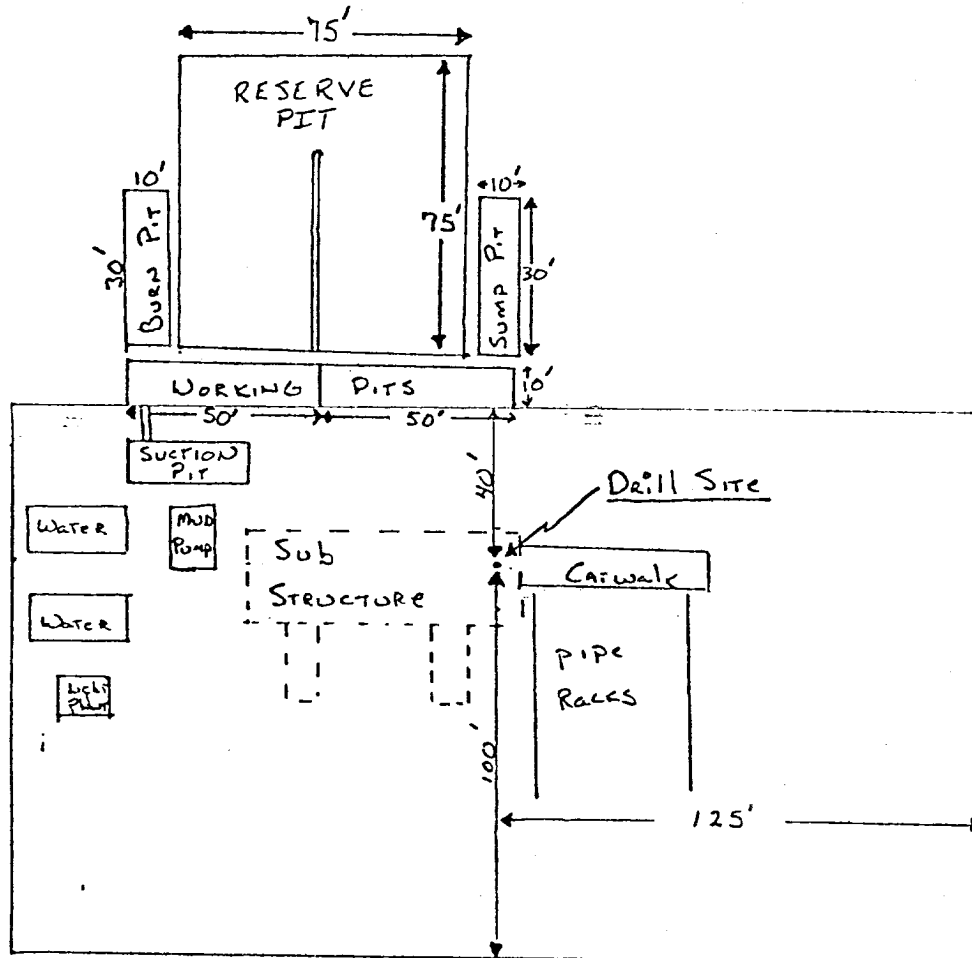

Scale 1" = 50'

BLOWOUT PREVENTER SPECIFICATION

