

All distances must be from the outer boundaries of the Section.

Operator McClellan Oil Corp.		Lease Dana Federal		Well No. #4
Unit Letter K	Section 3	Township 9 South	Range 25 East	County Chaves
Actual Postage Location of Well: 1980 feet from the West line and 2310 feet from the South line				
Ground Level Elev. 3549	Producing Formation Abo	Pool Pecos Slope Abo	Dedicated Acreage: 160 Acres	

1. Outline the acreage dedicated to the subject well by colored pencil or hatchure marks on the plat below.
2. If more than one lease is dedicated to the well, outline each and identify the ownership thereof (both as to working interest and royalty).
3. If more than one lease of different ownership is dedicated to the well, have the interests of all owners been consolidated by communitization, unitization, force-pooling, etc?

☐ Yes ☐ No If answer is "yes," type of consolidation _____
If answer is "no," list the owners and tract descriptions which have actually been consolidated. (Use reverse side of this form if necessary.) _____

No allowable will be assigned to the well until all interests have been consolidated (by communitization, unitization, force-pooling, or otherwise) or until a non-standard unit, eliminating such interests, has been approved by the Division.

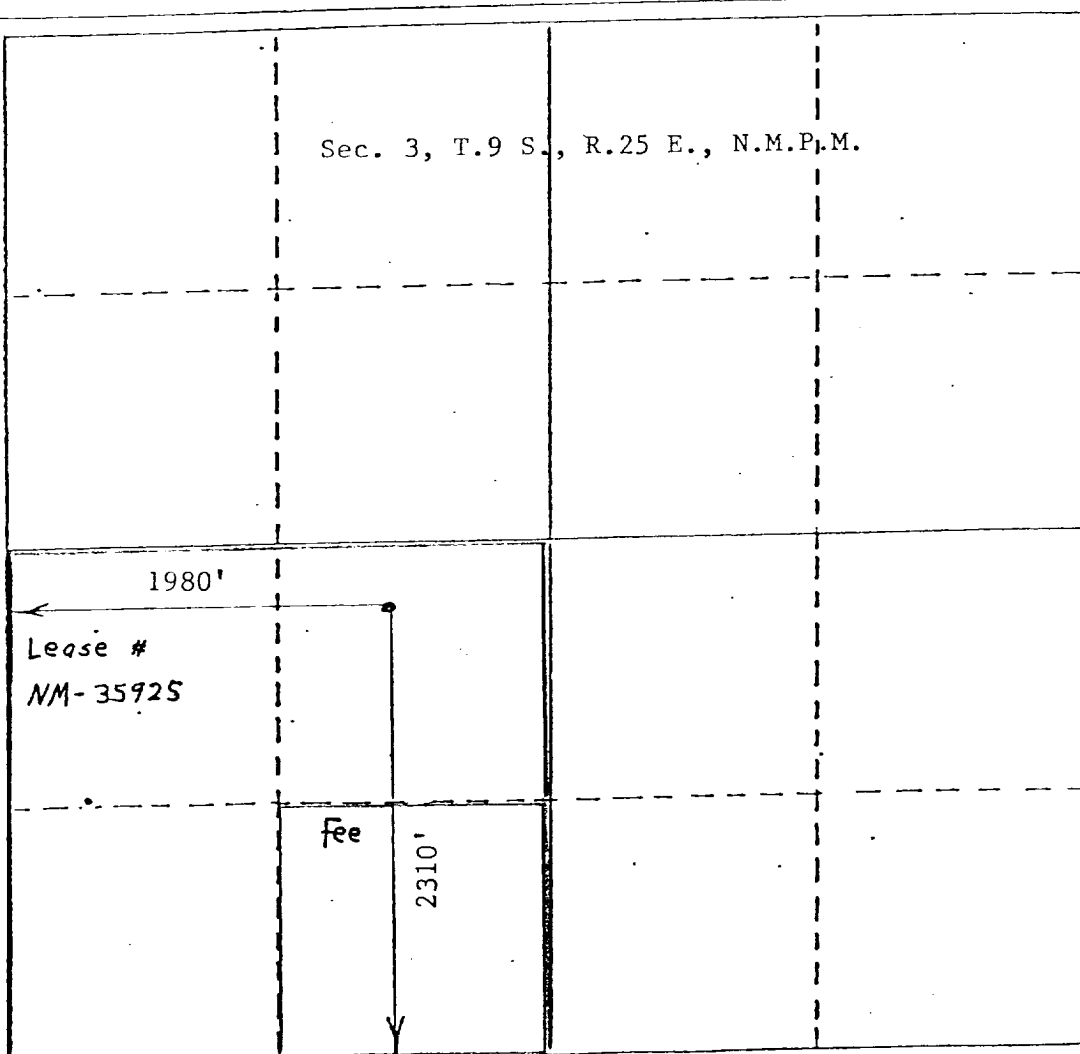

CERTIFICATION

I hereby certify that the information contained herein is true and complete to the best of my knowledge and belief.

Mark McClellan

Name

Mark McClellan

Position

Geologist

Company

McClellan Oil Corporation

Date

7-28-82

I hereby certify that the well location shown on this plat was plotted from field notes of actual surveys made by me or under my supervision, and that the same is true and correct to the best of my knowledge and belief.

Date Surveyed

Registered Professional Engineer and Land Surveyor

JOHN D. JAQUESS
NEW MEXICO
JULY 28, 1982
6290
JOHN D. JAQUESS, P.E. & L.S.
Certificate No. 6290