

FEB 02 1984

O. C. D.

PLUG BACK

30-005-61827

LEASE DESIGNATION AND SERIAL NO.

NM-36409

IF INDIAN, ALLOTTEE OR TRIBE NAME

7. UNIT AGREEMENT NAME

8. FARM OR LEASE NAME

McClellan Fed. ~~ME~~

9. WELL NO.

4

10. FIELD AND POOL, OR WILDCAT

X Pecos Slope Abo

11. SEC., T., R., M., OR BLK.
AND SURVEY OR AREA

Sec. 29-T5S-R25E

12. COUNTY OR PARISH

Chaves

NM

1a. TYPE OF WORK

DRILL ☒DEEPEN ☐PLUG BACK ☐

b. TYPE OF WELL

OIL
WELL ☐GAS
WELL ☒

OTHER

SINGLE
ZONE ☒MULTIPLE
ZONE ☐

2. NAME OF OPERATOR

McClellan Oil Corporation

3. ADDRESS OF OPERATOR

P. O. Drawer 730, Roswell, NM 88202

4. LOCATION OF WELL (Report location clearly and in accordance with any State requirements.)

At surface

990 FSL & 1650 FEL

At proposed prod. zone

14. DISTANCE IN MILES AND DIRECTION FROM NEAREST TOWN OR POST OFFICE*

25 miles north and 13 miles east of Roswell, New Mexico

15. DISTANCE FROM PROPOSED*

LOCATION TO NEAREST

PROPERTY OR LEASE LINE, FT.

(Also to nearest drlg. unit line, if any)

990'

16. NO. OF ACRES IN LEASE

2441.49

17. NO. OF ACRES ASSIGNED
TO THIS WELL

160

18. DISTANCE FROM PROPOSED LOCATION*
TO NEAREST WELL, DRILLING, COMPLETED,
OR APPLIED FOR, ON THIS LEASE, FT.

1682'

19. PROPOSED DEPTH

4100'

20. ROTARY OR CABLE TOOLS

Rotary

21. ELEVATIONS (Show whether DF, RT, GR, etc.)

3783' G.L.

22. APPROX. DATE WORK WILL START*

February 15, 1984

23.

PROPOSED CASING AND CEMENTING PROGRAM

SIZE OF HOLE	SIZE OF CASING	WEIGHT PER FOOT	SETTING DEPTH	QUANTITY OF CEMENT
17-1/2"	13-3/8"	48	40'	6 yards
12-1/4"	8-5/8"	23	1000' 900 ⁹⁵⁰	250 sx (circulated)
7-7/8"	4-1/2"	10.5	4100'	350 sx

Propose to drill and test the Abo formation. Approximately 1000' of surface casing will be set and cement circulated. If production is indicated, will run production casing and attempt completion.

Formation Tops: San Andres - 590', Glorieta - 1356', Tubb - 2884', Abo - 3637'

Mud Program: Fresh water to top of Abo. Will mud up 100' above Abo with 15cc water loss, 9.5 lb/gal mud wt. and 40 viscosity mud.

Gas not dedicated.

IN ABOVE SPACE DESCRIBE PROPOSED PROGRAM: If proposal is to deepen or plug back, give data on present productive zone and proposed new productive zone. If proposal is to drill or deepen directionally, give pertinent data on subsurface locations and measured and true vertical depths. Give blowout preventer program, if any.

24.

SIGNED

Paul Ragsdale

TITLE Operations Manager

DATE January 12, 1984

(This space for Federal or State office use)

PERMIT NO.

APPROVAL DATE

District Manager

FEB 01 1984

APPROVED BY 'Orig. Sgd.' Earl R. Cunningham

TITLE

DATE

CONDITIONS OF APPROVAL, IF ANY:

*See Instructions On Reverse Side

APPROVAL SUBJECT TO
GENERAL REQUIREMENTS AND
SPECIAL STIPULATIONS
ATTACHED

All distances must be from the outer boundaries of the Section.

Operator McClellan Oil Corp.		Lease MOC Federal		Well No. #4
Unit Letter 0	Section 29	Township 5 South	Range 2 5 East	County Chaves
Actual Footage Location of Well: 990 feet from the South line and 1650 feet from the East line				
Ground Level Elev. 3783	Producing Formation Abo	Pool Pecos Slope	Dedicated Acreage 160 Acres	

1. Outline the acreage dedicated to the subject well by colored pencil or hachure marks on the plat below.
2. If more than one lease is dedicated to the well, outline each and identify the ownership thereof (both as to working interest and royalty).
3. If more than one lease of different ownership is dedicated to the well, have the interests of all owners been consolidated by communitization, unitization, force-pooling, etc?

☐ Yes ☐ No If answer is "yes," type of consolidation _____

If answer is "no," list the owners and tract descriptions which have actually been consolidated. (Use reverse side of this form if necessary.) _____

No allowable will be assigned to the well until all interests have been consolidated (by communitization, unitization, forced-pooling, or otherwise) or until a non-standard unit, eliminating such interests, has been approved by the Division

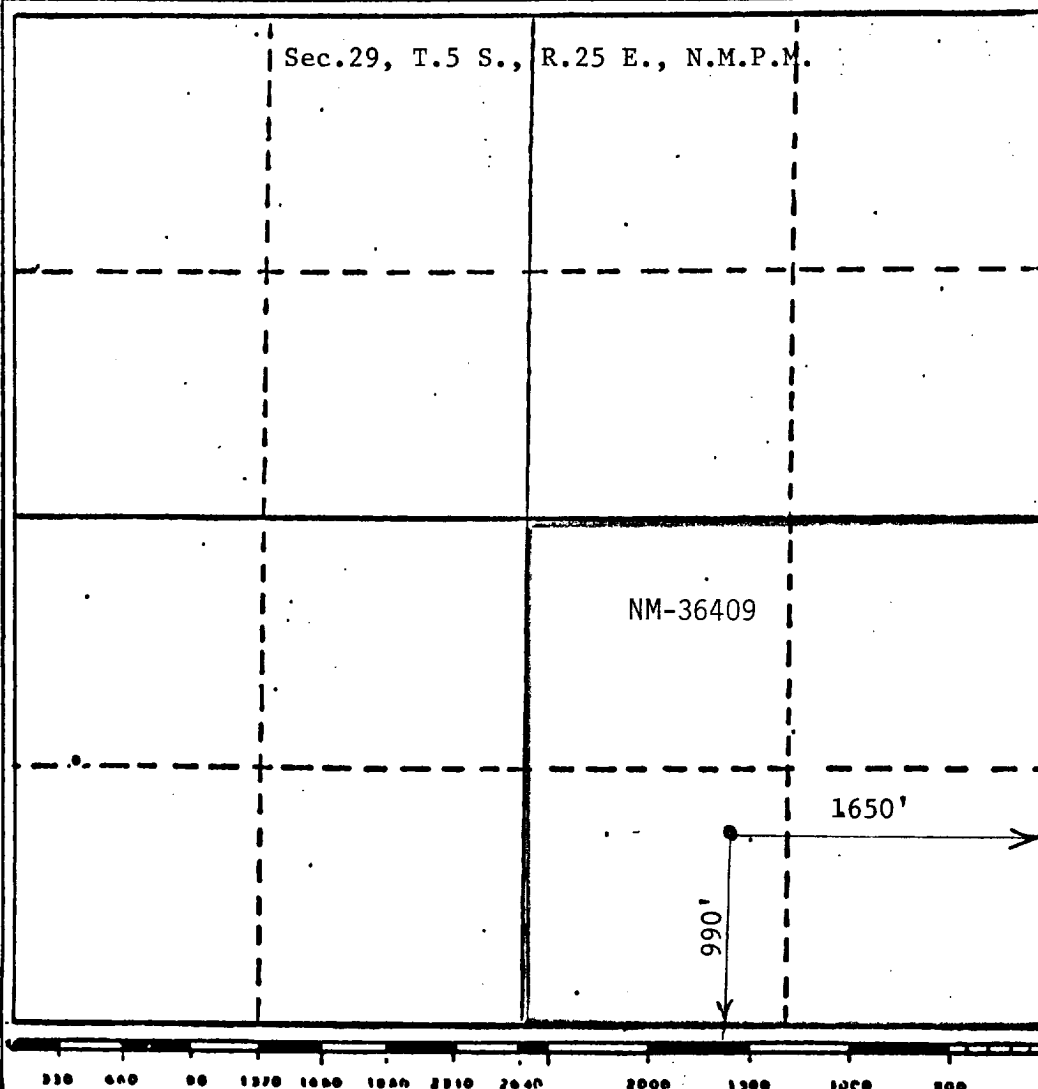

CERTIFICATION

I hereby certify that the information contained herein is true and complete to the best of my knowledge and belief.

Paul Ragsdale
Name

Paul Ragsdale

Position

Operations Manager

Company

McClellan Oil Corporation

Date

January 12, 1984

I hereby certify that the well location shown on this plat was plotted from field notes of actual surveys made by me or under my supervision, and that the same is true and correct to the best of my knowledge and belief.

Date Signed

January 12, 1984

Registered Professional Engineer and/or Land Surveyor

John D. Jacques
John D. Jacques, E. & L.S.

Certificate No. 6290

BLOWOUT PREVENTER SPECIFICATION

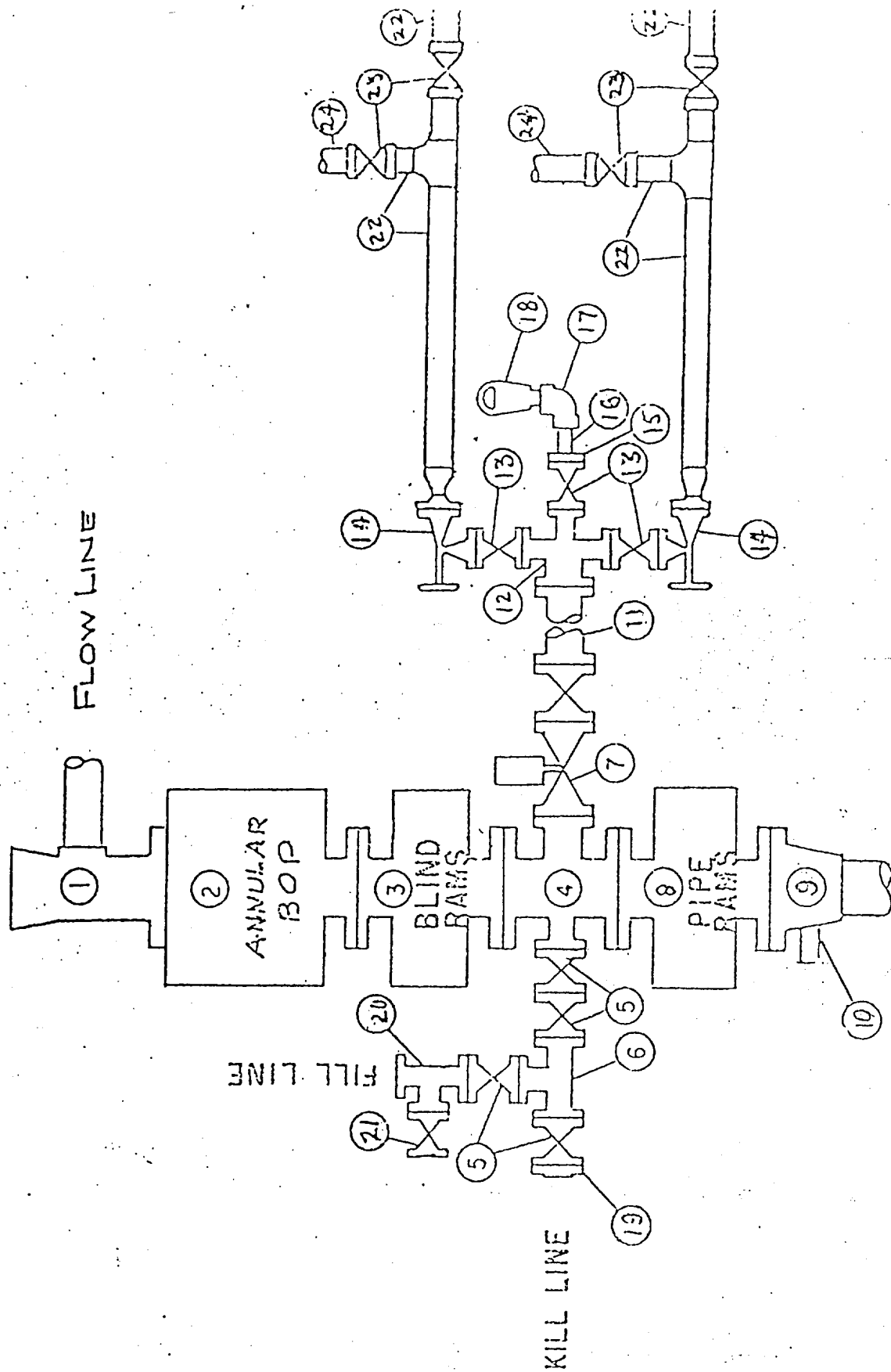

1. Location: 990 FSL & 1650 FEL, Section 29-T5S-R25E
2. Elevation: 3783' G.L.
3. Geologic name of surface formation: See archaeological report
4. Type of drilling rig and associated equipment: Rotary Rig
5. Proposed drilling depth and objective formation: 4100', Abo
6. Estimated tops of geologic markers:

Yates _____	San Andres <u>590'</u>	Abo <u>3637'</u>
7-Rivers _____	Glorieta <u>1356'</u>	Wolfcamp _____
Queen _____	Tubb <u>2884'</u>	_____
7. Estimated depths of any oil, water, or gas: 3637'-4100', Possible gas
- 8-9. Proposed casing program:
 - * 13-3/8" @ 40' Grade H-40 Wt. 48 Type Cement 6 yards
 - 8-5/8" @ 1000' Grade J-55 Wt. 23 Type Cement Class "C"
 - 4-1/2" @ 4100' Grade J-55 Wt. 10.5 Type Cement Class "C"
10. Specifications for pressure control equipment and testing procedures:
Schaeffer Modle 39 (4500 psi test) See Exhibit "E"
11. Type and characteristics of drilling fluids: Fresh water to top of Abo. Mud up 100' above Abo with 15cc water loss, 40 visc. and 9.5 lb/gal mud.
12. Testing, logging, and coring programs: No testing or coring is anticipated.
Will run Compensated Neutron - Formation Density and Dual Laterolog gamma ray logs.
13. Anticipated abnormal pressures or temperature: None
14. Anticipated commencement and completion date: February 15, 1984 to March 1, 1984
15. Other pertinent information: _____

* If necessary, due to lost circulation.

McCLELLAN OIL CORPORATION
SUGGESTED PAD DIMENSIONS

Reserve Pits 4 ft. deep, plastic lined

Working pits 5 ft. deep

No cellar

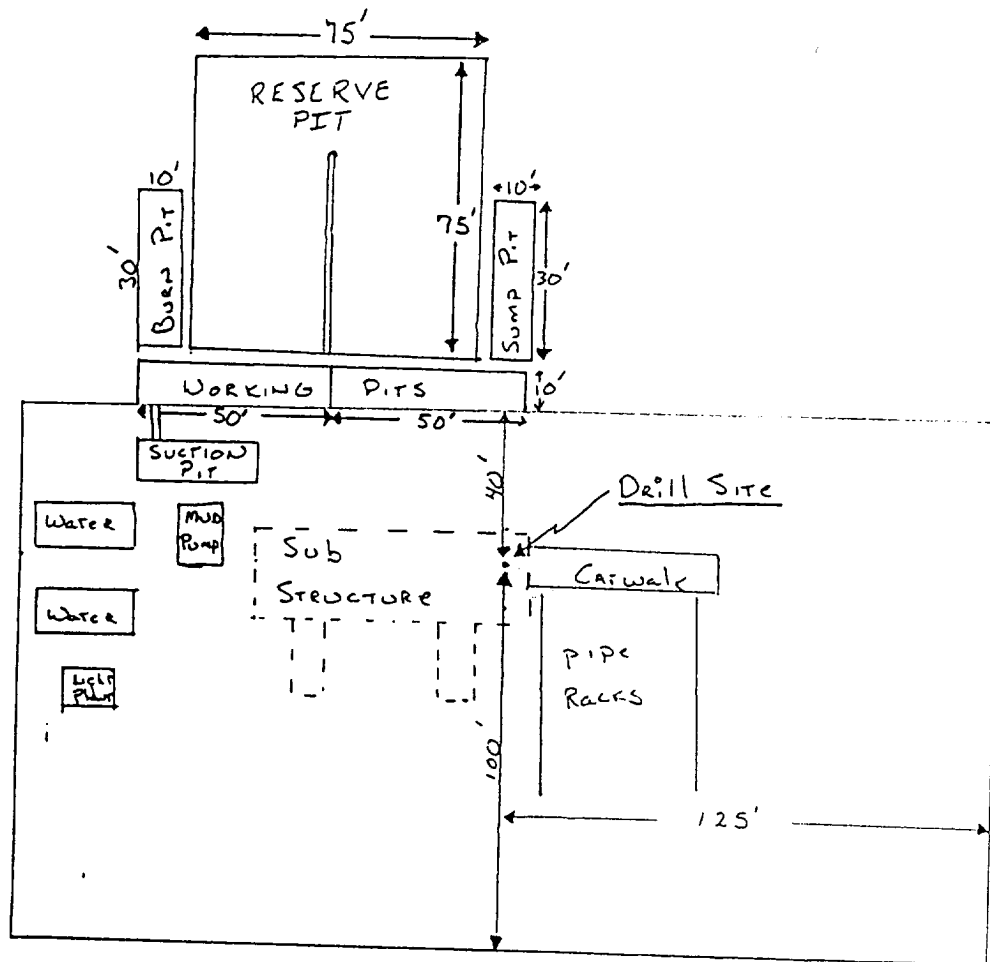

Scale 1" = 50'