

30-005-61936

STATE OF NEW MEXICO
ENERGY AND MINERALS DEPARTMENT

OIL CONSERVATION DIVISION

RECEIVED

P. O. BOX 2009

SANTA FE, NEW MEXICO 87501

NOV 12 1982

O. C. D.
ARTESIA, OFFICEForm C-101
Revised 10-1-78

NO. OF COPIES RECEIVED	
DISTRIBUTION	
SANTA FE	
FILE	
U.S.G.S.	
LAND OFFICE	
OPERATOR	

5A. Indicate Type of Lease
STATE <input type="checkbox"/> FCC <input checked="" type="checkbox"/>
5. State Oil & Gas Lease No.
7. Unit Agreement Name
8. Form or Lease Name
M.E.C. Com.
9. Well No.
#1
10. Field and Pool, or Wildcat
UNDESIGNATED ABO
17. County
Chaves

APPLICATION FOR PERMIT TO DRILL, DEEPEN, OR PLUG BACK

1a. Type of Work

b. Type of Well

OIL WELL ☐ GAS WELL ☒ OTHER ☐ SINGLE ZONE ☒ MULTIPLE ZONE ☐

2. Name of Operator

Mesa Petroleum Co. ✓

3. Address of Operator

P.O. Box 2009 - Amarillo, Texas 79189

4. Location of Well

UNIT LETTER M LOCATED 660 FEET FROM THE South LINE

AND 660 FEET FROM THE West LINE OF SEC. 6 TWP. 7S. RGE. 23E. RANGE

11. Elevation (show whether Dr., Ft., etc.)

4058'

12. Kind of Status Plug Bond

BLANKET

13. Proposed Depth

3200'

14. Formation

ABO

15. History of C.T.

ROTARY

21b. Drilling Contractor

Tom Brown

22. Approx. Date Work will start

15, Nov. 82

PROPOSED CASING AND CEMENT PROGRAM

SIZE OF HOLE	SIZE OF CASING	WEIGHT PER FOOT	SETTING DEPTH	SACKS OF CEMENT	EST. TOP
12 1/4"	8 5/8"	24#	1400	700/300	Surface
7 7/8"	4 1/2"	10.5#	3200	300	Cover ABO

Propose to drill 12 1/4" hole to approximately 1400' to set 8 5/8" surface casing and cement to surface. Will nipple up ram type BOP's and reduce hole to 7 7/8" to drill to total depth. Drilling medium will be air, foam, or mud as required. After log evaluation, 4 1/2" casing may be run and cemented with sufficient kinds and amounts to isolate and seal off any fresh water, oil or gas zones encountered.

Operator's Gas sales are dedicated.

APPROVAL VALID FOR 180 DAYS
PERMIT EXPIRES 5-12-83
UNLESS DRILLING UNDERWAY

ABOVE SPACE DESCRIBE PROPOSED PROGRAM; IF PROPOSAL IS TO DEEPEN OR PLUG BACK, GIVE DATA ON PRESENT PRODUCTIVE ZONE AND PROPOSED NEW PRODUCTION ZONE. GIVE BLOWOUT PREVENTER PROGRAM, IF ANY.

I hereby certify that the information above is true and complete to the best of my knowledge and belief.

Signed [Signature] Title Regulatory Agent Date 11 Nov. 82

(This space for State Use)

APPROVED BY [Signature] TITLE OIL AND GAS INSPECTOR DATE NOV 12 1982

CONDITIONS OF APPROVAL, IF ANY:

Notify N.M.O.C.C. in sufficient
time to witness cementing

The CSIR

All distances must be from the outer boundaries of the Section.

NOV 12 1982

Operator Mesa Petroleum Co.			Lease M.E.C. Com.			O. C. D.			Well No. #1						
Unit Letter M	Section 6	Township 7 South	Range 23 East	County ARTESIA, OFFICE Chaves											
Actual Postage Location of Well:															
660		feet from the		South		line and		660		feet from the		West		line	
Ground Level Elev. 4058		Producing Formation ABO				Pool UNDESIGNATED ABO				Dedicated Acreage: SW 1/4 160 Acres					

1. Outline the acreage dedicated to the subject well by colored pencil or hatchure marks on the plat below.
2. If more than one lease is dedicated to the well, outline each and identify the ownership thereof (both as to working interest and royalty).
3. If more than one lease of different ownership is dedicated to the well, have the interests of all owners been consolidated by communitization, unitization, force-pooling, etc?

☐ Yes ☐ No If answer is "yes," type of consolidation Communitization in progress

If answer is "no," list the owners and tract descriptions which have actually been consolidated. (Use reverse side of this form if necessary.)

No allowable will be assigned to the well until all interests have been consolidated (by communitization, unitization, forced-pooling, or otherwise) or until a non-standard unit, eliminating such interests, has been approved by the Division.

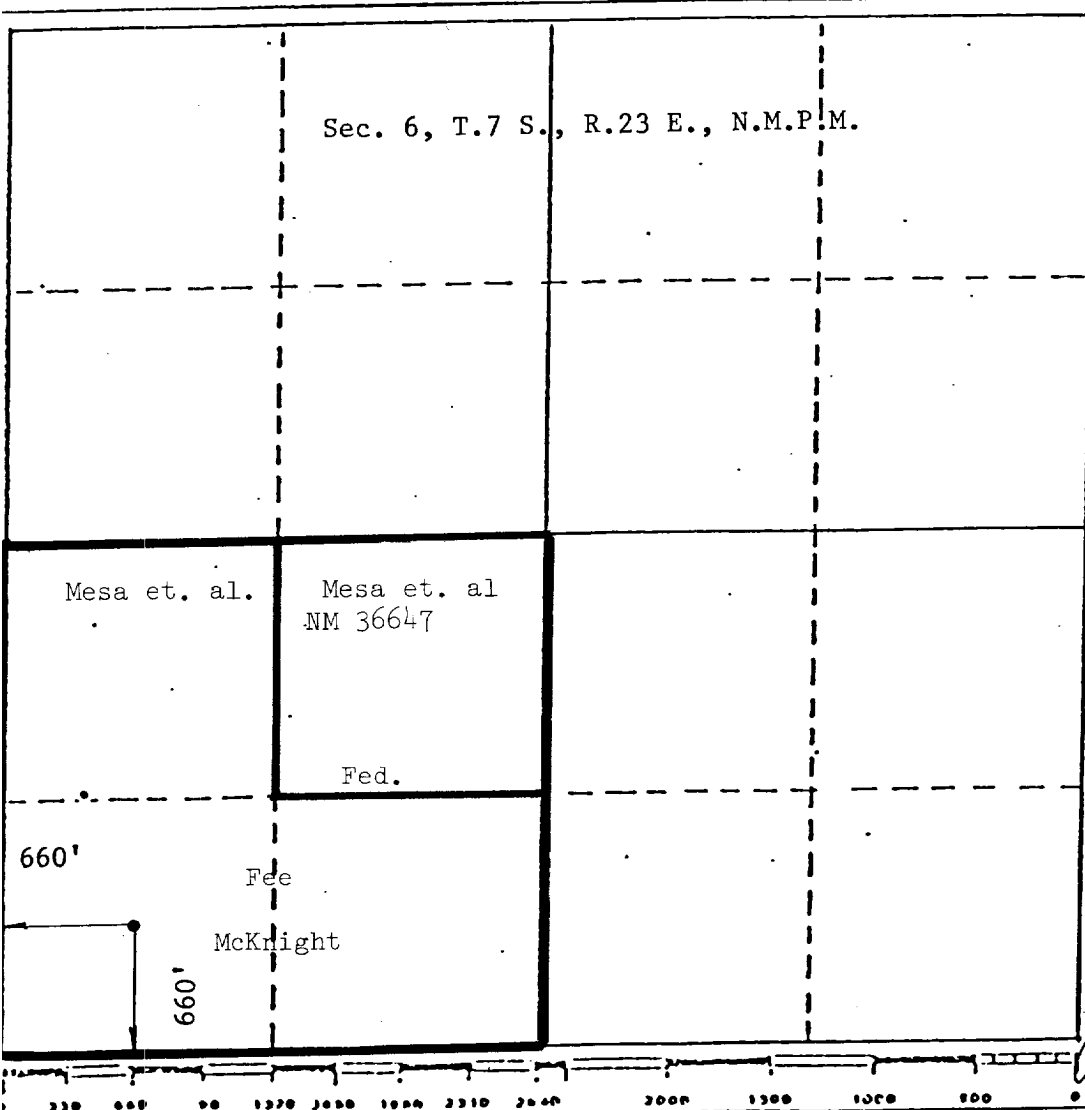

CERTIFICATION

I hereby certify that the information contained herein is true and complete to the best of my knowledge and belief.

Name

Lloyd Reed

Position

Regulatory Agent

Company

Mesa Petroleum Co.

Date

11 Nov. 82

I hereby certify that the well location shown on this plat was plotted from field notes of actual surveys made by me or under my supervision, and that the same is true and correct to the best of my knowledge and belief.

Date Surveyed

November 10, 1982

Registered Professional Engineer and/or Land Surveyor

John D. Jaquess, P.E. & L.S.
Certificate No. 6290