

488

GEOLOGICAL SURVEY

APPLICATION FOR PERMIT TO DRILL, DEEPEN, OR PLUG BACK

1a. TYPE OF WORK DRILL [X] DEEPEN [] PLUG BACK []

b. TYPE OF WELL OIL WELL [] GAS WELL [X] OTHER [] SINGLE ZONE [X] MULTIPLE ZONE []

2. NAME OF OPERATOR McClellan Oil Corporation

3. ADDRESS OF OPERATOR P.O. Drawer 730, Roswell, New Mexico

4. LOCATION OF WELL (Report location clearly and in accordance with State requirements.) At surface 660' FSL & 660' FEL At proposed prod. zone

14. DISTANCE IN MILES AND DIRECTION FROM NEAREST TOWN OR POST OFFICE* 8 miles northeast of Roswell, New Mexico

15. DISTANCE FROM PROPOSED* LOCATION TO NEAREST PROPERTY OR LEASE LINE, FT. (Also to nearest drlg. unit line, if any) 660'

18. DISTANCE FROM PROPOSED LOCATION* TO NEAREST WELL, DRILLING, COMPLETED, OR APPLIED FOR, ON THIS LEASE, FT. 6610'

21. ELEVATIONS (Show whether DF, RT, GR, etc.) 3690 G.L.

23. PROPOSED CASING AND CEMENTING PROGRAM

Table with 5 columns: SIZE OF HOLE, SIZE OF CASING, WEIGHT PER FOOT, SETTING DEPTH, QUANTITY OF CEMENT. Rows include 12-1/4" hole with 8-5/8" casing and 7-7/8" hole with 4-1/2" casing.

Propose to drill to approximately 4550' to test the Abo formation. If production is indicated, will set casing and attempt completion.

Estimated Geologic Tops: San Andres: 680' Glorieta: 1780' Tubb: 3665' Abo: 4010'

Mud Program: Will drill to top of Abo with native mud. Will mud-up with salt gel, 40 Visc. 20cc water loss and 9.8 lb/gal mud.

Gas is not dedicated.

IN ABOVE SPACE DESCRIBE PROPOSED PROGRAM: If proposal is to deepen or plug back, give data on present productive zone and proposed new productive zone. If proposal is to drill or deepen directionally, give pertinent data on subsurface locations and measured and true vertical depths. Give blowout preventer program, if any.

24. SIGNED Mark McClellan TITLE Geologist DATE Nov. 2, 1982

(This space for Federal or State office use)

PERMIT NO. APPROVED BY (ORIG. SGD.) DAVID R. GLASS TITLE DATE

APPROVED (ORIG. SGD.) DAVID R. GLASS TITLE NOV 12 1982 JAMES A. GILLHAM DISTRICT SUPERVISOR

RECEIVED NOV 3 1982

5. LEASE DESIGNATION AND SERIAL NO. NM-13978 6. IF INDIAN, ALLOTTEE OR TRIBE NAME 7. UNIT AGREEMENT NAME 8. FARM OR LEASE NAME Leeman Federal 9. WELL NO. 2 10. FIELD AND POOL, OR WILDCAT Undesignated Abo 11. SEC., T., R., M., OR BLK. AND SURVEY OR AREA Sec. 12-T9S-R25E 12. COUNTY OR PARISH Chaves 13. STATE N.M. 20. ROTARY OR CABLE TOOLS Rotary 22. APPROX. DATE WORK WILL START* Nov. 30, 1982

Handwritten notes and signatures at bottom right.

All distances must be from the outer boundaries of the well.

Operator McClellan Oil Corp.		Lease Leeman Federal			Well No. #2
Unit Letter P	Section 12	Township 9 South	Range 25 East	County Chaves	
Actual Postage Location of Well: 660 feet from the South line and 660 feet from the East line					
Ground Level Elev. 3690	Producing Formation Abo		Pool Undesignated Abo		Dedicated Acres 160 Acres

1. Outline the acreage dedicated to the subject well by colored pencil or hachure marks on the plat below.
2. If more than one lease is dedicated to the well, outline each and identify the ownership thereof (both as to working interest and royalty).
3. If more than one lease of different ownership is dedicated to the well, have the interests of all owners been consolidated by communitization, unitization, force-pooling, etc?

Yes No If answer is "yes;" type of consolidation _____

If answer is "no;" list the owners and tract descriptions which have actually been consolidated. (Use reverse side of this form if necessary.) _____

No allowable will be assigned to the well until all interests have been consolidated (by communitization, unitization, forced-pooling, or otherwise) or until a non-standard unit, eliminating such interests, has been approved by the Division.

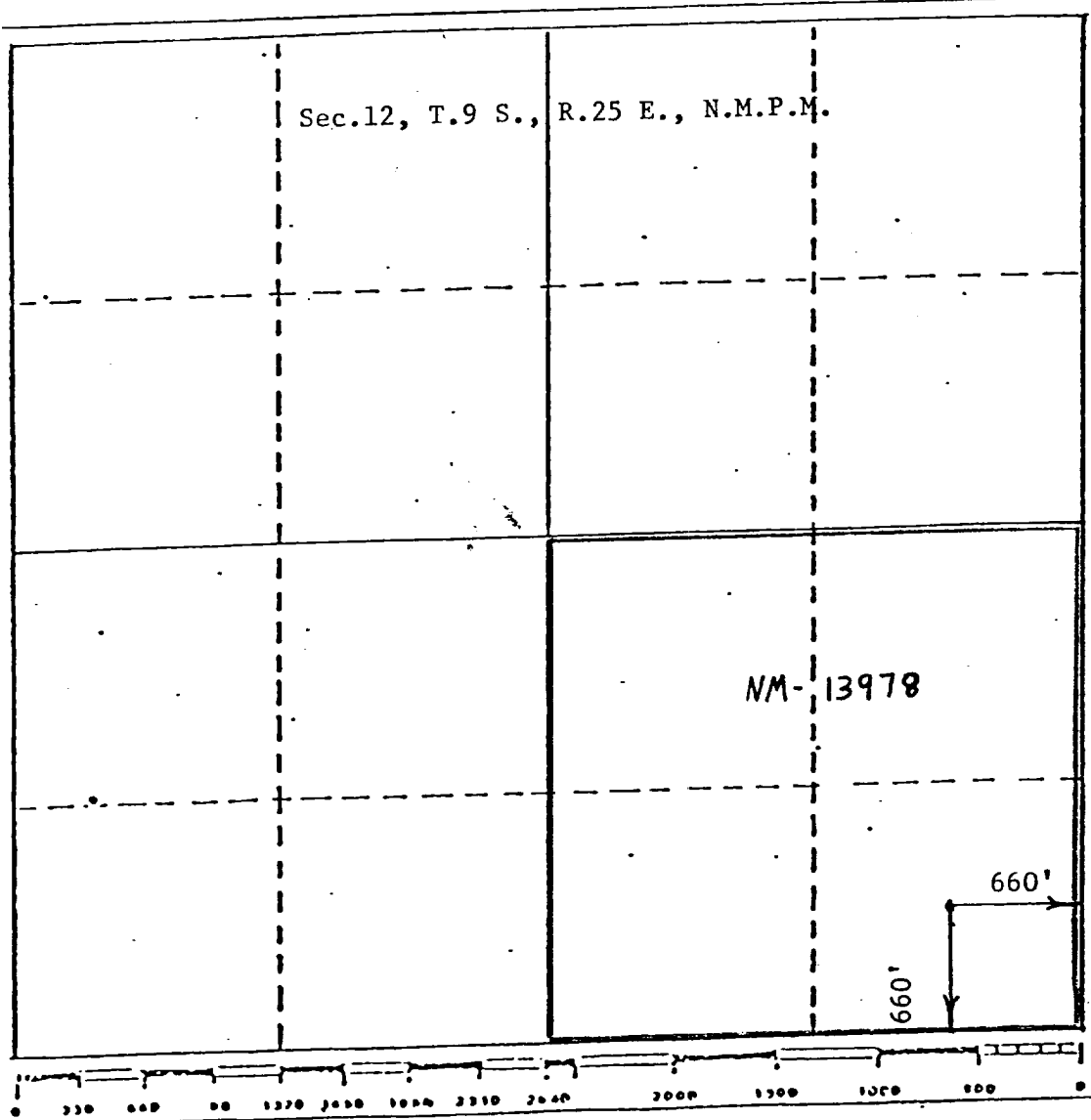

CERTIFICATION

I hereby certify that the information contained herein is true and complete to the best of my knowledge and belief.

Mark McClellan
Name
Mark McClellan
Position
Geologist
Company
McClellan Oil Corp.
Date
October 25, 1982

I hereby certify that the well location shown on this plat was plotted from field notes of actual surveys made by me or under my supervision, and that the same is true and correct to the best of my knowledge and belief.

Date Surveyed
October 25, 1982
Registered Professional Engineer and/or Land Surveyor
John D. Jaquess
John D. Jaquess, P.E. & L.S.
Certificate No.
6290

Leeman Federal No. 2
REQUIREMENTS
(NTL-6)

1. Location: Sec. 12-T9S-R25E 660' FSL & 660' FEL
2. Elevation: 3690' G.L.
3. Geologic name of surface formation: See archaeological report
4. Type of drilling rig and associated equipment: Rotary rig
5. Proposed drilling depth and objective formation: 4550' Abo
6. Estimated tops of geologic markers:

Yates _____	San Andres <u>680'</u>	Abo <u>4010'</u>
7-Rivers _____	Glorieta <u>1780'</u>	Wolfcamp _____
Queen _____	Tubb <u>3665'</u>	_____
7. Estimated depths of any oil, water, or gas: 4010 - 4550'; possible gas
- 8-9. Proposed casing program:

<u>8-5/8" @ 900'</u>	Grade <u>J-55</u>	Wt. <u>23</u>	Type Cement <u>Class "C"</u>
<u>4-1/2" @ 4550'</u>	Grade <u>J-55</u>	Wt. <u>10.5</u>	Type Cement <u>50-50 Poz-C</u>
<u> " @ _____'</u>	Grade _____	Wt. _____	Type Cement _____
10. Specifications for pressure control equipment and testing procedures: Schaeffer type E 10" series 900 hydraulic BOP
11. Type and characteristics of drilling fluids: Native mud to top of Abo.
Mud up with salt base gel; 15 cc water loss, 35 visc., 9.5 lb/gal mud.
12. Testing, logging, and coring programs: No testing or coring is anticipated.
Will run Compensated Neutron - Formation Density and Dual Laterolog gamma ray logs.
13. Anticipated abnormal pressures or temperature: None anticipated
14. Anticipated commencement and completion date: Nov. 30, 1982 - Dec. 10, 1982
15. Other pertinent information: _____

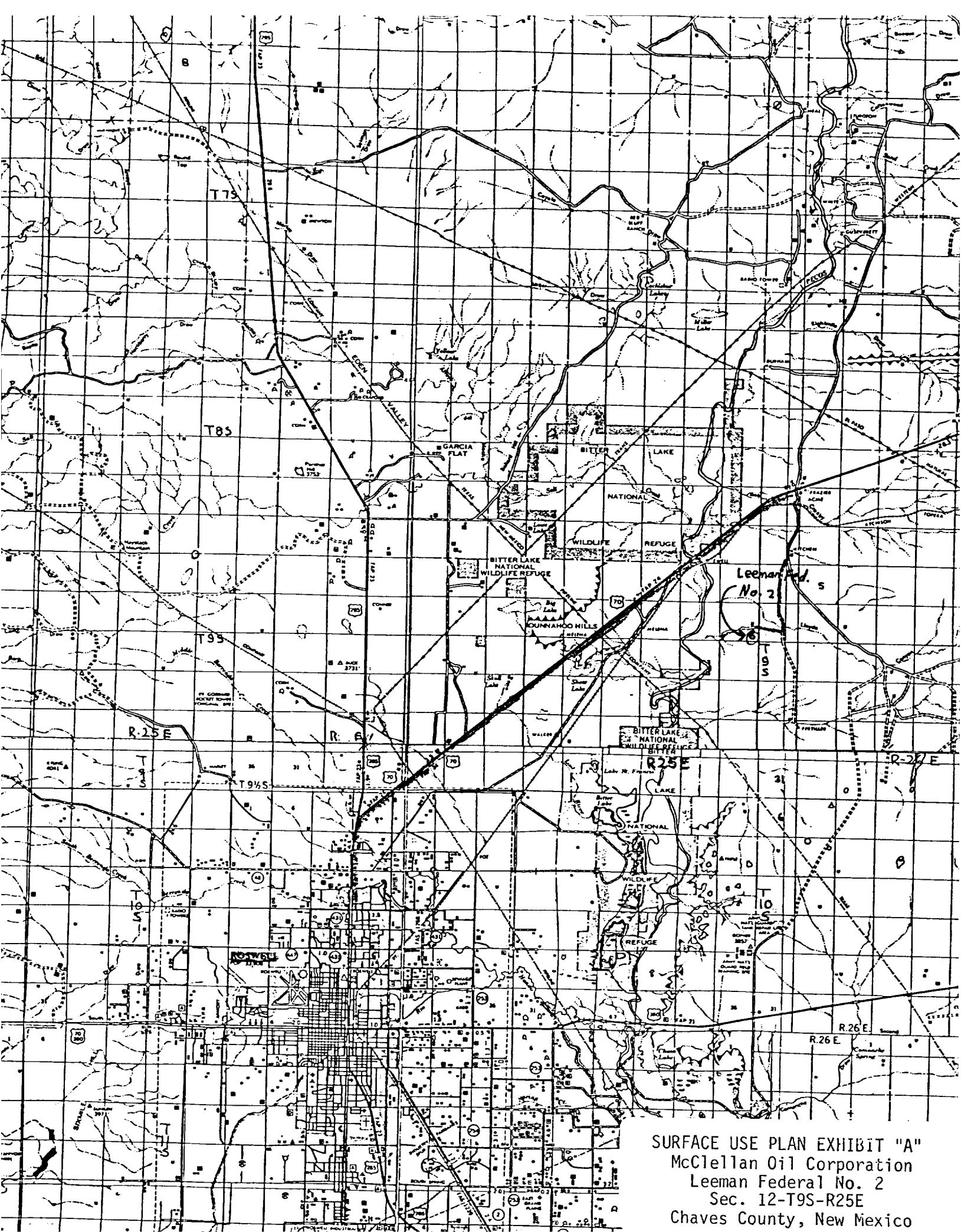

SURFACE USE PLAN EXHIBIT "A"
McClellan Oil Corporation
Leeman Federal No. 2
Sec. 12-T9S-R25E
Chaves County, New Mexico

McCLELLAN OIL CORPORATION
SUGGESTED PAD DIMENSIONS

Reserve Pits 4 ft. deep, plastic lined

Working pits 5 ft. deep

No cellar

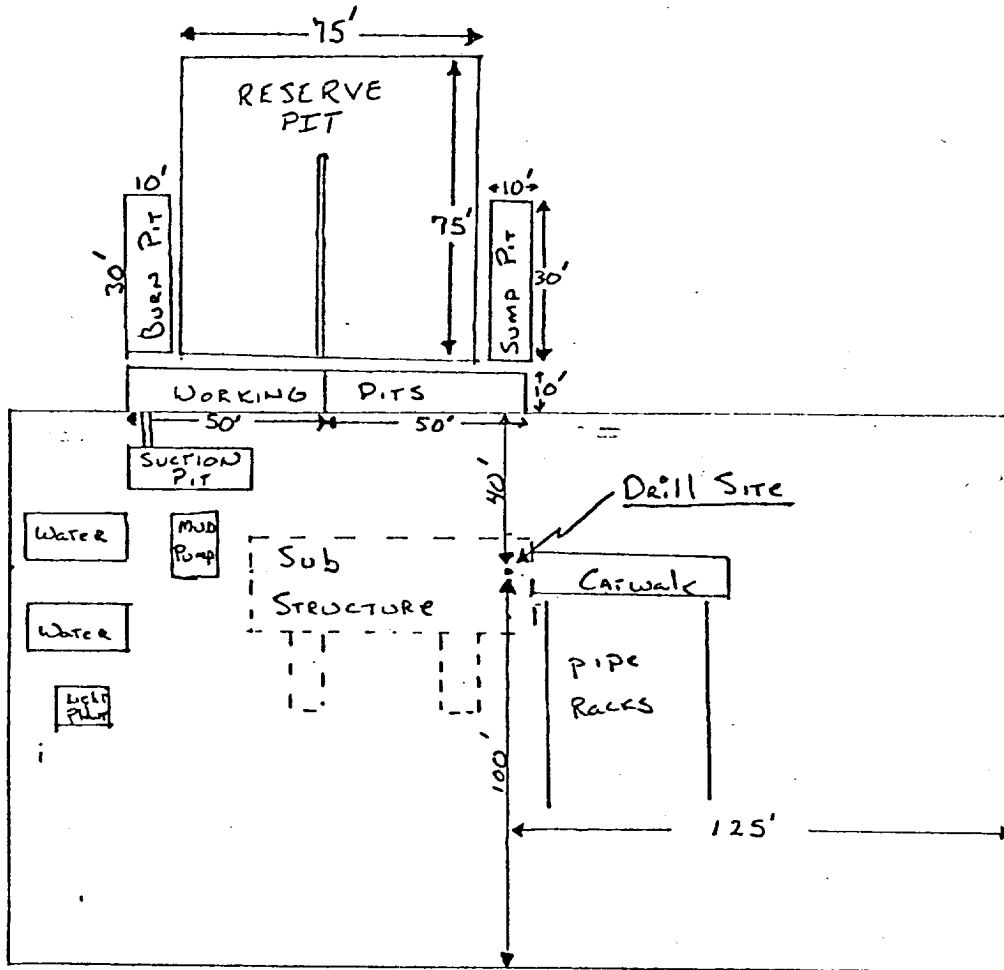

Scale 1" = 50'

BLOWOUT PREVENTER SPECIFICATION

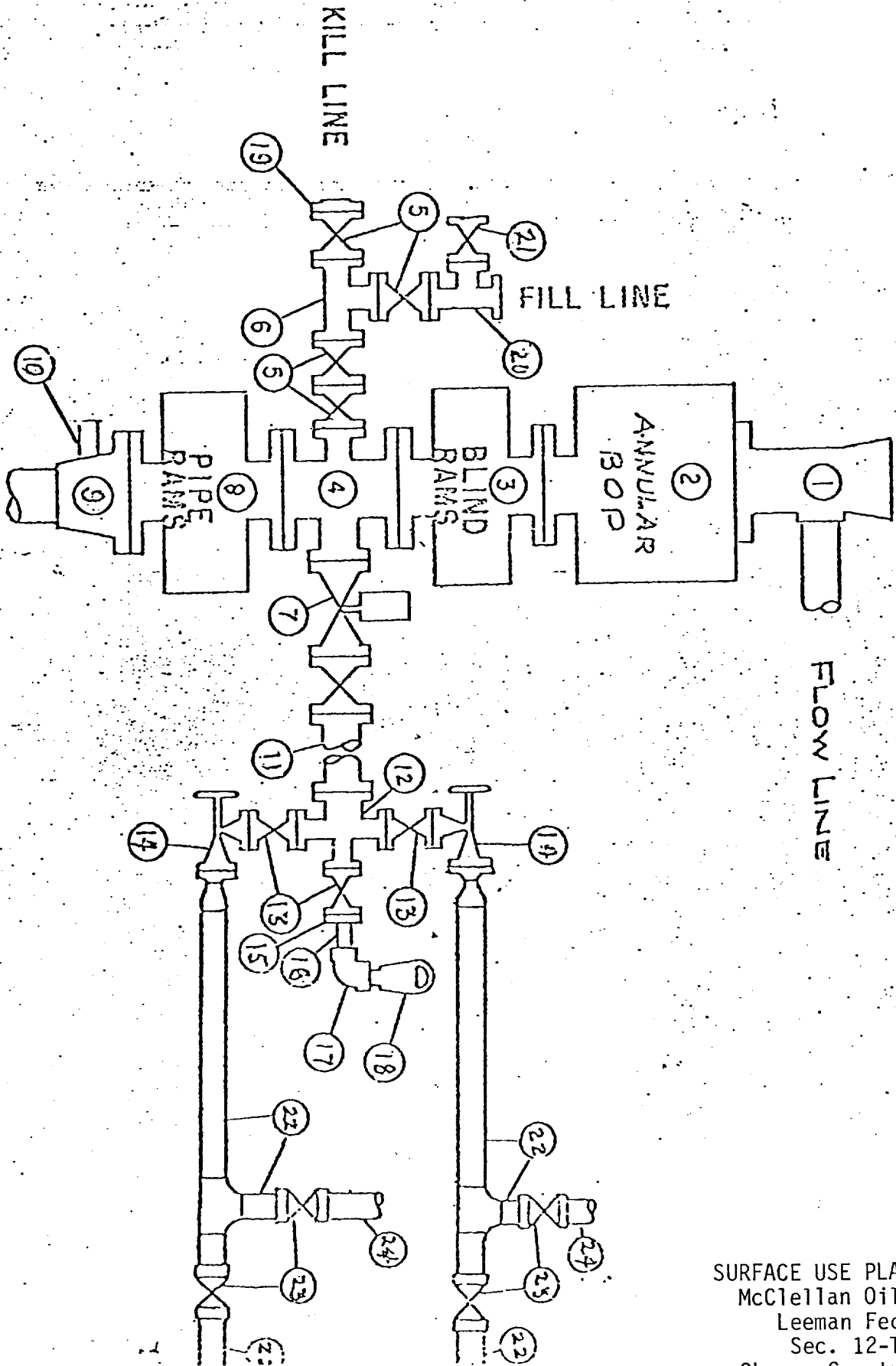

SURFACE USE PLAN EXHIBIT "E"
 McClellan Oil Corporation
 Leeman Federal No. 2
 Sec. 12-T9S-R25E
 Chaves County, New Mexico