

NO. OF COPIES RECEIVED	
DISTRIBUTION	
SANTA FE	<input checked="" type="checkbox"/>
FILE	<input checked="" type="checkbox"/>
U.S.G.S.	<input checked="" type="checkbox"/>
LAND OFFICE	<input checked="" type="checkbox"/>
OPERATOR	<input checked="" type="checkbox"/>

NOV 22 1982

O. C. D.

APPLICATION FOR PERMIT TO DRILL, DEEPEN, OR PLUG BACK

1a. Type of Work DRILL <input checked="" type="checkbox"/> DEEPEN <input type="checkbox"/> PLUG BACK <input type="checkbox"/>		7. Unit Agreement Name	
b. Type of Well OIL WELL <input type="checkbox"/> GAS WELL <input checked="" type="checkbox"/> OTHER <input type="checkbox"/>		8. Farm or Lease Name Martin et al	
2. Name of Operator Sanders Oil & Gas Company ✓		9. Well No. 1	
3. Address of Operator 14679 Midway Road, Suite 101, Dallas, Texas 75234		10. Field and Pool, or Wildcat Pecos Slope	
4. Location of Well UNIT LETTER <u>J</u> LOCATED <u>1980</u> FEET FROM THE <u>South</u> LINE AND <u>1980</u> FEET FROM THE <u>East</u> LINE OF SEC. <u>31</u> TWP. <u>8S</u> RGE. <u>26E</u> NMPM		12. County Chaves	
19. Proposed Depth 4750		19A. Formation Abo	
20. Rotary or C.T. Rotary		21. Elevations (show whether DF, RT, etc.) 3736 R.T.	
21A. Kind & Status Plug. Bond Blanket		21B. Drilling Contractor Young Drilling Co.	
22. Approx. Date Work will start Nov. 25, 1982			

23.

PROPOSED CASING AND CEMENT PROGRAM

SIZE OF HOLE	SIZE OF CASING	WEIGHT PER FOOT	SETTING DEPTH	SACKS OF CEMENT	EST. TOP
12 1/4	8 5/8	24	900	650	Surface
7 7/8	4 1/2	10.5	4700	600	3900

Propose to drill a 12 1/4" to approximately 900'. Set 8 5/8" casing and circulate cement to surface. Nipple up BOP. Reduce hole to 7 7/8" and drill to T.D. Drilling fluid will be fresh water and salt based gel as required.

Gas is not dedicated.

APPROVAL VALID FOR 180 DAYS
PERMIT EXPIRES 5/22/83
UNLESS DRILLING UNDERWAY

IN ABOVE SPACE DESCRIBE PROPOSED PROGRAM; IF PROPOSAL IS TO DEEPEN OR PLUG BACK, GIVE DATA ON PRESENT PRODUCTIVE ZONE AND PROPOSED NEW PRODUCTIVE ZONE. GIVE BLOWOUT PREVENTER PROGRAM, IF ANY.

I hereby certify that the information above is true and complete to the best of my knowledge and belief.

Signed William M. Battista Title Exploration Manager Date Nov. 15, 1982

(This space for State Use)

Original Signed By

Leslie A. Clements

Supervisor District II

SUPERVISOR, DISTRICT II

NOV 23 1982

APPROVED BY _____ TITLE _____ DATE _____

CONDITIONS OF APPROVAL, IF ANY:

N MEXICO OIL CONSERVATION COMMISS
WELL LOCATION AND ACREAGE DEDICATION PLAT

Form C-102
 Supersedes C-128
 Effective 1-1-65

All distances must be from the outer boundaries of the Section.

Operator Sanders Oil & Gas			Lease Martin et al		Well No. 1
Unit Letter J	Section 31	Township 8 South	Range 26 East	County Chaves	
Actual Footage Location of Well: 1980 feet from the South line and 1980 feet from the East line					
Ground Level Elev. 3724	Producing Formation ABO	Pool And. P. 12.5 Pecos Slope		Dedicated Acreage: 160 Acres	

1. Outline the acreage dedicated to the subject well by colored pencil or hachure marks on the plat below.
2. If more than one lease is dedicated to the well, outline each and identify the ownership thereof (both as to working interest and royalty).
3. If more than one lease of different ownership is dedicated to the well, have the interests of all owners been consolidated by communitization, unitization, force-pooling, etc?

☐ Yes ☐ No If answer is "yes," type of consolidation _____

If answer is "no," list the owners and tract descriptions which have actually been consolidated. (Use reverse side of this form if necessary.) _____

No allowable will be assigned to the well until all interests have been consolidated (by communitization, unitization, forced-pooling, or otherwise) or until a non-standard unit, eliminating such interests, has been approved by the Commission.

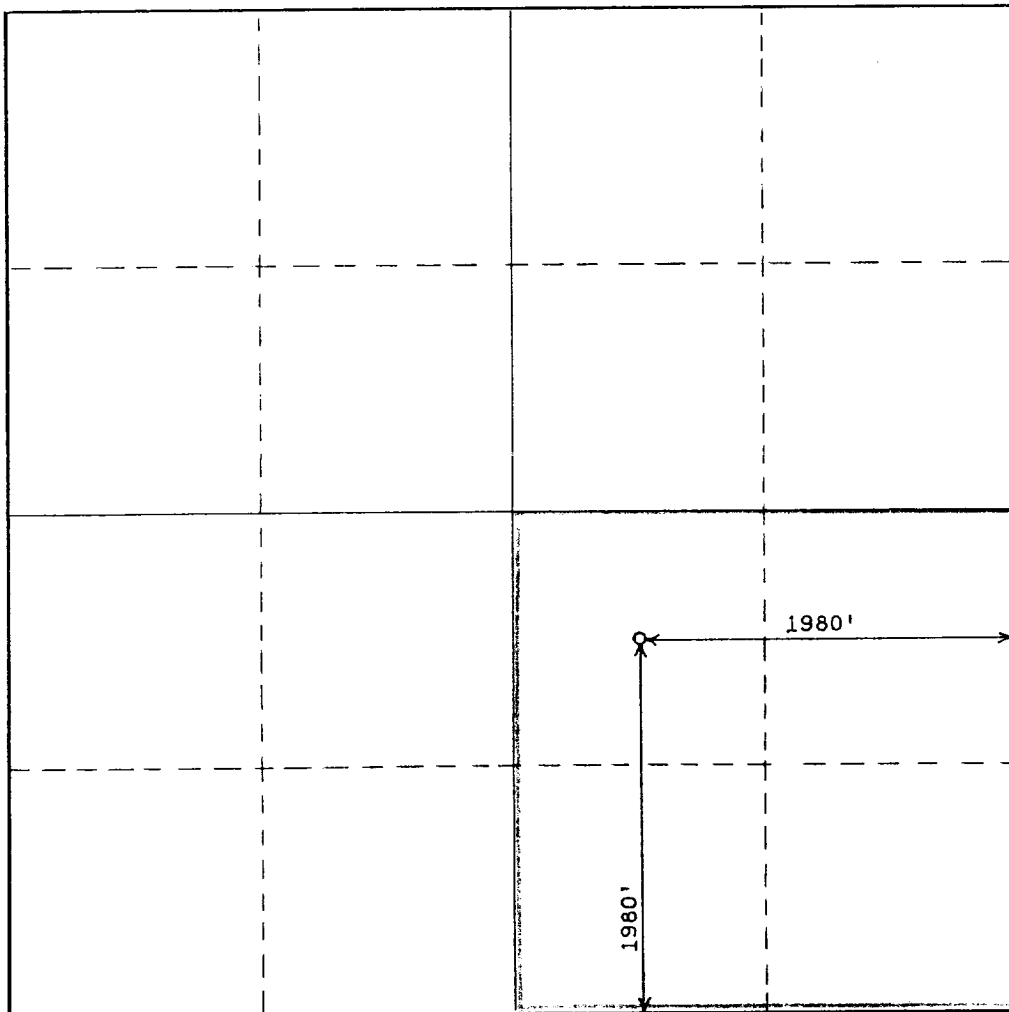

CERTIFICATION

I hereby certify that the information contained herein is true and complete to the best of my knowledge and belief.

Name
Kleon Whittaker
 Position
EXPLORATION MGR.
 Company
SANDERS OIL & GAS CO
 Date
NOV. 15-1982

I hereby certify that the well location shown on this plat was plotted from field notes of actual surveys made by me or under my supervision, and that the same is true and correct to the best of my knowledge and belief.

November 7, 1982

Date Surveyed
[Signature]
 Registered Professional Engineer
 and/or Land Surveyor
8112
 Certificate No.

