

UNITED STATES
DEPARTMENT OF THE INTERIOR
BUREAU OF LAND MANAGEMENT

NM 010101
SUBMIT IN TRIP
10th Edition
Drawers DD
Artesia, NM 88210

Form approved.
Budget Bureau No. 1004-0135
Expires August 31, 1985

SUNDRY NOTICES AND REPORTS ON WELLS

(Do not use this form for proposals to drill or to deepen or plug back to a different reservoir.
Use "APPLICATION FOR PERMIT—" for such proposals.)

RECEIVED

1. OIL WELL <input type="checkbox"/> GAS WELL <input checked="" type="checkbox"/> OTHER <input type="checkbox"/>		5. LEASE DESIGNATION AND SERIAL NO. NM-25473	
2. NAME OF OPERATOR Yates Petroleum Corporation		6. IF INDIAN, ALLOTTEE OR TRIBE NAME	
3. ADDRESS OF OPERATOR 105 South Fourth Street - Artesia, NM 88210		7. UNIT AGREEMENT NAME	
4. LOCATION OF WELL (Report location clearly and in accordance with any State requirements. See also space 17 below.) At surface 660' FNL and 1650' FEL		8. FARM OR LEASE NAME Savage NI Federal	
14. PERMIT NO.		9. WELL NO. 3	
15. ELEVATIONS (Show whether DF, RT, GR, etc.) 3694.2' GR		10. FIELD AND POOL, OR WILDCAT Pecos Slope Abo	
		11. SEC., T., E., M., OR BLK. AND SURVEY OR AREA Section 30-T6S-R26E	
		12. COUNTY OR PARISH Chaves	
		13. STATE NM	

18. Check Appropriate Box To Indicate Nature of Notice, Report, or Other Data

NOTICE OF INTENTION TO:

TEST WATER SHUT-OFF	<input type="checkbox"/>	PULL OR ALTER CASING	<input type="checkbox"/>
FRACTURE TREAT	<input type="checkbox"/>	MULTIPLE COMPLETE	<input type="checkbox"/>
SHOOT OR ACIDIZE	<input type="checkbox"/>	ABANDON*	<input type="checkbox"/>
REPAIR WELL	<input type="checkbox"/>	CHANGE PLANS	<input type="checkbox"/>
(Other) Amend Land Use Plan		X	

SUBSEQUENT REPORT OF:

WATER SHUT-OFF	<input type="checkbox"/>	REPAIRING WELL	<input type="checkbox"/>
FRACTURE TREATMENT	<input type="checkbox"/>	ALTERING CASING	<input type="checkbox"/>
SHOOTING OR ACIDIZING	<input type="checkbox"/>	ABANDONMENT*	<input type="checkbox"/>
(Other)			

(NOTE: Report results of multiple completion on Well Completion or Recompletion Report and Log form.)

17. DESCRIBE PROPOSED OR COMPLETED OPERATIONS (Clearly state all pertinent details, and give pertinent dates, including estimated date of starting any proposed work. If well is directionally drilled, give subsurface locations and measured and true vertical depths for all markers and zones pertinent to this work.) *

Amend Land Use Plan to include a 2-1/2" steel natural gas pipeline right-of-way, 30 feet in width and approximately 1100 feet in length. This pipeline will go north from the northwest corner of our Savage NI Federal #3 location to the southwest corner of our Savage NI Federal #2 location to tie into Enron's pipeline. The pipeline will be buried with a minimum cover of 24 inches. An archaeological survey will be conducted over the proposed route of the pipeline. A copy will be submitted to the BLM.



18. I hereby certify that the foregoing is true and correct

SIGNED Chilton P. May TITLE Permit Agent DATE April 20, 1988
(This space for Federal or State office use)

APPROVED BY S/Phil Ki TITLE Area Manager DATE JUN 14 1988

CONDITIONS OF APPROVAL, IF ANY:

Conditions of approval, if any:

This authorization is subject to the condition that all or part might be converted to a right-of-way grant in the future. Attached are two pages of stipulations which also apply. See Instructions on Reverse Side

Title 18 U.S.C. Section 1001, makes it a crime for any person knowingly and willfully to make to any department or agency of the United States any false, fictitious or fraudulent statements or representations as to any matter within its jurisdiction.

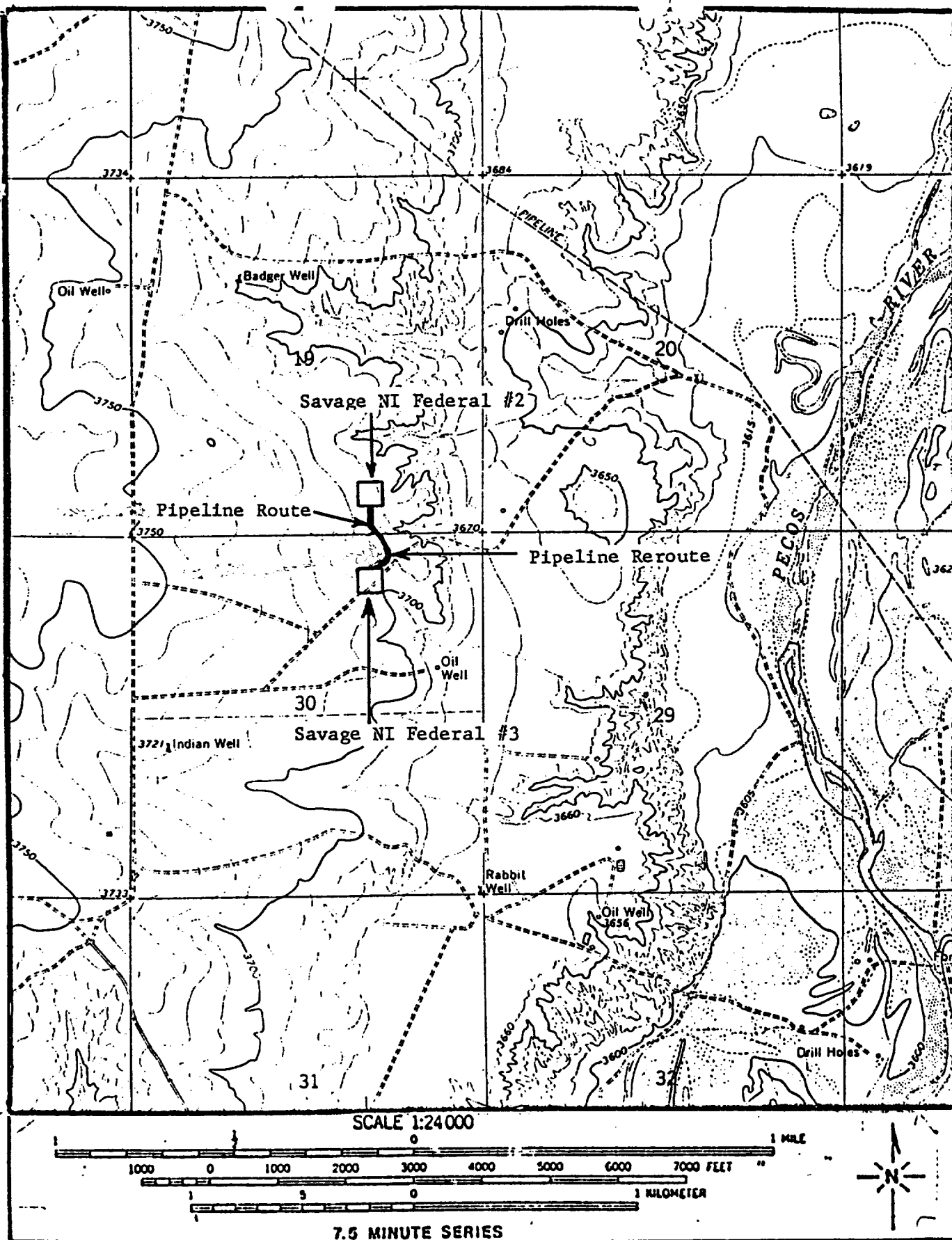

Figure 1. Location of pipeline from Savage NI Fed. #3 to Savage NI Fed. #2 in Sections 30 and 19, T06S, R26E, NMPM, Chaves County, NM.

Map Reference: USGS Cottonwood Draw, N.Mex. Quadrangle, 1967