

UNITED STATES ^{Artesia, NM 88210} DEPARTMENT OF THE INTERIOR
GEOLOGICAL SURVEY

APPLICATION FOR PERMIT TO DRILL, DEEPEN, OR PLUG BACK

1a. TYPE OF WORK

DRILL ☒DEEPEN ☐PLUG BACK ☐

b. TYPE OF WELL

OIL
WELL ☐GAS
WELL ☒OTHER ☐SINGLE
ZONED ☐RECEIVED ☐

2. NAME OF OPERATOR

Yates Petroleum Corporation ✓

3. ADDRESS OF OPERATOR

207 S. 4th, Artesia, New Mexico 88210

4. LOCATION OF WELL (Report location clearly and in accordance with any State requirements.)

At surface
1980' FNL and 1980' FELAt proposed prod. zone
same

14. DISTANCE IN MILES AND DIRECTION FROM NEAREST TOWN OR POST OFFICE*

16 miles ENE of Roswell, New Mexico 88210

15. DISTANCE FROM PROPOSED*

LOCATION TO NEAREST
PROPERTY OR LEASE LINE, FT.
(Also to nearest drlg. unit line, if any)

1980

16. NO. OF ACRES IN LEASE

1920

18. DISTANCE FROM PROPOSED LOCATION*

TO NEAREST WELL, DRILLING, COMPLETED,
OR APPLIED FOR, ON THIS LEASE, FT.

19. PROPOSED DEPTH

4650'

17. NO. OF ACRES ASSIGNED
TO THIS WELL

160

20. ROTARY OR CABLE TOOLS

Rotary

21. ELEVATIONS (Show whether DF, RT, GR, etc.)

3662.3' GL

22. APPROX. DATE WORK WILL START*

ASAP

23. PROPOSED CASING AND CEMENTING PROGRAM

SIZE OF HOLE	SIZE OF CASING	WEIGHT PER FOOT	SETTING DEPTH	QUANTITY OF CEMENT
14 3/4"	10 3/4"	48# J-55	950'	600 sx circulated
7 7/8"	4 1/2"	9.5#	TD	450 sx

We propose to drill and test the Abo and intermediate formations. Approximately 950' of surface casing will be set and cement circulated to shut off gravel and caving. If needed (lost circulation) 8 5/8" intermediate casing will be run to 1500' and cemented with enough cement calculated to tie back into the surface casing. If commercial, production casing will be run and cemented with adequate cover, perforated and stimulated as needed for production.

MUD PROGRAM: FW gel and LCM to 950', Brine to 3200', Brine & KCL water to TD.

BOP PROGRAM: BOP's will be installed at the offset and tested daily.

GAS NOT DEDICATED

IN ABOVE SPACE DESCRIBE PROPOSED PROGRAM: If proposal is to deepen or plug back, give data on present productive zone and proposed new productive zone. If proposal is to drill or deepen directionally, give pertinent data on subsurface locations and measured and true vertical depths. Give blowout preventer program, if any.

24.

SIGNED

Ken Beardsley

TITLE Regulatory Coordinator

DATE 11/18/82

(This space for Federal or State official use)

(Orig. Sgd.) **GEORGE H. STEWART**

PERMIT NO.

APPROVAL DATE

APPROVED BY

CONDITIONS OR APPROVAL IF ANY:

TITLE

JOHN GILHAM
DISTRICT SUPERVISORRECEIVED
NOV 22 1982OIL & GAS
U.S. GEOLOGICAL SURVEY
ROSWELL, NEW MEXICO*Posted 12/3/82
12-3-82*

NEW MEXICO OIL CONSERVATION COMMISSION
WELL LOCATION AND ACREAGE DEDICATION PLAT

Form C-102
Supersedes C-128
Effective 1-1-63

All distances must be from the outer boundaries of the Section.

Operator YATES PETROLEUM CORPORATION			Lease Huckabay "TJ" Federal		Well No. 3
Tract Letter G	Section 19	Township 8 South	Range 26 East	County Chaves	
Section 19, T8S, R26E, Chaves Co., N.M.					
Section 19, T8S, R26E, Chaves Co., N.M.					
1980 feet from the North		Line and	1980 feet from the East	Line	
Section 19, T8S, R26E, Chaves Co., N.M.	Producing Formation Abo	Foot	Undes. Peecos Slope Abo	Indicated Acreage 160 Acres	

- Outline the acreage dedicated to the subject well by colored pencil or hatchure marks on the plat below.
- If more than one lease is dedicated to the well, outline each and identify the ownership thereof (both as to working interest and royalty).
- If more than one lease of different ownership is dedicated to the well, have the interests of all owners been consolidated by communitization, unitization, force-pooling, etc?

RECEIVED

DEC 1 1982

O. C. D.

ARTESIA, OFFICE

☐ Yes ☐ No If answer is "yes," type of consolidation _____

If answer is "no," list the owners and tract descriptions which have actually been consolidated. (Use reverse side of this form if necessary.) _____

No allowable will be assigned to the well until all interests have been consolidated (by communitization, unitization, force-pooling, or otherwise) or until a non-standard unit, eliminating such interests, has been approved by the Commission.

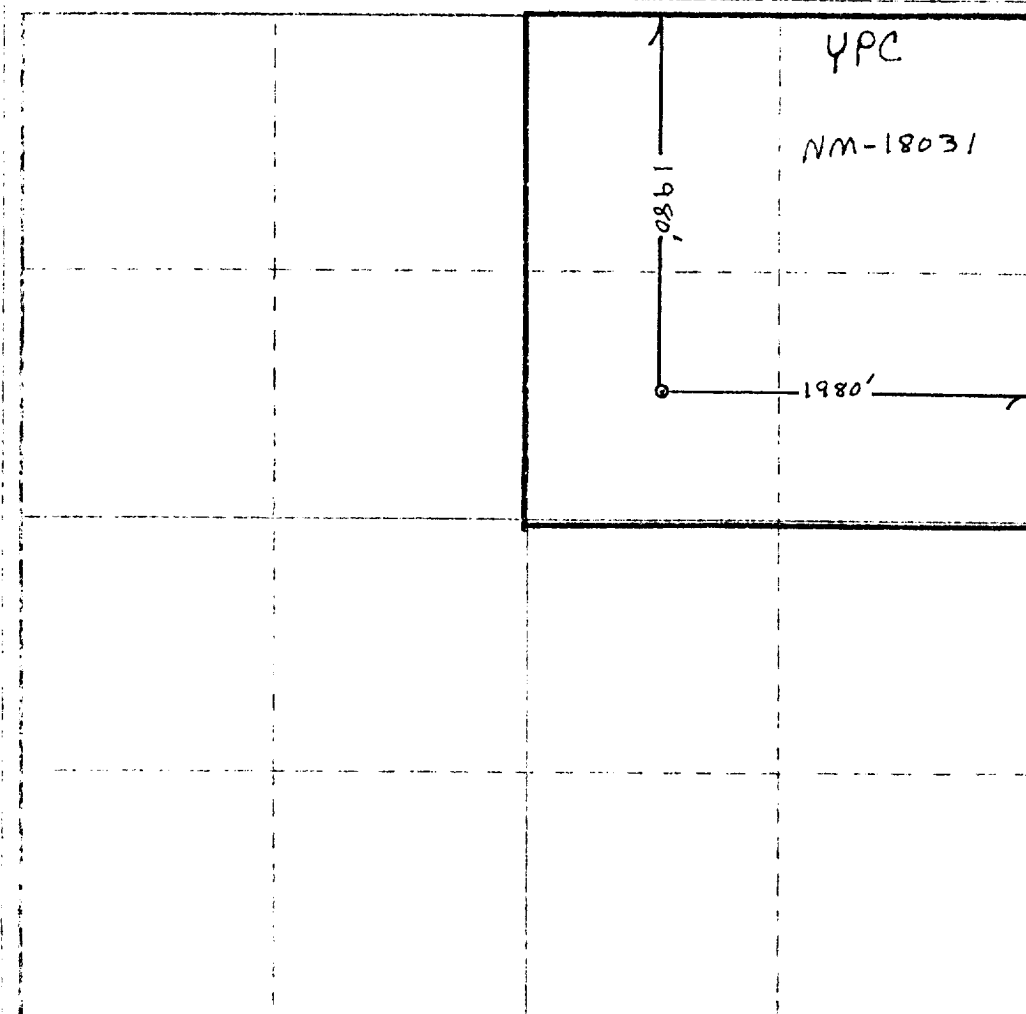

CERTIFICATION

I hereby certify that the information contained herein is true and complete to the best of my knowledge and belief.

Ken Beardemphl

Name
Ken Beardemphl
Position
Regulatory Coordinator
Company
Yates Petroleum Corp.

Date
11/17/82

I hereby certify that the information shown on this plat is true and complete to the best of my knowledge and belief.



Date Surveyed
November 15, 1982
Registered Professional Engineer
and/or Land Surveyor

Sam Ash

Certificate No.
7977

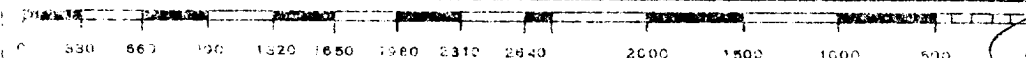

YATES PETROLEUM CORPORATION
Luckaby "TJ" Federal #3
1980' FNL and 1980' FEL
Sec. 19-T8S-R26E

In conjunction with Form 9-331C, Application for Permit to Drill subject well, Yates Petroleum Corporation submits the following ten items of pertinent information in accordance with USGS requirements.

1. The geologic surface formation is sandy alluvium.
2. The estimated tops of geologic markers are as follows:

<u>San Andres</u>	<u>748'</u>
<u>Glorieta</u>	<u>1885'</u>
<u>Fullerton</u>	<u>3338'</u>
<u>Abo</u>	<u>4056'</u>
<u>TD</u>	<u>4650'</u>

3. The estimated depths at which anticipated water, oil or gas formations are expected to be encountered:

Water: Approximately 260' - 330'

Oil or Gas: Abo 4085'

4. Proposed Casing Program: See Form 9-331C.
5. Pressure Control Equipment: See Form 9-331C and Exhibit B.
6. Mud Program: See Form 9-331C.
7. Auxiliary Equipment: Kelly Cock; pit level indicators and flow sensor equipment; sub with full-opening valve on floor, drill pipe connection.
8. Testing, Logging and Coring Program:
Samples: Surface casing to TD.
DST's: As warranted.
Coring: As warranted.
Logging: CNL-FDC TD to csg w/GR-CNL to surface & DLL from TD to csg.
9. No abnormal pressures or temperatures are anticipated.
10. Anticipated starting date: As soon as possible after approval.

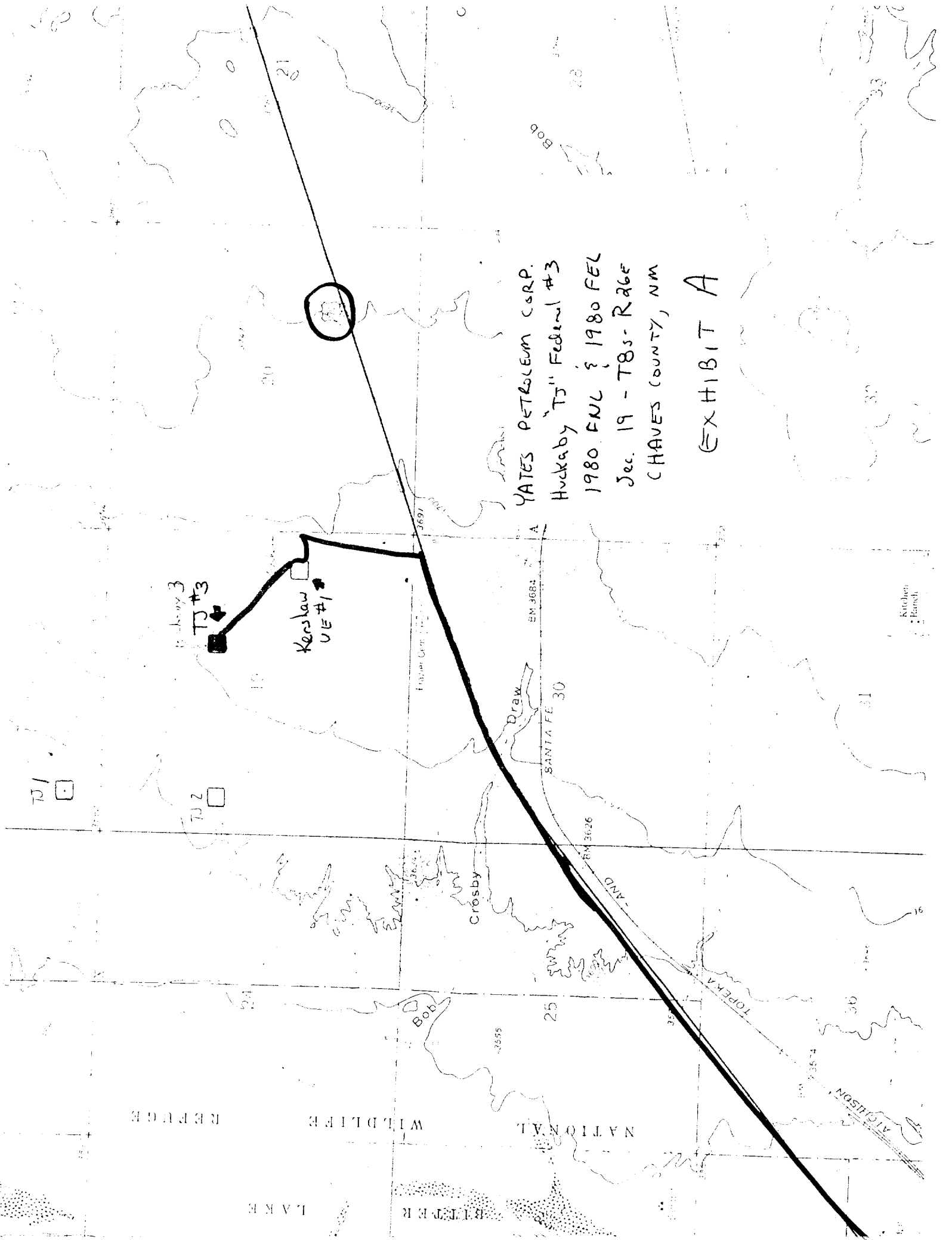

YATES PETROLEUM CORP.
Huckaby "TJ" Federal #3
1980 FNL & 1980 FEL
Sec. 19 - T8s-R26E
CHAVES COUNTY, NM

EXHIBIT A

Exhibit B

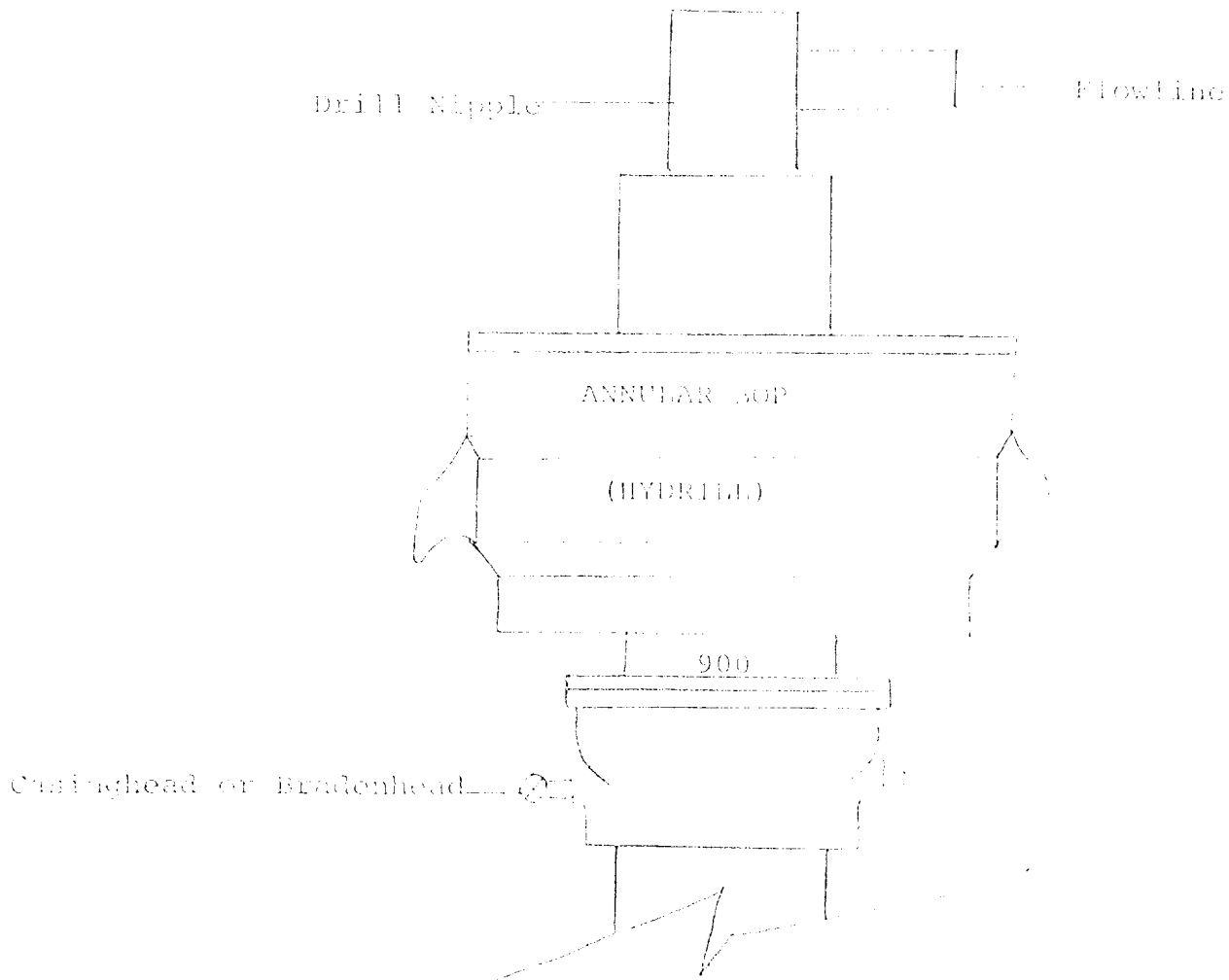

THE FOLLOWING CONSTITUTE MINIMUM BLOWOUT PREVENTER REQUIREMENTS

1. All preventers to be hydraulically operated with secondary manual controls installed prior to drilling out from under casing.
2. All connections from operating manifolds to preventers to be all steel. Hole or tube a minimum of one inch in diameter.
3. The available closing pressure shall be at least 15% in excess of that required with sufficient volume to operate the BOP's.
4. All connections to and from preventer to have a pressure rating equivalent to that of the BOP's.
5. Hole must be kept filled on trips below intermediate casing.

YATES PETROLEUM CORP.

Exhibit C

Reserve Pit
bottom to be at
ground level to
1 ft.

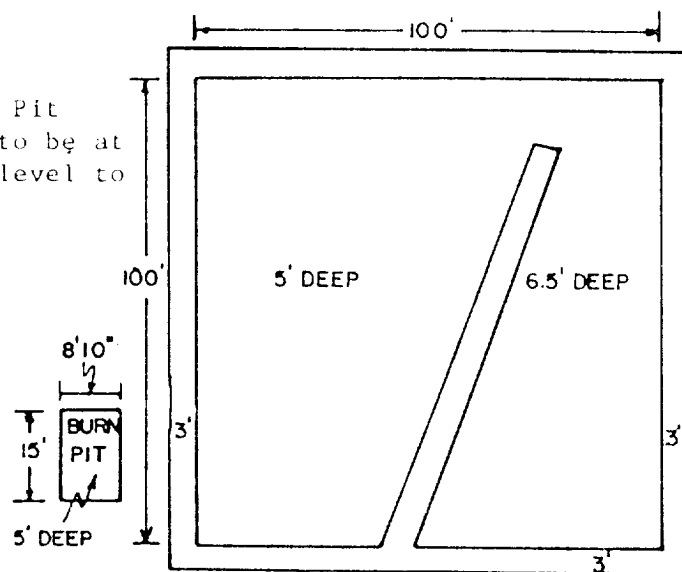

NOTE:

Inside walls must be as
high and wide as outer
walls of pit.

