

NO. OF COPIES RECEIVED	
DISTRIBUTION	
SANTA FE	<input checked="" type="checkbox"/>
FILE	<input checked="" type="checkbox"/>
U.S.G.S.	<input checked="" type="checkbox"/>
LAND OFFICE	<input checked="" type="checkbox"/>
OPERATOR	<input checked="" type="checkbox"/>

RECEIVED

DEC 6 1982

5A. Indicate Type of Lease
STATE <input type="checkbox"/> FEE <input checked="" type="checkbox"/>
5. State Oil & Gas Lease No.

APPLICATION FOR PERMIT TO DRILL, DEEPEN, OR PLUG BACK O. C. D.

1a. Type of Work	ARTESIA, <input type="checkbox"/>	7. Unit Agreement Name
b. Type of Well	DRILL <input checked="" type="checkbox"/> DEEPEN <input type="checkbox"/> PLUG BACK <input type="checkbox"/>	8. Farm or Lease Name
OIL WELL <input type="checkbox"/> GAS WELL <input checked="" type="checkbox"/> OTHER <input type="checkbox"/>	SINGLE ZONE <input type="checkbox"/> MULTIPLE ZONE <input type="checkbox"/>	Drumm "A" Com
2. Name of Operator	Clements Energy, Inc.	9. Well No.
3. Address of Operator	P. O. Box 20500, Oklahoma City, Oklahoma 73156	1
4. Location of Well	UNIT LETTER <u>G</u> LOCATED <u>1980</u> FEET FROM THE <u>North</u> LINE	10. Field and Pool, or Wildcat
AND <u>1980</u> FEET FROM THE <u>East</u> LINE OF SEC. <u>33</u> TWP. <u>14-S</u> RGE. <u>26-E</u> NMPM		W. Buffalo Valley-Penn
		12. County
		Chaves
		19. Proposed Depth
		7300'
		19A. Formation
		Morrow
		20. Rotary or C.T.
		Rotary
21. Elevations (Show whether D.F., R.T., etc.)	21A. Kind & Status Plug. Bond	21B. Drilling Contractor
3427' GR	Blanket - Active	
		22. Approx. Date Work will start
		December 27, 1982

23.

PROPOSED CASING AND CEMENT PROGRAM

SIZE OF HOLE	SIZE OF CASING	WEIGHT PER FOOT	SETTING DEPTH	SACKS OF CEMENT	EST. TOP
17-1/2"	13-3/8"	48#	375'	450	Circ to surface
12-1/4"	8-5/8"	24#	1350'	450	Circulate
7-7/8"	4-1/2"	10.5 & 11.6#	7300'	275	5800'

BOP Schedule: 0' - 375' None
375' - 1350' Rotating head on 13-3/8"
1350' - 7300' Double Shafer with Hydril test to 1000#

Spacing 320 acres

Gas is not dedicated

APPROVAL VALID FOR 180 DAYS
PERMIT EXPIRES 6-7-83
UNLESS DRILLING UNDERWAY

ABOVE SPACE DESCRIBE PROPOSED PROGRAM: IF PROPOSAL IS TO DEEPEN OR PLUG BACK, GIVE DATA ON PRESENT PRODUCTIVE ZONE AND PROPOSED NEW PRODUCTIVE ZONE. GIVE BLOWOUT PREVENTER PROGRAM, IF ANY.

I hereby certify that the information above is true and complete to the best of my knowledge and belief.

Signed W. E. Green Title V.P. Operations Date Dec. 3, 1982

(This space for State Use)

PROVED BY M. L. Williams TITLE Notify N.M.O.C.C. in sufficient DATE time to witness cementing

CONDITIONS OF APPROVAL, IF ANY:

Posted a P
12-10-82

OIL CONSERVATION DIVISION

STATE OF NEW MEXICO
ENERGY AND MINERALS DEPARTMENTP. O. BOX 2088
SANTA FE, NEW MEXICO 87501Form C-102
Revised 10-1-78
RECEIVED

All distances must be from the outer boundaries of the Section.

Operator Clements Energy, Inc.		Lease Drumm "A"		DEC	6 1982	1
Unit Letter G	Section 33	Township 14-S	Range 26-E	County Chaves		
Actual Footage Location of Well: 1980' feet from the North line and 1980' feet from the East line				Dedicated Acreage: 320 Acres		
Ground Level Elev. 3427'	Producing Formation Morrow	Pool W. Buffalo Valley-Penn				

1. Outline the acreage dedicated to the subject well by colored pencil or hachure marks on the plat below.
2. If more than one lease is dedicated to the well, outline each and identify the ownership thereof (both as to working interest and royalty).
3. If more than one lease of different ownership is dedicated to the well, have the interests of all owners been consolidated by communitization, unitization, force-pooling, etc?

☐ Yes ☒ No If answer is "yes," type of consolidation _____

If answer is "no," list the owners and tract descriptions which have actually been consolidated. (Use reverse side of this form if necessary.) None - Upon completion as producer will file Designation of Pooling

No allowable will be assigned to the well until all interests have been consolidated (by communitization, unitization, forced-pooling, or otherwise) or until a non-standard unit, eliminating such interests, has been approved by the Division.

Linda L. Wax 1/8		First National Bank of Kansas City, Agent U/A with Andrew Drumm Inst.
1980'		3/8
#1		1980'
Andrew Drumm Inst.		
T-14-S	William J. Schnedar	3/16
R-26-E		
E. H. Walkup - 5/16		
Clements Energy, Inc. et al 100% Working Interest		

CERTIFICATION

I hereby certify that the information contained herein is true and complete to the best of my knowledge and belief.

Colene Aldridge

Name

Asst. to V. P. Operations

Position

Clements Energy, Inc.

Company

December 3, 1982

Date

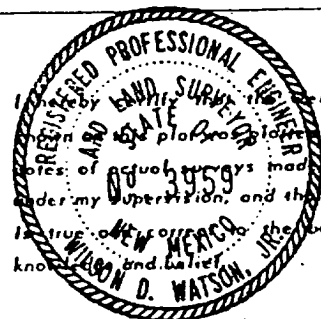

November 30, 1982

Date Surveyed

Registered Professional Engineer
and/or Land Surveyor

3959

Certificate No.

0 330 660 990 1320 1650 1980 2310 2640 2970 3300 3630 3960 4290 4620 4950 5280 5610 5940 6270 6600