

CONSERVATION DIVISION

P. O. BOX 2088

SANTA FE, NEW MEXICO 87501

Form C-101  
Revised 10-1-78

NO. OF COPIES RECEIVED	
DISTRIBUTION	
SANTA FE	<input checked="" type="checkbox"/>
FILE	<input checked="" type="checkbox"/>
U.S.G.S.	<input checked="" type="checkbox"/>
LAND OFFICE	<input checked="" type="checkbox"/>
OPERATOR	<input checked="" type="checkbox"/>

RECEIVED

DEC 6 1982

O. C. D.

ARTESIA, OFFICE

5A. Indicate Type of Lease  
STATE ☒ FEE ☐

5. State Oil & Gas Lease No.  
LH-181

APPLICATION FOR PERMIT TO DRILL, DEEPEN, OR PLUG BACK

1. Type of Work  
DRILL ☒ DEEPEN ☐ PLUG BACK ☐

2. Type of Well  
OIL WELL ☐ GAS WELL ☒ OTHER ☐ SINGLE ZONE ☐ MULTIPLE ZONE ☐

Name of Operator  
Clements Energy, Inc. ✓

Address of Operator  
P. O. Box 20500, Oklahoma City, Oklahoma 73156

Location of Well  
UNIT LETTER J LOCATED 1980 FEET FROM THE South LINE  
1980 FEET FROM THE East LINE OF SEC. 36 TWP. 13-South, 26-East NMPM

10. Field and Pool, or Wildcat  
Wildcat - Morrow

12. County  
Chaves

7. Unit Agreement Name

8. Farm or Lease Name  
New Mexico 36 State

9. Well No.  
2

13. Proposed Depth  
7000'

13A. Formation  
Morrow

20. Rotary or C.T.  
Rotary

Elevations (Show whether DF, RT, etc.)  
3437' GR

21A. Kind & Status Plug. Bond  
Blanket - Active

21B. Drilling Contractor

22. Approx. Date Work will start  
December 28, 1982

PROPOSED CASING AND CEMENT PROGRAM

SIZE OF HOLE	SIZE OF CASING	WEIGHT PER FOOT	SETTING DEPTH	SACKS OF CEMENT	EST. TOP
17-1/2"	13-3/8"	48#	375'	450	Circ to surface
12-1/4"	8-5/8"	24#	1350'	450	Circulate
7-7/8"	4-1/2"	10.5 & 11.6#	7300'	275	5800'

BOP Schedule: 0' - 375' None  
375' - 1350' Rotating head on 13-3/8"  
1350' - 7300' Double Shafer with Hydril test to 1000#

Spacing 320 acres

Gas is not dedicated

*Posted a dg  
FD-121 of Book  
12-10-82*

APPROVAL VALID FOR 180 DAYS  
PERMIT EXPIRES 6-7-83  
UNLESS DRILLING UNDERWAY

BEFORE SPACE DESCRIBE PROPOSED PROGRAM: IF PROPOSAL IS TO DEEPEN OR PLUG BACK, GIVE DATA ON PRESENT PRODUCTIVE ZONE AND PROPOSED NEW PRODUCTIVE ZONE, GIVE BLOWOUT PREVENTER PROGRAM, IF ANY.

by certify that the information above is true and complete to the best of my knowledge and belief.

W. G. Gullen Title Vice President - Operations Date December 3, 1982

(This space for State Use)

APPROVED BY M. L. Walker TITLE DATE

CONDITIONS OF APPROVAL, IF ANY:

Notify N.M.O.C.C. in sufficient time to witness cementing

the 8 5/8 casing

DEC 6 1982

All distances must be from the outer boundaries of the Section.

Operator <b>Clements Energy Inc.</b>		Lease <b>New Mexico State</b>		O. C. D. <b>ARIESA, OFFICE</b>		Well No. <b>36#2</b>
Unit Letter <b>J</b>	Section <b>36</b>	Township <b>13 South</b>	Range <b>26 East</b>	County <b>Chaves</b>		
Actual Footage Location of Well: <b>1980</b> feet from the <b>South</b> line and <b>1980</b> feet from the <b>East</b> line						
Ground Level Elev. <b>3437'</b>	Producing Formation <b>Morrow</b>		Pool <b>Wildcat - Morrow</b>		Dedicated Acreage: <b>320</b> Acres	

1. Outline the acreage dedicated to the subject well by colored pencil or hachure marks on the plat below.
2. If more than one lease is dedicated to the well, outline each and identify the ownership thereof (both as to working interest and royalty).
3. If more than one lease of different ownership is dedicated to the well, have the interests of all owners been consolidated by communitization, unitization, force-pooling, etc?

☐ Yes ☐ No If answer is "yes," type of consolidation \_\_\_\_\_

If answer is "no," list the owners and tract descriptions which have actually been consolidated. (Use reverse side of this form if necessary.) \_\_\_\_\_

No allowable will be assigned to the well until all interests have been consolidated (by communitization, unitization, forced-pooling, or otherwise) or until a non-standard unit, eliminating such interests, has been approved by the Division.

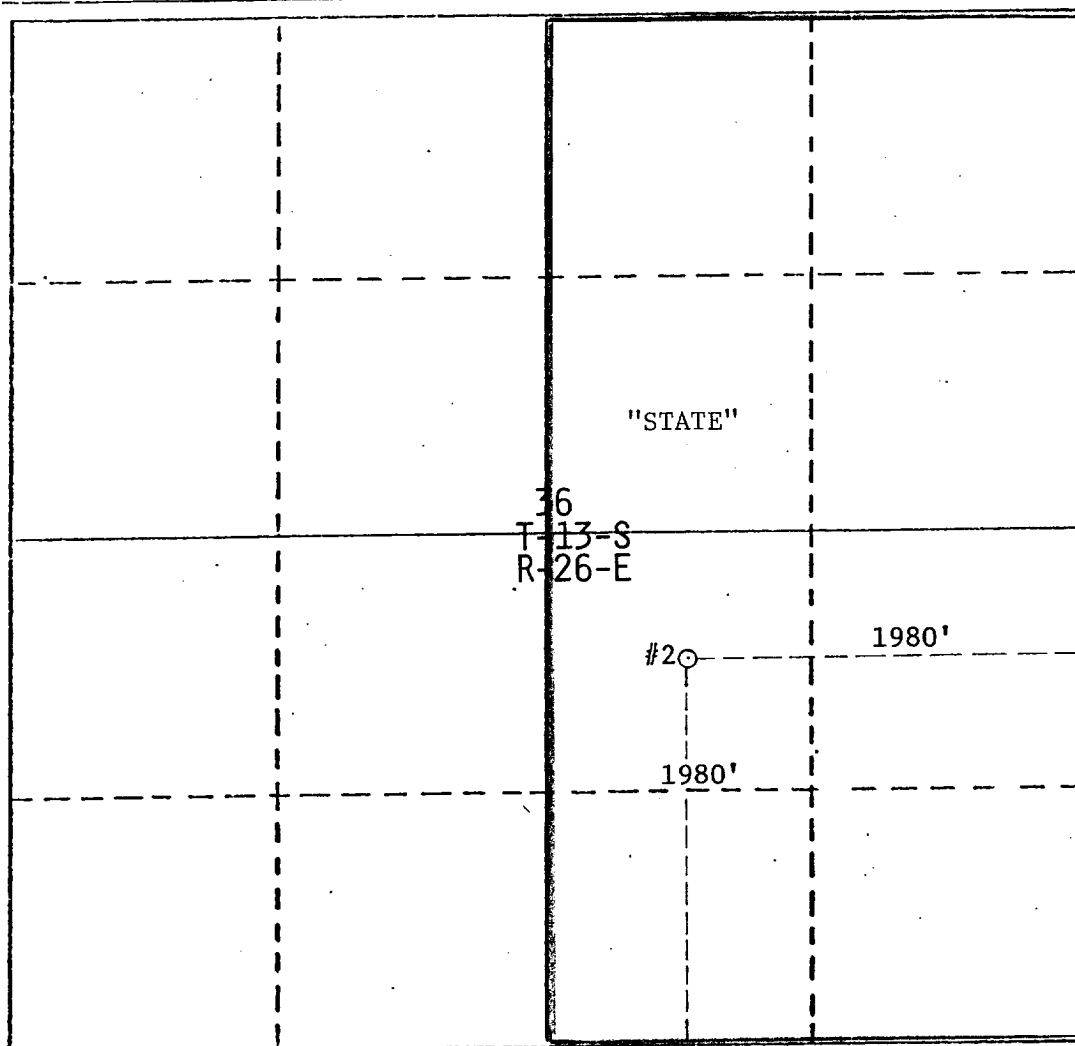

CERTIFICATION

I hereby certify that the information contained herein is true and complete to the best of my knowledge and belief.

Colene Aldridge

Name  
Asst. to V. P. Operations  
Position  
Clements Energy, Inc.  
Company  
December 3, 1982  
Date

I hereby certify that the well location shown on this plat was plotted from field notes of actual surveys made by me or under my supervision, and that the same is true and correct to the best of my knowledge.

Date Surveyed  
Registered Professional Engineer  
W.D. Watson Jr.  
Certificate No.