

STATE OF NEW MEXICO
ENERGY AND MINERALS DEPARTMENT

L CONSERVATION DIVISION
P. O. BOX 2088
SANTA FE, NEW MEXICO 87501

30-005-61870

Form C-101
Revised 10-1-78

NO. OF COPIES RECEIVED	
DISTRIBUTION	
SANTA FE	<input checked="" type="checkbox"/>
FILL	<input checked="" type="checkbox"/>
U.S.G.S.	<input checked="" type="checkbox"/>
LAND OFFICE	<input checked="" type="checkbox"/>
OPERATOR	<input checked="" type="checkbox"/>

RECEIVED

DEC 8 1982

O. C. D.

5A. Indicate Type of Lease STATE <input checked="" type="checkbox"/> FEE <input type="checkbox"/>
5. State Oil & Gas Lease No. L-6853

APPLICATION FOR PERMIT TO DRILL, DEEPEN, OR PLUG BACK

1a. Type of Work DRILL <input checked="" type="checkbox"/> DEEPEN <input type="checkbox"/> PLUG BACK <input type="checkbox"/>		7. Unit Agreement Name	
b. Type of Well OIL WELL <input type="checkbox"/> GAS WELL <input checked="" type="checkbox"/> OTHER <input type="checkbox"/>		8. Form or Lease Name Aikman State Comm.	
2. Name of Operator ELK OIL COMPANY ✓		9. Well No. 1	
3. Address of Operator P. O. BOX 310, ROSWELL, NEW MEXICO 88201		10. Field and Pool, or Wildcat Undesignated Penn.	
4. Location of Well UNIT LETTER I LOCATED 1980 FEET FROM THE South LINE AND 660 FEET FROM THE East LINE OF SEC. 14 TWP. 9S RGE. 26E NMPM		12. County Chaves	
19. Proposed Depth 6,500'		19A. Formation Penn	
20. Rotary or C.T. Rotary		21. Elevations (Show whether DF, KI, etc.) 3814	
21A. Kind & Status Plug. Bond Blanket		21B. Drilling Contractor WEK	
22. Approx. Date Work will start 12/15/82			

23.

PROPOSED CASING AND CEMENT PROGRAM

SIZE OF HOLE	SIZE OF CASING	WEIGHT PER FOOT	SETTING DEPTH	SACKS OF CEMENT	EST. TOP
12 1/4	8 5/8	24	950	500	circ.
7 7/8	4 1/2	10.5	6,500	600	4200'

BLOWOUT PREVENTION PROGRAM

See Attached

Postcard & P.D. 12-9-82

APPROVAL VALID FOR 180 DAYS
PERMIT EXPIRES 6-9-83
UNLESS DRILLING UNDERWAY

IN ABOVE SPACE DESCRIBE PROPOSED PROGRAM: IF PROPOSAL IS TO DEEPEN OR PLUG BACK, GIVE DATA ON PRESENT PRODUCTIVE ZONE AND PROPOSED NEW PRODUCTIVE ZONE. GIVE BLOWOUT PREVENTER PROGRAM, IF ANY.

I hereby certify that the information above is true and complete to the best of my knowledge and belief.

Signed [Signature] Title President Date 12/3/82
(This space for State Use)

APPROVED BY [Signature] TITLE OIL AND GAS INSPECTOR DATE DEC 9 1982
CONDITIONS OF APPROVAL, IF ANY:

All distances must be from the outer boundaries of the Section.

Operator Elk Oil		Lease Aikman State Comm.		Well No. 1
Unit Letter I	Section 14	Township 9 South	Range 26 East	County Chaves
Actual Postage Location of Well: 1980 feet from the South line and 660 feet from the East line				
Ground Level Elev. 3814	Producing Formation Penn	Pool Undesignated	Dedicated Acres: 320 Acres	

1. Outline the acreage dedicated to the subject well by colored pencil or hatchure marks on the plat below.

2. If more than one lease is dedicated to the well, outline each and identify the ownership thereof (both as to working interest and royalty).

3. If more than one lease of different ownership is dedicated to the well, have the interests of all owners been consolidated by communitization, unitization, force-pooling, etc?

☐ Yes ☐ No If answer is "yes," type of consolidation _____

If answer is "no," list the owners and tract descriptions which have actually been consolidated. (Use reverse side of this form if necessary.) _____

No allowable will be assigned to the well until all interests have been consolidated (by communitization, unitization, forced-pooling, or otherwise) or until a non-standard unit, eliminating such interests, has been approved by the Division.

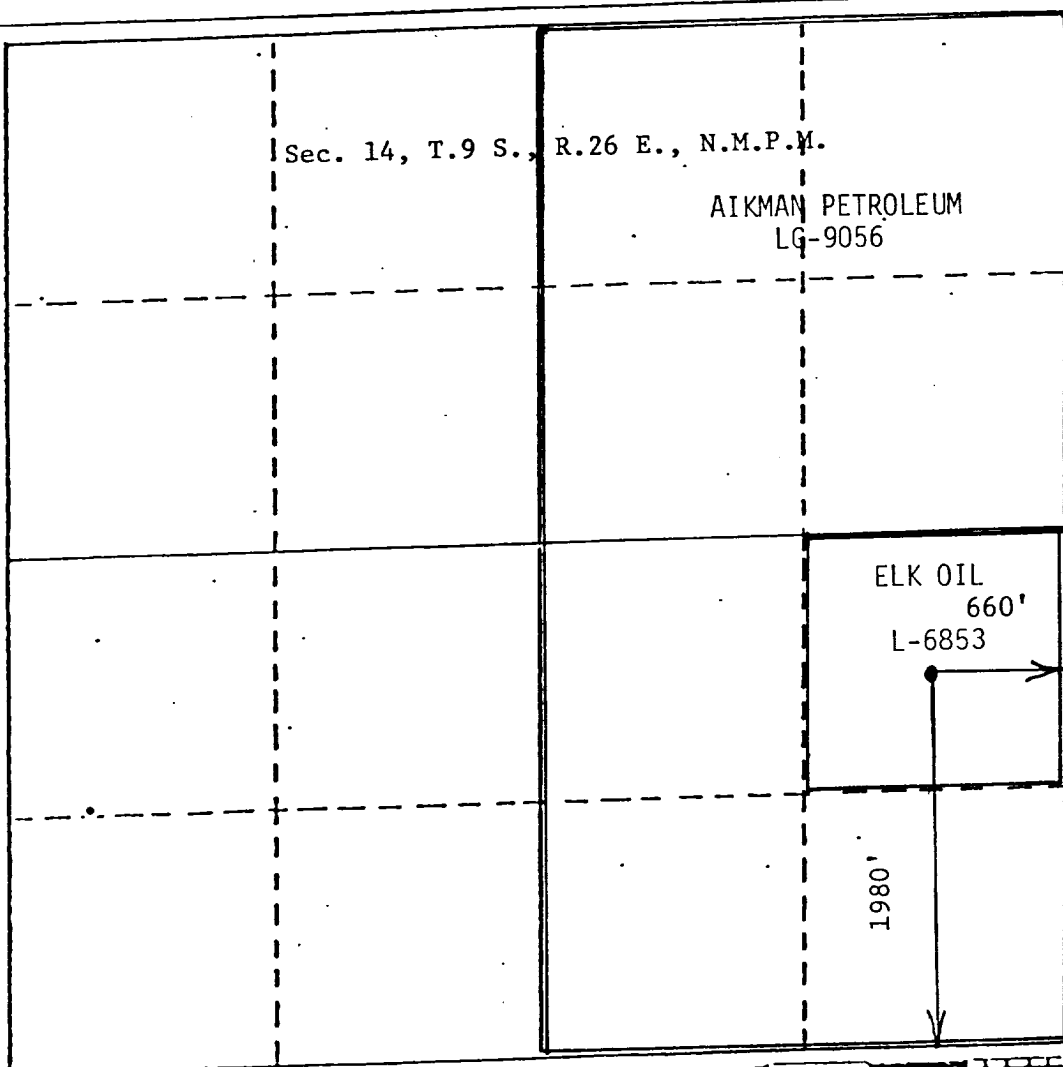

CERTIFICATION

I hereby certify that the information contained herein is true and complete to the best of my knowledge and belief.

Name
Joseph J. Kelly

Position
President

Company
ELK OIL COMPANY

Date
12/3/82

I hereby certify that the well location shown on this plat was plotted from field notes of actual surveys made by me or under my supervision, and that the same is true and correct to the best of my knowledge and belief.

Date Surveyed
December 1982

Registered Professional Engineer and/or Land Surveyor

JOHN D. JAQUE
NEW MEXICO
6290
Professional Engineer and Land Surveyor
6290

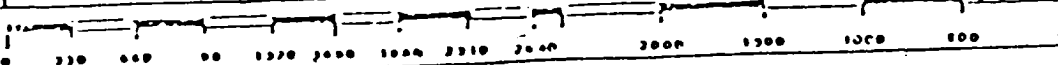

WEK DRILLING CO., INC. - Rig 1 & 3 BLOWOUT PREVENTER SPECIFICATION

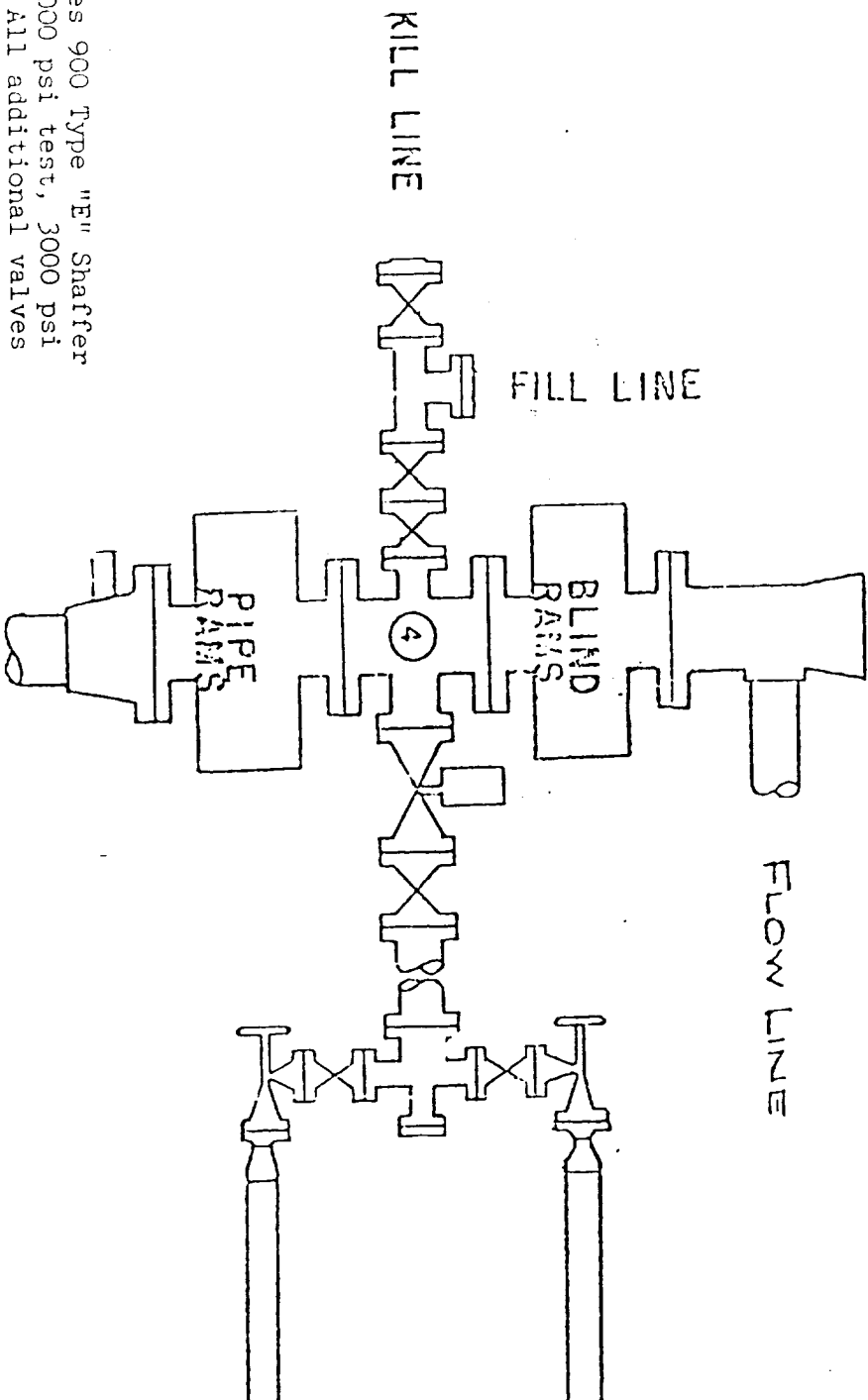

BOP's are 10" Series 900 Type "E" Shaffer Double Hydraulic 6000 psi test, 3000 psi working pressure. All additional valves & connections are the same test & working pressures.