

STATE OF NEW MEXICO  
 DEPARTMENT OF ENERGY AND MINES  
 DIVISION OF OIL AND GAS  
 SUNDARY NOTICES AND REPORTS ON WELLS

LAND OFFICE	<input checked="" type="checkbox"/>
OPERATOR	<input checked="" type="checkbox"/>

RECEIVED  
 JAN 31 1983  
 O. C. D.  
 ARTESIA, OFFICE

10. Well Type (Check one)  
 State ☐ ☒ ☐  
 11. Well No. ☐

SUNDARY NOTICES AND REPORTS ON WELLS

(DO NOT USE THIS FORM FOR PROPOSALS TO DRILL OR RE-DRILL OR PLUG BACK TO A DIFFERENT RESERVOIR. USE APPLICATION FOR PERMIT - 11 (FORM C-103) FOR SUCH PROPOSALS.)

12. Well Name ☒ ☐ ☐

Cibola Energy Corporation ✓  
 P.O. Box 1668, Albuquerque, New Mexico 87103

13. Well No. ☐

14. Well Location  
 East West  
 330 FEET FROM THE North LINE AND 990 FEET FROM  
 18 SECTION 10S RANGE 28E

15. Well Agreement (Check one)  
 J. P. White  
 4  
 Race Track San Andres  
 16. County  
 Chaves

Check Appropriate Box To Indicate Nature of Notice, Report or Other Data  
 NOTICE OF INTENTION TO: SUBSEQUENT REPORT OF:

17. Proposed or Completed Operations (Clearly state all pertinent details, and give pertinent dates, including estimated date of starting any work. See Rule 1103.)	18. Well Type (Check one) <input type="checkbox"/> <input checked="" type="checkbox"/> <input type="checkbox"/>	19. Well No. <input type="checkbox"/>
---	--	---------------------------------------

12/13/82 Spudded at 1:00 PM.

1/26/83 Ran 320' of 8 5/8" 24# casing. Ran texas pattern guide shoe and insert float. Cemented with 100 sacks Class C Cement with 2% CaCl. Circulated 20 sacks to pit. Bumped plug 500 psi and held for 15 minutes. WOC 18 hrs.

I hereby certify that the information above is true and complete to the best of my knowledge and belief.

*Quinta Uziel*  
 TITLE Drilling Secretary DATE 1-27-83

For Record Only  
 MAR 03 1983

NO. OF COPIES RECEIVED	
DISTRIBUTION	
SANTA FE	<input checked="" type="checkbox"/>
FILE	<input checked="" type="checkbox"/>
U.S.G.S.	<input checked="" type="checkbox"/>
LAND OFFICE	<input checked="" type="checkbox"/>
OPERATOR	<input checked="" type="checkbox"/>

## NEW MEXICO OIL CONSERVATION COMMISSION

RECEIVED

DEC 7 1982

Form O-101  
Revised 1-1-85

5A. Lease Type of Lease	STATE <input type="checkbox"/>	FEE <input checked="" type="checkbox"/>
5B. State Oil & Gas Lease No.		

## APPLICATION FOR PERMIT TO DRILL, DEEPEN, OR PLUG BACK

1a. Type of Work			7. Unit Agreement Name		
b. Type of Well OIL WELL <input checked="" type="checkbox"/> GAS WELL <input type="checkbox"/> OTHER <input type="checkbox"/>			8. Firm or Lease Name J. P. White		
c. Name of Operator Cibola Energy Corporation			9. Well No. 4		
3. Address of Operator P.O. Box 1668, Albuquerque, New Mexico 87103			10. Field and Pool, or Well Unit Race Track San Andres		
4. Location of Well UNIT LETTER <u>A</u> LOCATED <u>330</u> FEET FROM THE <u>North</u> LINE AND <u>990</u> FEET FROM THE <u>East</u> LINE OF SEC. <u>18</u> TWP. <u>10S</u> RGE. <u>28E</u> NMPM			11. County Chaves		
12. Proposed Depth 2300'			13A. Formation San Andres		13B. Rotary or C.T. Cable Tool
21. Elevations (Show whether DT, RT, etc.) 3791.5		21A. Kind & Status Plug. Bond Statewide	21B. Drilling Contractor Comanche Drilling		22. Approx. Date Work will start December 14, 1982

23.

## PROPOSED CASING AND CEMENT PROGRAM

SIZE OF HOLE	SIZE OF CASING	WEIGHT PER FOOT	SETTING DEPTH	SACKS OF CEMENT	EST. TOP
10"	8 5/8"	23#	320'	200 sacks	surface
8"	7"	23#	2300'	300 sacks	1660'

We plan to drill a 10" hole to 320' and set 8 5/8" 23# casing, a texas pattern guide shoe and insert float. Cementing with 200 sacks Class "C" Cement. WOC 18 hours. Then drill an 8" hole to TD (2300'). Casing and cement program will be decided after reviewing the logs.

APPROVAL VALID FOR 180 DAYS  
PERMIT EXPIRES 6-9-83  
UNLESS DRILLING UNDERWAY

IN ABOVE SPACE DESCRIBE PROPOSED PROGRAM; IF PROPOSAL IS TO DEEPEN OR PLUG BACK, GIVE DATA ON PRESENT PRODUCTIVE ZONE AND PROPOSED NEW PRODUCTIVE ZONE. GIVE BLOWOUT PREVENTER PROGRAM, IF ANY.

I hereby certify that the information above is true and complete to the best of my knowledge and belief.

Signed Quinta P. Vigil Title Drilling Secretary Date 12-6-82  
(This space for State Use)

APPROVED BY Mike Walker TITLE OIL AND GAS INSPECTOR DATE DEC 9 1982  
CONDITIONS OF APPROVAL, IF ANY:

N. MEXICO OIL CONSERVATION COMMISS  
WELL LOCATION AND ACREAGE DEDICATION PLAT

Form C-102  
Supersedes C-120  
Effective 1-1-65

RECEIVED

All distances must be from the outer boundaries of the Section

Operator <b>CIBOLA ENERGY CORP.</b>		Lease <b>J.P. WHITE</b>		DEC 7 1982 Well No. 4	
Unit Letter <b>A</b>	Section <b>18</b>	Township <b>10 SOUTH</b>	Range <b>28 EAST</b>	County <b>O.C.D. CHAVES D. ARTESIA, OFFICE</b>	
Actual Footage Location of Well: <b>330</b> feet from the <b>NORTH</b> line and <b>990</b> feet from the <b>EAST</b> line					
Ground Level Elev. <b>3791.5</b>	Producing Formation <b>Slaughter</b>		Pool <b>Race Track San Andres</b>		Dedicated Acreage: <b>40</b> Acres

1. Outline the acreage dedicated to the subject well by colored pencil or hachure marks on the plat below.
2. If more than one lease is dedicated to the well, outline each and identify the ownership thereof (both as to working interest and royalty).
3. If more than one lease of different ownership is dedicated to the well, have the interests of all owners been consolidated by communitization, unitization, force-pooling, etc?

☐ Yes ☒ No If answer is "yes," type of consolidation \_\_\_\_\_

If answer is "no," list the owners and tract descriptions which have actually been consolidated. (Use reverse side of this form if necessary.) All leases held by operator and participating parties

No allowable will be assigned to the well until all interests have been consolidated (by communitization, unitization, forced-pooling, or otherwise) or until a non-standard unit, eliminating such interests, has been approved by the Commission.

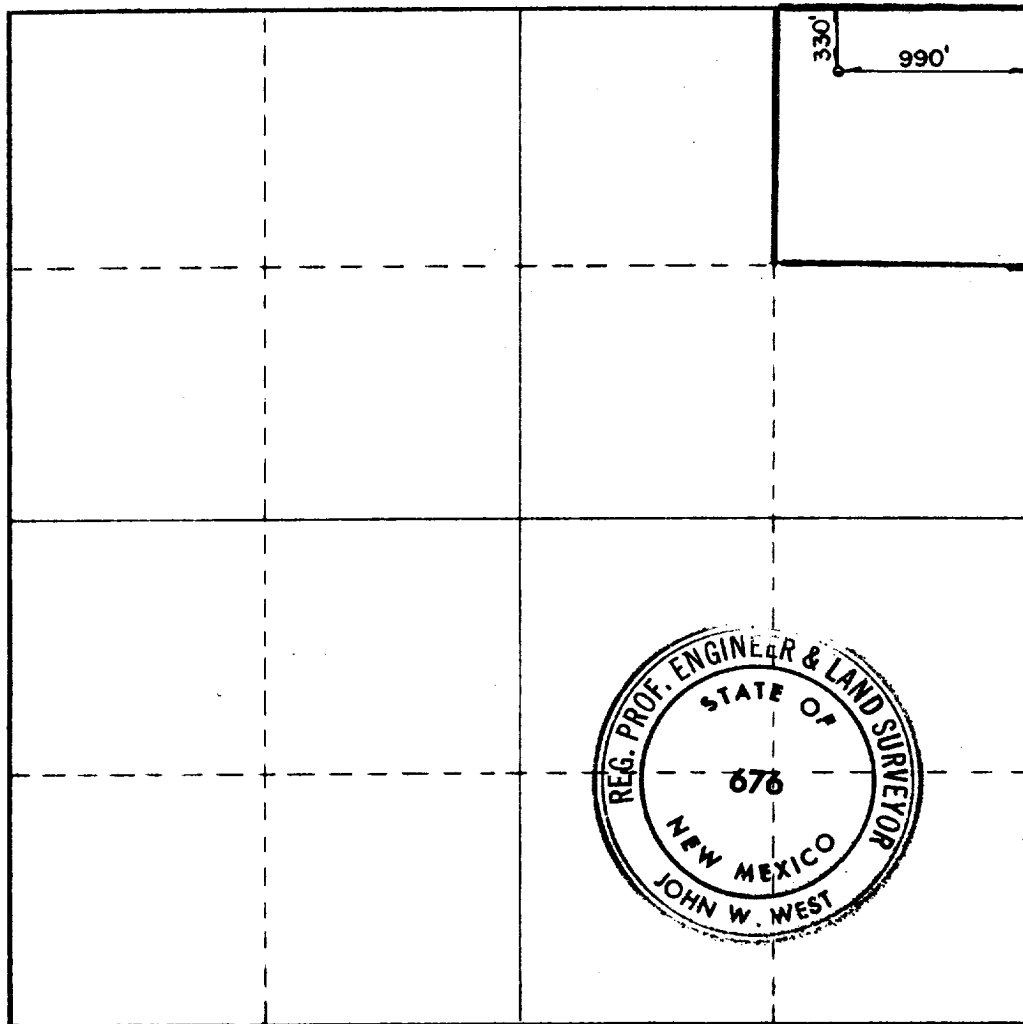

CERTIFICATION

I hereby certify that the information contained herein is true and complete to the best of my knowledge and belief.

*Anita Vigil*

Name  
**Anita Vigil**

Position  
**Drilling Secretary**

Company  
**Cibola Energy Corporation**

Date  
**December 6, 1982**

I hereby certify that the well location shown on this plat was plotted from field notes of actual surveys made by me or under my supervision, and that the same is true and correct to the best of my knowledge and belief.

Date Surveyed  
**DECEMBER 1, 1982**

Registered Professional Engineer and or Land Surveyor

*John W. West*

Certificate No  
**JOHN W. WEST N.M. #676**

