

30-005-6816

STATE OF NEW MEXICO
ENERGY AND MINERALS DEPARTMENTOIL CONSERVATION DIVISION
P. O. BOX 2088
SANTA FE, NEW MEXICO 87501Form C-101
Revised 10-1-78

NO. OF COPIES RECEIVED	
DISTRIBUTION	
SANTA FE	<input checked="" type="checkbox"/>
FILE	<input checked="" type="checkbox"/>
U.S.G.S.	<input checked="" type="checkbox"/>
LAND OFFICE	<input checked="" type="checkbox"/>
OPERATOR	<input checked="" type="checkbox"/>

RECEIVED

DEC 9 1982

O. C. D.

ARTESIA OFFICE

APPLICATION FOR PERMIT TO DRILL, DEEPEN, OR PLUG BACK

a. Type of Work DRILL <input checked="" type="checkbox"/> DEEPEN <input type="checkbox"/> PLUG BACK <input type="checkbox"/>		7. Unit Agreement Name
b. Type of Well OIL WELL <input type="checkbox"/> GAS WELL <input checked="" type="checkbox"/> OTHER <input type="checkbox"/>		8. Farm or Lease Name Sun Diamond
c. Name of Operator STEVENS OPERATING CORPORATION		9. Well No. 1
d. Address of Operator P. O. Box 2408, Roswell, NM 88201		10. Field and Pool, or Wildcat Pecos Slope Abo
e. Location of Well UNIT LETTER 0 LOCATED 660 FEET FROM THE South LINE AND 1980 FEET FROM THE East LINE OF SEC. 20 TWP. 7S RGE. 26E NMPM		12. County Chaves
19. Proposed Depth 4500'		19A. Formation Abo
20. Rotary or C.T. Rotary		21. Elevation (Show whether DF, RT, etc.) 3566.8 GR
21A. Kind & Status Plug. Bond Statewide		21B. Drilling Contractor Horizon Drilling Company
22. Approx. Date Work will start December 27, 1982		

23. PROPOSED CASING AND CEMENT PROGRAM

SIZE OF HOLE	SIZE OF CASING	WEIGHT PER FOOT	SETTING DEPTH	SACKS OF CEMENT	EST. TOP
12 1/4"	8 5/8"	23.0#	900'	Circ to surface	
7 7/8"	4 1/2"	10.5#	4500'	Circ to surface	

Drill with water and mud to TD, log and if indicated productive, case to TD. Pay zones will be perforated and stimulated as needed for production.

Gas is not dedicated.

APPROVAL VALID FOR 180 DAYS
PERMIT EXPIRES 6-1-83
UNLESS DRILLING UNDERWAY

IN ABOVE SPACE DESCRIBE PROPOSED PROGRAM: IF PROPOSAL IS TO DEEPEN OR PLUG BACK, GIVE DATA ON PRESENT PRODUCTIVE ZONE AND PROPOSED NEW PRODUCTIVE ZONE. GIVE BLOWOUT PREVENTER PROGRAM, IF ANY.

I hereby certify that the information above is true and complete to the best of my knowledge and belief.

Signed Don Thompson Title Production Coordinator Date December 8, 1982

(This space for State Use)

APPROVED BY M. Williams TITLE OIL AND GAS INSPECTOR DATE DEC 14 1982

CONDITIONS OF APPROVAL, IF ANY:

Notify N.M.O.C.D. in sufficient time to witness cementing

the casing

Posted 2/28/83
19-1-83 Hook
12-17-82

NEW MEXICO OIL CONSERVATION COMMISSION
WELL LOCATION AND ACREAGE DEDICATION PLAT

Form C-102
Supersedes C-128
Effective 1-1-65

All distances must be from the outer boundaries of the Section

STEVEN'S OPERATING CO.			SUN-DIAMOND		Well No. 1
Section 0	Section 20	Township 7S	Range 26E	County CHAVES	
660 feet from the SOUTH line and		1980 feet from the EAST line			
Surface Elev. 3566.8	Producing Formation Abo	Pecos Slope Abo		Estimated Acreage 160 Acres	

- Outline the acreage dedicated to the subject well by colored pencil or hatchure marks on the plat below.
- If more than one lease is dedicated to the well, outline each and identify the ownership thereof (both as to working interest and royalty).
- If more than one lease of different ownership is dedicated to the well, have the interests of all owners been consolidated by communitization, unitization, force-pooling, etc?

Yes ☐ No ☐ If answer is "yes," type of consolidation _____

If answer is "no," list the owners and tract descriptions which have actually been consolidated. (Use reverse side of this form if necessary.) _____

No allowable will be assigned to the well until all interests have been consolidated (by communitization, unitization, forced-pooling, or otherwise) or until a non-standard unit, eliminating such interests, has been approved by the Commission.

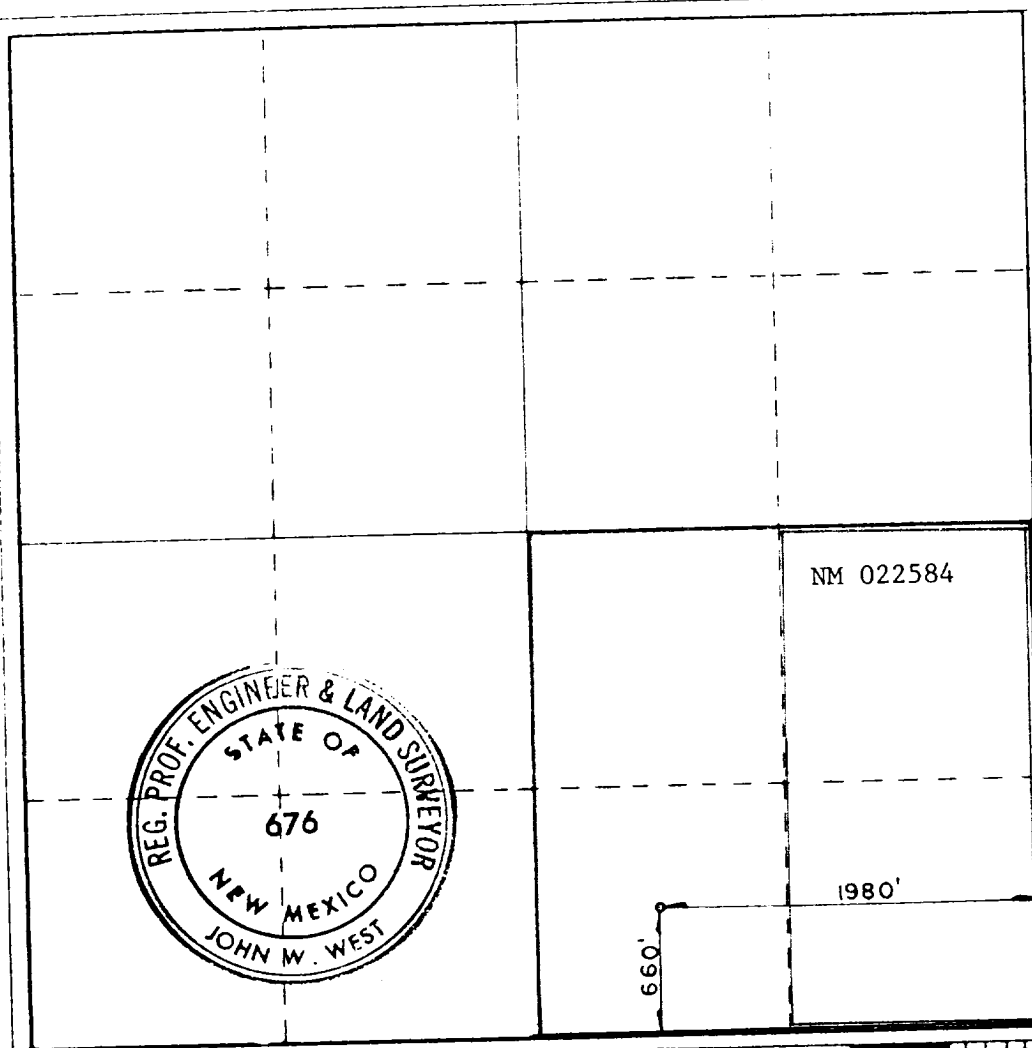

CERTIFICATION

I hereby certify that the information contained herein is true and complete to the best of my knowledge and belief.

Pat Thompson
Name
Pat Thompson

Position
Production Coordinator

Company
STEVEN'S OPERATING CORPORATION

Date
December 8, 1982

I hereby certify that the well location shown on this plat was plotted from field notes of actual surveys made by me or under my supervision, and that the same is true and correct to the best of my knowledge and belief.

Date Surveyed
12/2/82

Registered Professional Engineer and/or Land Surveyor

John W. West

Certificate No.
JOHN W. WEST N.M.#676

BLOWOUT PREVENTER SKETCH

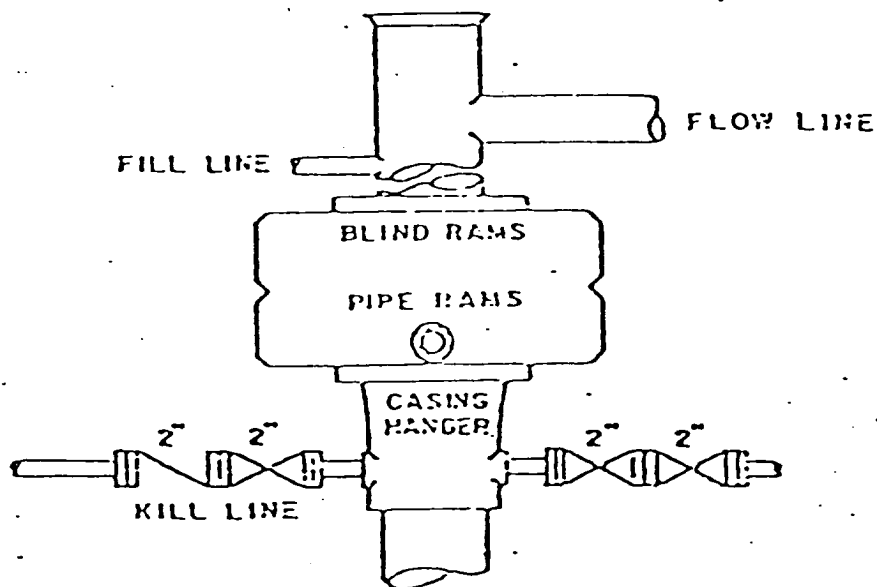

DUAL RAM-TYPE PREVENTER

STEVENS OPERATING CORPORATION
660 FSL 1980 FEL, Sec. 20, T-7-S R-26-E
Sun Diamond #1
CHAVES COUNTY, NEW MEXICO