

UNITED STATES DEPARTMENT OF THE INTERIOR
GEOLOGICAL SURVEY
NM OIL CONS. COMMISSION
Prior DD
Artesia, NM 88210

APPLICATION FOR PERMIT TO DRILL, DEEPEN, OR PLUG BACK

1a. TYPE OF WORK

DRILL ☒DEEPEN ☐PLUG BACK ☐

b. TYPE OF WELL

OIL WELL ☐GAS WELL ☒

OTHER

SINGLE ZONE ☒MULTIPLE ZONE ☐

2. NAME OF OPERATOR

McClellan Oil Corporation

3. ADDRESS OF OPERATOR

P.O. Drawer 730, Roswell, New Mexico 88201

4. LOCATION OF WELL (Report location clearly and in accordance with any State requirements.)*

At surface

2310' FSL & 660' FWL

At proposed prod. zone

14. DISTANCE IN MILES AND DIRECTION FROM NEAREST TOWN OR POST OFFICE*

20 miles northeast of Roswell, New Mexico

ARTESIA, OFFICE

15. DISTANCE FROM PROPOSED*

LOCATION TO NEAREST
PROPERTY OR LEASE LINE, FT. 660'

(Also to nearest drlg. unit line, if any)

15. DISTANCE FROM PROPOSED LOCATION*

TO NEAREST WELL, DRILLING, COMPLETED,
OR APPLIED FOR, ON THIS LEASE, FT. 2400'

21. ELEVATIONS (Show whether DF, RT, GR, etc.)

3609' G.L.

23. PROPOSED CASING AND CEMENTING PROGRAM

SIZE OF HOLE	SIZE OF CASING	WEIGHT PER FOOT	SETTING DEPTH	QUANTITY OF CEMENT
24"	20"	60	120'	12 yards
17 1/2"	13-3/8"	48	700'	500 sx Circulate
12 1/4"	8-5/8"	23	1250'	500 sx Circulate
7-7/8"	4-1/2"	10.5	4000'	350 sx

Propose to drill the Abo formation. If production is indicated, will set 4 1/2" casing and attempt completion.

Mud Program: Drill with fresh water and native mud to top of Abo. Will mud up 100' above top of Abo with salt gel mud, 40 viscosity, 15 water loss, 10 lb/gal wt. mud.

Gas is not dedicated.

IN ABOVE SPACE DESCRIBE PROPOSED PROGRAM: If proposal is to deepen or plug back, give data on present productive zone. If proposal is to drill or deepen directionally, give pertinent data on subsurface locations and measured and true vertical depths. Give blowout preventer program, if any.

24.

SIGNED

Mark McClellan

TITLE Geologist

DATE Oct. 11, 1982

(This space for Federal or State office use)

(Orig. Sgd.) GEORGE H. STEWART

PERMIT NO.

OCT 20 1982

APPROVAL DATE

APPROVED BY

TITLE

DATE

CONDITIONS OF APPROVAL, IF ANY

APPROVAL NON-STD LOCATION

RECEIVED
OCT 13 1982OIL & GAS
MINERALS MGMT. SERVICE
ROSWELL, NEW MEXICOWanted a p2
AD-1 with Booth
12-24-82

All distances must be from the outer boundaries of the Section.

Operator McClellan Oil Corp		Lease Coyote Federal		Well No. 4Y
Unit Letter L	Section 7	Township 8 South	Range 25 East	County Chaves
Actual Footage Location of Well: 2310 feet from the South line and 660 feet from the West line				
Ground Level Elev. 3609	Producing Formation Abo	Pool Undesignated Abo	Dedicated Acreage: 160 Acres	

1. Outline the acreage dedicated to the subject well by colored pencil or hatchure marks on the plat below.
2. If more than one lease is dedicated to the well, outline each and identify the ownership thereof (both as to working interest and royalty).
3. If more than one lease of different ownership is dedicated to the well, have the interests of all owners been consolidated by communitization, unitization, force-pooling, etc?

☐ Yes ☐ No If answer is "yes," type of consolidation _____

If answer is "no," list the owners and tract descriptions which have actually been consolidated. (Use reverse side of this form if necessary.) _____

No allowable will be assigned to the well until all interests have been consolidated (by communitization, unitization, forced-pooling, or otherwise) or until a non-standard unit, eliminating such interests, has been approved by the Division.

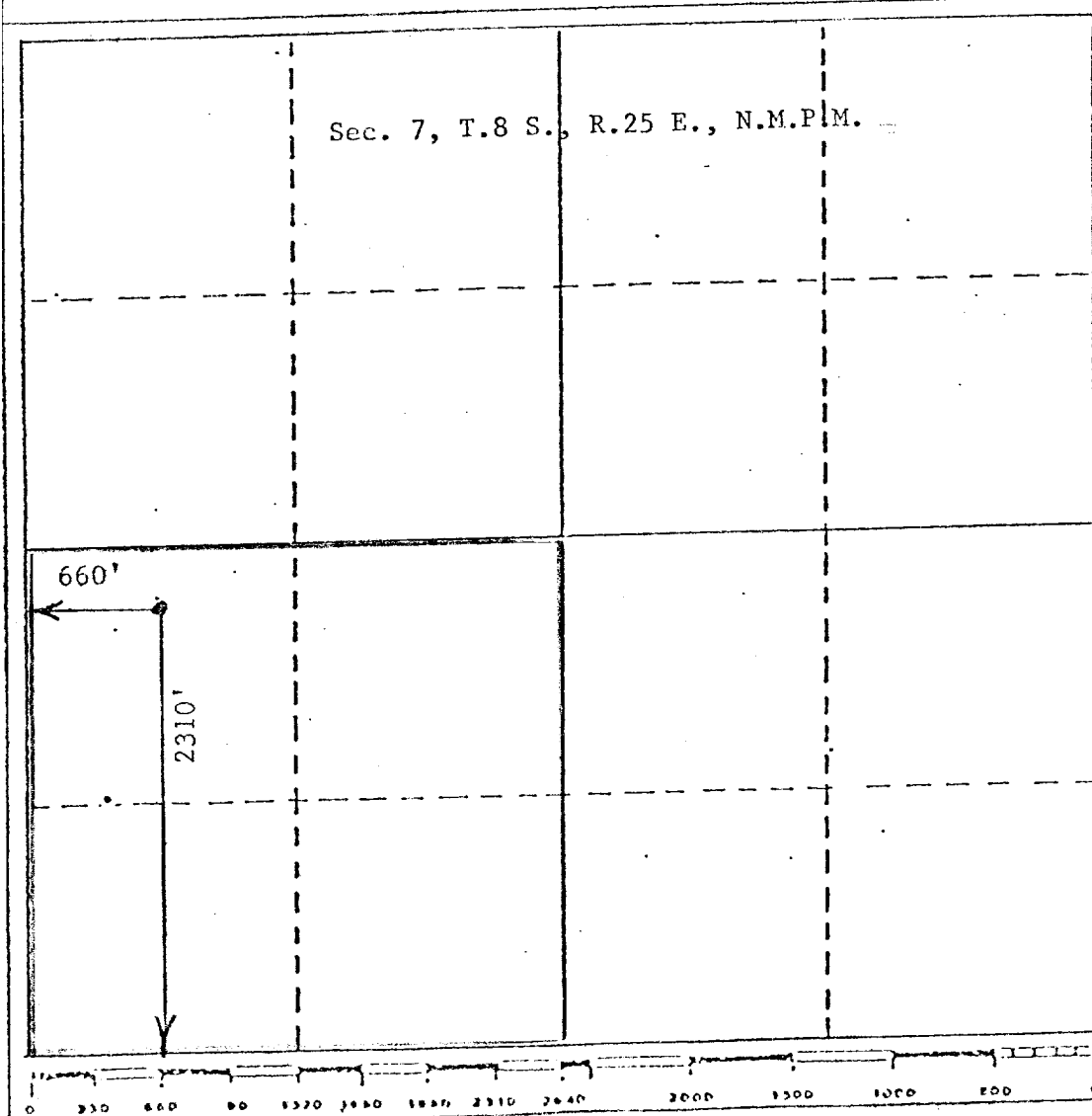

CERTIFICATION

I hereby certify that the information contained herein is true and complete to the best of my knowledge and belief.

Mark McClellan

Name

Mark McClellan

Position

Geologist

Company

McClellan Oil Corporation

Date

October 8, 1982

I hereby certify that the well location shown on this plat was plotted from field notes of actual surveys made by me or under my supervision, and that the same is true and correct to the best of my knowledge and belief.

Date Surveyed

October 7, 1982

Registered Professional Engineer and Surveyor

John D. Jaques, P.E. & L.S.

Certificate No. 6290