

**NEW MEXICO OIL CONSERVATION COMMISSION
WELL LOCATION AND ACREAGE DEDICATION PLAT**

Form C-102
Supersedes C-128
Effective 1-1-65

All distances must be from the outer boundaries of the Section.

Operator Yates Petroleum Corporation		Lease Cities "UO" Federal		Well No. 1
Unit Letter H	Section 7	Township 5 South	Range 25 East	County Chaves
Actual Postage Location of Well:				
1980	feet from the	North	line and	860
				feet from the
				East
Ground Level Elev. 3901.8' GL	Producing Formation Abo		Pool Pecos Slope Abo	Dedicated Acreage 16.0 Acres

1. Outline the acreage dedicated to the subject well by colored pencil or hachure marks on the plat below.
2. If more than one lease is dedicated to the well, outline each and identify the ownership thereof (both as to working interest and royalty).
3. If more than one lease of different ownership is dedicated to the well, have the interests of all owners been consolidated by communitization, unitization, force-pooling, etc?

☐ Yes ☐ No If answer is "yes," type of consolidation _____

If answer is "no," list the owners and tract descriptions which have actually been consolidated. (Use reverse side of this form if necessary.) _____

No allowable will be assigned to the well until all interests have been consolidated (by communitization, unitization, forced-pooling, or otherwise) or until a non-standard unit, eliminating such interests, has been approved by the Commission.

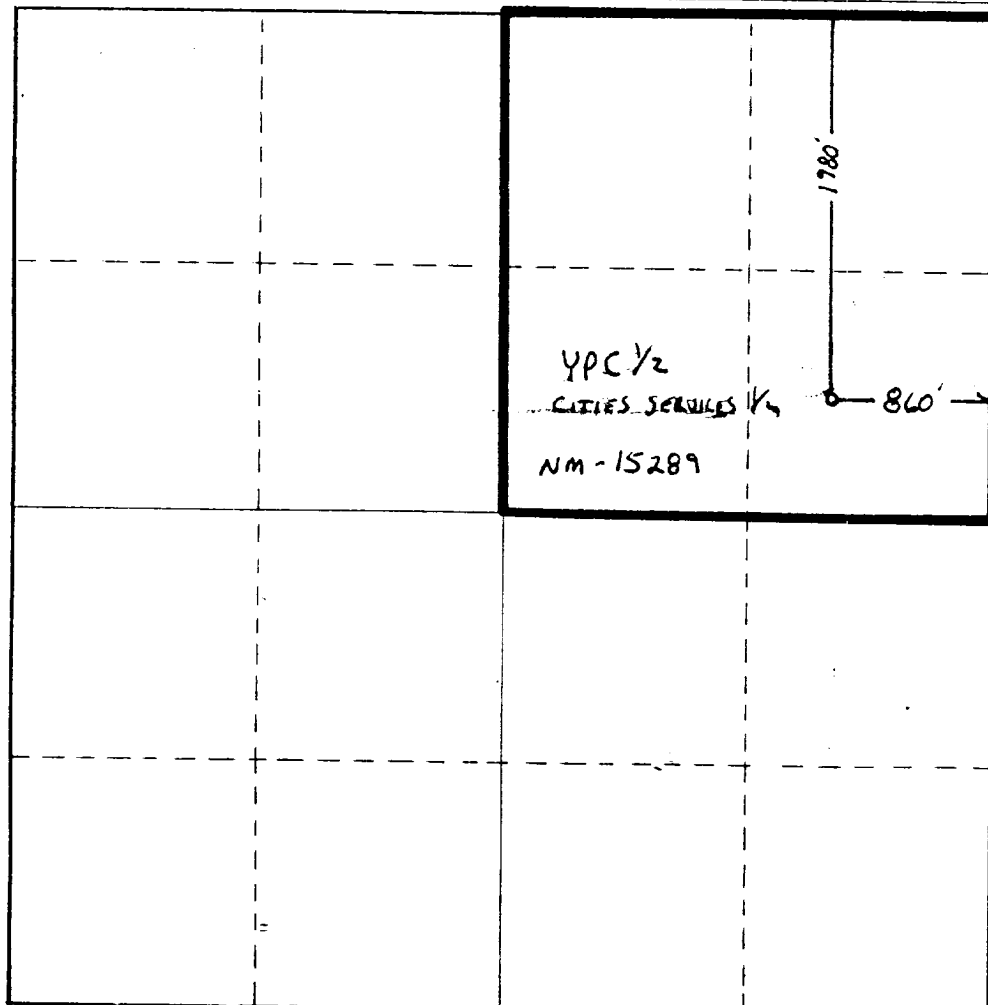

CERTIFICATION

I hereby certify that the information contained herein is true and complete to the best of my knowledge and belief.

Ken Beardemphl

Name
Ken Beardemphl
Position
Regulatory Coordinator
Company
Yates Petroleum Corp.
Date
12/20/82

I hereby certify that the well location shown on this plat was plotted from field notes of actual surveys made by me or under my supervision, and that the same is true and correct to the best of my knowledge and belief.

December 20, 1982

Date Surveyed
December 20, 1982
Registered Professional Engineer and/or Land Surveyor
L. JONES
3640
Certificate No. **7977**

