

ARTESIA, UNITED STATES
DEPARTMENT OF THE INTERIOR
GEOLOGICAL SURVEY

AMENDED

APPLICATION FOR PERMIT TO DRILL, DEEPEN, OR PLUG BACK

1a. TYPE OF WORK DRILL <input checked="" type="checkbox"/> DEEPEN <input type="checkbox"/> PLUG BACK <input type="checkbox"/>			5. LEASE DESIGNATION AND SERIAL NO. NM 36644	
b. TYPE OF WELL OIL WELL <input type="checkbox"/> GAS WELL <input checked="" type="checkbox"/> OTHER <input type="checkbox"/>			6. IF INDIAN, ALLOTTEE OR TRIBE NAME	
2. NAME OF OPERATOR MESA PETROLEUM CO.			7. UNIT AGREEMENT NAME	
3. ADDRESS OF OPERATOR 1000 VAUGHN BUILDING/MIDLAND, TEXAS 79701-4493			8. FARM OR LEASE NAME DEBBIE FEDERAL	
4. LOCATION OF WELL (Report location clearly and in accordance with any State requirements.) At surface 1980' FSL & 1650' FWL NE 1/4 SW 1/4 K JAN 14 1983 At proposed prod. zone SAME O. C. D.			9. WELL NO. 7	
14. DISTANCE IN MILES AND DIRECTION FROM NEAREST TOWN OR POST OFFICE 28 Miles Northwest of Roswell, New Mexico			10. FIELD AND POOL, OR WILDCAT UNDESIGNATED ABO	
15. DISTANCE FROM PROPOSED* LOCATION TO NEAREST PROPERTY OR LEASE LINE, FT. (Also to nearest drlg. unit line, if any) 1980' / 990'			11. SEC., T., R., M., OR BLK. AND SURVEY OR AREA Sec 29, T7S, R23E	
16. NO. OF ACRES IN LEASE 1941.5'			12. COUNTY OR PARISH 13. STATE CHAVES NEW MEXICO	
17. NO. OF ACRES ASSIGNED TO THIS WELL 160			18. DISTANCE FROM PROPOSED* LOCATION TO NEAREST WELL, DRILLING, COMPLETED, OR APPLIED FOR, ON THIS LEASE, FT. 1550'	
19. PROPOSED DEPTH 3400'			20. ROTARY OR CABLE TOOLS ROTARY	
21. ELEVATIONS (Show whether DF, RT, GR, etc.) 3985' GR			22. APPROX. DATE WORK WILL START* August 25, 1982	

23. PROPOSED CASING AND CEMENTING PROGRAM

SIZE OF HOLE	SIZE OF CASING	WEIGHT PER FOOT	SETTING DEPTH	QUANTITY OF CEMENT
12 1/4"	8 5/8"	24#	1400'	700/300 SURFACE
7 7/8"	4 1/2"	10.5#	3400'	350 COVER ALL PAY

Propose to drill 12 1/4" hole to approximately 1400' to set 8 5/8" surface casing and cement to surface. Will nipple up ram type BOP's and reduce hole to 7 7/8" to drill to total depth. Drilling medium will be air, foam, or mud as required. After log evaluation, 4 1/2" casing may be run and cemented with sufficient kinds and amounts to isolate and seal off any fresh water, oil or gas zones encountered.

Operator's Gas Sales are dedicated.

NOTE: Location moved due to archaeology at original location

XC: MMS (7), TLS, CEN RCDS, ACCTG, MEC, LAND, ROSWELL, REM, FILE, (PARTNER)

IN ABOVE SPACE DESCRIBE PROPOSED PROGRAM: If proposal is to deepen or plug back, give data on present productive zone and proposed new productive zone. If proposal is to drill or deepen directionally, give pertinent data on subsurface locations and measured and true vertical depths and any blowout preventer program, if any.

24. SIGNED <u>R. P. Mott</u> TITLE <u>REGULATORY COORDINATOR</u>	
(This space for Federal or State office use)	
PERMIT NO. _____	APPROVAL DATE _____
APPROVED BY _____	TITLE _____
CONDITIONS OF APPROVAL, IF ANY:	

All distances must be from the outer boundaries of the Section.

Operator Mesa Petroleum Co.		Lease Debbie Federal		Well No. 7
Unit Letter K	Section 29	Township 7 South	Range 23 East	County Chaves
Actual Postage Location of Well: 1650 feet from the West line and 1980 feet from the South line				
Ground Level Elev. 3985	Producing Formation ABO	Pool UNDESIGNATED	Dedicated Acreage: SW/4 160 Acres	

1. Outline the acreage dedicated to the subject well by colored pencil or hatchure marks on the plat below.
2. If more than one lease is dedicated to the well, outline each and identify the ownership thereof (both as to working interest and royalty).
3. If more than one lease of different ownership is dedicated to the well, have the interests of all owners been consolidated by communitization, unitization, force-pooling, etc?

RECEIVED

AUG 16 1982

☐ Yes ☐ No If answer is "yes," type of consolidation _____

If answer is "no," list the owners and tract descriptions which have actually been consolidated on the reverse side of this form if necessary.)

No allowable will be assigned to the well until all interests have been consolidated (by communitization, unitization, forced-pooling, or otherwise) or until a non-standard unit, eliminating such interests, has been approved by the Division.

Oil & Gas
MINERALS MGMT. SERVICE
ROSWELL, NEW MEXICO

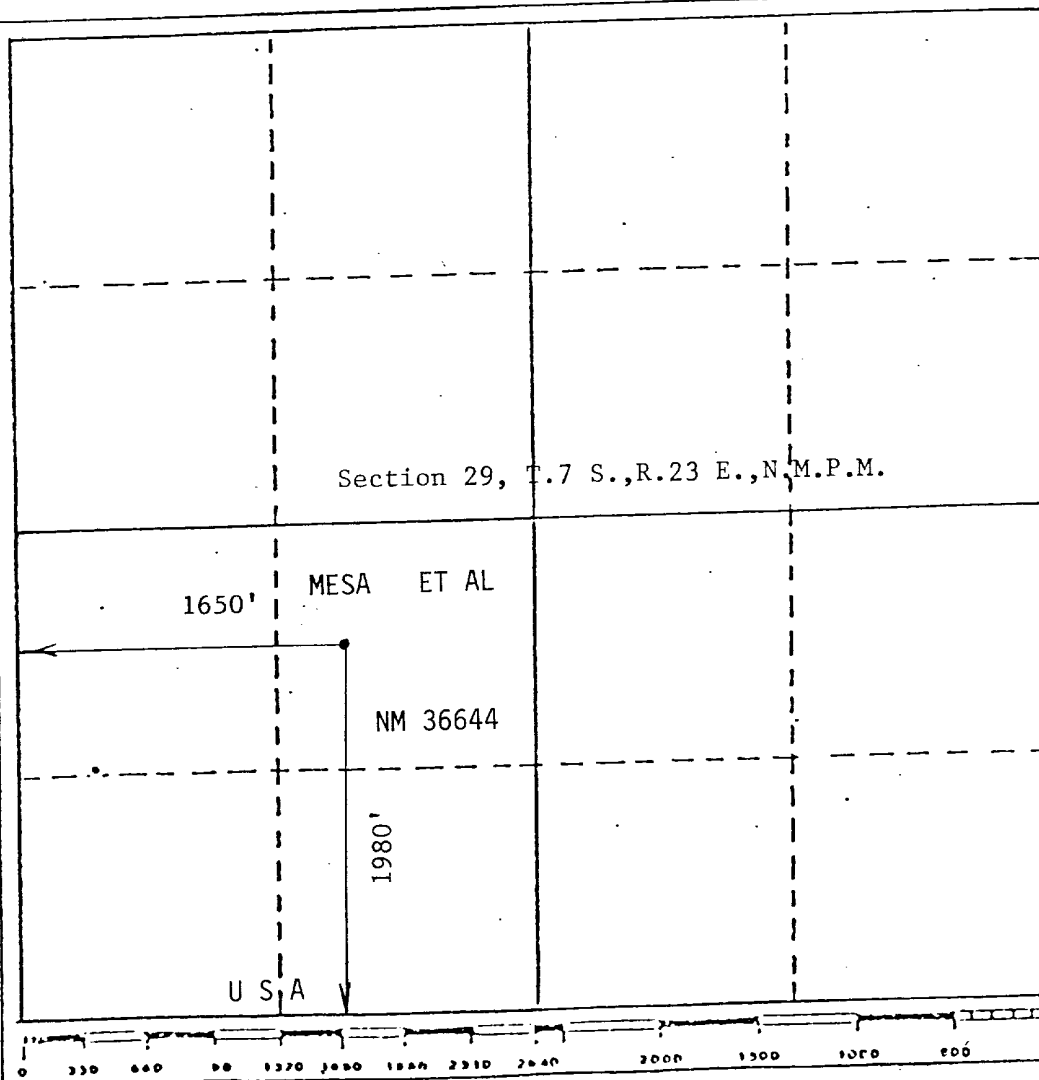

CERTIFICATION

I hereby certify that the information contained herein is true and complete to the best of my knowledge and belief.

R. E. Mathis

Name
R. E. MATHIS
Position
REGULATORY COORDINATOR
Company
MESA PETROLEUM CO.
Date
AUGUST 16, 1982

I hereby certify that the well location shown on this plat was plotted from field notes of actual surveys made by me or under my supervision, and that the same is true and correct to the best of my knowledge and belief.

JOHN D. JAQUESS
NEW MEXICO
Date Surveyed
July 16, 1982
Registered Professional Engineer
and/or Land Surveyor
John D. Jaquess, P.E. & L.S.
Certificate No.
6290

APPLICATION FOR PERMIT TO DRILL

MESA PETROLEUM CO.
DEBBIE FEDERAL #7
1980' FSL & 990' FWL, SEC 29, T7S, R23E
CHAVES COUNTY, NEW MEXICO

LEASE NO. NM-36644



In conjunction with Form 9331-C, Application For Permit to Drill subject well, the following additional information is provided:

1. Applicable portions of the GENERAL REQUIREMENTS FOR OIL AND GAS OPERATIONS ON FEDERAL LEASES, Roswell District, Geological Survey of September 1, 1980 will be adhered to.
2. Geological markers are estimated as follows:

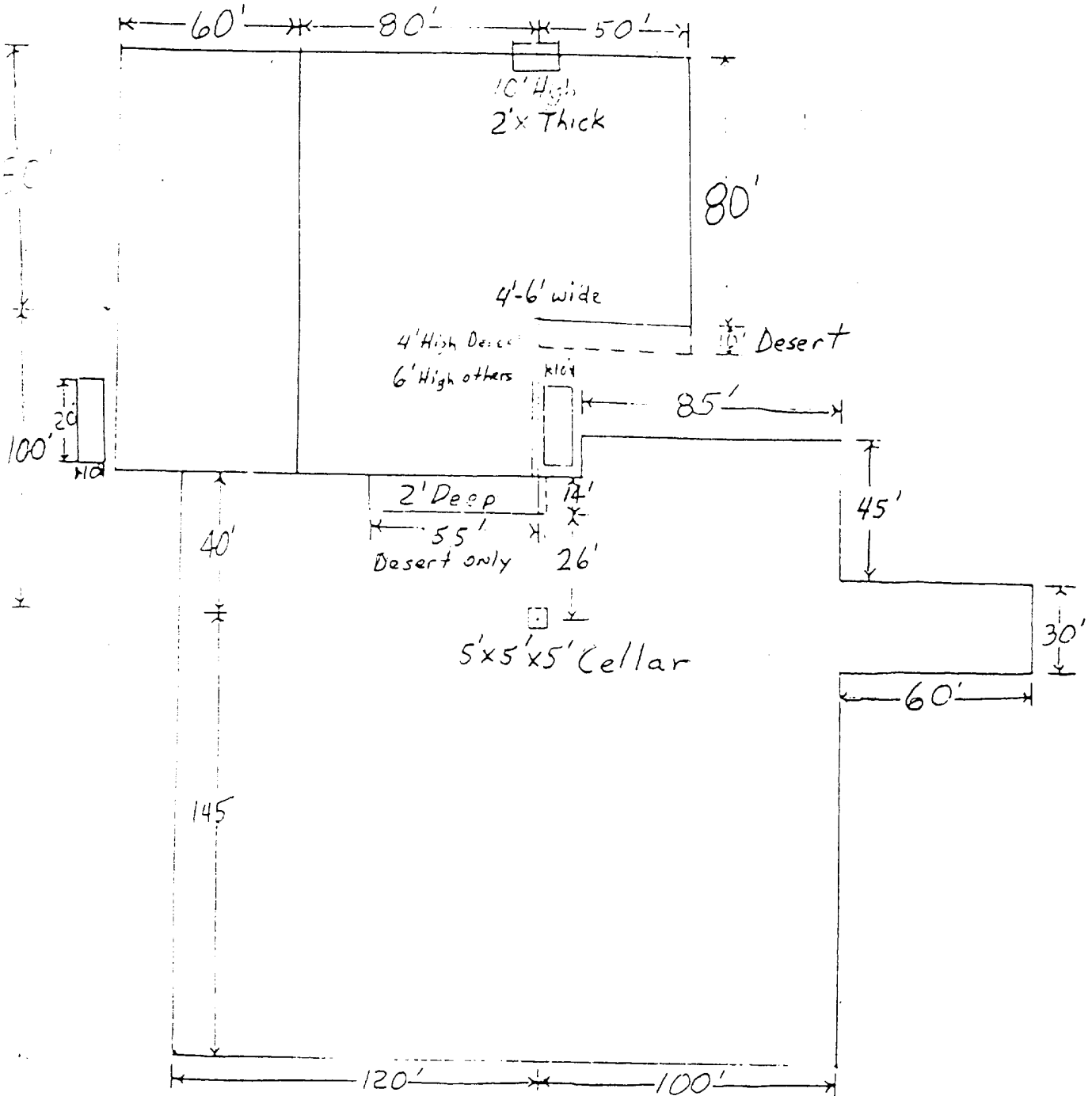
SEVEN RIVERS	Surface
SAN ANDRES	722'
GLORIETA	900'
TUBB	2248'
ABO	2427'
3. Hydrocarbon bearing strata may occur in the Abo formation(s). No fresh water is expected to be encountered below 1400'.
4. The Casing and Blowout Preventer Program will be determined by hole conditions as encountered. See Exhibit VI. Anticipate drilling with air or foam using ram type preventer and rotating head for well control. The 8 5/8" casing will be set at approximately 1400' to protect any fresh water zones and cemented to the surface. The 4 1/2" production casing will be set at total depth or shallower depending upon the depth of the deepest commercial hydrocarbon bearing strata encountered. Sufficient amounts and kinds of cement would be used to ensure any water, gas, or oil zones encountered are isolated and shut off down to the casing point if run.
5. No drill stem test or coring program is planned. The logging program may consist of a GR-CNL from surface total depth and FDC from casing point to total depth.
6. Anticipated drilling time is ten days with completion operations to follow as soon as a completion unit is available.



6"-8" Watered & Compacted Caliche
ON PAD & ROAD IF NEEDED

		MESA PETROLEUM CO. PERMAN BASIN DIVISION			
EXHIBIT V					
FOR PROPOSED DEBBIE FEDERAL #7					
BY:		DRAWN BY:		SCALE:	
DATE:					

Blow-out Preventers hydril and choke manifold ore all 900 Series

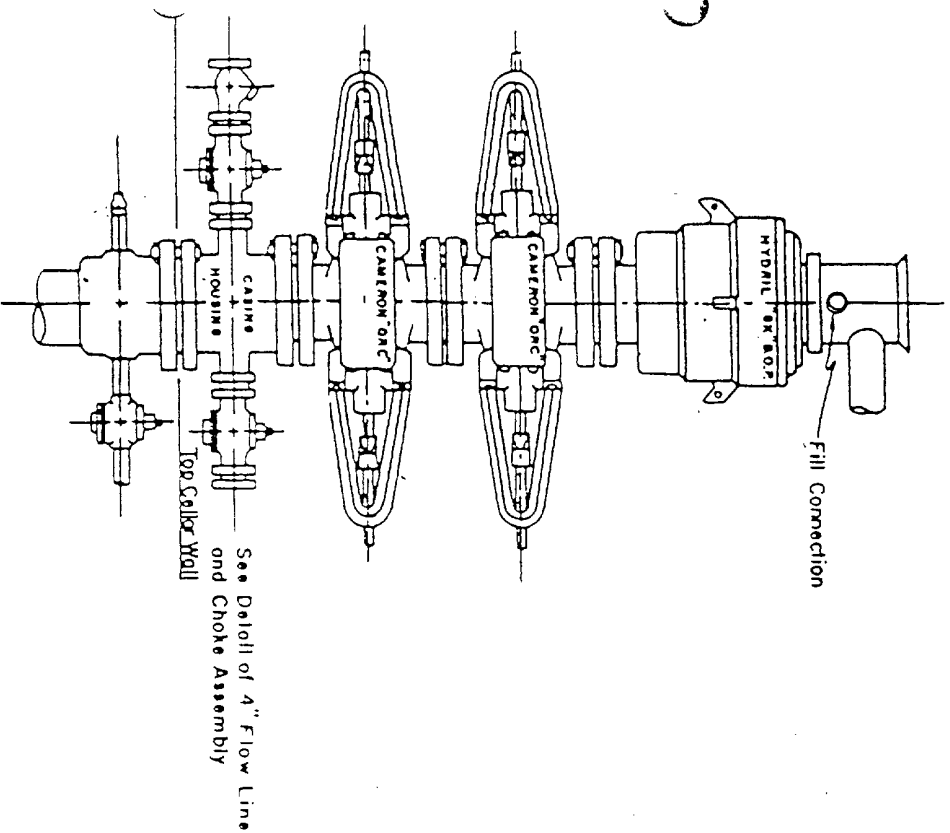

3,000 PSI WORKING PRESSURE
BLOW-OUT PREVENTER HOOK-UP

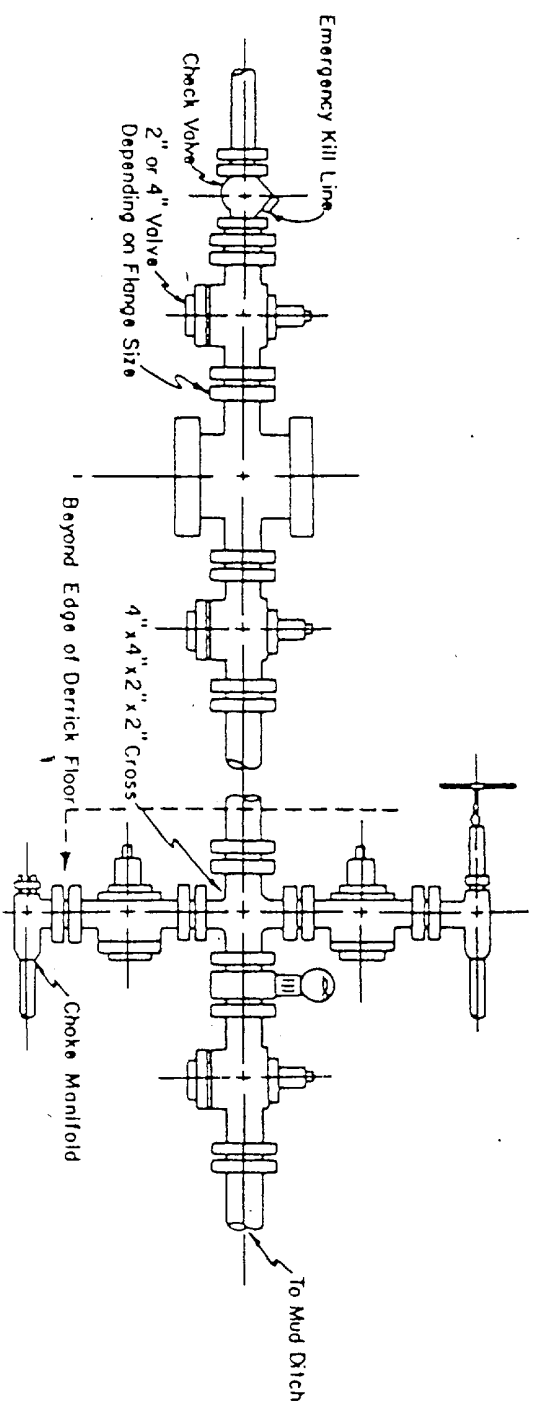

3,000 PSI WORKING PRESSURE KILL, CHOKE, AND FILL CONNECTIONS

DETAIL OF 4" FLOW LINE CHOKE ASSEMBLY

Minimum assembly for 3,000 PSI working pressure will consist of three preventers.
The bottom and middle preventers may be Cameron.

NOTE: HYDRIL not installed on shallow-low pressure wells.
RAM type BOPs are API 10" X 3000 PSI



E X H I B I T

V I