

NEW MEXICO OIL CONSERVATION COMMISSION
DRAWER DD
ARTESIA, NEW MEXICO

FIELD REPORT FOR CEMENTING OF WELLS

Operator <u>Mesa Pet. Co.</u>		Lease <u>Haley Com.</u>		Well # <u>3</u>	
Location of Well	Unit <u>A</u>	Section <u>12</u>	Township <u>7S</u>	Range <u>22E</u>	County <u>Chaves</u>
Drilling Contractor	<u>DUAL</u>		Type of Equipment <u>ROTARY</u>		

* WITNESS APPROVED CASING PROGRAM

Size of Hole	Size of Casing	Weight Per Foot	New or Used	Depth	Sacks Cement
* 12 1/4"	8 5/8"	24	new	1400'	Circ
7 7/8"	4 1/2"	10.5	"	3500'	350

Casing Data:

Surface _____ joints of 8 7/8 inch 24 # Grade J-55

(Approved) (Rejected) _____

Inspected by BW Weaver date 4-13-83

Cementing Program

Size of hole 12 Size of Casing 8 5/8 Sacks cement required _____

Type of Shoe used Tex-Pat Float collar used Insert Btm 3 jts welded yes

TD of hole 1210 Set 1217 Feet of 8 7/8 Inch 24 # Grade J-55

New ~~and~~ csg. @ 1217 with 200 sacks neat cement around shoe

+ 400 sax BJ Lite additives _____

Plug down @ 230 (AM) (PM) Date 4-13-83

Cement circulated No No. of Sacks _____

Cemented by BJ Witnessed by BW Weaver

Temp. Survey ran @ 8:30 (AM) (PM) Date 4-13-83 top cement @ 400

Casing test @ _____ (AM) (PM) Date _____

Method Used _____ Witnessed by _____

Checked for shut off @ _____ (AM) (PM) Date _____

Method used _____ Witnessed by _____

Remarks: Loss circulation 115

Ran 1 1/2 to 300 ft 150 SX C 4% CC

Tag 210 ft Ran 100 SX C 4% CC

Tag 210 ft Ran 100 SX C 4% CC

Tag 130 Ran 100 SX C 4% CC

Tag @ 80 Ran 100 SX C 4% CC

Tag @ 80 Ran 200 SX C 4% CC

Cement Fell Back Rodi Mix to Surface

NO. OF COPIES RECEIVED	
DISTRIBUTION	
SANTA FE	<input checked="" type="checkbox"/>
FILE	<input checked="" type="checkbox"/>
U.S.G.S.	<input checked="" type="checkbox"/>
LAND OFFICE	<input checked="" type="checkbox"/>
OPERATOR	<input checked="" type="checkbox"/>

NEW MEXICO OIL CONSERVATION COMMISSION

RECEIVED

FEB 08 1983

O. C. D.

ARTESIA OFFICE

Form C-101
Revised 1-1-65

5A. Indicate Type of Lease

STATE ☐FEE ☒

5. State Oil & Gas Lease No.

APPLICATION FOR PERMIT TO DRILL, DEEPEN, OR PLUG BACK

a. Type of Work

DRILL ☒DEEPEN ☐PLUG BACK ☐

b. Type of Well

OIL WELL ☐GAS WELL ☒

OTHER

SINGLE ZONE ☒MULTIPLE ZONE ☐

c. Name of Operator

Mesa Petroleum Co. ☒

d. Address of Operator

P.O. Box 2009 / Amarillo, Texas 79189

e. Location of Well

UNIT LETTER A

LOCATED 532

FEET FROM THE

North

LINE

ND 453

FEET FROM THE

East

LINE OF SEC. 12

TWP. 7S

RGE. 22E

NMPM

7. Unit Agreement Name

8. Farm or Lease Name

Haley Com

9. Well No.

3

10. Field and Pool, or Wildcat Unders. West Pecos Slope ABO

12. County

Chaves

19. Proposed Depth

3500'

19A. Formation

ABO

20. Rotary or C.T.

Rotary

1. Elevations (Show whether DF, RT, etc.)

4117' GR

21A. Kind & Status Plug. Bond

Blanket

21B. Drilling Contractor

Dual Drilling

22. Approx. Date Work will start

March 1, 1983

PROPOSED CASING AND CEMENT PROGRAM

SIZE OF HOLE	SIZE OF CASING	WEIGHT PER FOOT	SETTING DEPTH	SACKS OF CEMENT	EST. TOP
12 1/4"	8 5/8"	24#	1400'	700/300	Surface
7 7/8"	4 1/2"	10.5#	3500'	350	Cover all pay

Propose to drill 12 1/4" hole to approximately 1400' to set 8 5/8" surface casing and cement to surface. Will nipple up ram type BOP's and reduce hole to 7 7/8" to drill to total depth. Drilling medium will be air, foam, or mud as required. After log evaluation, 4 1/2" casing may be run and cemented with sufficient kinds and amounts to isolate and seal off any fresh water, oil or gas zones encountered.

Operator's Gas Sales are dedicated

APPROVAL VALID FOR 180 DAYS

PERMIT EXPIRES 8-11-83

UNLESS DRILLING UNDERWAY

Location approved under NSL-1631

XC: NMOC-D-A (O+6), CEN RCDS, ACCTG, OPS (FILE), MIDLAND, ROSWELL, PARTNERS

Post #10-1
2-18-83
New Loc + API

ABOVE SPACE DESCRIBE PROPOSED PROGRAM: IF PROPOSAL IS TO DEEPEN OR PLUG BACK, GIVE DATA ON PRESENT PRODUCTIVE ZONE AND PROPOSED NEW PRODUCTION ZONE. GIVE BLOWOUT PREVENTER PROGRAM, IF ANY.

I hereby certify that the information above is true and complete to the best of my knowledge and belief.

by R. F. Mathis Title REGULATORY COORDINATOR Date 2-7-83

(This space for State Use)

PROVED BY Mike Walker TITLE

OIL AND GAS INSPECTOR

Notify N.M.O.C. in sufficient

time to witness cementing

FEB 14 1983

CONDITIONS OF APPROVAL, IF ANY:

NSL-1631

DATE 12-12-79

ASH

OIL CONSERVATION DIVISION

STATE OF NEW MEXICO
ENERGY AND MINERALS DEPARTMENTP. O. BOX 2088
SANTA FE, NEW MEXICO 8750Form C-102
Revised 10-1-78

All distances must be from the outer boundaries of the Section.

Mesa Petroleum Co.		Lease		Haley Com		Well No. #3	
Well Letter A	Section 12	Township 7 South	Range 22 East	County Chaves			
Actual Postage Location of Well:							
532		feet from the North line and		453		feet from the East line	
Ground Level Elev. 4117	Producing Formation ABO		Pool West Pecos Slope		Dedicated Acreages NE $\frac{1}{4}$ 160 Acres		

1. Outline the acreage dedicated to the subject well by colored pencil or hachure marks on the plat below.
2. If more than one lease is dedicated to the well, outline each and identify the ownership thereof (both as to working interest and royalty).
3. If more than one lease of different ownership is dedicated to the well, have the interests of all owners been consolidated by communitization, unitization, force-pooling, etc?

☐ Yes ☐ No If answer is "yes," type of consolidation communitization in progress

If answer is "no," list the owners and tract descriptions which have actually been consolidated. (Use reverse side of this form if necessary.)

No allowable will be assigned to the well until all interests have been consolidated (by communitization, unitization, forced-pooling, or otherwise) or until a non-standard unit, eliminating such interests, has been approved by the Division.

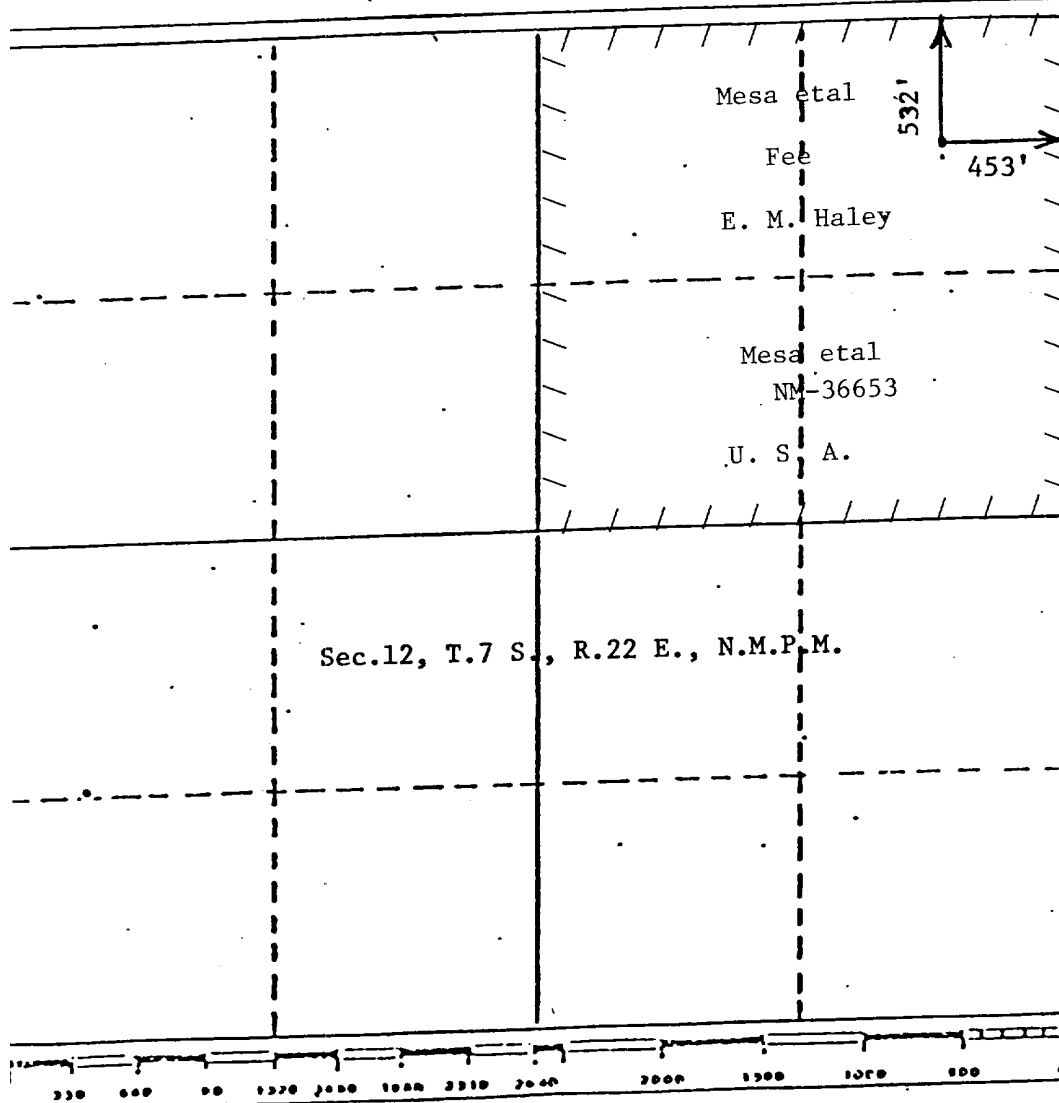

CERTIFICATION

I hereby certify that the information contained herein is true and complete to the best of my knowledge and belief.

R. E. Mathis

Name

R. E. Mathis

Position

Regulatory Coordinator

Company

Mesa Petroleum Co.

Date

2-7-83

I hereby certify that the well location shown on this plat was plotted from field notes of actual surveys made by me or under my supervision, and that the same is true and correct to the best of my knowledge and belief.

JOHN D. JAQUESS
NEW MEXICO
Date Surveyed
November 10, 1982
6290
Registered Professional Engineer
and/or Civil Surveyor
John D. Jaquess, P.E. & L.S.
Certificate No. 6290