

30-005-61938

APPLICATION FOR PERMIT TO DRILL, DEEPEN, OR PLUG BACK

1. TYPE OF WORK DRILL <input checked="" type="checkbox"/> DEEPEN <input type="checkbox"/> PLUG BACK <input type="checkbox"/>		5. LEASE DESIGNATION AND SERIAL NO. NM-28305
2. TYPE OF WELL OIL WELL <input type="checkbox"/> GAS WELL <input checked="" type="checkbox"/> OTHER <input type="checkbox"/>		6. IF INDIAN, ALLOTTEE OR TRIBE NAME
3. NAME OF OPERATOR Yates Petroleum Corporation ✓		7. UNIT AGREEMENT NAME
4. ADDRESS OF OPERATOR 207 S. 4th, Artesia, New Mexico 88210		8. FARM OR LEASE NAME Binnion "TT" Federal
5. LOCATION OF WELL (Report location clearly and in accordance with any State requirements*) At surface: 1980' FSL and 660' FEL At proposed prod. zone: same		9. WELL NO. #6
6. DISTANCE IN MILES AND DIRECTION FROM NEAREST TOWN OR POST OFFICE* Approximately 25 miles NE of Roswell, New Mexico.		10. FIELD AND POOL, OR WILDCAT Pecos Slope Abo
7. DISTANCE FROM PROPOSED* LOCATION TO NEAREST PROPERTY OR LEASE LINE, FT. (Also to nearest drlg. unit line, if any) 660'		11. SEC., T., R., M., OR BLK. AND SURVEY OR AREA Sec. 24-T7S-R25E
8. DISTANCE FROM PROPOSED LOCATION* TO NEAREST WELL, DRILLING, COMPLETED, OR APPLIED FOR, ON THIS LEASE, FT.		12. COUNTY OR PARISH Chaves
9. ELEVATIONS (Show whether DF, RT, GR, etc.) 3627.2' GL		13. STATE NM
10. PROPOSED CASING AND CEMENTING PROGRAM		14. NO. OF ACRES ASSIGNED TO THIS WELL 160
11. NO. OF ACRES IN LEASE 800		15. ROTARY OR CABLE TOOL Rotary
16. PROPOSED DEPTH 4325'		17. APPROX. DATE WORK WILL START* O.C.B. ASAP

SIZE OF HOLE	SIZE OF CASING	WEIGHT PER FOOT	SETTING DEPTH	QUANTITY OF CEMENT
14 3/4"	10 3/4"	40.5# J-55	850'	700 sx circulated
7 7/8"	4 1/2"	9.5# J-55	TD	350 sx

We propose to drill and test the Abo and intermedaite formations. Approximately 850' of surface casing will be set and cement circulated to shut off gravel and caving. If needed (lost circulation) 8 5/8" intermediate casing will be run to 1500' and cemented with enough cement calculated to tie back into the surface casing. If commercial, production casing will be run and cemented with adequate cover, perforated, and stimulated as needed for production.

MUD PROGRAM: FW gel/LCM to 850', Brine to 3200', KCL water/brine to TD.

BOP PROGRAM: BOP's will be installed at the offset and tested daily.

GAS NOT DEDICATED.

IN ABOVE SPACE DESCRIBE PROPOSED PROGRAM: If proposal is to deepen or plug back, give data on present productive zone and proposed new productive zone. If proposal is to drill or deepen directionally, give pertinent data on subsurface locations and measured and true vertical depths. Give blowout preventer program, if any.

SIGNED Tom Beasley TITLE Regulatory Agent DATE 1/28/83
(This space for Federal or State office use)

PERMIT NO. APPROVED APPROVAL DATE FEB 15 1983
APPROVED BY JAMES A. GILLHAM TITLE DISTRICT SUPERVISOR DATE FEB 15 1983
CONDITIONS OF APPROVAL, IF ANY

**NEW MEXICO OIL CONSERVATION COMMISSION
WELL LOCATION AND ACREAGE DEDICATION PLAT**

Form C-102
Supersedes C-128
Effective 1-1-65

All distances must be from the outer boundaries of the Section.

Owner YATES PETROLEUM CORPORATION			Lease Binnion "TT" Federal		Well No. 6
Section 1	Section 24	Township 7 South	Range 25 East	County Chaves	
Location of Well:					
1950	feet from the South	line and 660	feet from the East	line	
about 1 1/2 Well Elev. 3627.2'	Producing Formation Abo	Pool Pecos Slope Abo	Dedicated Acreage: 160 Acres		

1. Outline the acreage dedicated to the subject well by colored pencil or hatchure marks on the plat below.
2. If more than one lease is dedicated to the well, outline each and identify the ownership thereof (both as to working interest and royalty).
3. If more than one lease of different ownership is dedicated to the well, have the interests of all owners been consolidated by communitization, unitization, force-pooling, etc?

☐ Yes ☐ No If answer is "yes," type of consolidation _____

If answer is "no," list the owners and tract descriptions which have actually been consolidated. (Use reverse side of this form if necessary.) _____

No allowable will be assigned to the well until all interests have been consolidated (by communitization, unitization, forced-pooling, or otherwise) or until a non-standard unit, eliminating such interests, has been approved by the Commission.

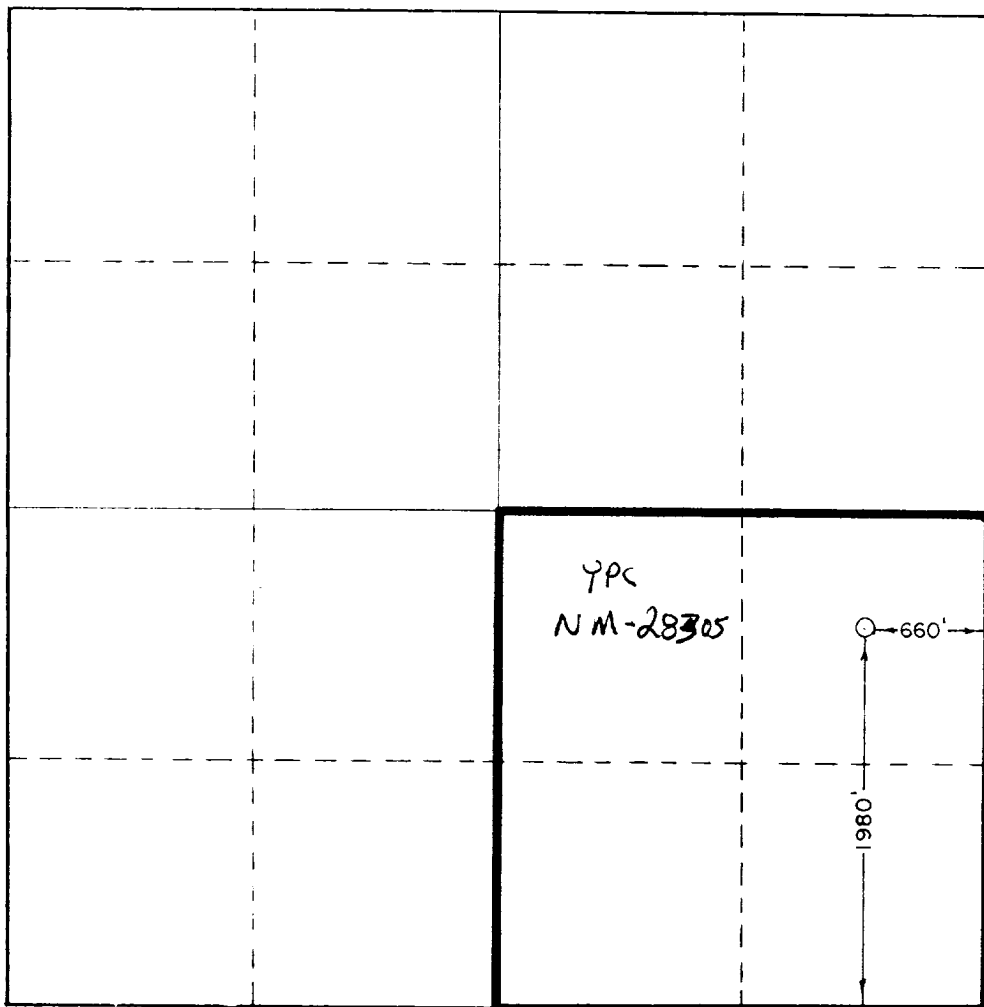

CERTIFICATION

I hereby certify that the information contained herein is true and complete to the best of my knowledge and belief.

Ken Beardemphl

Name
Ken Beardemphl

Position
Regulatory Agent

Company
Yates Petroleum Corp.

Date
January 27, 1983

I hereby certify that the well location shown on this plat was located from field notes of actual surveys made by me or under my supervision, and that the same is true and correct to the best of my knowledge and belief.

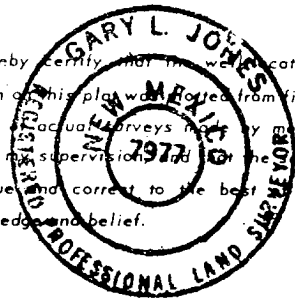

Date Surveyed
January 25, 1983

Registered Professional Engineer and/or Land Surveyor

Gary L. Jones

Certificate No.

7977

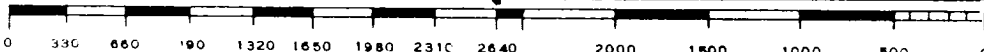

YATES PETROLEUM CORPORATION
Binnion "TT" Federal #6
1980' FSL and 660' FEL
Sec. 24-T7S-R25E
Chaves County, New Mexico

In conjunction with Form 9-331C, Application for Permit to Drill subject well, Yates Petroleum Corporation submits the following ten items of pertinent information in accordance with USGS requirements.

1. The geologic surface formation is sandy alluvium.
2. The estimated tops of geologic markers are as follows:

San Andres	427'
Glorieta	1539'
Fullerton	2963'
Abo	3627'
TD	4325'
3. The estimated depths at which anticipated water, oil or gas formations are expected to be encountered:
Water: 150'-180'
Oil or Gas: Abo 3650'
4. Proposed Casing Program: See Form 9-331C.
5. Pressure Control Equipment: See Form 9-331C and Exhibit B.
6. Mud Program: See Form 9-331C.
7. Auxiliary Equipment: Kelly Cock; pit level indicators and flow sensor equipment; sub with full-opening valve on floor, drill pipe connection.
8. Testing, Logging and Coring Program:
Samples: Surface casing to TD.
DST's: As warranted.
Coring: None
Logging: CNL-FDC TD to csq w/GR-CNL to surface & DLL from TD to csq.
9. No abnormal pressures or temperatures are anticipated.
10. Anticipated starting date: As soon as possible after approval.

To Red Bluff
Ranch Road

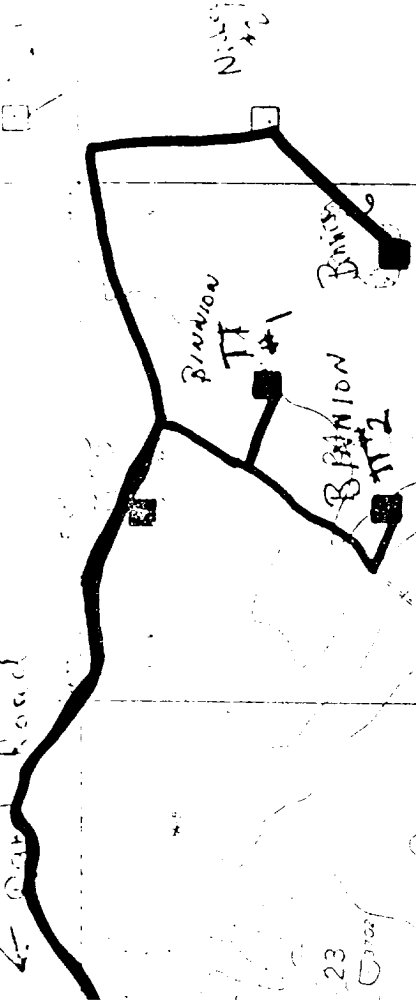

To Red Bluff
Ranch Road

YPC
BINNION "TT" Parcel # 6
1980' FSL & 660' FEL
Sec. 24-T7S-R25E
Chaves County, NM

EXHIBIT A

31

36

35

Bluff Lake

Exhibit B

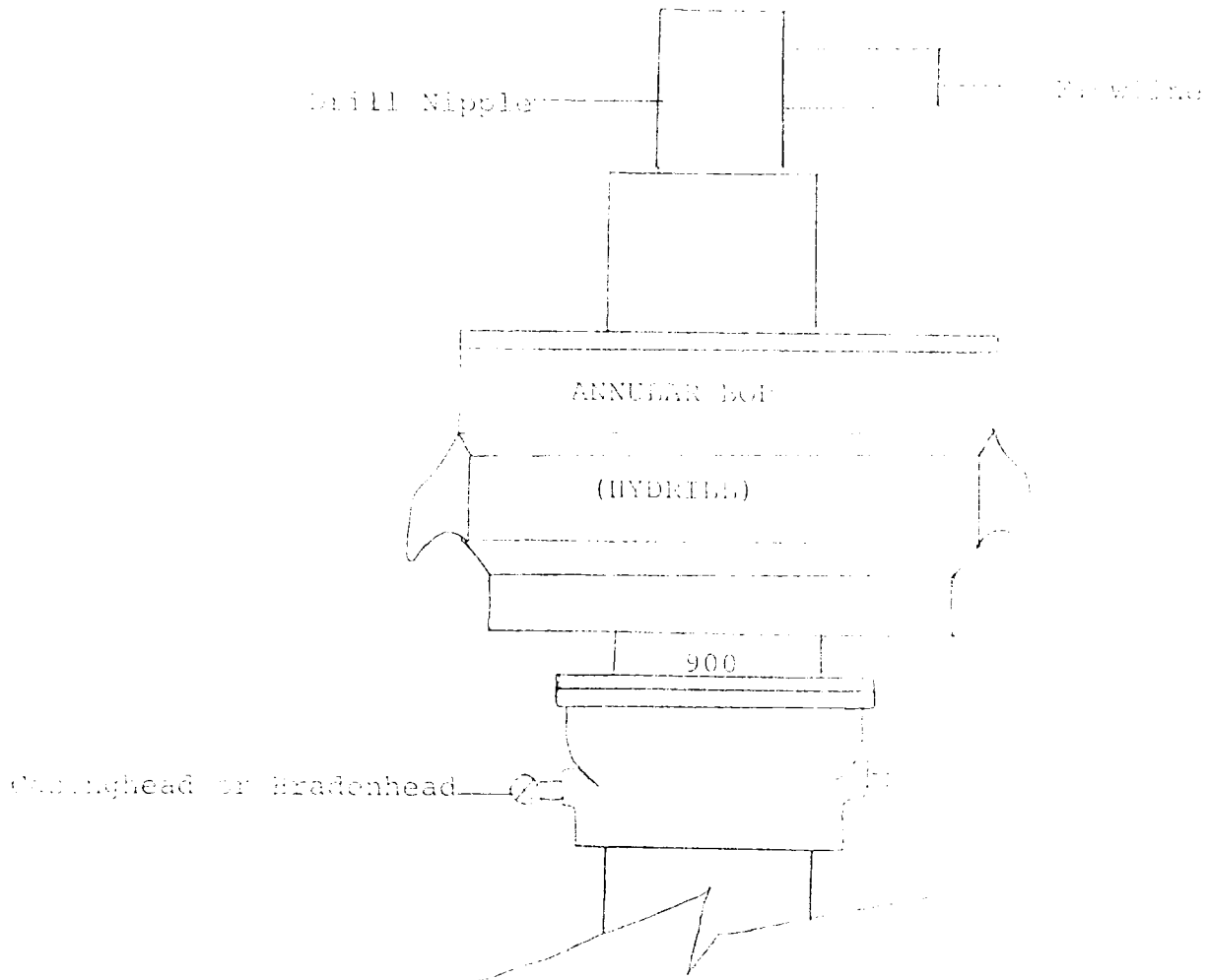

THE FOLLOWING CONSTITUTE MINIMUM BLOWOUT PREVENTER REQUIREMENTS

1. All preventers to be hydraulically operated with secondary manual controls installed prior to drilling out from under casing.
2. All connections from operating manifolds to preventers to be all steel. Hole or tube a minimum of one inch in diameter.
3. The available closing pressure shall be at least 15% in excess of that required with sufficient volume to operate the BOP's.
4. All connections to and from preventer to have a pressure rating equivalent to that of the BOP's.
5. Hole must be kept filled on trips below intermediate casing.

YATES PETROLEUM CORP.

Exhibit C

Reserve Pit
bottom to be at
ground level to
1 ft.

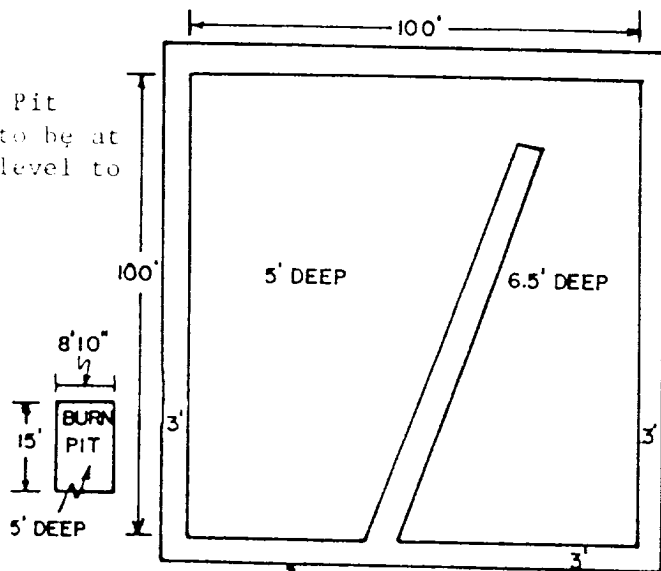

NOTE:

Inside walls must be as
high and wide as outer
walls of pit.

