

NO. OF COPIES RECEIVED	
DISTRIBUTION	
SANTA FE	<input checked="" type="checkbox"/>
FILE	<input checked="" type="checkbox"/>
U.S.G.S.	<input checked="" type="checkbox"/>
LAND OFFICE	<input checked="" type="checkbox"/>
OPERATOR	<input checked="" type="checkbox"/>

RECEIVED

MAR 16 1983

O. C. D.

## APPLICATION FOR PERMIT TO DRILL, DEEPEN, OR PLUG BACK

a. Type of Work

DRILL ☒DEEPEN ☐PLUG BACK ☐

b. Type of Well

OIL WELL ☐GAS WELL ☒OTHER ☐SINGLE ZONE ☐MULTIPLE ZONE ☐

Name of Operator

Yates Petroleum Corporation

Address of Operator

207 S. 4th Street, Artesia, New Mexico 88210

Location of Well

UNIT LETTER C

LOCATED 660

FEET FROM THE

North

LINE

1980

FEET FROM THE

West

LINE OF SEC. 27

TWP. 7S

R. 25E

17. County  
Chaves

19. Proposed Depth

4200

19A. Formation

Abo

20. Method of C.T.

Rotary

21. (Indicate whether DP, KI, etc.)

3670.4 GL.

21A. Kind &amp; Status Plug. Bond

Blanket

21B. Drilling Contractor

Not Determined

22. Approx. Date Work will start

ASAP

## PROPOSED CASING AND CEMENT PROGRAM

SIZE OF HOLE	SIZE OF CASING	WEIGHT PER FOOT	SETTING DEPTH	SACKS OF CEMENT	EST. TOP
14 3/4	10 3/4	40.5 #J-55	900'	800 SX	Circulated
7 7/8	4 1/2	9.5#	Total Depth	350 SX	

We propose to drill and test the ABO and intermediate formations. Approximately 900' of surface casing will be set and cement circulated to shut off gravel and caving. If needed (lost circulation) 8 5/8 intermediate casing will be run to 1500' and cemented with enough cement calculated to tie back into the surface casing. Temperature survey will be run to determine cement top. If commercial, production casing will be run and cemented with adequate cover, perforate, and stimulate as needed for production.

MUD PROGRAM: Fw gel and LCM to 900', Brine to 3200', Brine and KCL water to TD.

BOP PROGRAM: BOP's will be installed at the offset and tested daily.

GAS NOT DEDICATED.

APPROVAL VALID FOR 180 DAYS  
PERIOD 3/16/83 TO 9/18/83  
UNLESS DRILLING UNDERWAY

ABOVE SPACE DESCRIBE PROPOSED PROGRAM; IF PROPOSAL IS TO DEEPEN OR PLUG BACK, GIVE DATA ON PRESENT PRODUCTIVE ZONE AND PROPOSED NEW PRODUCTION ZONE. GIVE BLOWOUT PREVENTER PROGRAM, IF ANY.

I hereby certify that the information above is true and complete to the best of my knowledge and belief.

Signed Ken Beardsley Title Regulatory Agent Date March 16, 1983

(This space for State Use)

APPROVED BY MAH TITLE OIL AND GAS INSPECTOR

CONDITIONS OF APPROVAL, IF ANY:

Notice NMOC G.C. for 15 days to 15 days commencing the 15th of casing

MAR 18 1983

Noted up  
15th of March  
1983

NEW MEXICO OIL CONSERVATION COMMISSION  
WELL LOCATION AND ACREAGE DEDICATION PLAT

Form C-102  
Supersedes C-128  
Effective 1-1-65

All distances must be from the outer boundaries of the Section.

Operator <b>YATES PETROLEUM CORPORATION</b>			Lease <b>Spool SU Com</b>		Well No. <b>5</b>
Unit Letter <b>C</b>	Section <b>27</b>	Township <b>7 South</b>	Range <b>25 East</b>	County <b>Chaves</b>	
Actual Footage Location of Well: <b>660</b> feet from the <b>North</b> line and <b>1980</b> feet from the <b>West</b> line					
Ground Level Elev. <b>3670.4</b>	Producing Formation <b>Abq</b>		Pool <b>Pecos Slope Abq</b>		Dedicated Acreage: <b>160</b> Acres

- Outline the acreage dedicated to the subject well by colored pencil or hachure marks on the plat below.
- If more than one lease is dedicated to the well, outline each and identify the ownership thereof (both as to working interest and royalty).
- If more than one lease of different ownership is dedicated to the well, have the interests of all owners been consolidated by communitization, unitization, force-pooling, etc?

☐ Yes ☐ No If answer is "yes," type of consolidation \_\_\_\_\_

If answer is "no," list the owners and tract descriptions which have actually been consolidated. (Use reverse side of this form if necessary.) \_\_\_\_\_

No allowable will be assigned to the well until all interests have been consolidated (by communitization, unitization, forced-pooling, or otherwise) or until a non-standard unit, eliminating such interests, has been approved by the Commission.

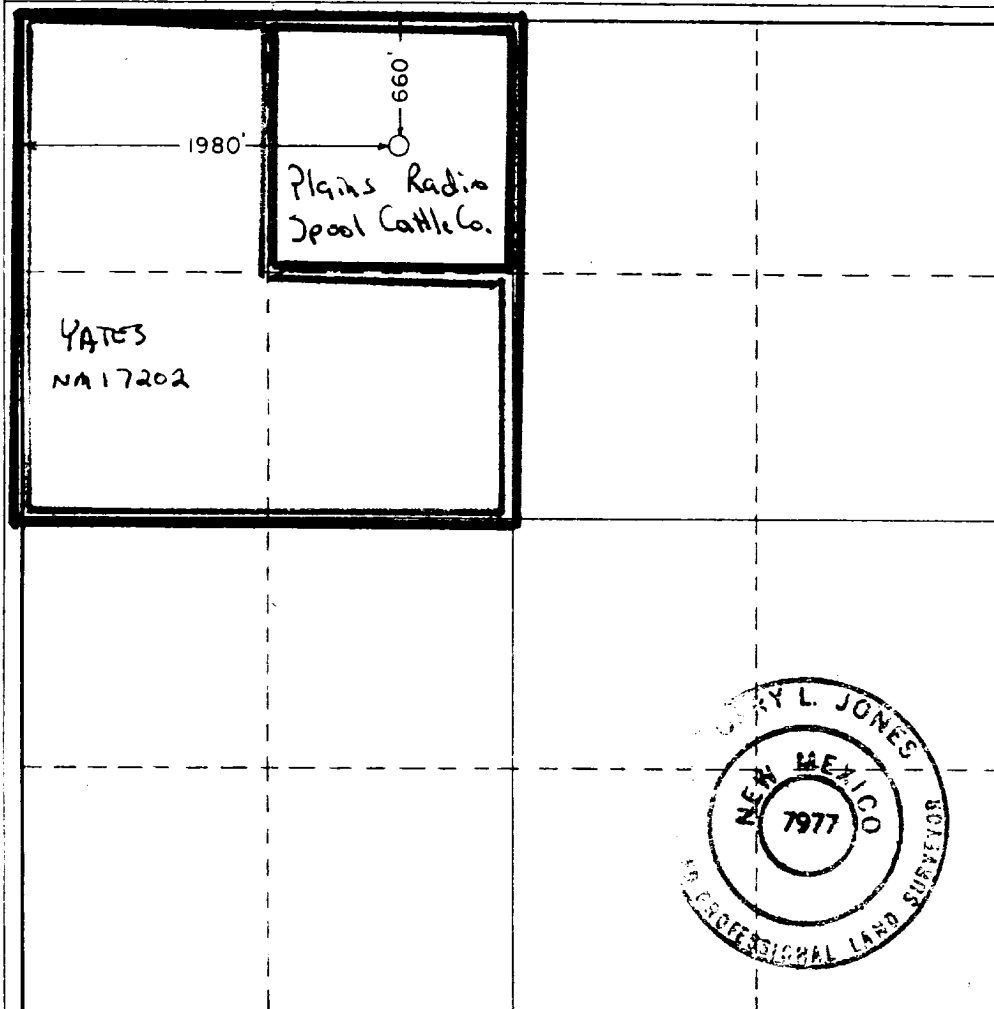

CERTIFICATION

I hereby certify that the information contained herein is true and complete to the best of my knowledge and belief.

*Ken Beardemphl*

Name

*Ken Beardemphl*

Position

*Regulatory Agent*

Company

*Yates Petroleum Corp.*

Date

*March 16, 1983*

I hereby certify that the well location shown on this plat was plotted from field notes of actual surveys made by me or under my supervision, and that the same is true and correct to the best of my knowledge and belief.

Date Surveyed

*March 10, 1983*

Registered Professional Engineer and/or Land Surveyor

*James E. Jones*

Certificate No.

*7977*

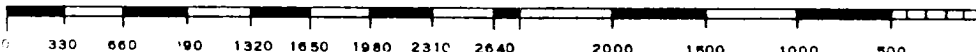

# EXHIBIT B

## BOP DIAGRAM

