

Form 9-231 C
(May 1963)

NM OIL CONS. COMMISSION

Drawer DD

Artesia, NM 88210

UNITED STATES

DEPARTMENT OF THE INTERIOR

GEOLOGICAL SURVEY

SUBMIT IN TRIPL. RE*
(Other instructions on
reverse side)Form approved.
Budget Bureau No. 42-R1425.

APPLICATION FOR PERMIT TO DRILL, DEEPEN, OR PLUG BACK

1a. TYPE OF WORK

DRILL ☒DEEPEN ☐PLUG BACK ☐

b. TYPE OF WELL

OIL
WELL ☐GAS
WELL ☒

OTHER

SINGLE
ZONE ☒MULTIPLE
ZONE ☐

2. NAME OF OPERATOR

Getty Oil Company

3. ADDRESS OF OPERATOR

P.O. Box 730 Hobbs, NM 88240

4. LOCATION OF WELL (Report location clearly and in accordance with any State requirements.)*

At surface

Unit 1tr. A, 660' FNL & 990' FEL

Section 7, T6S, R26E

At proposed prod. zone

14. DISTANCE IN MILES AND DIRECTION FROM NEAREST TOWN OR POST OFFICE

44 miles Northeast of Roswell, NM

MIN. SERVICE
ROSSELL, NEW MEXICO

15. DISTANCE FROM PROPOSED*

LOCATION TO NEAREST
PROPERTY OR LEASE LINE, FT.

(Also to nearest drlg. unit line, if any)

660'

16. NO. OF ACRES IN LEASE

313.39

17. NO. OF ACRES ASSIGNED
TO THIS WELL

160.00

18. DISTANCE FROM PROPOSED LOCATION*

TO NEAREST WELL, DRILLING, COMPLETED,
OR APPLIED FOR, ON THIS LEASE, FT.

2310'

19. PROPOSED DEPTH

4200'

20. ROTARY OR CABLE TOOLS

Rotary

21. ELEVATIONS (Show whether DF, RT, GR, etc.)

3757.3 GR

22. APPROX. DATE WORK WILL START*

April, 1983

23.

PROPOSED CASING AND CEMENTING PROGRAM

SIZE OF HOLE	SIZE OF CASING	WEIGHT PER FOOT	SETTING DEPTH	QUANTITY OF CEMENT
14 3/4"	11 3/4"	42.0	900'	978 ft ³ (660 sxs) CIRCULATE
10 5/8"	8 5/8"	24.0	1600'	"Run only if necessary"
7 7/8"	5 1/2"	14.0	4200'	1831 ft ³ (1135 sxs)

- The subject well will be drilled from surface to 900' with fresh water and gel additives to condition the hole for running casing. From 900' to T.D. of 4200' a native mud and brine of sufficient weight and gel additives will be used to control formation pressures and condition the hole for electric logs and running casing.
- The pump and plug method will be used in cementing all strings of casing. The 11 3/4" and 8 5/8" casing will be cemented to surface. 8 5/8" casing will only be run to approximately 1600' if lost circulation becomes a problem. TOC on the 5 1/2" casing will be inside the surface/or intermediate casing.
- See attachment for BOP Program.
- Gas is not dedicated.

RECEIVED

MAR 25 1983

O. C. D.

IN ABOVE SPACE DESCRIBE PROPOSED PROGRAM: If proposal is to deepen or plug back, give data on present productive zone and proposed new productive zone. If proposal is to drill or deepen directionally, give pertinent data on subsurface locations and measured and true vertical depths. Give blowout preventer program, if any.

24.

SIGNED

Dale R. Crockett

TITLE

Area Superintendent

DATE

3/15/83

(This space for Federal or State office use)

PERMIT NO.

APPROVAL DATE

APPROVED BY

TITLE

DATE

CONDITIONS OF APPROVAL

APPROVED

MAR 23 1983

JAMES A. GILLHAM
DISTRICT SUPERVISOR

*See Instructions On Reverse Side

Posted 4-1-83
J.D. 1-1-83
4-1-83

**NEW MEXICO OIL CONSERVATION COMMISSION
WELL LOCATION AND ACREAGE DEDICATION PLAT**

Form C-102
Supersedes C-128
Effective 1-1-65

All distances must be from the outer boundaries of the Section.

Operator GETTY OIL COMPANY			Lease GETTY "GC" FEDERAL COM.		Well No. 2
Unit Letter A	Section 7	Township 6 South	Range 26 East	County Chaves	
Actual Footage Location of Well: 660 feet from the North line and 990 feet from the East line					
Ground Level Elev. 3757.3	Producing Formation ABO		Pool Undesignated	Dedicated Acreage: 160 Acres	

1. Outline the acreage dedicated to the subject well by colored pencil or hatchure marks on the plat below.
2. If more than one lease is dedicated to the well, outline each and identify the ownership thereof (both as to working interest and royalty).
3. If more than one lease of different ownership is dedicated to the well, have the interests of all owners been consolidated by communitization, unitization, force-pooling, etc?

☒ Yes ☐ No If answer is "yes," type of consolidation Communitization

If answer is "no," list the owners and tract descriptions which have actually been consolidated. (Use reverse side of this form if necessary.) _____

No allowable will be assigned to the well until all interests have been consolidated (by communitization, unitization, forced-pooling, or otherwise) or until a non-standard unit, eliminating such interests, has been approved by the Commission.

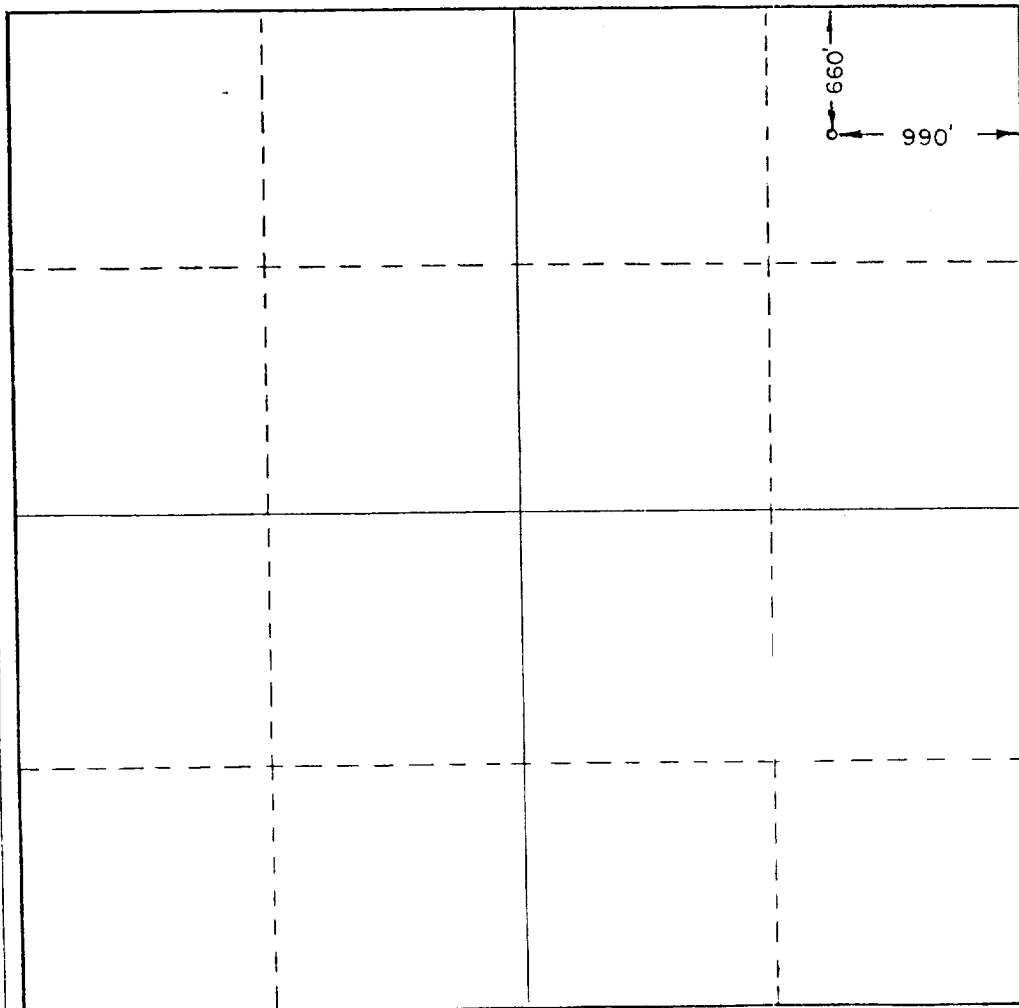

CERTIFICATION

I hereby certify that the information contained herein is true and complete to the best of my knowledge and belief.

Donald J. Steinnerd
Name

Donald J. Steinnerd

Position

Area Engineer

Company

Getty Oil Company

Date

March 3, 1983

I hereby certify that the well location shown on this plat was plotted from field notes of actual surveys made by me or under my supervision, and that the same is true and correct to the best of my knowledge and belief.

Date *March 1, 1983*

Registered Professional Engineer
in the State of New Mexico

3640

Certified

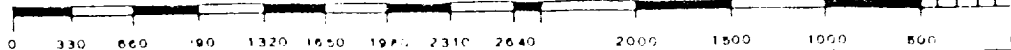

ADDITIONAL INFORMATION FOR
"APPLICATION FOR PERMIT TO DRILL"
GETTY OIL COMPANY
GETTY GC FED COM WELL NO. 2

1. The geologic name of the surface formation is assignable to the Ustollic Camborthid subgroup.
2. The estimated tops of important geologic markers are as follows:

<u>FORMATION</u>	<u>DEPTH FROM SURFACE</u>	<u>DEPTH SUBSEA</u>
San Andres	575'	+3182'
Glorietta	1630'	+2127'
Tubb	3120'	+ 637'
Abo	3700'	+ 57'

3. The estimated depths at which anticipated water and oil could be encountered are:

DEPTH

50' - 575' Possible fresh water
575' - 1630' San Andres - possible oil
3700' - 4200' Abo - possible gas

4. The proposed casing program is as follows:

<u>SIZE</u>	<u>GRADE</u>	<u>THREAD</u>	<u>WT.</u>	<u>TOP</u>	<u>BOTTOM</u>	<u>LENGTH</u>
11 3/4"	H-40	8RST&C	42#	Surface	900'	900'
*8 5/8"	K-55	8RST&C	24#	Surface	1600'	1600'
5 1/2"	K-55	8RST&C	14#	Surface	4200'	4200'

*Will run only if lost circulation is a problem

5. The minimum specifications for pressure control equipment to be used - see Figure I. The BOP stack will be tested to 5000 psi.
6. The drilling fluid from surface to 900' will be fresh water of sufficient gel to condition the hole for running casing. From 900' to 3400' a native mud system will be used with brine and LCM added for stability and seepage. From 3400' to TD a salt gel system will be used to condition the hole for logging and running casing.
7. The auxilliary equipment to be used is as follows:
 1. Kelly cocks
 2. Monitoring equipment on the mud system
 3. Sub on the floor with a full opening valve to be stabbed into drill pipe when the Kelly is not in the string.
8. There are no anticipated drill stem tests or cores to be cut.

EXHIBIT A
Getty Oil Company
Getty GC Fed Com
Well No. 2
660 FNL and 990 FEL
Section 7, T6S, R26E

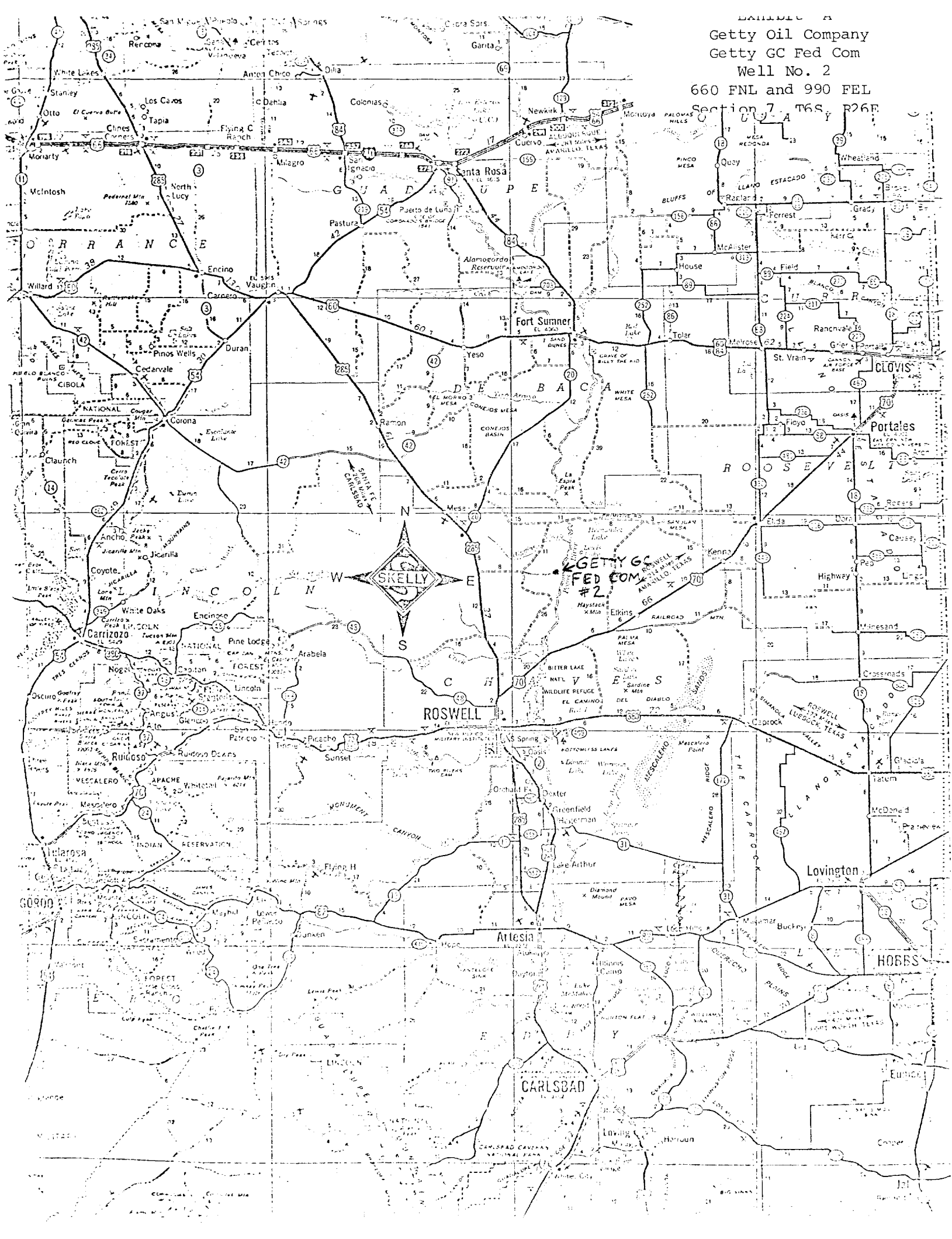

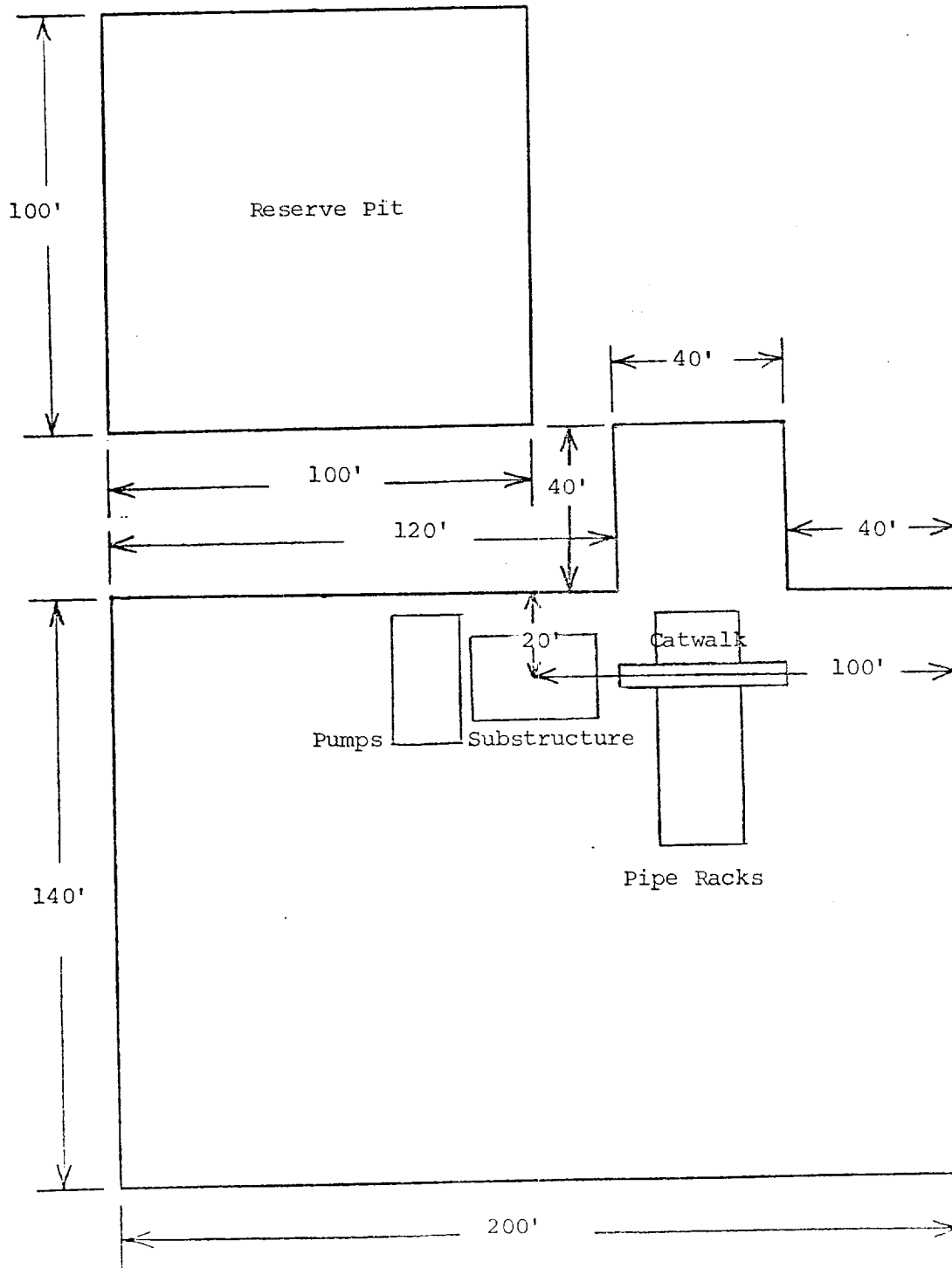

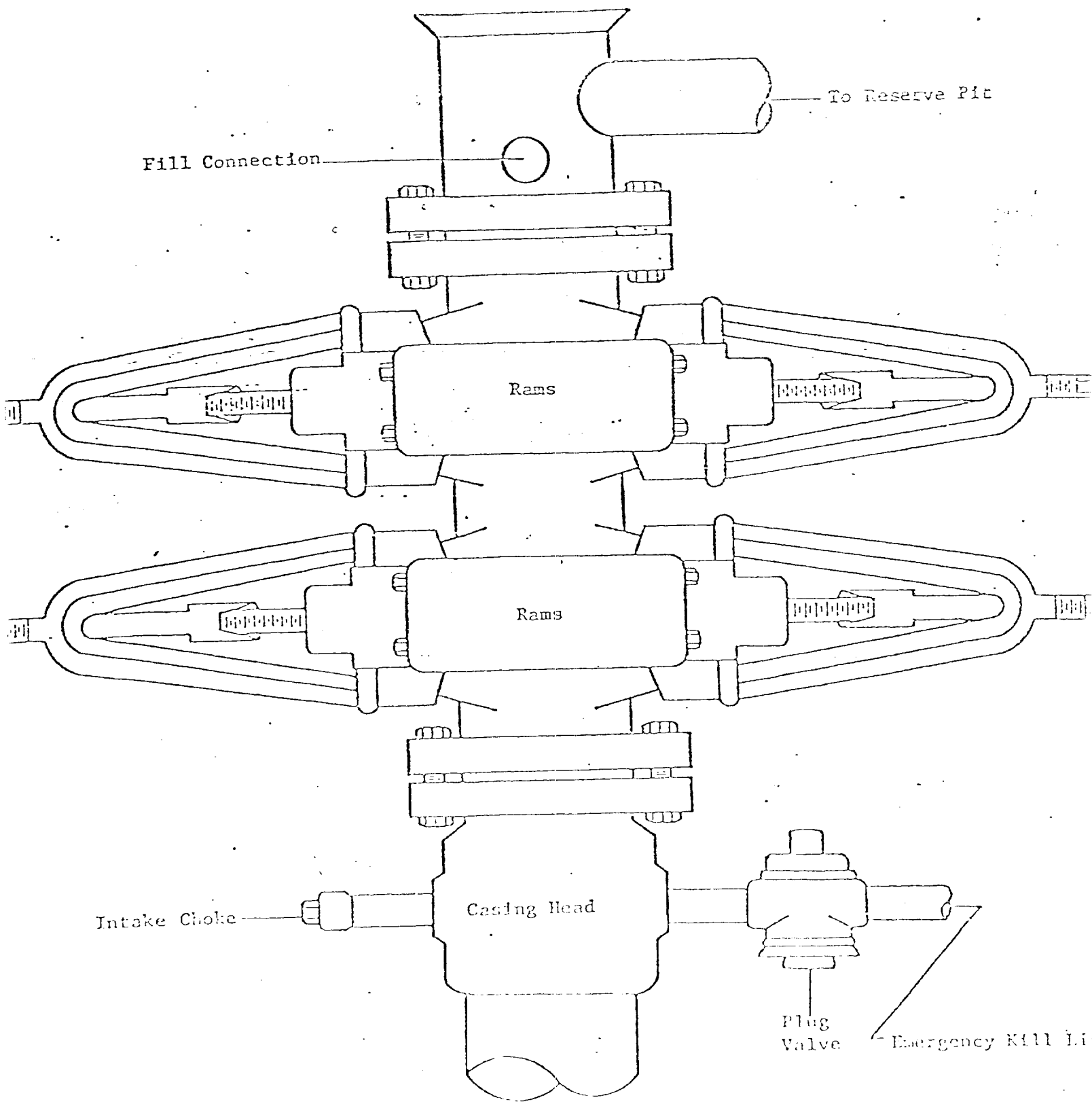

FIGURE I
GERTY OIL COMPANY

5000 PSI WORKING PRESSURE
DRILLING CONTROL HOOK-UP